

MINUTES
OF THE BOARD OF REGENTS
WESTERN KENTUCKY UNIVERSITY

November 19, 2005

AGENDA ITEM 1 - Call to Order

Required statutory notice having been given, the third quarterly meeting of the Board of Regents of Western Kentucky University was held in the *Cornelius A. Martin Regents Room* in the Mass Media and Technology Hall on the Western Kentucky University campus. The meeting was called to order by Chair Martin at approximately 9 a.m., CST.

AGENDA ITEM 2 - Invocation

The invocation was provided by Ms. Katie Dawson, Student Regent.

AGENDA ITEM 3 - Oath of Office

The Constitutional Oath of Office was administered to Ms. Yvette Haskins and Dr. Robert Dietle by Ms. Liz Esters, Secretary to the Board of Regents and Notary Public. Ms. Haskins, from Campbellsville, Kentucky, was appointed to a six-year term by Governor Ernie Fletcher replacing Kristen Bale whose term had expired. Dr. Robert Dietle was elected by the faculty to serve another three-year term. Ms. Haskins was presented the traditional Regents Pin by President Ransdell.

AGENDA ITEM 4 - Roll Call

The following members were present:

Ms. Katie Dawson
Dr. Robert L. Dietle
Mr. Robert Earl Fischer
Ms. Yvette Haskins
Ms. Lois Gray
Ms. Judi Hughes
Ms. Pat Jordan
Mr. Cornelius A. Martin
Ms. Forrest Roberts
Ms. LaDonna G. Rogers
Mr. Larry Zielke

Others in attendance included: President Gary Ransdell; Ms. Liz Esters, Secretary to the Board of Regents and Staff Assistant to the President; Dr. Barbara Burch, Provost and Vice President for Academic Affairs; Mr. Robert Edwards, Assistant Vice President for University

Relations; Dr. Richard Kirchmeyer, Vice President for Information Technology; Ms. Ann Mead, Chief Financial Officer and Assistant to the President for Economic Development; Ms. Robbin Taylor, Assistant to the President for Governmental Relations; Dr. Gene Tice, Vice President for Student Affairs; Mr. John Osborne, Associate Vice President for Campus Services; Dr. Wood Selig, Athletics Director; and Ms. Deborah Wilkins, General Counsel.

In keeping with the policy of the Board, the agenda for the meeting and information and materials pertinent to items thereon had been mailed in advance of the meeting by the President to members of the Board.

AGENDA ITEM 5 - Special Presentations/Resolution of Appreciation for

Ms. Kristen T. Bale

President Ransdell recognized Bob Adams, Advisor, Student Publications, Shawntaye Hopkins, Editor of the *College Heights Herald*, Katie Clark, Editor of the *Talisman*. Both publications have received the Pacemaker Award. Dr. Ransdell stated, “For years the University has enjoyed incredible success with the Student Publications. Mr. Adams has been the Advisor for Student Publications for many years. This year, both the campus newspaper and the yearbook have won Pacemaker Awards. This is rare for both to have won, although, we have done it in the past; what makes it particularly special is the fact our yearbook went on a seven- or eight-year hiatus and was not published. This award was for the second yearbook once we resumed publication of the *Talisman*.”

Mr. Adams described the Pacemaker Awards as “awarded by the Associated Collegiate Press, one of the two national organizations that most college publications belong to; they have Pacemaker finalists which are a larger group of publications. The national Pacemaker winners are a smaller group—there’s not just one winner; there are several, but it is a great honor to be among the elite publications in the country. This includes all of the universities—it’s not a divisional kind of award. We compete with Indiana and Missouri, North Carolina, etc.; we’re very proud to be included in this group.”

WHEREAS, Ms. Kristen T. Bale, Glasgow, Kentucky, has served as a member of the Board of Regents of Western Kentucky University from July, 1992, to June 30, 2005; and

WHEREAS, Ms. Bale served as Vice Chair from 1998-2000; and as Chair from 2000-2002; and

WHEREAS, this was a transformational period in the life of Western Kentucky University; and

WHEREAS, her term of office was characterized by able leadership, wise counsel, sound business acumen, and faithful service; and

WHEREAS, her loyal service and dedication to her responsibilities have made significant and lasting contributions to the University; and

WHEREAS, Ms. Bale has given unselfishly of her time, energies, and resources to make Western Kentucky University better; and

WHEREAS, such leadership and dedicated efforts are deserving of special recognition;

Therefore be it

RESOLVED, that the Board of Regents of Western Kentucky University in a meeting on November 19, 2005, does hereby express its appreciation to Ms. Kristen T. Bale for her many contributions and for her special Hilltopper enthusiasm and extends best personal wishes for continued success in all her endeavors;

Be it further

RESOLVED, that this resolution be spread upon the minutes and a copy thereof be presented to Ms. Bale as an expression of the esteem in which she is held by members of the Board.

Ordered at Bowling Green, Kentucky, this 19th day of November in the year of our Lord two thousand and five.

Cornelius A. Martin, Chair
Board of Regents

Gary A. Ransdell, President
Western Kentucky University

The above resolution was read by Ms. Gray; Mr. Fischer moved adoption, seconded by Ms. Gray. The motion carried unanimously.

AGENDA ITEM 6 - Disposition of minutes of the special meeting of June 17, 2005, and the regular meeting of July 22, 2005

Motion to approve the June 17 and July 22, 2005, minutes as submitted was made by

Mr. Fischer, seconded by Ms. Jordan, and carried unanimously.

AGENDA ITEM 7 - Committee Reports

7.1 Academic Affairs, Ms. Lois W. Gray, Chair

The Academic Affairs Committee met on October 28, 2005, considered and approved the following:

7.1.1 Approval of new Certificate in Complementary Health Care offered through the Department of Baccalaureate and Graduate Nursing

FACTS : Research demonstrates that a significant majority of Americans use complementary or nontraditional therapies to deal with health issues. The Certificate in Complementary Health Care will provide nursing and other health care practitioners with additional knowledge and skills to provide patient-centered care that incorporates appropriate complementary and nontraditional approaches. Students who complete this program will be eligible to apply for national certification from the American Holistic Nurses Association.

The development of this certificate program is responsive to the University's Strategic Goal 1: Increasing Student Learning by expanding opportunities for students to develop career oriented knowledge and skills.

COST IMPLICATIONS: No new faculty will be needed to support this certificate program. Courses in support of the program will be offered as part of elective alternatives currently available to students.

APPROVED: Academic Affairs Committee, October 28, 2005

RECOMMENDATION: President Ransdell recommends approval of a new Certificate in Complementary Health Care to be offered through the Department of Baccalaureate and Graduate Nursing.

Motion for approval of a new Certificate in Complementary Health Care offered through the Department of Baccalaureate and Graduate Nursing was made by Dr. Dietle, seconded by Ms. Hughes, and carried unanimously.

7.1.2 Approval of a new Certificate in Public Health Nursing offered through the Department of Baccalaureate and Graduate Nursing

FACTS: Some 80 percent of public health nurses in Kentucky hold associate degrees or diplomas and usually they have had minimal formal training in public health nursing. This program is designed for associate degree registered nurses who wish to upgrade their public health nursing skills. Completion of the certificate program will also allow these nurses to move toward completion of baccalaureate (BSN) degrees in nursing. The Kentucky Department of Public Health has established a goal of increasing the number of BSN prepared public health nurses in the state. Fifteen to twenty students are expected to enroll in the program annually. If approved, the certificate program will be submitted to the Kentucky Department of Public Health for endorsement.

The development of this certificate is responsive to the University's Strategic goal 1: Increasing Student Learning; and Strategic Goal 4: Enhancing Responsiveness to Constituents.

COST IMPLICATIONS: Current faculty in the Department of Baccalaureate and Graduate Nursing and the Department of Public Health will teach the courses required for the certificate. If demands warrant in the future, an additional faculty member may be required.

APPROVED: Academic Affairs Committee, October 28, 2005

RECOMMENDATION: President Ransdell recommends approval of a new Certificate in Public Health Nursing offered through the Department of Baccalaureate and Graduate Nursing and the Department of Public Health.

Motion for approval of a Certificate in Public Health Nursing offered through the Department of Baccalaureate and Graduate Nursing and the Department of Public Health was made by Ms. Rogers, seconded by Ms. Jordan, and carried unanimously.

7.1.3 Approval of suspension of the Bachelor of Arts program in Art Education offered through the Department of Art

FACTS: The Bachelor of Arts in Art Education is no longer needed because it overlaps substantially with another program, the Bachelor of Arts in Visual Studies. Both programs have been offered through the Department of Art and the needs of students interested in art education can be met through offering only the Bachelor of Arts in Visual Studies (with a teacher certification concentration) in the future.

COST IMPLICATIONS: Some efficiency should be achieved in department operations through suspension of this program although the Bachelor of Arts in Visual Studies will require continuing support.

APPROVED: Academic Affairs Committee, October 28, 2005

RECOMMENDATION: President Ransdell recommends suspension of the Bachelor of Arts in Art Education program offered through the Department of Art.

Motion for approval of suspension of the Bachelor of Arts in Art Education program offered through the Department of Art was made by Ms. Hughes, seconded by Dr. Dietle, and carried unanimously.

7.1.4 Approval of Honorary Doctorate

This item was withdrawn from the agenda.

7.1.5 Approval of appointment of Faculty Emeritus/a status for recommended faculty members

RECOMMENDATION: President Ransdell recommends approval of Faculty Emeritus/a status for retired faculty members who have been recommended by the tenured faculty, department head, and college dean to be awarded emeritus status. They have served the University for at least ten years and have had distinguished records of achievement and service at the University. Recommended that emeritus/a status be awarded to the following faculty members:

OGDEN COLLEGE OF SCIENCE AND ENGINEERING

Department of Architectural and Manufacturing Sciences

Dr. Frank Conley, Professor of Architectural and Manufacturing Sciences, Emeritus

Dr. T. Norman Tomazic, Associate Professor of Architectural and Manufacturing Sciences, Emeritus

Dr. Frank Pittman, Professor of Architectural and Manufacturing Sciences, Emeritus

Dr. Donald D. Wendt, Professor of Architectural and Manufacturing Sciences, Emeritus

Dr. Edward C. Hein, Professor of Architectural and Manufacturing Sciences, Emeritus

Dr. Robert Eversoll, Professor of Architectural and Manufacturing Sciences, Emeritus

Dr. George D. Roberts, Professor of Architectural and Manufacturing Sciences, Emeritus

Mr. Jeff Crisp, Assistant Professor of Architectural and Manufacturing Sciences, Emeritus

Mr. Howard Lowrey, Assistant Professor of Architectural and Manufacturing Sciences, Emeritus

Department of Biology

Dr. Gary Dillard, Professor of Biology, Emeritus

POTTER COLLEGE OF ARTS, HUMANITIES & SOCIAL SCIENCES

Department of English

Mr. John Reiss, Assistant Professor of English, Emeritus

Department of History

Dr. Richard Stone, Professor of History, Emeritus

Department of Journalism and Broadcasting

Dr. John Barnum, Associate Professor of Journalism and Broadcasting, Emeritus

Department of Philosophy and Religion

Dr. Ronald Veenker, Professor of Philosophy and Religion, Emeritus

Department of Political Science

Dr. John Parker, Professor of Political Science, Emeritus

Dr. Joerg Seitz, Professor of Political Science, Emeritus

Dr. Julius Sloan, Associate Professor of Political Science, Emeritus

COLLEGE OF HEALTH AND HUMAN SERVICES

Department of Physical Education and Recreation

Dr. Charles Daniel, Jr., Professor of Physical Education and Recreation, Emeritus

Dr. William Kummer, Professor of Physical Education and Recreation, Emeritus

Dr. Alton Little, Professor of Physical Education and Recreation, Emeritus

Dr. William Meadors, Professor of Physical Education and Recreation, Emeritus

Dr. Burch Oglesby, Professor of Physical Education and Recreation, Emeritus

APPROVED: Academic Affairs Committee, October 28, 2005

RECOMMENDATION: Approval of Faculty Emeritus/a status for the above-listed retired faculty members who have been recommended by the tenured faculty, department head, and college dean to be awarded emeritus status. They have served the University for at least ten years and have had distinguished records of achievement and service at the University.

Motion for approval of the Faculty Emeritus/a status for the retired faculty members as

recommended was made by Dr. Dietle, seconded by Ms. Jordan, and carried unanimously.

7.1.6 Approval of appointment of Dean Emeritus status for Dr. Robert Jefferson

FACTS: Dr. Robert Jefferson was appointed Dean of the College of Business at Western Kentucky University in 1996 following a distinguished career as business dean at Western Illinois University and Illinois State University. During Dean Jefferson's tenure at Western Kentucky University the College of Business (renamed the Gordon Ford College of Business following a major gift from businessman and alumnus Gordon Ford) has reached its highest ever level of recognition and achievement. Academic programs have been realigned and strengthened, outstanding faculty have been recruited, student enrollments have substantially increased, private donations have grown dramatically, and full undergraduate and graduate accreditation has been achieved under Dean Jefferson's leadership.

Recently, Dean Jefferson announced his plan to fully retire. In recognition of his outstanding contributions to the University he has earned designation as *Dean Emeritus* at Western Kentucky University.

APPROVED: *Academic Affairs Committee, October 28, 2005*

RECOMMENDATION: President Ransdell recommends designation of Dr. Robert Jefferson as *Dean Emeritus* upon his retirement from the University.

Motion for approval of the designation of Dr. Robert Jefferson as *Dean Emeritus* upon his retirement from Western Kentucky University was made by Ms. Jordan; seconded by Ms. Haskins; and carried unanimously.

7.2 Executive Committee, Mr. Cornelius A. Martin, Chair

The Executive Committee met October 28, 2005, considered and approved agenda items 7.2.1 - 7.2.4. Item 7.2.5 has since been added to the agenda.

7.2.1 Approval to name a single floor in the future Academic-Athletic Performance Center at L.T. Smith Stadium Harbaugh Hall in honor of the contributions of the Jack Harbaugh family

BACKGROUND: Jack Harbaugh served as head coach of Hilltopper Football from 1989 through 2002 and became the first coach in Western Kentucky University history to lead a WKU team to a NCAA team championship when his 2002 Toppers won the NCAA I-AA Football National Championship.

Both his tenure (14 seasons) and his total victories (91) rank as the second highest totals in the annals of Hilltopper Football (behind only Jimmy Feix). His teams enjoyed seven straight winning seasons (1996-2002) and made four appearances in the I-AA championship playoffs. His teams won league championships in both the Ohio Valley Conference (2000) and the Gateway Football Conference (2002).

He coached 27 athletes who earned All-America honors a total of 85 times. And, he was named the 2002 American Football Coaches Association National I-AA Coach of the Year. He also earned coach of the year honors in the OVC (2000), among I-AA Independents (1997) and in the AFCA GTE I-AA Region 3 (also in 1997).

Hilltopper Athletics and Western Kentucky University meant more than just a coaching position for Jack Harbaugh. It was a labor of love for the Harbaugh Family. Mrs. Harbaugh (Jackie) was active in assisting with the academic support for Topper athletes and was a regular at her husband's side promoting WKU Football. Their son, Jim Harbaugh, gave generously of his time and financial resources to help support the program. A standout NFL quarterback, Jim Harbaugh assisted with fund-raisers and with arrangements with equipment suppliers to aid the program. In one of the more unique situations in college football history, he served as a volunteer assistant coach on his father's staff from 1993 through 2002, while he was playing professional football.

Jack Harbaugh retired from active coaching after the 2002 season and is now on the athletic director's staff at Marquette University in Milwaukee. Jim Harbaugh is retired from the NFL and is now the head football coach at the University of San Diego.

This naming request is recommended with respect to the Harbaugh family for their outstanding contributions to the University and is a fitting tribute to their support and dedication to Hilltopper Football.

APPROVED: Executive Committee, October 28, 2005

Motion to approve naming the single floor which houses the football office and team

meeting area in the future Academic-Athletic Performance Center at L. T. Smith Stadium

Harbaugh Hall in honor of the contributions of the Jack Harbaugh family to Hilltopper Football

was made by Ms. Gray, seconded by Ms. Haskins, and carried unanimously.

7.2.2 Approval of the naming of the Guthrie Family Overlook and Arboretum in the Van Meter Overlook area as a result of the Lowell Guthrie family gift for the construction of the overlook and arboretum

FACTS: Lowell Guthrie is the CEO of Trace Die Cast, Inc. in Bowling Green. The company funds numerous scholarships through the College Heights Foundation and is a Cherry Society member. In October 1999, Lowell committed over \$2.3 million to provide scholarships and fund construction of a courtyard & bell tower on campus. The bell tower was in honor of his brother, Sgt. 1st Class Robert Guthrie, who was killed in the Korean War. The courtyard is in honor of his wife, Carolyn.

Mr. Guthrie is a graduate of the University of North Alabama. He was named one of Kentucky's Ten Entrepreneurs of the Year in 1992, a second runner-up for the Small Business Person of the Year in 1995, and served as the Chairman of the Bowling Green Area Chamber of Commerce in 1998. Lowell is a past member of the College of Business Advisory Council, Libraries Advisory Council, and Campaign Cabinet, and currently serves on the Board of Advisors for WKU. He and his wife, Carolyn, have four sons - Greg Guthrie, Hon. Brett Guthrie, Chris Guthrie, and Kent Guthrie.

This naming request is recommended with respect to an initial gift of a minimum of \$1.1 million from the Guthrie family. Subsequent gifts from the family will fund the arboretum phase of the project. This commitment coupled with the gift for the Guthrie Bell Tower and Courtyard demonstrates the family's strong affiliation with Western Kentucky University and makes this a fitting tribute for their support and dedication.

APPROVED: Executive Committee, October 28, 2005

Motion for approval of the naming of the *Guthrie Family Overlook and Arboretum* in the

Van Meter overlook area was made by Mr. Fischer, seconded by Ms. Jordan and carried unanimously.

7.2.3 REQUEST: Recommendation for approval of the University's 2006-2012 Six-Year Capital Plan

BACKGROUND: The University is required to submit a 2006-2012 Six-Year Capital Plan, which outlines the University's top priority projects, to the Capital Planning Advisory Board (CPAB) and the Council on Postsecondary Education (CPE) by April 15. The deadline will be met by submitting the attachment, while also notifying both agencies that this plan is preliminary and contingent pending review and approval by the Board of Regents. (**Attachment C**)

The CPAB is comprised of members representing all three branches of government and has a responsibility under KRS Chapter 7A to biennially develop a comprehensive state capital improvements plan and to make funding recommendations for Postsecondary Education to the Governor and the General Assembly for the 2006-2008 biennium.

In the development of the Six-Year Capital Plan, the priorities contained in our Strategic Plan were incorporated, and input was solicited from units across the campus.

The University's priorities were integrated with the capital priorities for higher education as outlined by the CPE. This plan places a focus on restoring the architectural integrity of our campus and emphasizes capital renewal, renovation of existing facilities, and upgrading our campus infrastructure. We believe that our priorities are reflective of and consistent with the direction of postsecondary education in Kentucky.

APPROVED: Executive Committee, April 8, 2005

RECOMMENDATION: The President requests that the Board approve the University's 2006-2012 Six-Year Capital Plan.

Dr. Dietle requested that, "in the future when considering capital projects to not only discuss whether it is going to be a state bond or agency bond or private donations, but that we also consider if it's an agency bond, how we're going to pay for it. I really think that we need to just add that other dimension to our future discussions if we're going to finance things by selling bonds, what are the opportunity costs to the institution when we set money aside to pay for those bonds."

President Ransdell noted that a bond status report will be presented at the January Board meeting.

Motion to approve the attached 2006-2012 Six-Year Capital Plan was made by Ms. Gray, seconded by Ms. Jordan, and carried unanimously.

7.2.4 Approval and authorization to purchase 501 Regents Avenue, Bowling Green, Warren County Kentucky, for the sum of \$105,000

FACTS: This property lies on Regents Avenue, in Bowling Green. There is a single family residence on the property, which is in good condition. The fair market value of the property has been appraised at an amount equal to the purchase price. Acquisition of the property is in keeping with the University's Master Plan and would improve access to and utilization of contiguous property already owned by the University in that area.

It is WKU's intent to complete a private fund raising effort to raise \$1,000,000 in gifts and operating revenue from Student Publications to build a new Student Publications Building to house operations of the College Heights Herald and Talisman.

It is the University's intention to draw upon the University Reserve for payment of the \$105,000.

RECOMMENDATION: The President requests authorization and approval to purchase property located at 501 Regents Avenue for the sum of \$105,000.

APPROVED: Executive Committee, October 28, 2005

Motion to approve and authorize the purchase 501 Regents Avenue, Bowling Green, Warren County, Kentucky, for the sum of \$105,000.

7.2.5 Approval of a resolution to transfer three parcels of property to the City of Bowling Green located on/near 14th Street in order that the City may improve, realign and extend 14th Street

The President requests the Board of Regents approval and authorization to:

1. Transfer three parcels of property to the City of Bowling Green located on / near 14th Street in order that the City may improve, realign, and extend 14th Street, as described in the agenda material (**Attachment A**);
2. To accept ownership of a portion of 14th Street and Center Street which will be closed by the City, including all pedestrian walkways and/or alley ways associated with same (**Attachment B**); and,
3. To accept control of College Heights Blvd. from State Street to the intersection formerly known as the intersection of Center Street and Big Red Way, including all pedestrian walkways and/or alley ways associated with same.

FACTS: The City of Bowling Green desires to improve, realign and extend 14th Street, which will require acquisition of a portion of property now owned by the University, as shown in the agenda material. Related to this project is the University's desire to improve and realign 15th Street (College Heights Boulevard), in order to improve safety and traffic flow. Both projects (the extension of 14th Street and the realignment of 15th Street) are dependent upon each other and the City and the University recognize the mutual benefits to be derived from these two projects.

In addition to the above, the City has indicated it will initiate and take actions necessary to close a portion of 14th Street and Center Street, as shown in the attachment "B." Upon closure of this area, the University will maintain ownership and control of this property.

For and in consideration of the transfer of the 14th Street property and the closure of the remaining portion of 14th Street, the City will take action to transfer ownership and control of College Heights Blvd. from State Street to the former intersection known as Center Street and Big Red Way, as shown in attachment "B," including any pedestrian walkways or alley ways associated with same, and the University will work jointly to initiate any actions required for this transfer, including action by the Bowling Green - Warren County Planning Commission.

Motion by Mr. Zielke, seconded by Ms. Haskins to approve and authorize the President to take any actions necessary to:

1. Transfer three parcels of property to the City of Bowling Green located on/ near 14th Street in order that the City may improve, realign, and extend 14th Street, as described in the agenda material (Attachment A);
2. To accept ownership of a portion of 14th Street and Center Street which will be closed by the City, including all pedestrian walkways and/or alley ways associated with same (Attachment B); and,
3. To accept control of College Heights Blvd. from State Street to the intersection formerly known as the intersection of Center Street and Big Red Way, including all pedestrian walkways and/or alley ways associated with same.

The motion carried unanimously.

7.3 Finance and Budget Committee, Mr. Earl Fischer, Chair

Mr. Fischer reported the Committee met on October 28, 2005, considered and approved the following:

7.3.1 Accept the Accountants' Report and Financial Statements for the fiscal year ending June 30, 2005

FACTS: The financial statements of the University, including Management's Discussion and Analysis, are the responsibility of Western Kentucky University management. The establishment and maintenance of an internal control structure and compliance with laws, regulations, terms, and conditions of grants and contracts also are the responsibility of University management. Western Kentucky University contracts with an independent external auditor. The external auditor provides to the Board of Regents opinions that the financial statements present fairly the financial position of the University; the University has complied with applicable laws and regulations; and the design and operation of the University's internal control structure are effective.

Crowe Chizek and Company, LLC has completed the audit for the fiscal year June 30, 2005. The audit was performed in accordance with generally accepted auditing standards (GAAS). These standards are designed to obtain reasonable, rather than absolute, assurance about the financial statements. In performing GAAS procedures, Crowe Chizek and Company, LLC established scopes of audit tests in relation to the financial statements taken as a whole. The audit does not include a detailed audit of every transaction.

The Accountants' Report and Financial Statements include separate financial statements for the Western Kentucky University Foundation, WKU Student Life Foundation, and College Heights Foundation. Each of these foundations is recognized as "discretely presented component units." Comparative information is included for each component unit.

In conjunction with this audit, Crowe Chizek and Company, LLC prepared the Independent Accountants' Report in Compliance with Specified Requirements of Commonwealth of Kentucky House Bill 622. This state requirement is for an external auditor to express an opinion on the University's compliance with state requirements pertaining to accounting, auditing and payroll procedures; investments and interest income procedures; and purchasing procedures. The Report states that the University is in compliance with the criteria set forth by the Minimum Audit Scope for Compliance with House Bill 622.

The Independent Accountants' Report includes no issues to be addressed by University management.

As required by OMB Circular A-133, a schedule of findings and questioned costs is included with the Annual Financial Report. Crowe Chizek and Company, LLC notes no material weaknesses in internal control over financial reporting. In its Management Comment Letter, the firm made some observations and recommendations regarding internal control and its operation. These comments will be reviewed by management, and a report on these recommendations will be shared with the Finance & Budget Committee in the future.

Representatives of Crowe Chizek and Company, LLC will be at the Board of Regents meeting to answer any questions.

RECOMMENDATION: President Gary Ransdell recommends that the Board of Regents accept the Accountants' Report and Financial Statements for the fiscal year ending June 30, 2005.

Mr. Fischer stated the importance to note that all procedures at the University: accounting, auditing, payroll, etc. have been reviewed by our independent auditor; and in the auditor's report, basically the conclusion is that this report leaves no issues to be addressed by University management. The report states there are no material weaknesses in internal control over financial reporting. Mr. Fischer commented, "It is a very good audit report and one that we would strive for every year."

Motion to accept the Accountants' Report and Financial Statements for the fiscal year

ending June 30, 2005, was made by Mr. Zielke, seconded by Ms. Rogers, and carried unanimously.

7.3.2 Approval of 2005-06 Operating Budget Revisions

FACTS: The proposed revisions to the Western Kentucky University 2004-05 Operating Budget, in the amount of \$5,962,259, are the result of over-realization of revenue and under-expenditures in 2004-05. Technically, the University's authority to expend funds expires on June 30th unless action is taken by the Board of Regents. The 2005-06 Operating Budget includes expenditure authority for \$8,240,000 from carry forward funds from the previous fiscal year. Expenditure authority is being requested for the unbudgeted carry forward funds. Funds will be used for research support, academic awards (departmental and individual), Division of Extended Learning and Outreach (DELO), program enhancements, nonrecurring purchases such as furnishings, equipment, and computers, the Kentucky Building fire alarm system, the Faculty House roof replacement, deferred maintenance projects, Centennial, President's Circle Gala, Sygen chair start-up costs, and Civil War microfilm collection.

<u>Source</u>	<u>Proposed Revision</u>
Educational and General Carry Forward	\$5,962,259
Total	\$5,962,259
<u>Use</u>	
Revenue dependent units and workshops	2,561,044
Academic Affairs	1,650,265
Financial Affairs	7,525
Information Technology	42,827
Student Affairs	3,935
President's Areas	22,261
Deferred maintenance	650,849
Capital projects and Other nonrecurring allocations	1,023,553
Total	\$5,962,259

RECOMMENDATION: President Gary A. Ransdell recommends that the revisions to the Western Kentucky University 2005-06 Operating Budget be approved in order to increase the budget by \$5,962,259.

Motion for approval of the revisions to the 2005-06 Operating Budget was made by

Mr. Zielke, seconded by Ms. Haskins, and carried unanimously.

7.3.3 Acceptance of the First Quarter Statement of Revenues and Expenditures

FACTS: Total realized Educational and General (E&G) revenue, as a percentage of the budget, was slightly higher than the first quarter revenue of 2004-05. This may be attributable to slight variances in collections. State appropriations are distributed on a quarterly basis, but the distribution for each quarter does not represent 25 percent of the total. Restricted revenues and expenditures for grants and contracts were slightly higher than the first quarter revenue of 2004-05, primarily due to the inclusion of additional grant projects. The percent of budget for revenues in Auxiliary Enterprises is higher than

the first quarter revenue of 2004-05, primarily due to some contra-revenue entries that have not yet posted.

The increase in the revised budget for the first quarter of 2005-06 was due to the allocation of net assets to cover accounting requirements relating to the carry forward of encumbrances and balances in grants and contracts. **(Attachment D)**

RECOMMENDATION: President Gary A. Ransdell recommends that the Board of Regents accept for filing the First Quarter Statement of Revenues & Expenditures.

APPROVED: Finance & Budget Committee, October 28, 2005

Motion for acceptance for filing the First Quarter Statement of Revenues & Expenditures was made by Mr. Zielke, seconded by Dr. Dietle, and carried unanimously.

7.3.4 University's Emergency Reserve

As of June 30, 2005, the University's Emergency Reserve was \$1,685,200. The current balance in the Emergency Reserve is \$1,095,000. Changes to the Emergency Reserve are as follows:

June 30, 2005	\$1,685,200
<u>Less:</u>	
SKyPAC Property	1,000,000
1346 and 1350 Kentucky St.	210,000
501 Regents Avenue	105,000
<u>Add:</u>	
Auxiliary Services Reimbursement, FY 05	356,854
Balance of Auxiliary Services	
Reimbursement out of Current Year	243,146
FY 05 Carry Forward Allocated to Reserve	124,800
Current Reserve Balance	\$1,095,000

Mr. Fischer noted that this item was submitted for informational purposes stating, "The administration has done a good job of making sure that the Reserve, while it has been declining, has been put to the uses for which it was designed. Most of the time it's used to acquire property that no one expected to come on the market, but presents an opportunity. The basis of the reserve is for that purpose, and I would also add for unexpected large expenditures. We want to very carefully watch this amount. The Board, several years ago, set \$2 million as the desired reserve fund balance."

Dr. Ransdell commented, "We will recall that we worked hard to address a \$5.2 million state budget cut that was from both non-recurring and recurring sources. We made the decision to meet that mandate in the non-recurring category by drawing on the reserve to meet a portion of that state budget cut requirement. That was the spring of 2004; so we ended the fiscal year 2004

with a reserve that was down to around \$500,000, but we had to do what we had to do; and on a thirty-day window to meet a budget cut. We are rebuilding it back; and from time to time, we will

have properties that we will bring to you, but we do intend to get that back to the \$2 million level.

It may take two fiscal years to get there, but we intend to get that back to the more required level;

and then as the Board contemplates that level; whether it's sufficient or not as the budget grows,

those are future discussions we should have.”

7.4 Student Affairs, Ms. LaDonna Rogers, Chair

Ms. Rogers noted there were no items for approval. Dr. Gene Tice distributed and

discussed the document of benefits which Human Resources prepares yearly for each employee

that also provides a detailed explanation of their salary and benefits. Following a discussion

about employee costs for medical insurance, Mr. Zielke *requested staff to provide comparative*

costs for health care data with other state universities. This will be provided at the January Board meeting.

AGENDA ITEM 8 - Recommendation for approval of personnel recommendations since July 22, 2005

RECOMMENDATION: President Gary Ransdell recommends approval of the personnel actions contained in the next sixteen pages that have transpired since the July 22, 2005, Board meeting.

PERSONNEL CHANGES -- FACULTY

Organization	Employee	Title	Effective Date	End Date	Salary	Proposed Salary	Type Action
Agriculture	Cris Scudder	Visiting Assistant Professor	08/15/2005	06/30/2006		45,000.00	Appointment
Agriculture	John Kesssell	Assistant Professor	01/01/2006			53,676.00	Appointment
Communication Disorders	Jeffrey Barefoot	Instructor	08/15/2005			37,008.00	Appointment
Folk Studies & Anthropology	Bryan McNeil	Visiting Assistant Professor	08/15/2005	06/30/2006		43,008.00	Appointment
Journalism & Broadcasting	Gordon McKerral	Associate Professor	08/15/2005			61,008.00	Appointment
Journalism & Broadcasting	Matthew Robertson	Instructor	08/15/2005	06/30/2006		36,000.00	Appointment
Management	Terry Goodin	Visiting Assistant Professor	08/15/2005	06/30/2006		52,008.00	Appointment
Management	Krist Schell	Instructor	08/15/2005	06/30/2006		50,004.00	Appointment
Marketing	Patricia Todd	Instructor	08/15/2005			77,004.00	Appointment
	w/Doctorate	Assistant Professor				81,204.00	
Music	Sarah Boronow	Visiting Professional-Residence	08/15/2005	06/30/2006		33,000.00	Appointment
Physical Education & Recreation	Andrew Bosak	Assistant Professor	08/15/2005			45,000.00	Appointment
Physical Education & Recreation	Adolfo Ramos	Assistant Professor	08/15/2005			45,000.00	Appointment
Public Health	Dana Bradley	Associate Professor	08/01/2005			76,500.00	Appointment
Public Health	Vijay Golla	Assistant Professor	01/01/2006			52,008.00	Appointment
Associate Degree Nursing Program	Linda Clark	Assistant Professor	07/01/2005			49,044.00	Rehire
Associate Degree Nursing Program	Carol Stowe-Byrd	Instructor	07/01/2005			39,288.00	Rehire
Chemistry	Laura Roberts	Instructor	08/15/2005	06/30/2006		33,000.00	Rehire
Chemistry	Chad Snyder	Visiting Assistant Professor	08/15/2005	06/30/2006		36,504.00	Rehire
Community College	Jean Bobbett	Instructor	08/15/2005	12/31/2005		16,836.00	Rehire
Community College	Yvonne Greenwalt	Instructor	08/15/2005	12/31/2005		16,836.00	Rehire
English	Marya Waters	Instructor	08/15/2005	06/30/2006		33,000.00	Rehire
Geography & Geology	Sara All	Instructor	08/15/2005	06/30/2006		30,000.00	Rehire
Special Instructional Programs	Jane Bowman	Part-Time Faculty	08/17/2005	05/17/2006		13,704.00	Rehire
Special Instructional Programs	Pete Hoechner	Part-Time Faculty	08/17/2005	05/17/2006		13,704.00	Rehire
Special Instructional Programs	Marcus Pedigo	Part-Time Faculty	08/17/2005	05/17/2006		13,704.00	Rehire
Chemistry	Jennifer Thomas	Visiting Assistant Professor	07/01/2005	06/30/2006	33,000.00	38,004.00	Reappointment
Computer Information Systems	John Atkinson	Visiting Assistant Professor	07/01/2005	06/30/2006	62,088.00	64,428.00	Reappointment
Consumer & Family Sciences	Sheila Duncan	Instructor	07/01/2005	06/30/2006	34,020.00	34,704.00	Reappointment
Consumer & Family Sciences	Sheila Flener	Clinical Instructor	07/01/2005	06/30/2006	31,008.00	32,256.00	Reappointment
Consumer & Family Sciences	Tracy Pace	Instructor	07/01/2005	06/30/2006	33,000.00	34,320.00	Reappointment
Economics	Charles Roberts	Part-Time Faculty	07/01/2005	06/30/2006	21,528.00	21,960.00	Reappointment
Management	Jerry Bennett	Visiting Assistant Professor	07/01/2005	06/30/2006	50,004.00	52,008.00	Reappointment
Management	Randall Capps	Visiting Executive-in-Residence	07/01/2005	06/30/2006	30,000.00	30,000.00	Reappointment
Marketing	Melinda Hill	Visiting Executive-in-Residence	07/01/2005	06/30/2006	38,628.00	45,564.00	Reappointment
Marketing	Donald Mellon	Visiting Executive-in-Residence	07/01/2005	06/30/2006	43,812.00	45,564.00	Reappointment
Physics & Astronomy	Christopher Bassey	Visiting Assistant Professor	07/01/2005	06/30/2006	39,216.00	40,008.00	Reappointment

PERSONNEL CHANGES – FACULTY
(continued)

Organization	Employee	Title	Effective Date	End Date	Salary	Proposed Salary	Type Action
Public Health	Jae Kim	Instructor	07/01/2005	06/30/2006	36,336.00	37,776.00	Reappointment
Public Health	Tracey Young	PT Instructor	07/01/2005	06/30/2006	23,628.00	24,570.00	Reappointment
Allied Health	Karen Smarko	Instructor	08/15/2005	06/30/2006	8,808.00	42,000.00	Status Change
Biology	Becky Bartow	Instructor	07/01/2005		32,652.00	34,008.00	Status Change
Chemistry	Buchang Shi	Visiting Assistant Professor	07/01/2005	06/30/2006	17,502.00	37,500.00	Status Change
University College	Sara McCaslin	Instructor	08/15/2005	06/30/2006	19,824.00	31,032.00	Status Change
Sociology	Craig Taylor	Optional Retiree	01/01/2006		52,452.00	19,680.00	Optional Retirement
Communication	Kay Payne	Optional Retiree	07/01/2005		20,760.00	10,380.00	Opt Retirement Chg
Nursing	Sue Bryant	Optional Retiree	07/01/2005		11,268.00	5,640.00	Opt Retirement Chg
Biology	Martin Houston	Optional Retiree	07/01/2005	12/31/2005			Opt Ret, Unpaid Lv
History	Frederick Murphy	Optional Retiree	07/01/2005	06/30/2006			Opt Ret, Unpaid Lv
Accounting	Joel Philhours	Optional Retiree	06/30/2005				Opt Retirement End
Associate Degree Nursing Program	Angela Irvin	Instructor	07/01/2005		37,740.00	38,448.00	Degree
Economics	William Davis	Chair	07/01/2005		74,184.00	90,672.00	Promotion
Marketing	Richard Shannon	Chair	07/01/2005		88,080.00	107,664.00	Promotion
FaCET	Sally Kuhlenschmidt	Director	07/01/2005		71,400.00	75,000.00	Salary Increase FY
Mathematics	Thanh Nguyen	Assistant Professor	07/01/2005		47,448.00	47,652.00	Salary Increase FY
Music	Bill Scott	Professor	07/01/2005		64,296.00	68,448.00	Salary Increase FY
Nursing	Kimberly Botner	Instructor	07/01/2005		34,020.00	39,024.00	Salary Increase FY
Physics & Astronomy	Charles McGruder	Professor, McCormack	07/01/2005		106,776.00	111,000.00	Salary Increase FY
Psychology	William Pfohl	Professor, NASP	07/01/2005	06/30/2006	69,300.00	92,400.00	Salary Increase FY
Social Work	Michelle Blake	Associate Professor	07/01/2005		49,440.00	51,420.00	Salary Increase FY
University Libraries	Nancy Steen	Instructor	07/01/2005		15,324.00	24,036.00	Salary Increase FY
Academic Affairs	Larry Caillouet	Associate Professor	07/01/2005	06/30/2006		300.00/mo	Stipend
Academic Affairs – Quality Enhancement	Doug McElroy	Professor	09/01/2005	06/30/2006		500.00/mo	Stipend
Accounting	Janet Colbert	Professor, Meany	07/01/2005	06/30/2006		1,360.00/mo	Stipend
Accounting	Nace Magner	Professor, Holland	07/01/2005	06/30/2006		1,360.00/mo	Stipend
Agriculture	Jack Rudolph	Interim Department Head	07/01/2005	06/30/2006		500.00/mo	Stipend
Agriculture – University Farm	Jack Rudolph	Interim Department Head	07/01/2005	06/30/2006		832.00/mo	Stipend

PERSONNEL CHANGES – FACULTY
(continued)

Organization	Employee	Title	Effective Date	End Date	Salary	Proposed Salary	Type Action
Allied Health - Dental Hygiene	Lynn Austin	Interim Department Head	07/01/2005	06/30/2006		500.00/mo	Stipend
College of Health & Human Services	Randall Deere	Assistant to the Dean	08/01/2005	06/30/2006		500.00/mo	Stipend
Community College	Sherry Reid	Interim Dean	07/01/2005	09/30/2005		750.00/mo	Stipend
Community College	Sherry Reid	Interim Dean	10/01/2005	06/30/2006		2,000.00/mo	Stipend
Computer Science	Uta Ziegler	Interim Department Head	08/01/2005	05/31/2006		500.00/mo	Stipend
Distance Learning	Robert Wyatt	Director	07/01/2005	06/30/2006		300.00/mo	Stipend
FaCET	Sally Kuhlenschmidt	Director		06/30/2005		300.00/mo	Stipend, End
Finance	Jeff Butterfield	Chair, Lessenberry	07/01/2005	06/30/2006		500.00/mo	Stipend
Finance	Kam Chan	Professor, Page	07/01/2005	06/30/2006		1,500.00/mo	Stipend
Leadership Studies	Cecile Garmon	Interim Coordinator	07/01/2005	06/30/2006		300.00/mo	Stipend
Management	Leo Simpson	Professor, Ford	07/01/2005	06/30/2006		1,500.00/mo	Stipend
Ogden College	Bruce Kessler	Interim Assistant Dean	07/01/2005	06/30/2006		500.00/mo	Stipend
Social Work	Suzie Cashwell	Assistant Professor	09/01/2005	06/30/2006		500.00/mo	Stipend
Women's Studies	Jane Olmsted	Director	07/01/2005	06/30/2006		300.00/mo	Stipend
Nursing	Kimberly Botner	Instructor	07/01/2005	12/31/2005			Unpaid Leave
Computer Science	Uta Ziegler	Interim Department Head	2006-2007 Academic Year				Sabbatical, Change
Physics & Astronomy	Richard Gelderman	Associate Professor	2005 Fall Semester				Sabbatical, Change
Computer Science	Hongyu Guo	Visiting Assistant Professor					Declined Appt
Geography & Geology	Laura McClain	Assistant Professor					Declined Appt
Communication	James Mory	Instructor	06/30/2005				Termination
Communication	Douglas Robertson	Professional-in-Residence	06/30/2005				Termination
Library Technical Services	Kathryn Roe	Assistant Professor	08/26/2005				Termination
Management	Kirk Heriot	Associate Professor	06/30/2005				Termination
Management	Robert Sims	Assistant Professor	06/30/2006				Termination
Management	Robert Wharton	Assistant Professor	06/30/2005				Termination
Psychology	Antony Norman	Professor	08/31/2005				Termination
Public Health	Richard Wilson	Professor	06/30/2005				Termination

PERSONNEL CHANGES - GRANTS

Organization	Employee	Title	Effective Date	End Date	Salary	Proposed Salary	Type Action
Ag Research & Ed Complex - POD	Matthew Futrell	Research Technician	10/03/2005	03/30/2006		28,008.00	Appointment
Biology	Karen Bell	MN Temp PNF 00	08/01/2005	07/30/2006		30,000.00	Appointment
Child Care	Amanda Kelly	BW PT Tech 00	08/15/2005	10/31/2005		10.00	Appointment
College of Health & Human Services	Nelson De La Pena	MN Temp PNF 00	08/01/2005	06/30/2006		30,000.00	Appointment
College of Health & Human Services	Maria Gott	MN Temp PNF 00	08/01/2005	07/31/2006		25,008.00	Appointment
College of Health & Human Services	Juan Gutierrez	MN Temp PNF 00	07/01/2005	06/30/2006		30,008.00	Appointment
College of Health & Human Services	Francisco Palacios	MN Temp PNF 00	08/01/2005	07/31/2006		25,008.00	Appointment
College of Health & Human Services	Jorge Iberico Romero	MN Temp PNF 00	08/15/2005	07/31/2006		28,008.00	Appointment
Educational Enhancement Programs	Kristen Galloway	Academic Coordinator	07/18/2005	08/31/2006		30,960.00	Appointment
Educational Enhancement Programs	Stacy Jessie	Counselor	01/02/2006	08/31/2006		28,500.00	Appointment
Educational Talent Search	Nacole Potts	Counselor	07/12/2005	08/31/2006		26,520.00	Appointment
Materials Characterization - POD	Xin Li	BW PT Temp Tech 00	08/29/2005	09/30/2005		14.00	Appointment
Materials Characterization - POD	Trong Vo	BW PT Temp Tech 00	10/01/2005	12/31/2005		20.77	Appointment
Public Health	Elio Pajares Ruiz	BW PT Clerical 00	08/01/2005	07/31/2006		15.00	Appointment
Public Radio Services	Tiffany McElroy	BW PT Clerical 00	07/21/2005	09/30/2006		7.00	Appointment
Special Instructional Programs	Smit Chauhan	BW PT Clerical 00	09/19/2005	05/15/2006		10.00	Appointment
Training/Technical Assistance Svcs	Lindsay Spence	Teacher	09/19/2005	10/31/2005		28,800.00	Appointment
Institute for Rural Health	Kent Koostra	BW PT Temp Maint 00	07/01/2005	03/01/2007		11.44	Appt, Secondary
Astrophysics & Space Sciences - POD	Kevin Littich	BW PT Tech 00	08/08/2005	12/31/2005		6.25	Rehire
Biodiversity Center Prof Services	Eva Ngulo	BW PT Tech 00	08/29/2005	05/13/2006		16.88	Rehire
Equal Opportunity/504/ADA Comp	Stephanie Lau	BW PT Tech 00	08/29/2005	06/30/2006		35.00	Rehire
Equal Opportunity/504/ADA Comp	Teresa Smith	BW PT Tech 00	08/29/2005	06/30/2006		35.00	Rehire
Equal Opportunity/504/ADA Comp	Valerie Spence	BW PT Tech 00	08/29/2005	06/30/2006		35.00	Rehire
Equal Opportunity/504/ADA Comp	Peggy Wallace	BW PT Tech 00	08/29/2005	06/30/2006		25.00	Rehire
Equal Opportunity/504/ADA Comp	Deborah Ward	BW PT Tech 00	08/29/2005	06/30/2006		35.00	Rehire
Center for Math, Science, & Env Ed	Patricia Sowell	BW PT Clerical 00	07/04/2005	11/11/2005	10.00	10.00	Reappointment
Combustion Lab Center	John Smith	BW PT Temp Tech 00	08/01/2005	09/30/2005	35.00	35.00	Reappointment
Community College	Carla Hinton	MP PT PNF	07/01/2005	06/30/2006	9,474.00	9,758.00	Reappointment
Educational Enhancement Programs	Anna Scott	BW PT Temp Tech 00	07/24/2005	07/23/2006	12.00	12.00	Reappointment
Educational Opportunity Center	Jessica Wood	BW PT Temp Tech 00	08/31/2005	10/01/2005	12.00	12.00	Reappointment
Institute for Rural Health	Sandra Conroy	BW PT Temp Tech 00	07/01/2005	03/01/2007	45.00	45.00	Reappointment
Institute for Rural Health	Bonny Petty	BW PT Temp Tech 00	07/01/2005	03/01/2007	19.47	20.25	Reappointment
Materials Characterization - POD	Chien-Wei Chen	BW PT Temp Tech 00	09/01/2005	01/31/2006	25.96	33.15	Reappointment
Materials Characterization - POD	Hui-Ling Chen	BW PT Temp Tech 00	07/01/2005	12/31/2005	17.31	18.46	Reappointment
Materials Characterization - POD	Stan Herren	BW PT Temp Tech 00	09/01/2005	12/31/2005	20.00	20.00	Reappointment
Materials Characterization - POD	Xin Li	BW PT Temp Tech 00	10/01/2005	12/31/2005	14.00	14.00	Reappointment
Special Instructional Programs	Julie Gee	BW PT Temp Tech 00	08/01/2005	06/01/2006	15.00	15.00	Reappointment

PERSONNEL CHANGES – GRANTS
(continued)

Organization	Employee	Title	Effective Date	End Date	Salary	Proposed Salary	Type Action
Applied Physics Inst - Prof Svc POD	Lindsay Hopper	Research Assistant	08/01/2005	09/30/2005	28,008.00	28,008.00	Reappt/No Sal Inc
Chemistry	Pauline Hack	Laboratory Coordinator	10/01/2005	03/30/2006	33,000.00	33,000.00	Reappt/No Sal Inc
Chemistry	Youhua Ma	BW PT Temp Tech 00	10/01/2005	12/31/2005	20.77	20.77	Reappt/No Sal Inc
Combustion Lab Center Prof Services	Martin Cohron	BW PT Temp Tech 00	10/01/2005	12/31/2005	24.00	24.00	Reappt/No Sal Inc
Combustion Lab Center Prof Services	Jiang Wu	BW PT Tech 00	10/01/2005	12/31/2005	24.23	24.23	Reappt/No Sal Inc
Educational Enhancement Programs	Ashkea Herron	BW PT Clerical 00	06/13/2005	12/13/2005	11.50	11.50	Reappt/No Sal Inc
Educational Enhancement Programs	Shirley Wood	BW PT Clerical 00	10/01/2005	09/30/2006	17.64	17.64	Reappt/No Sal Inc
Educational Telecommunications	Jack Hanes	Director	09/01/2005	09/30/2006	74,208.00	74,208.00	Reappt/No Sal Inc
Geography & Geology	Patricia Kambesis	Research Associate	10/01/2005	03/30/2006	30,804.00	30,804.00	Reappt/No Sal Inc
Materials Characterization - POD	Hong Cui	BW PT Tech 00	10/01/2005	12/31/2005	24.23	24.23	Reappt/No Sal Inc
Materials Characterization - POD	Songgeng Li	BW PT Temp Tech 00	10/01/2005	12/31/2005	23.08	23.08	Reappt/No Sal Inc
Physics & Astronomy	Jonathan Paschal	Computer Specialist	08/01/2005	12/31/2005	35,004.00	35,004.00	Reappt/No Sal Inc
Public Radio Services	Marilyn Greer	Coordinator III	09/01/2005		34,704.00	34,704.00	Reappt/No Sal Inc
Training Projects	Charlene Manco	Director	10/01/2005	08/31/2006	72,084.00	72,084.00	Reappt/No Sal Inc
Training Projects	Janie Ward	Office Assistant	10/01/2005	09/30/2006	23,544.00	23,544.00	Reappt/No Sal Inc
Training/Technical Assistance Svcs	Misela Bulut	BW PT Tech 00	10/01/2005	10/31/2005	9.27	9.27	Reappt/No Sal Inc
Training/Technical Assistance Svcs	Gail Elleby	Management Specialist	09/29/2005	09/28/2006	64,212.00	64,212.00	Reappt/No Sal Inc
Training/Technical Assistance Svcs	Michael Gramling	Training Specialist	09/29/2005	09/28/2006	58,536.00	58,536.00	Reappt/No Sal Inc
Training/Technical Assistance Svcs	Holly Hatcher	Administrative Coordinator	09/29/2005	09/28/2006	32,352.00	32,352.00	Reappt/No Sal Inc
Training/Technical Assistance Svcs	Luis Hernandez	Training Specialist	09/29/2005	09/28/2006	65,604.00	65,604.00	Reappt/No Sal Inc
Training/Technical Assistance Svcs	Linda Reynolds	Teacher	10/01/2005	10/31/2005	18,792.00	18,792.00	Reappt/No Sal Inc
Veterans Upward Bound	Patricia Ault	Office Associate	10/01/2005	06/30/2006	24,216.00	24,216.00	Reappt/No Sal Inc
Veterans Upward Bound	Martha Kenney	Coord, Vet Upward Bound	10/01/2005	06/30/2006	37,896.00	37,896.00	Reappt/No Sal Inc
Veterans Upward Bound	Howard Stone	Adult Ed Spec, Vet Upward Bnd	10/01/2005	06/30/2006	31,812.00	31,812.00	Reappt/No Sal Inc
Veterans Upward Bound	Randal Wilson	Director	10/01/2005	06/30/2006	45,264.00	45,264.00	Reappt/No Sal Inc
Veterans Upward Bound	Cassie Zippay	Adult Ed Spec, Vet Upward Bnd	10/01/2005	06/30/2006	31,860.00	31,860.00	Reappt/No Sal Inc
WATERS Lab	Jana Fattic	Director, Operations	10/01/2005	09/30/2006	40,008.00	40,008.00	Reappt/No Sal Inc
Career Services Center	Karen Schreiner	BW PT Clerical 00	07/01/2005	08/08/2005	13.14	13.67	7/1 Salary Increase
Center for Entrepreneurship	Deborah Burch	Office Associate	07/01/2005	06/30/2006	24,120.00	25,080.00	7/1 Salary Increase
Center for Entrepreneurship	Lynn Minton	Associate Director	07/01/2005	06/30/2006	44,604.00	46,380.00	7/1 Salary Increase
College of Education & Behavioral Sciences	Jeffrey Kimmel	SM Tech 00	07/01/2005	06/30/2006	44,568.00	52,008.00	7/1 Salary Increase
Educational Enhancement Programs	Shirley Wood	BW PT Clerical 00	07/01/2005	06/30/2006	16.96	17.64	7/1 Salary Increase
Educational Telecommunications	Jack Hanes	Director	07/01/2005	08/31/2005	70,008.00	74,208.00	7/1 Salary Increase
Training/Technical Assistance Svcs	Heather Alms	Office Coordinator	07/01/2005	06/30/2006	27,240.00	27,792.00	7/1 Salary Increase
Training/Technical Assistance Svcs	Sheila Combs	Teacher	07/01/2005	06/30/2006	20,712.00	21,336.00	7/1 Salary Increase

PERSONNEL CHANGES – GRANTS
(continued)

Organization	Employee	Title	Effective Date	End Date	Salary	Proposed Salary	Type Action
Training/Technical Assistance Svcs	Sherri Meyer	Child Care Res/Ref Coord	07/01/2005	06/30/2006	39,840.00	40,632.00	7/1 Salary Increase
Training/Technical Assistance Svcs	Jill Norris	Coord/Early Childhood & Health	07/01/2005	06/30/2006	34,848.00	35,556.00	7/1 Salary Increase
Training/Technical Assistance Svcs	Lynne Tucker	Coordinator III	07/01/2005	06/30/2006	38,724.00	39,504.00	7/1 Salary Increase
Chemistry	Sreedevi Dawadi	Research Assistant	09/01/2005	12/31/2005	24,000.00	40,836.00	Salary Increase
Chemistry	Mark O'Brien	BW PT Temp Tech 00	10/01/2005	12/20/2005	9.23	14.00	Salary Increase
Combustion Lab Center Prof Services	Shuang Deng	BW PT Temp Tech 00	10/01/2005	12/31/2005	11.08	20.77	Salary Increase
Combustion Lab Center Prof Services	Yu-Sheng Wang	BW PT Temp Tech 00	10/01/2005	12/31/2005	14.42	20.77	Salary Increase
Combustion Lab Center Prof Services	Jian Zhong Zhu	BW PT Temp Tech 00	07/26/2005	12/31/2005	20.77	23.07	Salary Increase
Educational Television Services	Justin Davis	BW PT Tech 00	09/05/2005	09/30/2006	5.75	6.00	Salary Increase
Educational Television Services	Nicholas Grace	BW PT Tech 00	09/05/2005	09/30/2006	5.75	6.00	Salary Increase
Materials Characterization - POD	Chien-Wei Chen	BW PT Temp Tech 00	07/26/2005	08/31/2005	24.04	25.96	Salary Increase
Biodiversity Center - POD	Ouida Meier	Project Specialist	10/01/2005	09/30/2006	42,972.00	44,688.00	GrantFYSalary Inc
College of Health & Human Services	Donita Lashley	HETC Health Prog Specialist	09/30/2005	06/30/2006	34,320.00	35,688.00	GrantFYSalary Inc
College of Health & Human Services	Glynda Stone	MP PT PNF	09/01/2005	08/31/2006	11,928.00	12,408.00	GrantFYSalary Inc
Psychology	Gayla Cissell	Coordinator III	09/01/2005	08/31/2006	42,876.00	45,024.00	GrantFYSalary Inc
Psychology	Cindy Gaffney	Coordinator	08/01/2005	08/31/2006	30,000.00	31,500.00	GrantFYSalary Inc
Psychology	Tracy Harkins	BW PT Tech 00	08/01/2005	08/31/2006	21,000.00	22,056.00	GrantFYSalary Inc
Psychology	Leslie Plumlee	Research Associate	10/01/2005	09/30/2006	29,736.00	31,224.00	GrantFYSalary Inc
Psychology	Leah Tibbs	Coordinator	08/01/2005	08/31/2006	34,008.00	35,760.00	GrantFYSalary Inc
Small Business Development Center	Richard Horn	Director	10/01/2005	09/30/2006	52,956.00	55,332.00	GrantFYSalary Inc
Water Resource Center - POD	Marsha Wallace	Office Associate	10/01/2005	09/30/2006	24,840.00	25,608.00	GrantFYSalary Inc
WATERS Lab	Richard Fowler	Laboratory Technician	10/01/2005	09/30/2006	36,000.00	37,440.00	GrantFYSalary Inc
Student Support Services	Michael Johnson	Director	07/01/2005	08/31/2006	45,540.00	50,004.00	Promotion
Institute for Rural Health	Staci Simpson	MP PT PNF	07/01/2005	06/30/2006	53,388.00	32,280.00	Status Change
Training Projects	Jennifer Costellow	BW PT Clerical 00	09/07/2005	09/30/2006	29,304.00	15.02	Status Change
Training Projects	Jessica Watts	Training Associate	10/01/2005	06/30/2006	25,608.00	29,304.00	Temp Rate Inc
Training/Technical Assistance Svcs	Krista Williams	Teacher	08/01/2005	10/31/2005	29,664.00	33,864.00	Temp Rate Inc
Ag Research & Ed Complex - POD	Holly Henderson	Research Technician		07/29/2005			Termination
Career Services Center	Karen Schreiner	BW PT Clerical 00		08/08/2005			Termination
Chemistry	Kanglin Wang	BW PT Temp Tech 00		08/19/2005			Termination
Chemistry	Wenyuan Wu	Laboratory Manager		09/15/2005			Termination

PERSONNEL CHANGES – GRANTS
(continued)

Organization	Employee	Title	Effective Date	End Date	Salary	Proposed Salary	Type Action
College of Education & Behavioral Sciences	Inga Wolff	Coordinator III		09/14/2005			Termination
Combustion Lab Center Prof Services	Boshu He	BW PT Temp Tech 00		09/05/2005			Termination
Educational Opportunity Center	Jill Goodman	Counselor		08/19/2005			Termination
Public Radio Services	Imogene Potter	BW PT Clerical 00		07/22/2005			Termination
Training/Technical Assistance Svcs	JaToyri Doolin	Nutrition Associate		08/15/2005			Termination
Training/Technical Assistance Svcs	James Pasley	Training Specialist		10/14/2005			Termination
Training/Technical Assistance Svcs	Debra Strait	Teacher		09/23/2005			Termination

PERSONNEL CHANGES – STAFF

Organization	Employee	Title	Effective Date	End Date	Salary	Proposed Salary	Type Action
Academic Advising	Shawna O'Brien	Office Associate	10/03/2005			20,472.00	Initial Appointment
Academic Advising	Amber Haste	MP PT PNF	08/22/2005			10,000.00	Initial Appointment
Academic Advising	Antonio Smith	MP PT PNF	08/22/2005			10,000.00	Initial Appointment
Academic Advising	Aubrey Videtto	Coordinator II	10/10/2005			36,000.00	Initial Appointment
Admin. Systems and Applications	Joanna Castlen	Application/Prgmr Analyst II	07/25/2005			51,000.00	Initial Appointment
Admin. Systems and Applications	Theodore Eysenbach	Application/Prmgr Analyst II	08/01/2005			48,504.00	Initial Appointment
Admissions Office	Jayne Holloway	Admissions Counselor	10/03/2005			23,208.00	Initial Appointment
Admissions Office	Destiny Smith	FT Temp PNF	09/06/2005	02/05/2006		26,520.00	Initial Appointment
Allied Health	Kathy Donley	BW PT Temp Tech	09/21/2005	05/10/2006		40.00	Initial Appointment
Allied Health	Courtenay Olney	BW PT Temp Tech	09/21/2005	05/10/2006		40.00	Initial Appointment
Allied Health	Tim Whitaker	BW PT Temp Tech	09/21/2005	05/10/2006		40.00	Initial Appointment
Alumni Relations	Jeffrey Baynham	Assistant Director	08/09/2005			36,000.00	Initial Appointment
Associate Degree Nursing Program	Jason Shuffitt	BW PT Tech 00	08/15/2005	05/06/2006		25.00	Initial Appointment
Athletic Facilities	Leslie Forsythe	BW PT Maint 00	08/29/2005			7.00	Initial Appointment
Athletic Facilities	George French	BW PT Maint 00	08/29/2005			7.68	Initial Appointment
Athletic Marketing	Thomas Smith	BW PT Maint 00	08/01/2005	06/30/2006		10.00	Initial Appointment
Athletic Trainer	Ginger South	BW PT Maint 00	08/01/2005	05/31/2006		9.88	Initial Appointment
Bookstore	Nolia Batey	Bookstore Associate	09/06/2005			11.03	Initial Appointment
Bookstore	Catherine Greene	BW PT Clerical 00	08/11/2005			8.50	Initial Appointment
Bookstore	Laura Miller	Bookstore Associate	09/12/2005			10.77	Initial Appointment
Bursar	Angela Link	Billings/Rec Accts Specialist	09/06/2005			22,512.00	Initial Appointment
Campus Services	Anthony Shain	Groundskeeper	08/15/2005			8.13	Initial Appointment
College of Ed & Behavioral Sciences	Alan Cowles	MN Temp PNF 00	07/01/2005	06/30/2006		30,000.00	Initial Appointment
Communication Disorders	Juanita Dunbar	MP PT PNF	07/01/2005	06/30/2006		14,727.00	Initial Appointment
Communication Disorders	Angel Tapia	MP PT PNF	07/01/2005	06/30/2006		14,727.00	Initial Appointment
Community College	Melanie Duvall	BW PT Temp Tech 00	09/26/2005	06/30/2006		10.00	Initial Appointment
Conference Center	Deborah West	BW PT Clerical 00	09/06/2005	09/06/2006		12.00	Initial Appointment
Controller	Linda Smith	Office Assistant	10/17/2005			18,192.00	Initial Appointment
Correspondence Studies Office	Juliana Martins	SM Temp Clerical 00	09/22/2005	08/21/2006		24,000.00	Initial Appointment
Counseling & Testing Center	Emily Averitt	MN Temp PNF 00	10/01/2005	06/30/2006		38,460.00	Initial Appointment
Development	Theresa Clark	Office Associate	07/25/2005			25,512.00	Initial Appointment
Ed. Admin., Leadership & Research	Donna Cooper	Office Associate	08/22/2005			22,008.00	Initial Appointment
Environmental Health & Safety	Janet Hall	Office Associate	07/25/2005			24,000.00	Initial Appointment
Environmental Health & Safety	Roy Long	Fire Safety Technician	08/08/2005			17.43	Initial Appointment
Environmental Health & Safety	Charles Sixbey	Senior Asbestos Inspector	09/07/2005			18.23	Initial Appointment
Extended Campus Library Operations	Susan Clark	BW Lib PT Clerical 00	08/29/2005	10/02/2005		10.00	Initial Appointment
Extended Campus Library Operations	Janet Harbison	BW Lib PT Clerical 00	10/10/2005			10.00	Initial Appointment
Extended Campus-Elizabethtown	Jami Brown	BW PT Tech 00	08/21/2005			7.00	Initial Appointment
Extended Campus-Elizabethtown	Ronda Sullivan	Office Assistant	08/22/2005			21,480.00	Initial Appointment

PERSONNEL CHANGES – STAFF
(continued)

Organization	Employee	Title	Effective Date	End Date	Salary	Proposed Salary	Type Action
Extended Campus-Glasgow	Thomas Gaffin	Technology Specialist	08/08/2005			30,000.00	Initial Appointment
Extended Campus-Owensboro	Rebekah Phillips	Office Associate	08/22/2005			23,016.00	Initial Appointment
Extended Learning & Outreach (DELO)	Jamie Whartenby	Office Associate	08/01/2005			23,016.00	Initial Appointment
Facilities Management	James Fenelon	Group Leader, Bldg Svcs	07/11/2005			19,012.00	Initial Appointment
Facilities Management	William Henson	Landscape Architect	10/03/2005			54,996.00	Initial Appointment
Finance	Doreen Holmes	Office Assistant	07/18/2005			22,200.00	Initial Appointment
Forensics - POD	Jennifer Sullivan	SM Temp Clerical 00	08/08/2005	06/30/2006		23,016.00	Initial Appointment
Geography & Geology	Adam Coffman	Laboratory Manager	08/29/2005	06/30/2006		30,960.00	Initial Appointment
Health & Fitness Lab	Douglas Newton	Manager, Wellness Program	09/26/2005			40,008.00	Initial Appointment
Health Services	Andrea Dudas	Health Educator	08/10/2005			26,004.00	Initial Appointment
Housing & Residence Life	Christy Brewer	Coordinator	07/11/2005			27,000.00	Initial Appointment
Housing & Residence Life	Bethany Ore	Asst Residence Hall Director	07/20/2005			13,080.00	Initial Appointment
Housing & Residence Life	Joisanne Rodgers	Asst Residence Hall Director	07/29/2005			13,080.00	Initial Appointment
Housing & Residence Life	Kellie Scofield	Assistant Director	07/18/2005			43,008.00	Initial Appointment
Housing & Residence Life	Anthony Simms	Asst Residence Hall Director	07/18/2005	06/30/2006		13,008.00	Initial Appointment
Housing & Residence Life	Lamonte Stamps	Asst Residence Hall Director	07/29/2005			13,080.00	Initial Appointment
Housing & Residence Life	Michael Timmer	Asst Residence Hall Director	07/18/2005	06/30/2006		13,008.00	Initial Appointment
Housing & Residence Life	Theresa Yancey	Coordinator, HRL	07/11/2005			27,000.00	Initial Appointment
Intramural/Recreational Sports	Elizabeth Gardner	BW PT Tech 00	08/15/2005	05/12/2006		7.89	Initial Appointment
Intramural/Recreational Sports	Stephen Rey	Director	08/08/2005			68,004.00	Initial Appointment
Intramural/Recreational Sports	Scott Wilson	BW PT Temp Tech	08/15/2005	05/12/2006		7.89	Initial Appointment
IT Capital Projects	Dereck Keeling	BW PT Tech 00	10/10/2005	06/30/2006		15.00	Initial Appointment
IT Help Desk Operations	Jeremy Mosby	Help Desk Consultant	09/26/2005			35,640.00	Initial Appointment
Ky Science & Math Academy	Leigh Johnson	BW PT Clerical 00	08/01/2005	07/31/2006		15.00	Initial Appointment
Men's Basketball	Jeffrey Strohm	Assistant Coach	07/25/2005			70,008.00	Initial Appointment
Parking & Traffic Improvements	Wendi Carr	BW PT Clerical 00	08/29/2005			12.25	Initial Appointment
Parking & Traffic Improvements	Mary Meffert	Customer Svc Representative	09/12/2005			23,496.00	Initial Appointment
Parking & Traffic Improvements	David Roach	Sr Parking Enforcemt Officer	09/12/2005			26,496.00	Initial Appointment
Planning, Design & Construction	Deborah Pace	Field Coordinator/Inspector	09/26/2005			35,508.00	Initial Appointment
Purchasing & Accounts Payable	Kimberly Bradley	Assistant Director	11/01/2005			50,004.00	Initial Appointment
Public Health	Adriene Caton	Office Associate	06/30/2005	06/30/2006		25,008.00	Initial Appointment
Registrar's Office	Rheanna Plemons	Assistant Registrar	07/25/2005			42,504.00	Initial Appointment
Strength & Conditioning	Bradley Ohrt	Head Strength/Cond Coach	08/10/2005			52,008.00	Initial Appointment
Student Activity ,Org & Leadership	Linda Johnson	BW PT Tech 00	08/22/2005			8.00	Initial Appointment
Student Financial Assistance	Ashley Pinson	Financial Aid Assistant	07/01/2005			21,504.00	Initial Appointment
Student Government Association	Kathleen Hennessey	BW PT Clerical 00	08/30/2005			7.50	Initial Appointment

PERSONNEL CHANGES – STAFF
(continued)

Organization	Employee	Title	Effective Date	End Date	Salary	Proposed Salary	Type Action
Swimming	Janelle Atkinson	BW PT Maint 00	09/01/2005			15.61	Initial Appointment
Swimming	Alan Pfau	BW PT Maint 00	09/01/2005			7.80	Initial Appointment
Telecommunications	William McIntyre	Telecommunications Tech	08/15/2005			28,008.00	Initial Appointment
Ticket Manager	Drew Caskey	Asst. Manager, Ticket Sales	09/15/2005			24,000.00	Initial Appointment
University Centers	Heather Campbell	BW PT Maint 00	08/01/2005			8.00	Initial Appointment
University Centers	Kenneth Martin	BW PT Temp Maint 00	08/10/2005	08/10/2006		8.00	Initial Appointment
University Centers	Jamie Riley	Leadership Program Specialist	09/01/2005			27,996.00	Initial Appointment
University Centers	Emily Williams	BW PT Maint 00	08/01/2005			8.00	Initial Appointment
University Centers	Shaneka Wood	BW PT Maint 00	07/18/2005	08/14/2005		8.00	Initial Appointment
University Relations	Charles French	Graphic Artist	07/25/2005			30,000.00	Initial Appointment
WKU Foundation/HAF	Darian Westerfield	Associate Director, HAF	09/19/2005			42,000.00	Initial Appointment
Women's Basketball	Kristina Covington	BW PT Maint 00	06/15/2005			11.37	Initial Appointment
Intramural/Recreational Sports	Scott Wilson	BW PT Temp Tech	09/01/2005	05/12/2006		15.00	Appt, Secondary
Academic Advising	Dianna Marshall	MP PT PNF	08/15/2005	05/15/2006		17,500.00	Rehire
Alumni Relations	Amanda Lich	Assistant Director	08/01/2005			36,000.00	Rehire
Athletic Facilities	Natalie King	BW PT Clerical 00	08/10/2005			11.30	Rehire
Athletic Facilities	Austin Taylor	BW PT Maint 00	08/29/2005			7.68	Rehire
Athletic Trainer	William Steakley	BW PT Temp Tech 00	08/01/2005	05/31/2006		9.88	Rehire
Athletics	Kiesha Lee	BW PT Temp Tech 00	08/01/2005	05/31/2006		9.88	Rehire
Auxiliary Services	Gary Meszaros	Director	08/21/2005			82,500.00	Rehire
Auxiliary Services	Betsy Trogden	BW PT Clerical 00	10/17/2005	07/14/2006		10.00	Rehire
Center for Gifted Studies	Harper Lee	SM Temp Clerical 00	08/26/2005	08/01/2006		23,016.00	Rehire
Controller's Office	James Cummings	Controller	08/08/2005			90,000.00	Rehire
Development	Cynthia Morris	Office Associate	07/20/2005			24,000.00	Rehire
International Programs & Projects	Andrea Ford	Office Associate	09/01/2005			22,512.00	Rehire
Intramural/Recreational Sports	Brandon Basham	BW PT Temp Tech 00	08/15/2005	05/12/2006		7.89	Rehire
Intramural/Recreational Sports	Michael Collins	BW PT Temp Tech 00	08/15/2005	05/12/2006		7.89	Rehire
Intramural/Recreational Sports	Norman Gentry	BW PT Temp Tech 00	08/15/2005	05/12/2006		7.89	Rehire
Men's Basketball	Adeirele Oderinde	Strength/Conditioning Coach	08/29/2005			23,796.00	Rehire
Men's & Women's Swimming	Robert Benson	Assistant Coach	08/01/2005			22,008.00	Rehire
Associate VP for Campus Services	James Somers	BW PT Tech 00	08/01/2005	07/31/2006		27.95	Rehire of Retiree
Event Planning	Cynthia Kimbler	BW PT Clerical 00	08/01/2005	05/31/2006		10.00	Rehire of Retiree

PERSONNEL CHANGES – STAFF
(continued)

Organization	Employee	Title	Effective Date	End Date	Salary	Proposed Salary	Type Action
Gordon Ford College of Business	John Wassom	MP PT PNF 00	07/01/2005	06/30/2006		15,000.00	Rehire of Retiree
Kentucky Library & Museum	Murry Cherry	BW Lib PT Tech 00	10/03/2005			9.00	Rehire of Retiree
Admissions Office	Muhammad R. Tiwana	FT Temp PNF	07/01/2005	07/31/2005		30,000.00	Reappointment
Building Services	Azamina Ibrisevic	BW PT Temp Maint 00	08/07/2005	02/06/2006		6.50	Reappointment
Building Services	Justin Stilts	BW PT Temp Maint 00	09/09/2005	10/09/2005		6.99	Reappointment
Communication Disorders	Edward Sweeney	MP PT PNF	07/01/2005	06/30/2006		14,727.00	Reappointment
Curriculum & Instruction/Action Agenda	Roger Pankratz	MP PT PNF	07/01/2005	06/30/2006		75,192.00	Reappointment
Distance Learning	Leyla Zhuhadar	BW PT Temp Tech 00	09/01/2005	08/31/2006		22.00	Reappointment
Ed. Admin., Leadership & Research	Sharon Windham	Temp Clerical	08/02/2005	08/19/2005		22,008.00	Reappointment
Gifted Studies	Susan Porter	Office Assistant	07/01/2005			19,752.00	Reappointment
Library Special Collections	Alice Gatewood	BW PT Temp Tech 00	09/01/2005	03/01/2006		10.00	Reappointment
Men's Football	Stephen Adams	BW PT Tech 00	09/01/2005			12.54	Reappointment
Men's Football	Stuart Holt	BW PT Tech 00	07/01/2005			17.56	Reappointment
Network Computing & Communications	Mhd Alkhayat	BW PT Temp Tech 00	08/29/2005	12/16/2005	15.00	21.88	Reappointment
Psychology – Alive Center	Cheryl Kirby-Stokes	Director, Alive Center	09/01/2005		41,004.00	43,080.00	Reappointment
University Centers	Peggy Haas	BW PT Maint 00	08/01/2005	05/31/2006		14.40	Reappointment
University Centers	Ricky Murphy	BW PT Temp Maint 00	09/01/2005	09/01/2006	8.00	8.25	Reappointment
University Centers	Tabatha Spain	BW PT Temp Maint 00	10/01/2005	09/30/2006		7.00	Reappointment
Academic Advising	Ellen Bonaguro	Interim Director	07/01/2005	07/31/2005		2,000.00/mo	Status Change
Academic Advising	JaShard Justice	Coordinator	07/01/2005		23,484.00	29,448.00	Status Change
Admissions Office	Muhammad R. Tiwana	Coord, Intl Recruitment	08/01/2005		30,000.00	31,960.00	Status Change
Applied Physics Inst - Prof Svc POD	Lindsay Hopper	BW PT Tech 00	10/01/2005	12/31/2005	28,008.00	14.00	Status Change
Astrophysics & Space Sciences - POD	Robert VanFleet	BW PT Tech 00	08/27/2005	05/15/2006	8.50	8.50	Status Change
Bookstore	Jason Hargis	BW PT Clerical 00	09/01/2005		7.00	8.00	Status Change
Building Services	Azamina Ibrisevic	Building Services Attendant	10/03/2005		6.50	7.50	Status Change
Building Services	Donna Ring	Building Services Attendant	06/27/2005		6.82	7.50	Status Change
Building Services	Susan Minton	Building Services Attendant	06/27/2005		6.82	7.50	Status Change
Building Services	Shawana Hayes	Building Services Attendant	07/01/2005		6.50	7.50	Status Change
Campus Activity Board	Troy Ransdell	BW PT Tech 00	08/21/2005		8.00	8.00	Status Change
Campus Services	Fred Meador	Groundskeeper	08/15/2005		7.25	8.82	Status Change
Desktop Support	Bradley Rodgers	Desktop Support Consultant	09/19/2005		35,160.00	40,800.00	Status Change
Distance Learning	Elizabeth Romero Fuerte	FT Temp PNF	08/16/2005	01/13/2006	15,000.00	37,200.00	Status Change
Extended Learning & Outreach (DELO)	Laura Ricke	Coordinator, Cohort Programs	08/15/2005		27,432.00	32,148.00	Status Change

PERSONNEL CHANGES – STAFF
(continued)

Organization	Employee	Title	Effective Date	End Date	Salary	Proposed Salary	Type Action
Facilities Management	Jacklin Mayfield	Building Services Attendant	10/03/2005		6.50	7.50	Status Change
Farm	Andy Pike	FT Temp Tech	08/29/2005	07/31/2006	12.00	25,008.00	Status Change
Health Services	Terri Cunningham	Office Coordinator	09/06/2005		9.00	27,072.00	Status Change
Housing & Residence Life	Adrien DeLoach	Residence Hall Director	08/11/2005		26,832.00	26,832.00	Status Change
Housing & Residence Life	Aubrey Livingston	Coordinator, HRL	08/01/2005		27,828.00	27,828.00	Status Change
Interactive Video Services	Jason Stella	Coordinator, ITV Tech Svcs	07/18/2005		10.00	36,000.00	Status Change
International Programs	Ryana Severance	International Student Advisor	07/01/2005		26,868.00	30,000.00	Status Change
IT Help Desk Operations	Donald Fox	Help Desk Consultant	09/19/2005		10.00	35,040.00	Status Change
Library Public Services	Robert Harbison	Reference/Periodicals Asst	07/25/2005		10.74	19,512.00	Status Change
Public Health	Shaneka Wood	Office Assistant	08/15/2005		8.00	20,016.00	Status Change
Theatre & Dance	Cattie Brownfield	Supervisor, Costume Shop	09/26/2005		14.55	14.55	Status Change
Track Program	Curtiss Long	Head Coach	07/01/2005		71,040.00	71,040.00	Status Change
Undistributed Housing Expense	Autra Beasley	Building Services Attendant	10/03/2005		6.50	7.50	Status Change
Police	Lisa Brown	Police Officer	09/12/2005		35,280.00	33,672.00	Reassignment
Academic Advising	Carol Alicie	Advising Associate	07/14/2005		20,400.00	24,408.00	Promotion
Academic Advising	Ellen Bonaguro	Director	08/01/2005		51,000.00	75,000.00	Promotion
Academic Affairs	Dawn Bolton	AsstVP Prog Dev/AcRelations	07/01/2005		67,968.00	88,992.00	Promotion
Academic Affairs	Dennis George	AsstVP Institutional Effec.	07/01/2005		76,344.00	97,980.00	Promotion
Admissions Office	April Gaskey	Coord, Admission Services	08/24/2005		28,368.00	32,868.00	Promotion
Admissions Office	LaBrisha Williams	Assistant Director	07/01/2005		33,864.00	45,000.00	Promotion
Building Services	Andreda Burke	Team Leader, Building Svcs	08/22/2005		8.20	9.84	Promotion
Bursar	Brookie Henry	Sr Billings/Rec Accts Spec.	07/18/2005		27,264.00	29,856.00	Promotion
Bursar	Jessica Link	Loan Collections Specialist	10/24/2005		22,584.00	27,120.00	Promotion
Controller	Mary Nunn	Grant Accounts Specialist	08/24/2005		20,472.00	26,160.00	Promotion
Development	Amanda Trabue	Dev Director, BusinessCollege	07/05/2005		35,004.00	45,000.00	Promotion
Distance Learning	Pamela Wilson	Coordinator	06/15/2005		24,408.00	30,960.00	Promotion
Facilities Management	Randy Gillon	Assistant Supv, Painting	08/08/2005		11.59	13.93	Promotion
Facilities Management	Walter Mays	Zone Maintenance Technician	08/22/2005		10.67	11.00	Promotion
Gordon Ford College of Business	Sandra Patterson	Academic Advisor	09/01/2005		24,360.00	25,008.00	Promotion
Health Services	Misty Rich	Coord, Insurance & Billing	08/01/2005		25,608.00	30,000.00	Promotion
Housing & Residence Life	Rachel Barrett	Residence Hall Director	07/01/2005		13,344.00	19,728.00	Promotion
Housing & Residence Life	Brian Powell	Residence Hall Director	07/01/2005		13,344.00	19,728.00	Promotion
Human Resources	Deborah Richardson	Benefit Accounts Associate	08/08/2005		27,060.00	29,520.00	Promotion
International Programs	Carol Porter	Immigration Specialist	07/06/2005		22,464.00	26,544.00	Promotion

PERSONNEL CHANGES – STAFF
(continued)

Organization	Employee	Title	Effective Date	End Date	Salary	Proposed Salary	Type Action
IT Help Desk Operations	Charles Plemons	Coordinator, Help Desk	07/01/2005		40,656.00	47,520.00	Promotion
Men's Football	David Abernethy	Head Strength/Cond Coach	07/01/2005		45,972.00	52,008.00	Promotion
Parking & Traffic Improvements	Virginia Griffin	Manager, Operations	10/15/2005		30,000.00	36,000.00	Promotion
Registrar's Office	Dana Jones	Degree Certification Officer	09/16/2005		25,944.00	28,488.00	Promotion
Registrar's Office	Marsha Wagoner	Degree Certification Officer	09/16/2005		22,512.00	28,488.00	Promotion
Sociology	Vicki Armstrong	Office Associate	07/25/2005		19,176.00	22,800.00	Promotion
Teacher Services	Denise Hardesty	Coord/MinorityTchr Recruitmnt	09/12/2005		33,024.00	34,992.00	Promotion
Academic Affairs	Ladonna Hunton	Mgr, Academic Resources	07/01/2005		54,120.00	58,164.00	Reclassification
Journalism & Broadcasting	Kurt Fattic	Mgr, Photojournalism Lab	07/01/2005		33,432.00	35,436.00	Reclassification
Academic Technology	Masako Barnaby	Coord, Student Computing	07/01/2005		48,000.00	50,880.00	Salary Inc FY
Athletic Facilities	Douglas Simpson	Coordinator II	07/01/2005		29,004.00	31,452.00	Salary Inc FY/Degree
Building Services	Kathy Day	Supervisor, Bldg Svcs	07/01/2005		13.49	14.03	Salary Inc FY
Building Services	Karen Hubbard	Building Services Attendant	07/01/2005		6.82	7.55	Salary Inc FY
Building Services	Steve Martin	Building Services Attendant	07/01/2005		6.82	7.50	Salary Inc FY
Building Services	Wanda McDavitt	Group Leader, Bldg Svcs	07/01/2005		9.78	10.32	Salary Inc FY
Building Services	Janice McDonald	Building Services Attendant	07/01/2005		6.82	7.50	Salary Inc FY
Building Services	Wendy Pillow	Building Services Attendant	07/01/2005		6.82	7.50	Salary Inc FY
Building Services	Raymond Price	Building Services Attendant	07/01/2005		6.82	7.50	Salary Inc FY
Building Services	Jerry Reeves	Building Services Attendant	07/01/2005		6.82	7.50	Salary Inc FY
Bookstore	Wanda Quiggins	Manager, Glasgow Bookstore	07/01/2005		29,460.00	30,636.00	Salary Inc FY
Construction Management	Doris Hayes	Construction Coordinator	07/01/2005		30,000.00	31,224.00	Salary Inc FY
Extended Learning & Outreach (DELO)	Donald Swoboda	Dean	07/01/2005		117,708.00	118,668.00	Salary Inc FY
Facilities Management	Melinda Bailey	Building Services Attendant	07/01/2005		6.82	7.50	Salary Inc FY
Facilities Management	Tracy Barnett	Building Services Attendant	07/01/2005		6.82	7.50	Salary Inc FY
Facilities Management	Jan Bond	Building Services Attendant	07/01/2005		6.82	7.50	Salary Inc FY
Facilities Management	Albert Brown	Building Services Attendant	07/01/2005		6.82	7.50	Salary Inc FY
Facilities Management	Christopher Burch	Coord, Facility Services	07/01/2005		17.35	18.39	Salary Inc FY
Facilities Management	Perry Burns	Building Services Attendant	07/01/2005		6.82	7.50	Salary Inc FY
Facilities Management	Paul Davidson	Building Services Attendant	07/01/2005		7.10	7.50	Salary Inc FY
Facilities Management	Daniel Hall	Building Services Attendant	07/01/2005		6.82	7.50	Salary Inc FY
Facilities Management	John Huffman	Building Services Attendant	07/01/2005		6.82	7.50	Salary Inc FY
Facilities Management	Christine Johnson	Building Services Attendant	07/01/2005		6.82	7.50	Salary Inc FY
Facilities Management	Lakesha Sarver	Building Services Attendant	07/01/2005		6.82	7.50	Salary Inc FY
Facilities Management	Michell Southeard	Building Services Attendant	07/01/2005		6.82	7.50	Salary Inc FY

PERSONNEL CHANGES – STAFF
(continued)

Organization	Employee	Title	Effective Date	End Date	Salary	Proposed Salary	Type Action
HVAC Services	Marshall Smith	HVAC Tech	07/01/2005		13.50	14.04	Salary Inc FY
Library Special Collections	Lynne Ferguson	Artist-in-Residence	07/01/2005		33,132.00	34,440.00	Salary Inc FY
Maintenance Services	David Blankenship	Maintenance Tech	07/01/2005		13.52	14.06	Salary Inc FY
Men's Basketball	Cypheus Bunton	Assistant Coach	07/01/2005		41,604.00	45,000.00	Salary Inc FY
Men's Basketball	Paul Sanderford	Assistant Coach	07/01/2005		64,272.00	75,276.00	Salary Inc FY
Men's Football	Michael Chism	BW PT Maint 00	07/01/2005		24,000.00	27,000.00	Salary Inc FY
Men's Football	Kevin Dawson	Coordinator, Football Op	07/01/2005		21,336.00	25,500.00	Salary Inc FY
Men's Football	Michael Dietzel	Defensive Coordinator	07/01/2005		56,772.00	60,000.00	Salary Inc FY
Men's Football	Willie Taggart	Assistant Head Coach	07/01/2005		48,624.00	50,004.00	Salary Inc FY
Men's Football	Terry Weist	Offensive Coordinator	07/01/2005		56,772.00	60,000.00	Salary Inc FY
Men's Football	Walter Wells	Assistant Coach	07/01/2005		40,620.00	50,004.00	Salary Inc FY
University Centers	Anthony Elliott	BW PT Temp Maint	08/15/2005	08/15/2006	5.90	6.00	Salary Inc FY
University Libraries	Jayne Pelaski	Coordinator, Outreach	07/01/2005		36,000.00	40,728.00	Salary Inc FY
Police	Joshua Toomey	Police Officer	09/19/2005		28,392.00	31,488.00	Salary Increase KLEF
University Centers	Alison Brown	BW PT Maint 00	07/01/2005		8.00	8.25	FiscalYrHrlyRateInc
Athletic Facilities	Allan Craig Biggs	Assistant Director	07/01/2005		45,504.00	46,212.00	Degree/Certification
Extended Learning & Outreach (DELO)	Roberta Sue Parrigin	Manager, Conference Ctr	09/30/2005			300.00/Lump Sum	Degree/Certification
Facilities Management	William Stewart	Zone Maintenance Tech	08/01/2005			300.00/Lump Sum	Degree/Certification
Housing & Residence Life	Lisa Cook	Office Coordinator	09/15/2005			500.00/Lump Sum	Degree/Certification
Housing & Residence Life	Benjamin Ellis	Residence Hall Director	09/30/2005			700.00/Lump Sum	Degree/Certification
Intramural/Recreational Sports	Gail Murray	Office Associate	09/01/2005		26,712.00	27,216.00	Degree/Certification
Library Special Collections	Lynne Ferguson	Artist-in-Residence	10/31/2005			700.00/Lump Sum	Degree/Certification
Student Financial Assistance	Lois Tidwell	Financial Aid Coordinator	07/01/2005		30,552.00	31,056.00	Degree/Certification
WKU Foundation	Heather Pruitt	Accounts Associate	09/01/2005		24,888.00	25,392.00	Degree/Certification
Women's Basketball	Mary Taylor Cowles	Head Athletic Coach	07/01/2005		109,200.00	109,908.00	Degree/Certification
Women's Softball	Shanon Searle	Assistant Coach	09/01/2005		26,652.00	27,360.00	Degree/Certification
Athletics - HAF	Camden Selig	Stipend, WKU Foundation	07/01/2005	06/30/2006		625.00/mo	Stipend
Career Services Center	Carol White	Stipend, Interim Head	09/01/2005	10/31/2005		500.00/mo	Stipend
Extended Learning-Academic Quality	Elizabeth Laves	Stipend, Assistant to the Dean	09/01/2005	06/30/2006		250.00/mo	Stipend
Libraries - Centennial	Jayne Pelaski	Stipend, Centennial	07/01/2005	06/30/2006		500.00/mo	Stipend

PERSONNEL CHANGES – STAFF
(continued)

Organization	Employee	Title	Effective Date	End Date	Salary	Proposed Salary	Type Action
Men's Football	Michael Dietzel	Stipend, Men's Football	07/01/2005	06/30/2006		275.00/mo	Stipend
Men's Football	Stuart Holt	Stipend, Men's Football	09/01/2005	06/30/2006		275.00/mo	Stipend
Men's Football	Cary Marquell	Stipend, Men's Football	07/01/2005	06/30/2006		275.00/mo	Stipend
Men's Football	Eric Mathies	Stipend, Men's Football	07/01/2005	06/30/2006		275.00/mo	Stipend
Men's Football	Willie Taggart	Stipend, Men's Football	07/01/2005	06/30/2006		275.00/mo	Stipend
Men's Football	Terry Weist	Stipend, Men's Football	07/01/2005	06/30/2006		275.00/mo	Stipend
Men's Football	Walter Wells	Stipend, Men's Football	07/01/2005	06/30/2006		275.00/mo	Stipend
Purchasing	Maxine Hardin	Stipend, Chief Buyer	06/10/2005	08/10/2005		500.00/mo	Stipend
Academic Technology	David Copus	Lab Systems Specialist	07/01/2005	09/30/2005	44,676.00	47,088.00	Temporary Rate Inc
Bursar	Deirdre Lawless	Receivables Specialist	08/01/2005	09/30/2005	23,904.00	28,416.00	Temporary Rate Inc
Bursar	Jessica Link	Accounts Associate	09/01/2005	09/30/2005	22,584.00	28,584.00	Temporary Rate Inc
Career Services Center	Jaime Ritter	Office Assistant	08/01/2005	06/30/2006	20,328.00	24,072.00	Temporary Rate Inc
Financial Affairs – Business Accelerator	Carolyn Green	Administrative Assistant	07/01/2005	06/30/2006	35,520.00	38,520.00	Temporary Rate Inc
Registrar's Office	Cheryl Whitfield	Degree Certification Officer	08/15/2005	12/31/2005	30,336.00	35,352.00	Temporary Rate Inc
Swimming	Alan Pfau	BW PT Maint 00	10/01/2005	06/30/2006	7.80	11.70	Temporary Rate Inc
Student Affairs & Campus Services	Donna Gregory	Coord, Assessment/Planning	10/01/2005				Title Change
Admin. Systems and Applications	Jonathan Davis	Systems Administrator II	08/01/2005		47,352.00	50,040.00	Transfer
Building Services	Stacy Boehmer	Building Services Attendant	08/01/2005		7.52	7.52	Transfer
Building Services	Beverly Pruett	Building Services Attendant	08/01/2005		10.82	9.22	Transfer
Intramural/Recreational Sports	Rebecca Sims	Office Associate	10/03/2005		22,440.00	25,008.00	Transfer
Building Services	Redea Simmons	Team Leader, Bldg Svcs		07/31/2005			Retirement
Campus Services	Royce Dethridge	Supervisor, Landscaping		07/31/2005			Retirement
Career Services Center	Judith Owen	Director		08/31/2005			Retirement
Career Services Center	James Robert Somers	Associate Director		07/31/2005			Retirement
Library Public Services	Sarah Louise Pruitt	Library Facilities Specialist		09/30/2004			Retirement
Facilities Management	Margo Ramsey	Zone Maintenance Technician		06/24/2005			Death
Academic Technology	Bikramjeet Assal	Database Specialist		07/05/2005			Termination
Agriculture	John Tako	Manager, Dairy Herd		09/05/2005			Termination
Baseball	Nathan Murrie	BW Temp Maint 00		06/30/2005			Termination
Bookstore	Sherry Blanton	Bookstore Associate		08/31/2005			Termination

PERSONNEL CHANGES – STAFF
(continued)

Organization	Employee	Title	Effective Date	End Date	Salary	Proposed Salary	Type Action
Bookstore	Karen Zeibak	Bookstore Associate		07/22/2005			Termination
Building Services	Paul Davidson	Building Services Attendant		08/19/2005			Termination
Building Services	Dana Dennis	Building Services Attendant		08/30/2005			Termination
Building Services	Daniel Holloway	Building Services Attendant		08/21/2005			Termination
Building Services	Wendy Pillow	Building Services Attendant		08/07/2005			Termination
Building Services	Donna Ring	Building Services Attendant		09/09/2005			Termination
Building Services	Kevin Thomas	Building Services Attendant		09/05/2005			Termination
Bursar	Monica Rector	Loan Collections Specialist		07/29/2005			Termination
Center for Gifted Studies	Susan Porter	Office Assistant		08/12/2005			Termination
Dean Graduate Study	Robin Fulkerson	Specialist, Graduate Studies		10/21/2005			Termination
Distance Learning	Jeanne Garrett	BW PT Tech 00		08/04/2005			Termination
Extended Campus-Glasgow	Micah Lunsford	BW PT Tech 00		08/04/2005			Termination
Geography & Geology	Dennis Roach	Laboratory Manager		07/31/2005			Termination
Health Services	Deborah Baize	Medical Insurance Associate		10/21/2005			Termination
Health Services	Lesia Hartley	BW PT Tech 00		07/13/2005			Termination
Housing & Residence Life	Panida V-Vahrinth	BW PT Maint 00		08/26/2005			Termination
Human Resources	Racheal Rigsby	Benefit Accounts Associate		07/29/2005			Termination
Interactive Video Services	Amity Creech	BW PT Tech 00		08/01/2005			Termination
Intramural/Recreational Sports	Debra Cherwak	Director		08/15/2005			Termination
Men's Football	David Abernethy	Head Strength/Cond Coach		07/15/2005			Termination
Men's Football	Keith Caton	Strength/Conditioning Coach		08/19/2005			Termination
Parking & Transportation	Richard White	Shuttle Bus Operator		09/13/2005			Termination
Registrar's Office	Phoebe Jones	Sr Degree Certification Officer		08/15/2005			Termination
Swimming	Janelle Atkinson	BW PT Maint 00		09/30/2005			Termination
Telecommunications	Sonya Gray	Telephone Support Associate		08/19/2005			Termination
Ticket Manager	Scott Brannan	Asst. Manager, Ticket Sales		07/29/2005			Termination
University College	Mark May	Director, Freshman Experience		08/04/2005			Termination
University Centers	Jeremy Phillips	BW PT Maint 00		08/21/2005			Termination
University Centers	Jeremiah Lawson	BW PT Maint 00		07/25/2005			Termination
University Centers	Magan McFadden	BW PT Maint 00		07/25/2005			Termination

Motion for approval of the recommended personnel actions was made by Ms. Jordan, seconded by Dr. Dietle, and carried unanimously.

AGENDA ITEM 9 - Approval of a quarterly meeting schedule for 2006 and a 2006 schedule for Board committee meetings

RECOMMENDATION:

President Gary A. Ransdell recommends consideration of the following:

- 1) adoption of the quarterly meeting schedule for 2006:

First Quarterly Meeting January 17-18, 2006 (Frankfort)

Second Quarterly Meeting ~~April 14, 2006~~

Third Quarterly Meeting July 21, 2006

Fourth Quarterly Meeting October 27, 2006

- 2) adoption of the Board Committee meeting schedule for 2006:

March 10, 2006

June 2, 2006

September 29, 2006

The Board discussed the fact that the proposed second quarterly meeting was Good Friday and requested that another date be designated for the second quarterly meeting.

Motion for approval was made by Ms. Haskins, seconded by Ms. Hughes, and carried..

AGENDA ITEM 10 - President's Report

President's Report consisted of the following:

10.1.1 Final Enrollment Numbers - Fall 2005 final enrollment figures were provided to the Board. A copy of the report is filed in the Board's official files.

Dr. Ransdell reviewed the fall enrollment numbers as highlighted in a report provided to the Board and filed in the Board's official files.

10.1.2 Proposed Higher Education Budget - The Postsecondary Education Budget Recommendation for 2006-08 was distributed to the Board, Dr. Ransdell reviewed the summary. A copy is filed in the Board's official files.

10.1.3 Construction Projects Update - John Osborne provided the Board with a Capital Construction Project Status Report. That report is filed in the Board's official files.

10.1.4 2006 Legislative Priorities - Priorities for the 2006 General Assembly were distributed and discussed by Robbin Taylor, Assistant to the President for Governmental Relations. A copy is filed in the Board's official files.

AGENDA ITEM 11 - Other Business

In conjunction with Western Kentucky Univeristy's Centennial Kick-off, former Chairs of the Board of Regents were recognized for their leadership. Each of the following former

Board Chairs were presented with a replica of the "A Century of Leadership" plaque that is displayed in front of Ivan Wilson Fine Arts Center on the Colonnade:

Mr. John David Cole	1976-1981
Mr. Joseph Iracane	1984-1992
Mr. Burns E. Mercer	1992-1994
Mr. Robert Earl Fischer	1994-1996
Ms. Peggy W. Loafman	1996-1998
Mr. Cornelius A. Martin	1998-2000 2002-2004
Ms. Kristen Bale	2000-2002

Mr. Joe Bill Campbell, who served as Chair from 1982-1984, was unable to attend for medical reasons.

AGENDA ITEM 12 - Adjournment

With no further business on the agenda, motion for adjournment was made by Mr. Fischer, seconded by Ms. Rogers, and the meeting adjourned at approximately 12:05.

CERTIFICATION OF SECRETARY

I hereby certify that the minutes herein above set forth an accurate record of votes and actions taken by the Board of Regents of Western Kentucky University in the fourth quarterly meeting held November 19, 2005, in the Cornelius A. Martin Regents Room in the Mass Media and Technology Hall on the Western campus, and further certify that the meeting was held in compliance with KRS 61.810, 61.815, 61.820, and 61.825 (enacted as Sections 2, 3, 4 and 5 of House Bill 100, 1974 Regular Session, General Assembly).

Elizabeth W. Esters, Secretary

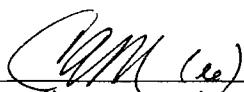
Cornelius A. Martin
Chair
January 18, 2006

Elizabeth W. Esters
Secretary
January 18, 2006

ATTACHMENT A

Tract No. 1

LAND DESCRIPTION OF A RIGHT-OF-WAY TRACT of a 241.9 square foot/0.006 acre more or less, tract of the lands of the Commonwealth of Kentucky for the use of Western Kentucky State College (Deed Book 350, Page 420), located in the southern section of City of Bowling Green, Kentucky about 0.53 Miles southwest of the Courthouse in Bowling Green, Warren County, Kentucky; from an actual survey and I hereby certify the Metes and Bounds description of said right-of-way tract is as follows:

Beginning at a set ½" steel rebar corner monument; with a 1" yellow plastic cap stamped JD Pedigo PLS 2933 (unless otherwise noted, all set steel pin rebar called out in this description are ½" x 18" rebar with a 1" yellow plastic cap stamped JD Pedigo PLS 2933), a new boundary corner of the subject tract and new boundary corner to said The Commonwealth of Kentucky for the use of Western Kentucky State College (Deed Book 350, Page 420) and also being a corner in the existing 45 foot right-of-way of said Fourteenth Avenue, said point being referenced South 85 degrees 04 minutes 21 seconds East, 249.38 feet from the Right-of-Way of Center Street and South 51 degrees 49 minutes 10 seconds East, 82.70 feet from a set steel rebar corner monument on the southwest boundary corner of Tract A2, about 0.53 miles southwest of the Courthouse in Bowling Green, Warren County, Kentucky, thence with two lines along the Right-of-Way of existing Fourteenth Avenue, South 85 degrees 04 minutes 21 seconds East, 12.80 feet to a chiseled "X" corner monument, (passing through a found steel pin reference with a 1" orange plastic cap stamped REF. POINT KY PLS 2933 at 2.80 feet), thence South 38 degrees 56 minutes 22 seconds East, 26.47 feet to a found steel rebar corner monument with a 1" yellow plastic cap stamped JD Pedigo PLS 2933, on a corner of the subject tract and on the southwestern Right-of-Way line of said existing Fourteenth Avenue and on the northwestern Right-of-Way line of a 20 foot Alley, thence along the northwestern Right-of-Way line of said Alley, South 50 degrees 41 minutes 09 seconds West, 7.50 feet to a set ½" steel rebar corner monument; on a corner of the subject tract and the northwestern Right-of-Way line of said foot Alley, thence severing the subject tract with a two (2) new lines North 38 degrees 56 minutes 22 seconds West, 4.86 feet to a set ½" steel rebar corner monument; thence with an arc of a curve to the left, arc length 30.60 feet, delta angle 06 degrees 29 minutes 34 seconds (left), radius 270.00 feet with a chord bearing and distance of North 42 degrees 11 minutes 09 seconds West, 30.58 feet to the point of beginning containing 241.9 square feet/0.006 acres more or less according to a survey made in September, 2005 by *DDS ENGINEERING, PLLC, James D. Pedigo II, KY PLS 2933*, Reggie Ramsey and Scott McFarland; subject to any and all existing rights-of-ways and easements and all bearings being referenced to Grid North.

Being the same property conveyed to the Commonwealth of Kentucky for the use and benefit of Western Kentucky University by deed of record in Deed Book 350, Page 420 as recorded in the Office of the Clerk of the Warren County Court.

Tract No. 2

LAND DESCRIPTION OF A RIGHT-OF-WAY TRACT of a 12,574.9 square foot/0.289 acre more or less, tract of the lands of Western Kentucky University (Deed Book 908, Page 35, Parcel 3 Tracts 1 and 2), located in the southern section of City of Bowling Green, Kentucky about 0.51 Miles southwest of the Courthouse in Bowling Green, Warren County, Kentucky; from an actual survey and I hereby certify the Metes and Bounds description of said right-of-way tract is as follows:

Beginning at a set ½" steel rebar corner monument; with a 1" yellow plastic cap stamped JD Pedigo PLS 2933 (unless otherwise noted, all set steel pin rebar called out in this description are ½" x 18" rebar with a 1" yellow plastic cap stamped JD Pedigo PLS 2933), on a new boundary corner of the subject tract and new boundary corner of said Western Kentucky University (Deed Book 908, Page 35 parcel 3, tract 2) and on the northwestern 50 foot Right-of-Way line of existing Center Street, said point being referenced North 51 degrees 08 minutes 57 seconds East, 114.52 feet from the Right-of-Way of existing Fourteenth Avenue, and North 45 degrees 26 minutes 42 seconds West, 50.33 feet from a set steel rebar corner monument on the southwest boundary corner of Tract A2, about 0.51 miles southwest of the Courthouse in Bowling Green, Warren County, Kentucky, thence severing the subject tract with a new line, North 39 degrees 03 minutes 55 seconds West, 209.16 feet to a set steel rebar corner monument, on a new corner of the subject tract and new boundary corner of said Western Kentucky University (Deed Book 908, Page 35 parcel 3, tract 2), and on the southeastern Right-of-Way line of an alley and being referenced South 39 degrees 03 minutes 55 seconds East, 24.33 feet from a set steel rebar corner monument on the southwest boundary corner of Tract C1, thence along said alley, North 50 degrees 21 minutes 06 seconds East, 60.00 feet to a found steel rebar corner monument; with a 1" yellow plastic cap stamped JD Pedigo PLS 2933, on a corner of the subject tract and a boundary corner of Steven Downey (Deed Book 777, Page 222) and on the southeastern Right-of-Way line of said alley; thence along the boundary of said Downey, South 39 degrees 03 minutes 55 seconds East, 210.00 feet to a found steel rebar corner monument; with a 1" yellow plastic cap stamped DDS PLS 2062, on a corner of the subject tract and a boundary corner of said Downey and on the northwestern 50 foot Right-of-Way line of existing Center Street, thence along the northwestern Right-of-Way line of said Center Street, South 51 degrees 08 minutes 57 seconds West, 60.00 feet to the point of beginning containing 12,574.9 square feet/0.289 acres more or less according to a survey made in September, 2005 by **DDS ENGINEERING, PLLC, James D. Pedigo II, KY PLS 2933**, Reggie Ramsey and Scott McFarland; subject to any and all existing rights-of-ways and easements and all bearings being referenced to Grid North.

Being the same property conveyed to Western Kentucky University by deed of record in Deed Book 908, Page 35, Parcel 3, Tracts 1 and 2 as recorded in the Office of the Clerk of the Warren County Court.

Tract 3

LAND DESCRIPTION OF A RIGHT-OF-WAY TRACT of a 12,005.2 square foot/0.276 acre more or less, tract of the lands of Western Kentucky University (Deed Book 908, Page 35, Parcels 4 and 5), located in the southern section of City of Bowling Green, Kentucky about 0.61 Miles southwest of the Courthouse in Bowling Green, Warren County, Kentucky; from an actual survey and I hereby certify the Metes and Bounds description of said right-of-way tract is as follows:

Beginning at a set ½" steel rebar corner monument; with a 1" yellow plastic cap stamped JD Pedigo PLS 2933 (unless otherwise noted, all set steel pin rebar called out in this description are ½" x 18" rebar with a 1" yellow plastic cap stamped JD Pedigo PLS 2933), on a new boundary corner of the subject tract and new boundary corner of said Western Kentucky University (Deed Book 908, Page 35, Parcel 5) and on the southeastern 40 foot Right-of-Way line of existing Kentucky Street, said point being referenced North 57 degrees 11 minutes 47 seconds East, 284.77 feet from the intersection of Kentucky Street and Fourteenth Avenue, about 0.61 miles southwest of the Courthouse in Bowling Green, Warren County, Kentucky, thence along the southeastern Right-of-Way line of said existing Kentucky Street, North 52 degrees 09 minutes 33 seconds East, 60.01 feet to a set steel rebar corner monument, on a new corner of the subject tract and new boundary corner of said Western Kentucky University (Deed Book 908, Page 35, Parcel 4), and on the southeastern Right-of-Way line of said Kentucky Street; thence severing the lands of said Western Kentucky University (Parcel 4), South 39 degrees 03 minutes 55 seconds East, 204.38 feet to a set ½" steel rebar corner monument, on a new corner of the subject tract and new boundary corner of said Western Kentucky University and on the northeastern Right-of-Way line of an alley; and being referenced North 39 degrees 03 minutes 55 seconds West, 12.44 feet from a found steel rebar corner monument; with a 1" yellow plastic cap stamped JD Pedigo PLS 2933 on the northeastern boundary corner of Tract B1, thence along the right-of-way of said alley South 52 degrees 09 minutes 33 seconds West, 34.31 feet to a found steel rebar corner monument; with a 1" yellow plastic cap stamped JD Pedigo PLS 2933, thence North 38 degrees 05 minutes 14 seconds West, 10.00 feet to a found steel rebar corner monument; with a 1" yellow plastic cap stamped JD Pedigo PLS 2933, thence South 52 degrees 09 minutes 33 seconds West, 25.87 feet to a set ½" steel rebar corner monument; on a new corner of the subject tract and new boundary corner of said Western Kentucky University (Deed Book 908, Page 35, Parcel 5) and on the northeastern Right-of-Way line of said alley; and being referenced North 39 degrees 03 minutes 55 seconds West,

24.33 feet from a set steel rebar corner monument; with a 1" yellow plastic cap stamped JD Pedigo PLS 2933 on the northwestern boundary corner of Tract B1, thence severing the lands of said Western Kentucky University (parcel 5), North 39 degrees 03 minutes 55 seconds West, 194.38 feet to the point of beginning containing 12,005.2 square feet/0.276 acres more or less according to a survey made in September, 2005 by **DDS ENGINEERING, PLLC, James D. Pedigo II, KY PLS 2933**, Reggie Ramsey and Scott McFarland; subject to any and all existing rights-of-ways and easements and all bearings being referenced to Grid North.

Being a portion of the same property conveyed to Western Kentucky University by deed of record in Deed Book 908, Page 35, Parcels 4 and 5 as recorded in the Office of the Clerk of the Warren County Court.

ATTACHMENT B

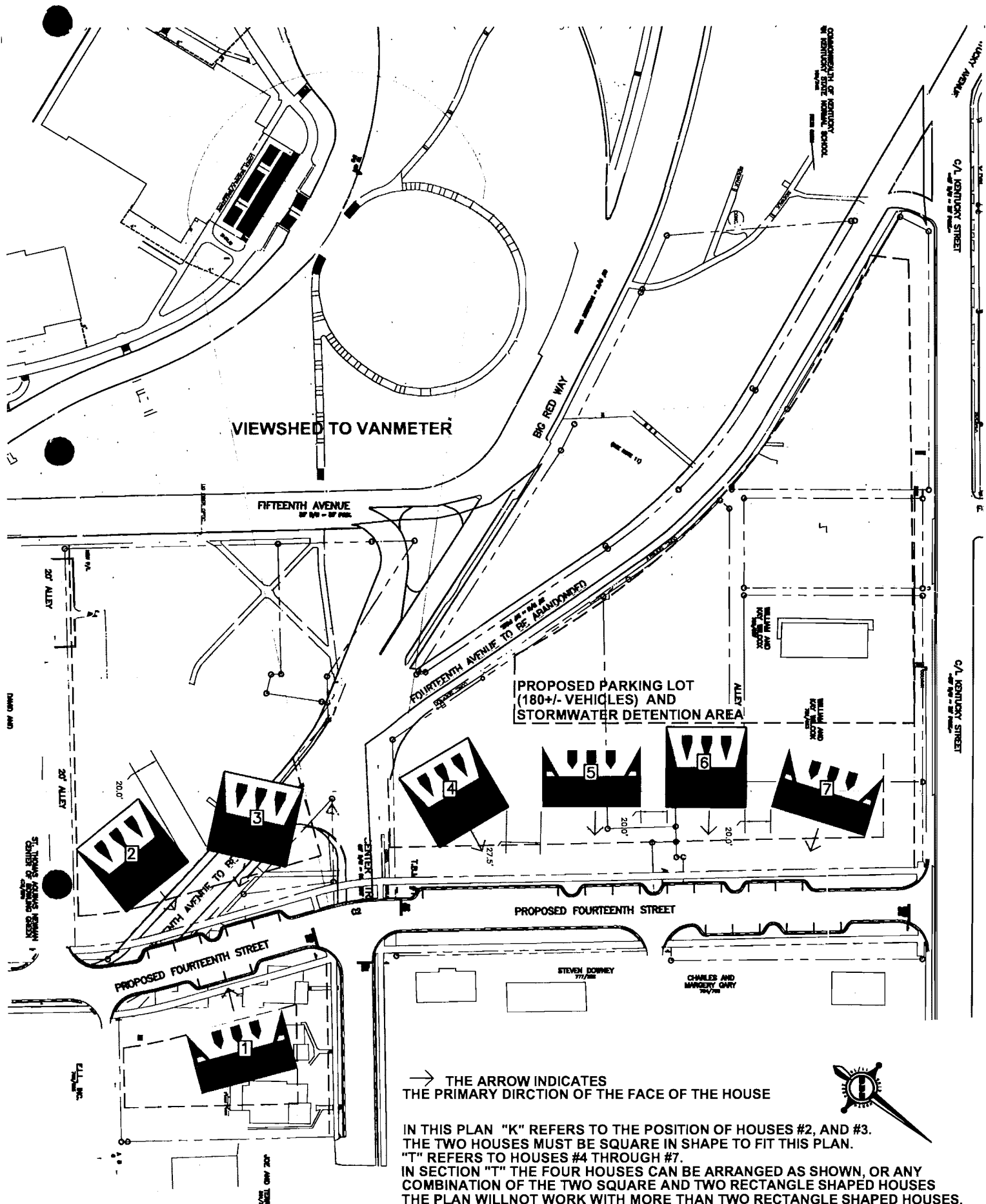

PLANS "K" + "T"

SCALE: 1" = 100'

OCTOBER 10, 2005

WESTERN KENTUCKY UNIVERSITY
GREEK VILLAGE CONCEPT PLANS
ON PROPOSED FOURTEENTH AVENUE

DD ENGINEERING, INC.
DESIGNING - ENGINEERING - ARCHITECTURE
2000 W. 10TH ST., SUITE 100
COLUMBIA, MISSOURI 65201
TEL: 636-331-1111 FAX: 636-331-1112
WWW.DDENGINEERING.COM

ATTACHMENT C

2006-2012 SIX-YEAR CAPITAL PLAN

2006-2008 CAPITAL PRIORITIES

PROJECT TITLE	BUDGET	FUNDING SOURCE
* 1. Replace building College of Education, Tate Page Hall	\$35,000,000	State Bond
* 2. Renovate Science Campus Ph III	7,000,000	State Bond
* 3. Renovate Academic/Athletic #2	28,500,000	AB-RF-OT-P
* 4. Renovate Electrical Distribution – Phase V	4,500,000	RF
* 5. Replace building, Ford College Business, Phase I	5,800,000	State Bond
6. Renovate Van Meter Hall	16,000,000	Agency Bond
7. ICSET/MCC Phase II	4,500,000	State Bond
8. Construct Owensboro Advanced Technology Ctr.	12,536,000	State Bond
9. Construct Central Region Postsecondary Ed Ctr, Phase II	17,782,000	State Bond
10. Renovate Ivan Wilson Center	8,000,000	Agency Bond
11. Expand Preston Center	10,000,000	Agency Bond
12. Acquire Property and Construct Parking Lots	4,000,000	Agency Bond
13. Construct Agriculture Research Svs Lab	22,825,000	Federal Funds
14. Renovate Academic Complex Phase I	1,323,000	State Bond
* 15. Renovate Ag Expo Ctr HVAC	930,000	State Bond
16. Replace Steam Line	3,000,000	State Bond
17. Renovate ES&T HVAC and Electrical System	2,000,000	State Bond
18. Convert WKUY-NPR and WKUY-PS to Digital	500,000	State Bond
19. Miscellaneous Maintenance Pool	10,195,000	RF
* 20. Upgrade IT Infrastructure	2,000,000	RF
* 21. Renovation and Expansion of Carroll Knicely Center	3,500,000	RF
22. Renovate Kentucky Building, Phase III	11,330,000	RF

2006-2012 SIX-YEAR CAPITAL PLAN

2006-2008 CAPITAL PRIORITIES

PROJECT TITLE	BUDGET	FUNDING SOURCE
23. Energy Savings Performance Contracting	\$ 6,000,000	OT-LTF
24. Purchase Property for Campus Expansion	3,000,000	RF
* 25. Renovate Faculty House	500,000	RF
26. Renovate Garrett Conference Ctr	10,000,000	RF-OT-P

* Project has been revised/updated since April 29, 2005

ATTACHMENT D

Western Kentucky University
First Quarter FY 2006 - Statement of Revenues and Expenditures
For the period from July 1, 2005 through September 30, 2005

	Revised Annual Budget 2005-06	Actual 1st Quarter Year-to-date	Percent of 2005-06 Actual/Revised
Revenue			
Educational and General			
Unrestricted			
Student tuition and fees	\$ 94,250,000	\$ 47,575,299	50.5%
State appropriations	\$ 78,039,000	\$ 23,410,100	30.0%
Other	\$ 19,783,000	\$ 3,888,361	19.7%
Net assets allocation	3,522,898		
Total unrestricted	\$ 195,594,898	\$ 74,873,760	
Restricted			
Grants and Contracts	\$ 63,197,000	\$ 21,405,515	33.9%
Other	\$ 806,000		0.0%
Net assets allocation	\$ 5,043,294		
Total restricted	\$ 69,046,294	\$ 21,405,515	
Auxiliary Enterprises			
Revenue Sources	\$ 16,511,000	\$ 7,463,966	45.2%
Net assets allocation	\$ -		
Total auxiliary enterprises	\$ 16,511,000	\$ 7,463,966	
Total revenue	<u>\$ 281,152,192</u>	<u>\$ 103,743,241</u>	<u>36.9%</u>
Total revenue excluding net assets allocation	<u>\$ 272,586,000</u>	<u>\$ 103,743,241</u>	<u>38.1%</u>
Expenditures			
Educational and General			
Unrestricted	\$ 195,594,898	\$ 46,513,427	23.8%
Restricted			
Grants and Contracts	\$ 63,197,000	\$ 21,405,515	33.9%
Grant Carryforward	\$ 5,043,294		
Other	\$ 806,000		0.0%
Total restricted	\$ 69,046,294	\$ 21,405,515	31.0%
Auxiliary Enterprises			
Auxilliary enterprises	\$ 16,511,000	\$ 5,232,504	31.7%
Total expenditures	<u>\$ 281,152,192</u>	<u>\$ 73,151,446</u>	<u>26.0%</u>

* Current year expenditure sources included both revenues from current year and net asset allocation from prior year.