

1987

## Industrial Resources: Carlisle County

Kentucky Library Research Collections  
Western Kentucky University, [spcol@wku.edu](mailto:spcol@wku.edu)

Follow this and additional works at: [https://digitalcommons.wku.edu/carlisle\\_cty](https://digitalcommons.wku.edu/carlisle_cty)

 Part of the [Business Administration, Management, and Operations Commons](#), [Growth and Development Commons](#), and the [Infrastructure Commons](#)

---

### Recommended Citation

Kentucky Library Research Collections, "Industrial Resources: Carlisle County" (1987). *Carlisle County*. Paper 6.  
[https://digitalcommons.wku.edu/carlisle\\_cty/6](https://digitalcommons.wku.edu/carlisle_cty/6)

This Report is brought to you for free and open access by TopSCHOLAR®. It has been accepted for inclusion in Carlisle County by an authorized administrator of TopSCHOLAR®. For more information, please contact [topscholar@wku.edu](mailto:topscholar@wku.edu).

IR  
543 Carlisle County, Ky

RESOURCES FOR ECONOMIC DEVELOPMENT

Carlisle County

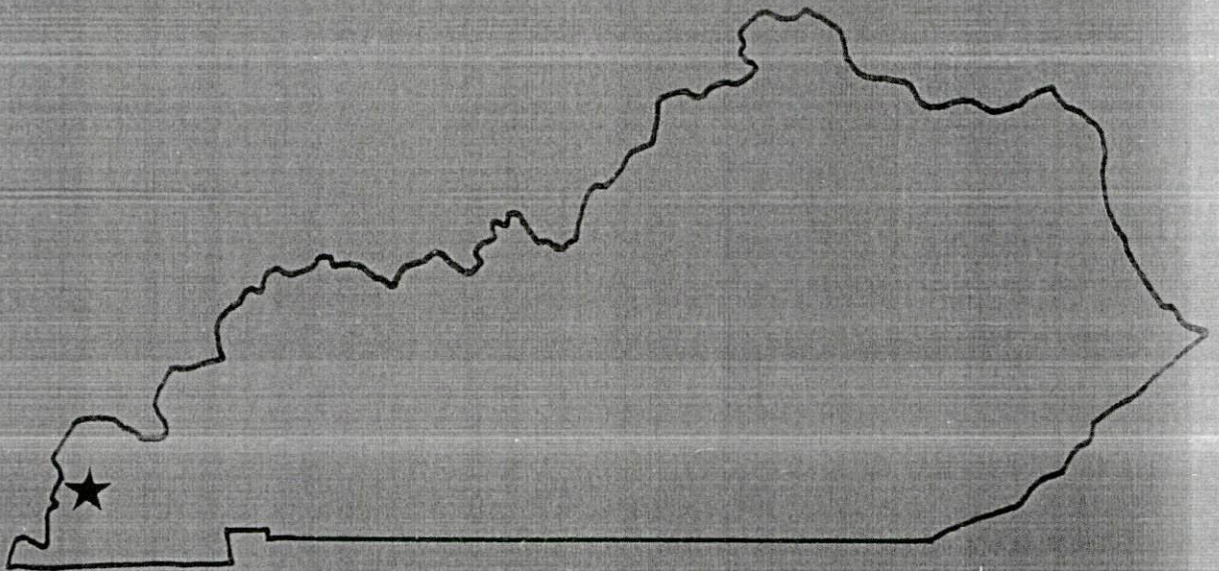

**KENTUCKY**  
The business environment is right.

# CARLISLE COUNTY --- Industrial Sites --- 1987

For more information contact the Kentucky Department of Economic Development, Industrial Development & Marketing Division, Capital Plaza Tower, Frankfort, Kentucky 40601 (502-564-7140).

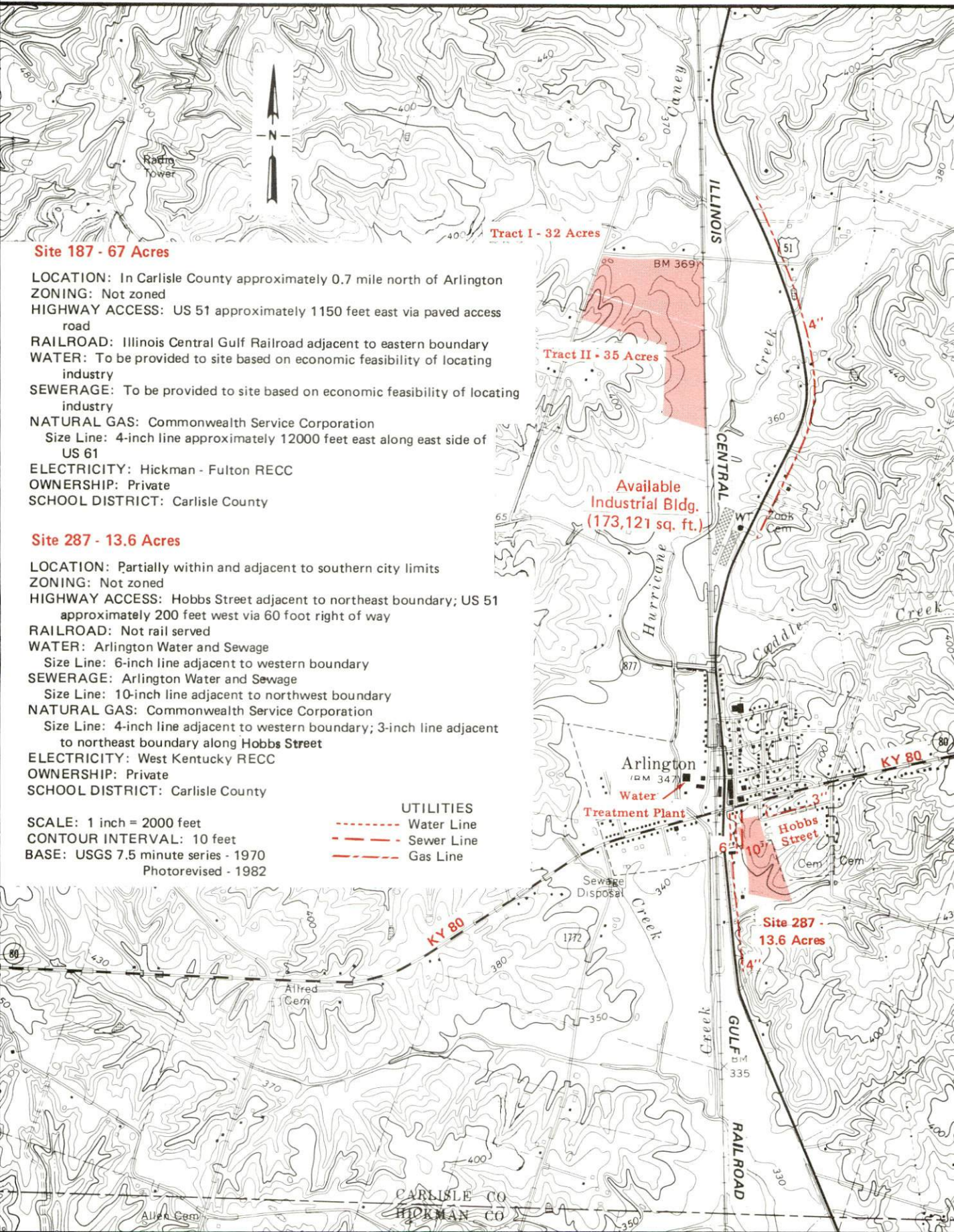

## Site 187 - 67 Acres

**LOCATION:** In Carlisle County approximately 0.7 mile north of Arlington  
**ZONING:** Not zoned  
**HIGHWAY ACCESS:** US 51 approximately 1150 feet east via paved access road  
**RAILROAD:** Illinois Central Gulf Railroad adjacent to eastern boundary  
**WATER:** To be provided to site based on economic feasibility of locating industry  
**SEWERAGE:** To be provided to site based on economic feasibility of locating industry  
**NATURAL GAS:** Commonwealth Service Corporation  
 Size Line: 4-inch line approximately 12000 feet east along east side of US 61  
**ELECTRICITY:** Hickman - Fulton RECC  
**OWNERSHIP:** Private  
**SCHOOL DISTRICT:** Carlisle County

## Site 287 - 13.6 Acres

**LOCATION:** Partially within and adjacent to southern city limits  
**ZONING:** Not zoned  
**HIGHWAY ACCESS:** Hobbs Street adjacent to northeast boundary; US 51 approximately 200 feet west via 60 foot right of way  
**RAILROAD:** Not rail served  
**WATER:** Arlington Water and Sewage  
 Size Line: 6-inch line adjacent to western boundary  
**SEWERAGE:** Arlington Water and Sewage  
 Size Line: 10-inch line adjacent to northwest boundary  
**NATURAL GAS:** Commonwealth Service Corporation  
 Size Line: 4-inch line adjacent to western boundary; 3-inch line adjacent to northeast boundary along Hobbs Street  
**ELECTRICITY:** West Kentucky RECC  
**OWNERSHIP:** Private  
**SCHOOL DISTRICT:** Carlisle County

**SCALE:** 1 inch = 2000 feet  
**CONTOUR INTERVAL:** 10 feet  
**BASE:** USGS 7.5 minute series - 1970  
 Photorevised - 1982

**UTILITIES**  
 - - - - - Water Line  
 - - - - - Sewer Line  
 - - - - - Gas Line

Tract I - 32 Acres

Tract II - 35 Acres

Available Industrial Bldg. (173,121 sq. ft.)

Site 287 - 13.6 Acres

CARLISLE CO  
 HICKMAN CO

RESOURCES FOR ECONOMIC DEVELOPMENT

CARLISLE COUNTY, KENTUCKY

Prepared by  
The Kentucky Department of Economic Development  
Division of Research and Planning  
in cooperation with  
The Carlisle County Chamber of Commerce

1987

Program manager - Andrew Dennis; research - Jerry Tolliver; clerical - Bobbi Graves; graphics - Tony Cecconi, Robert Owens, Pat Coleman; cartography - Site Evaluation Branch, Division of Industrial Development and Marketing. Cost of printing paid from state funds.

## TABLE OF CONTENTS

<u>Chapter</u>	<u>Page</u>
INDUSTRIAL SITES . . . . .	i
CARLISLE COUNTY, KENTUCKY - A RESOURCE PROFILE . . . . .	1
THE LABOR MARKET AREA . . . . .	2
Population . . . . .	2
Population Projections . . . . .	2
Labor Force Characteristics of Residents, 1986 . . . . .	3
Selected Components of Nonagricultural Employment, by Place of Work, 1986 . . . . .	3
Per Capita Personal Income . . . . .	4
Estimated Male Labor Supply . . . . .	5
Estimated Female Labor Supply . . . . .	5
Average Weekly Wages by Industry, by Place of Work, 1986 . . . . .	6
EXISTING INDUSTRY . . . . .	8
Carlisle County Manufacturing Firms, Their Products and Employment . . . . .	8
Labor Organizations in Manufacturing Firms . . . . .	8
Selected Industrial Services . . . . .	9
TRANSPORTATION . . . . .	10
Rail . . . . .	10
Highways . . . . .	10
Truck Service . . . . .	10
Air . . . . .	11
Air Express Service . . . . .	12
Water . . . . .	12
POWER AND FUEL . . . . .	13
Electricity . . . . .	13
Natural Gas . . . . .	14
Other Fuels . . . . .	15
WATER AND SEWERAGE . . . . .	16
Public Water Supply . . . . .	16
Raw Water . . . . .	17
Sewerage . . . . .	17
CLIMATE . . . . .	18

<u>Chapter</u>	<u>Page</u>
LOCAL GOVERNMENT . . . . .	19
Structure . . . . .	19
Planning and Zoning . . . . .	19
Local Fees and Licenses . . . . .	19
State and Local Property Taxes . . . . .	20
Combined State and Local Rates Per \$100 Valuation, 1986 . . . . .	20
Safety . . . . .	21
Police . . . . .	21
Fire . . . . .	21
Rescue Service . . . . .	21
Refuse Collection and Disposal . . . . .	21
EDUCATION . . . . .	22
Public Schools . . . . .	22
Area Colleges and Universities . . . . .	23
Vocational Schools . . . . .	24
HEALTH . . . . .	27
Local Medical Personnel . . . . .	27
Hospitals . . . . .	27
Other Medical Facilities . . . . .	27
Ambulance Service . . . . .	27
OTHER LOCAL FACILITIES . . . . .	28
Communications . . . . .	28
Library Services . . . . .	28
Religious Institutions . . . . .	28
Financial Institutions . . . . .	28
RECREATION . . . . .	29
COMMUNITY IMPROVEMENTS . . . . .	31

1986 EDITION  
GENERAL HIGHWAY MAP  
**CARLISLE COUNTY**  
**KENTUCKY**

PREPARED BY THE  
KENTUCKY TRANSPORTATION CABINET  
DEPARTMENT OF HIGHWAYS  
DIVISION OF PLANNING  
IN COOPERATION WITH THE  
U.S. DEPARTMENT OF TRANSPORTATION  
FEDERAL HIGHWAY ADMINISTRATION

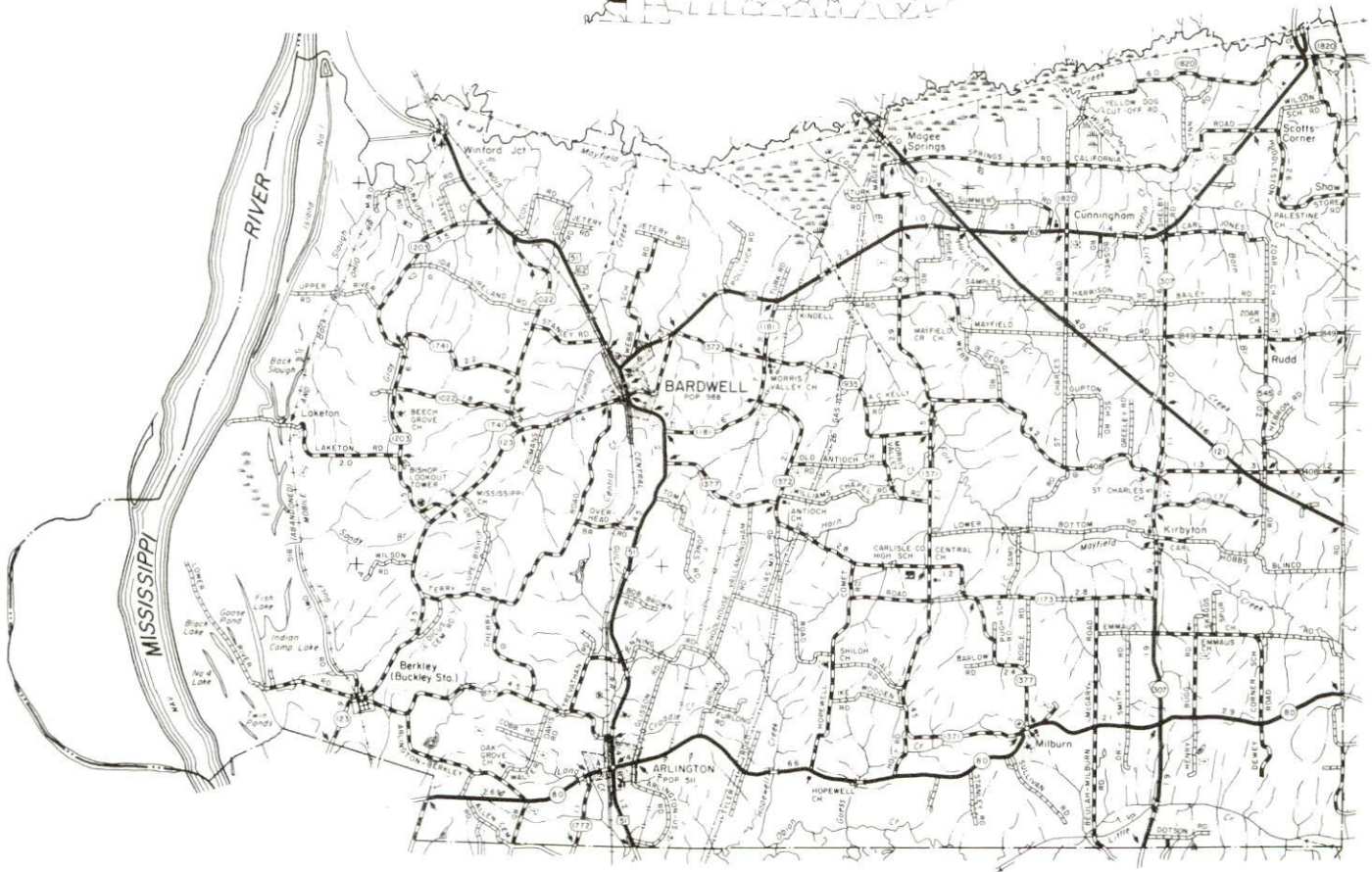



# CARLISLE COUNTY LABOR MARKET AREA

With  
MAJOR HIGHWAYS & RAILROAD SYSTEM

Shaded area denotes Labor Market Area.

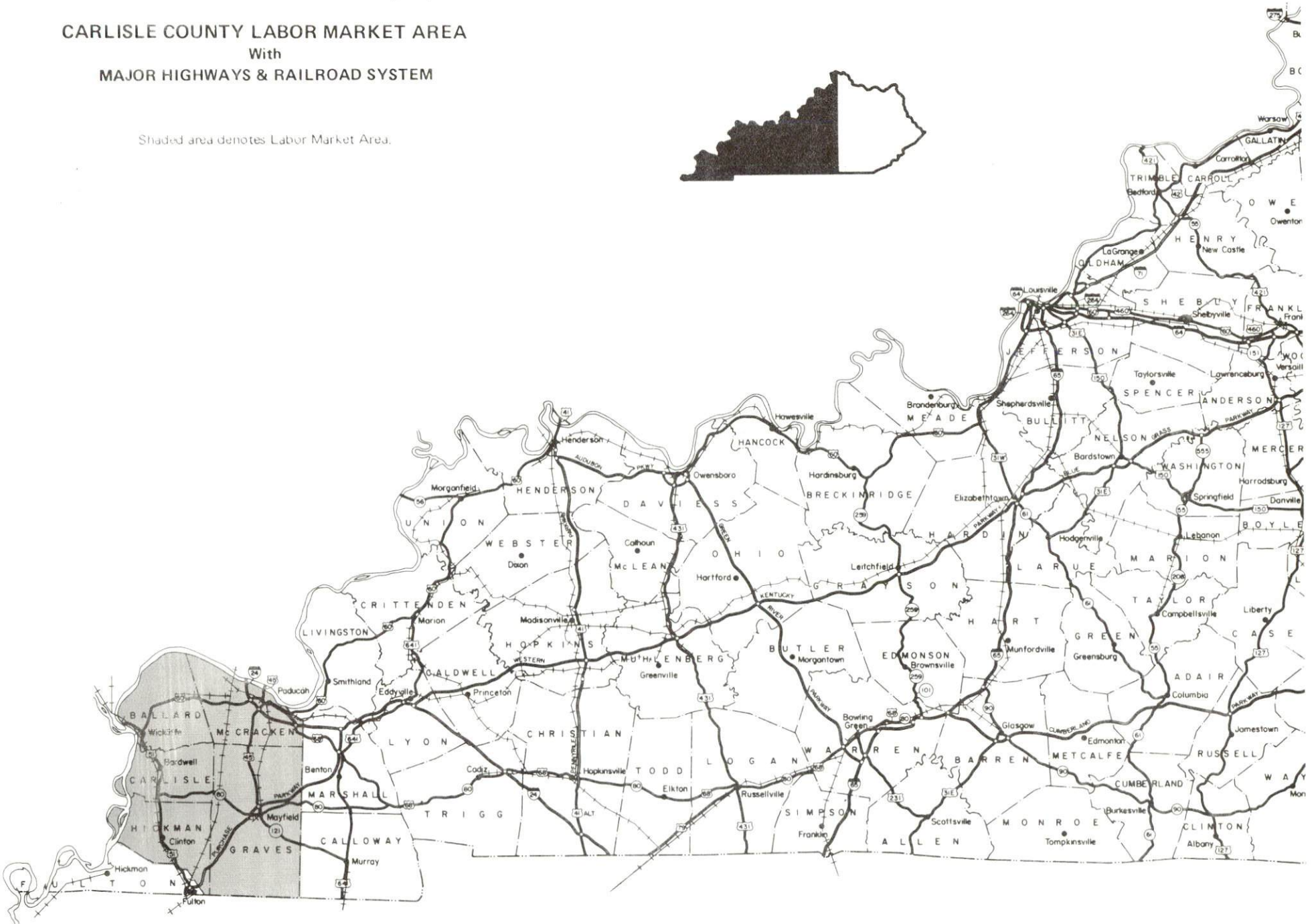
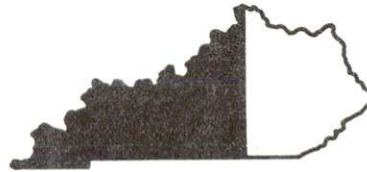

## CARLISLE COUNTY, KENTUCKY - A RESOURCE PROFILE

Carlisle County is located in the extreme western portion of Kentucky in the Jackson Purchase Region. Surrounding the county on the north, east, south and west are the counties of Ballard, Graves, and Hickman, and the Mississippi River respectively. The county covers a land area of 191 square miles and the topography is composed of gently rolling plain. Bardwell, the county seat of Carlisle County, is located 166 miles northeast of Nashville, Tennessee; 188 miles southeast of St. Louis, Missouri; and 249 miles southwest of Louisville, Kentucky.

Carlisle County had a 1986 estimated population of 5,000 with 541 persons residing in Arlington and 965 in Bardwell.

**The Economic Framework** - The total number of Carlisle County residents employed in 1986 averaged 2,017. Manufacturing firms in the county reported 206 employees; wholesale and retail trade provided 198 jobs; 57 people were employed in service occupations; state and local government accounted for 176 employees; and contract construction firms provided 5 jobs.

**Labor Supply** - There is a current estimated labor supply of 6,308 men and 10,191 women available for industrial jobs in the labor market area. In addition, from 1987 through 1991, 4,409 young men and 4,170 young women in the area will become 18 years of age and potentially available for industrial jobs.

**Transportation** - The Illinois Central Gulf Railroad provides rail service to Carlisle County. Major highways serving Carlisle County are U.S. 62, U.S. 51, and Kentucky 80. The Purchase Parkway, a multi-lane toll road, is 28 miles southeast of Bardwell via U.S. 51 and Kentucky 80, and Interstate 24 is 30 miles to the northeast via U.S. 62. Nine trucking companies provide interstate and/or intrastate service to Bardwell. The nearest scheduled commercial airline service is available at Barkley Regional Airport near Paducah, 24 miles northeast of Bardwell and the nearest local airport, Farrington Airport, is also located near Paducah. Public riverport facilities are located at Hickman, on the Mississippi River, 33 miles southwest of Bardwell and at Paducah, on the Tennessee River, 30 miles northeast of Bardwell.

**Power and Fuel** - Carlisle County is served by Hickman-Fulton County RECC, Jackson Purchase ECC and West Kentucky RECC. A small portion of Carlisle County is served by the Kentucky Utilities Company. Bardwell is served by Bardwell City Utilities and the source of power is the Kentucky Utilities Company. Commonwealth Service Corporation provides natural gas to Carlisle County and the source of supply is Truckline Gas Company. Three distributors of propane are within 15 miles of Bardwell. Two distributors of distillate fuel oil are located in Bardwell.

**Education** - Carlisle County is served by the Carlisle County School System. Five senior colleges and one community college are located within 65 miles of Bardwell. The nearest state vocational-technical education center is located at Paducah, 30 miles distant. The nearest area vocational education center is located in Barlow, 16 miles distant.

## LABOR MARKET STATISTICS

The Carlisle County Labor Market Area includes Carlisle County and the adjoining Kentucky counties of Ballard, Graves, Hickman and McCracken.

### POPULATION

Area	1986*	1980	1970	Percent Nonwhite
				1980
Arlington	541	511	549	1.8
Bardwell	965	988	1,049	3.3
Labor Market Area	111,900	115,709	109,114	-
Carlisle County	5,000	5,487	5,354	1.0
Ballard County	8,100	8,798	8,276	3.8
Graves County	32,900	34,049	30,939	4.7
Hickman County	5,600	6,065	6,264	10.5
McCracken County	60,300	61,310	58,281	10.5

\* Population estimates. City estimates are for 1984.

Note: The 1980 city counts of population by race are provisional.

Sources: U.S. Department of Commerce, Bureau of the Census, 1980 Census of Population and Housing, March 1981; 1980 Census of Population, Number of Inhabitants. University of Louisville, Urban Studies Center, Population Unit, October 1985; University of Louisville, Urban Studies Center, State Data Center, June 1987 Newsletter, Vol. 5 No. 4.

### POPULATION PROJECTIONS

Area	1990	1995	2000	2010
Labor Market Area	117,059	119,431	120,874	122,607
Carlisle County	5,400	5,457	5,493	5,507
Ballard County	8,348	8,406	8,436	8,408
Graves County	34,184	35,030	35,536	36,217
Hickman County	5,586	5,483	5,372	5,141
McCracken County	63,541	56,055	66,037	67,334

Source: University of Louisville, Urban Studies Center, Population Research Unit, How Many Kentuckians: Population Forecasts, 1980-2020, the 1986 Edition, Spring 1986.

LABOR FORCE CHARACTERISTICS OF RESIDENTS, 1986

	<u>Carlisle County</u>	<u>Labor Market Area</u>
Civilian Labor Force	2,337	51,414
Employment	2,017	46,417
Unemployment	320	4,997
Rate of Unemployment (%)	13.7	9.7

Source: Kentucky Cabinet for Human Resources, Kentucky Labor Force Estimates, Annual Averages, 1986.

SELECTED COMPONENTS OF NONAGRICULTURAL EMPLOYMENT  
BY PLACE OF WORK, 1986

	<u>Carlisle County</u>	<u>Labor Market Area</u>
All Industries (total)	690	38,516
Manufacturing	206	7,461
Wholesale & Retail Trade	198	11,678
Services	57	8,169
State/Local Government	176	4,556
Contract Construction	5	1,626
Mining & Quarrying	0	86

Note: Excludes domestic workers, railway workers, certain nonprofit corporations, majority of federal government workers, and self-employed workers.  
Source: Kentucky Cabinet for Human Resources, Average Monthly Workers Covered by Kentucky Unemployment Insurance Law, 1986.

PER CAPITA PERSONAL INCOME

<u>Area</u>	<u>1980</u>	<u>1984</u>	<u>Percent Change</u>
Carlisle County	\$ 6,626	\$ 9,716	46.6
Labor Market Area Range	\$5,935 - 8,980	\$8,945 - 12,053	-
Kentucky	7,644	10,232	33.9
U.S.	9,494	12,772	34.5

**Sources:** U.S. Department of Commerce, Bureau of Economic Analysis. Kentucky Economic Information System, June 1986.

ESTIMATED MALE LABOR SUPPLY  
CARLISLE COUNTY LABOR MARKET AREA

Area	Current				Future
	Total Male	Unemployed	Under-employed	Not in Labor Force	Becoming 18 years of age 1987 thru 1991
Labor Market					
Area*	6,308	2,827	2,283	1,198	4,409
Carlisle	403	186	142	75	219
Ballard	518	268	196	54	379
Graves	1,856	884	692	280	1,235
Hickman	351	211	140	0	210
McCracken	3,180	1,278	1,113	789	2,366

ESTIMATED FEMALE LABOR SUPPLY  
CARLISLE COUNTY LABOR MARKET AREA

Area	Current				Future
	Total Female	Unemployed	Under-employed	Not in Labor Force	Becoming 18 years of age 1987 thru 1991
Labor Market					
Area*	10,191	2,170	2,890	5,131	4,170
Carlisle	556	134	117	305	204
Ballard	949	124	183	642	331
Graves	2,852	639	875	1,338	1,139
Hickman	238	64	146	28	223
McCracken	5,596	1,209	1,569	2,818	2,273

\* Additional workers may be drawn from other nearby counties.

Note: Unemployed - persons unemployed and actively seeking work; Underemployed - persons employed but working only 14 to 26 weeks per year; Not in Labor Force - represents the number of persons who would enter the labor force if suitable employment were available (based on the assumption that persons in Kentucky would like to participate in the labor force in the same proportion that they do nationally).

Sources: Kentucky Cabinet for Human Resources, Kentucky Labor Supply Estimates by County, 1986. Kentucky Department of Economic Development, Future Labor Supply Becoming 18 Years of Age, 1987 thru 1991.

AVERAGE WEEKLY WAGES BY INDUSTRY  
BY PLACE OF WORK, 1986

	<u>Carlisle County</u>	<u>Ballard County</u>	<u>Graves County</u>
All Industries	\$214.29	\$420.49	\$330.78
Mining & Quarrying	0	0	414.05
Contract Construction	239.53	448.50	254.24
Manufacturing	200.00	601.55	480.66
Transportation, Communications & Public Utilities	*	449.76	452.10
Wholesale & Retail Trade	184.91	226.92	186.69
Finance, Insurance & Real Estate	283.85	255.52	291.68
Services	181.61	223.02	214.40
State/Local Government	257.57	269.68	313.97
Other	175.09	*	184.32

	<u>Hickman County</u>	<u>McCracken County</u>
All Industries	\$177.84	\$306.30
Mining & Quarrying	0	0
Contract Construction	277.59	357.76
Manufacturing	*	425.59
Transportation, Communications & Public Utilities	330.15	437.32
Wholesale & Retail Trade	227.91	217.91
Finance, Insurance & Real Estate	242.67	307.23
Services	160.98	309.43
State/Local Government	277.29	323.67
Other	*	169.79

\* Not disclosed.

Note: The average weekly wage for each category includes the salaries and wages of all persons working for that type business. For example, the manufacturing category includes both production workers and administrative personnel. Excludes domestic workers, railway workers, certain nonprofit corporations, majority of federal government workers, and self-employed workers.

Source: Kentucky Cabinet for Human Resources, Average Weekly Wages of Workers Covered by Kentucky Unemployment Insurance Law, 1986.

Occupational wage rates for specific industries are usually not available to most government agencies, and wage data furnished to state employment agencies by individual industrial employers are protected from disclosure by federal law. The most reliable up-to-date wage information can be obtained by direct contact with local employers.

Associated Industries of Kentucky, a voluntary organization of Kentucky businesses, regularly collects occupational wage rates and fringe benefits data from participating member firms. Data are compiled for over 127 clearly defined office, production, and service occupations. Tabulations are published for nine geographical areas of Kentucky, as shown on the map below. It should be noted that the data may be weighted by the preponderance of firms in the larger cities and may be somewhat higher than the rates paid in the smaller communities. Data from these tabulations are available, upon request, from the Kentucky Department of Economic Development, Frankfort, Kentucky 40601.

- Area 1 - Western
- Area 2 - Green River
- Area 3 - Southern
- Area 4 - Southeastern
- Area 5 - Louisville
- Area 6 - Central
- Area 7 - Lexington-Bluegrass
- Area 8 - Northern
- Area 9 - Northeastern

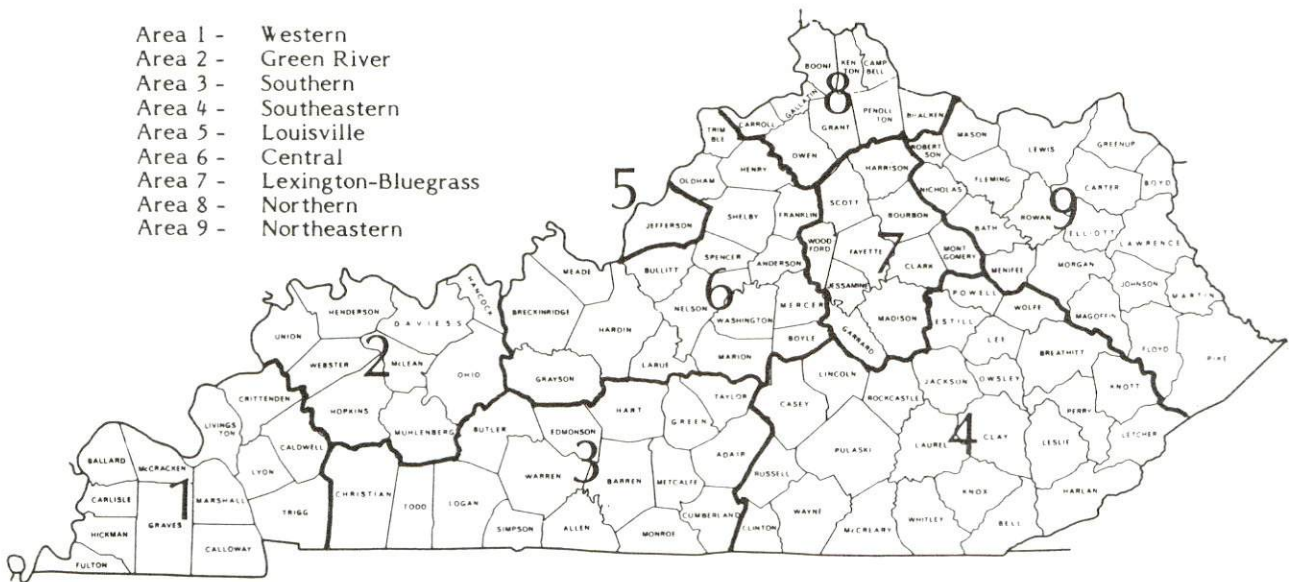

Associated Industries of Kentucky Area Wage Surveys



## EXISTING INDUSTRY

### CARLISLE COUNTY MANUFACTURING FIRMS, THEIR PRODUCTS AND EMPLOYMENT

Firm (Establishment date)	Product	Average Employment		
		Total	Male	Female
<b>Arlington</b>				
Grogan Sausage Company (1973)	Sausage	13	6	7
<b>Bardwell</b>				
The Carlisle County News (1972)	Newspaper, job printing	6	0	6
Ford Construction Company (1957)	Ready-mixed concrete, water tanks	4	4	0
<b>Cunningham</b>				
Cunningham Ready Mix (1979)	Ready-mixed concrete	7	-	-
National Ceramics, Inc. (1980)	Ceramic lamp bases, ceramic vases	105	45	60
Partin Sausage Company (1924)	Sausage	14	12	2

Sources: Kentucky Department of Economic Development, 1987 Kentucky Directory of Manufacturers; Division of Research and Planning.

### LABOR ORGANIZATIONS IN MANUFACTURING FIRMS

There are no labor unions representing manufacturing workers in Carlisle County at the present time.

## SELECTED INDUSTRIAL SERVICES

<u>Types of Service</u>	<u>Location</u>	<u>Mileage from Bardwell</u>
Custom Plastics Producers	Fulton, Kentucky	29
Electric Motor Repair	Paducah, Kentucky	30
	Mayfield, Kentucky	31
Grinding, Precision & Tool	Mayfield, Kentucky	31
Heat Treating Facilities	Evansville, Indiana	129
Industrial Equipment & Supplies	Paducah, Kentucky	30
	Mayfield, Kentucky	31
Industrial Gases	Paducah, Kentucky	30
Industrial Waste Removal	Paducah, Kentucky	30
Machine Shops, Tool & Die	Clinton, Kentucky	15
Metal Finishers	Paducah, Kentucky	30
	Mayfield, Kentucky	31
Metal Service Centers	Hopkinsville, Kentucky	98
Millwrights	Paducah, Kentucky	30
Public Warehouse Facilities	Paducah, Kentucky	30

Sources: Kentucky Department of Economic Development, Kentucky Directory of Selected Industrial Services, 1985; Division of Research and Planning.

## TRANSPORTATION

### Rail

Line serving Carlisle County - Illinois Central Gulf Railroad

Services - The cities of Arlington and Bardwell are provided with main line service. Two northbound and 2 southbound through freights daily; one switch engine, based in Wickliffe, provides round trip service six days per week. The nearest piggyback facilities are located on the Paducah and Louisville Railroad at Paducah, Kentucky, 30 miles northeast

### Highways

Major highways serving Bardwell are U.S. 62 and U.S. 51, both are "AAA"-rated trucking highways (80,000-pound gross load limit). U.S. Highway 51 connects Bardwell with the Purchase Parkway, a multi-lane toll road, at Fulton, 28 miles to the south, and with Interstate 57 near Cairo, Illinois, 20 miles to the northwest. U.S. 51 and Kentucky Highway 80 also connects Bardwell with the Purchase Parkway at Mayfield, 28 miles to the southeast. Access to Interstate 24 is 30 miles northeast of Bardwell via U.S. 62.

### Truck Services

ARA/Smith's\*  
Edwards, Henry Trucking  
Company\*\*  
Jones Truck Lines, Inc.\*  
Majors Transit, Inc.\*  
Manning Motor Express, Inc.\*

Milan Express Company, Inc.\*  
Overnite Transportation  
Company\*  
Roadway Express, Inc.\*  
Yellow Freight System, Inc.\*

\* Interstate and intrastate service.

\*\* Interstate service only.

Source: American Motor Carrier Directory, Spring 1987.

HIGHWAY MILES AND TRUCK TRANSIT TIME IN DAYS FROM  
BARDWELL, KENTUCKY, TO SELECTED MARKET CENTERS

City	Highway Miles	Delivery		City	Highway Miles	Delivery Time TL
		Time TL				
Atlanta, GA	422	1		Los Angeles, CA	2,033	3-5
Baltimore MD	847	2		Louisville, KY	249	1
Birmingham, AL	362	1		Nashville, TN	166	1
Chicago, IL	383	1		New Orleans, LA	542	2
Cincinnati, OH	350	1		New York, NY	997	-
Cleveland, OH	594	2		Pittsburgh, PA	637	2
Detroit, MI	609	2		St. Louis, MO	188	1
Knoxville, TN	358	1				

Note: Mileage computations are via the best interstate or primary highways, not necessarily the most direct route of travel.

Sources: Rand McNally Deluxe Motor Carriers' Road Atlas, 1987. Official Kentucky Mileage Map, 1980. Delivery time - Overnite Transportation Company, P. O. Box 3309, Paducah, Kentucky 42002.

Air

Local

Location: Farrington Airport  
 6 miles south of Paducah  
 Runways: 1 paved  
 Length: 3,000 feet  
 Traffic  
 Control: Wind sock  
 Lighting: Dusk to dawn, VASI  
 Services: Fuel; 100LL and auto gas for approved planes; major  
 A & P repairs

(Continued)

Nearest Scheduled Commercial Airline Service

Location: Barkley Regional Airport  
6 miles west of Paducah, Kentucky;  
24 miles northeast of Bardwell

Runways: 2 paved  
Length: 6,499 feet; 4,000 feet

Traffic Control: Wind sock, wind tee

Lighting: HIRL, MALSRail, REIL, VASI, MIRL, MITL, rotating  
beacon

Services: Allegheny Commuter, American Eagle, Northwest Air  
Link, Trans World Express, fuel - 100LL and  
jet-A; hangar, 10 T-hangars, 45 tie-downs;  
major and minor A & P repairs; APU, charter,  
flight instruction, plane rental, aerial  
photography; car rentals, limousine, restaurant,  
weather information; Part 139 Airport Operating  
Certificate, airport security

Air Freight Service: Air carriers accept air freight on a space available  
basis

**Air Express Service**

Several major companies offer air express services in Kentucky. These companies provide a quick means of shipping small to medium-sized packages expeditiously.

**Water**

Water transportation is an important asset to Carlisle County. Two major public riverports provide service to Carlisle County - the Hickman-Fulton County Riverport, located on the Mississippi River, and the Paducah-McCracken County Riverport, located on the Tennessee River. Private facilities are also available on the Mississippi River at Cairo, Illinois, 16 miles northwest of Bardwell.

## POWER AND FUEL

### Electricity

Company serving **Bardwell** - Bardwell Municipal Utilities  
Source of power - Kentucky Utilities Company  
For industrial rates contact:

Industrial Development Department  
Kentucky Utilities Company  
One Quality Street  
Lexington, Kentucky 40507  
(606) 255-1461

and/or

Bardwell Municipal Utilities  
P. O. Box 277  
Bardwell, Kentucky 42023  
(502) 628-3833

Company serving **Arlington and parts of Carlisle County** - West Kentucky  
RECC  
Source of power - Tennessee Valley Authority  
For industrial rates contact:

South Kentucky Industrial Development  
Association, Inc.  
P. O. Box 726  
Hopkinsville, Kentucky 42240  
(502) 885-5392

and/or

West Kentucky RECC  
1218 West Broadway  
Mayfield, Kentucky 42066

Company serving **northeastern Carlisle County** - Jackson Purchase ECC  
Source of power - Big Rivers Electric Corporation  
For industrial rates contact:

Big Rivers Electric Corporation  
201 3rd Street  
Henderson, Kentucky 42420  
(502) 827-2561

and/or

Jackson Purchase ECC  
2900 Irvine Cobb Drive  
Paducah, Kentucky 42001  
(502) 442-7321

Company serving western Carlisle County - Hickman-Fulton County RECC  
Source of power - Tennessee Valley Authority  
For industrial rates contact:

South Kentucky Industrial Development  
Association, Inc.  
P. O. Box 726  
Hopkinsville, Kentucky 42240  
(502) 885-5392

and/or

Hickman-Fulton Counties RECC  
Fulton Road  
Hickman, Kentucky 42050  
(502) 236-2521

Company serving parts of north central Carlisle County - Kentucky  
Utilities Company  
Source of power - Kentucky Utilities Company  
For industrial rates contact:

Industrial Development Department  
Kentucky Utilities Company  
One Quality Street  
Lexington, Kentucky 40507  
(606) 255-1461

## Natural Gas

Company serving Bardwell and Arlington - Commonwealth Service  
Corporation  
Source of supply - Truckline Gas Company  
Size of transmission mains - 24 and 36 inches (supplier);  
4-inch (distributor)  
Distribution mains - 2 and 4 inches  
Distribution pressure - 30 to 225 psi  
Btu content - 1,020 per cubic foot  
Specific gravity - 0.6  
For rates and supplies contact:

Commonwealth Service Corporation  
P. O. Box 295  
Wickliffe, Kentucky 42087  
(502) 335-3116

Other Fuels

Propane

Ballard/Carlisle County  
LP Gas Company  
Highway 60  
LaCenter, Kentucky 42056

Tri State Gas & Appliance  
Company, Inc.  
Jefferson Street  
Clinton, Kentucky 42031

Price's Bulk Gas Company  
P. O. Box 217  
Barlow, Kentucky 42024

Fuel oils

Distillate fuel oil -

Ashland Petroleum Company  
Bardwell, Kentucky 42023

Burgess, Joe W. Sales & Service  
Highway 51  
Bardwell, Kentucky 42023

Residual fuel oil - Arrangements must be made with the refinery.

Low sulphur content coal - Available in Kentucky.



## WATER AND SEWERAGE

### Public Water Supply

Company serving Arlington - Arlington Water & Sewage  
P. O. Box 398  
Arlington, Kentucky 42021  
(502) 655-2261

Source - 2 wells

Treatment plant capacity - 576,000 gallons per day\*

Average daily consumption - 35,000 gallons

Peak daily consumption - 150,000 gallons

Treatment processes - Aeration, chlorination, and fluoridation

Storage capacity - 212,000 gallons

Size lines - 6 and 8 inches

Water pressure - Average 90 psi

### MONTHLY WATER RATES

First	2,000 gallons	\$9.00 (Minimum)
Next	8,000 gallons	3.40 per M gallons
Next	10,000 gallons	3.00 per M gallons
Next	20,000 gallons	2.00 per M gallons
Over	40,000 gallons	1.60 per M gallons

Tap-on charge: \$400; tap-on fee for lines larger than 3/4-inch  
at actual cost to the city

Company serving Bardwell - Bardwell City Utilities  
P. O. Box 277  
Bardwell, Kentucky 42023  
(502) 628-3833

Source - Wells

Treatment plant capacity - 295,000 gallons per day

Average daily consumption - 145,000 gallons

Peak daily consumption - 164,000 gallons

Treatment processes - Chlorination and fluoridation

Storage capacity - 100,000 gallons

Size lines - 4 and 6 inches

Water pressure - 65 to 84 psi

(Continued)

\* The treatment plant was recently constructed at a cost of \$610,000. Also, several 2- and 4-inch lines were replaced by 6-inch lines.

MONTHLY WATER RATES

First	2,000 gallons	\$4.50 (Minimum)
Next	8,000 gallons	2.00 per M gallons
Next	10,000 gallons	1.80 per M gallons
Over	20,000 gallons	1.50 per M gallons

Tap-on charge: \$75

**Raw Water**

Surface water sources - Mississippi River, Obion Creek, Mayfield Creek  
Average discharge - Mississippi River - unlimited  
Expected ground water yield - 500 to 1,000 gpm over entire county

**Sewerage**

Company serving **Arlington** -   Arlington Water & Sewer  
  P. O. Box 398  
  Arlington, Kentucky 42021  
  (502) 655-2261

Design capacity - 70,000 gallons per day  
Average daily flow - 40,000 gallons  
Type of treatment - Secondary  
Treatment processes - Screening, extended aeration, contact stabilization,  
                                  chlorination, sludge drying beds, post aeration  
Treated effluent discharged into - Un-named tributary to Hurricane  
                                  Creek  
Size of sanitary mains - 10-inch  
Size of storm mains - None  
Monthly rates - 50% of water bill  
Tap-on charge: \$700

Company serving **Bardwell** -   Bardwell City Utilities  
  P. O. Box 277  
  Bardwell, Kentucky 42023  
  (502) 628-3833

Design capacity - 130,000 gallons per day  
Average daily flow - 70,000 gallons  
Type of treatment - Primary  
Treatment processes - Extended aeration  
Treated effluent discharged into - Truman Creek  
Size of sanitary mains - 6-inch  
Size of storm mains - 6-inch  
Monthly rates - Based on water usage:

First	2,000 gallons	\$2.75
Next	8,000 gallons	1.00 per M gallons
Next	10,000 gallons	.90 per M gallons
Over	20,000 gallons	.75 per M gallons

Tap-on charge: \$25

## CLIMATE

### Carlisle County

#### Temperature

Normal (30-year record)	59.10 degrees
Average annual 1985	58.20 degrees
Record highest, July 1980 (43-year record)	104.00 degrees
Record lowest, January 1985 (43-year record)	-12.00 degrees
Normal heating degree days (30-year record) (Heating degree day totals are the sums of negative departures of average daily temperatures from 65 degrees F.)	3,913

#### Precipitation

Normal (30-year record)	47.65 inches
Mean annual snowfall (30-year record)	10.40 inches
Total precipitation 1985	54.37 inches
Mean number days precipitation (.01 inch or more) (43-year record)	112.60
Mean number days thunderstorms (23-year record)	51.50

#### Prevailing winds (through 1964)

Southwest

#### Relative Humidity (22-year record)

Midnight	N/A
6 a.m.	82 percent
Noon	59 percent
6 p.m.	N/A

Source: U.S. Department of Commerce, Environmental Science Services Administration, Climatological Data, 1985. Station of record: Cairo, Illinois.

## LOCAL GOVERNMENT

### Structure

The city of Arlington is served by a mayor and four council members. The city of Bardwell is served by a mayor and six council members. In both cities the mayor is elected to a four-year term and the council members serve two-year terms. Carlisle County is served by a county judge/executive and four magistrates. The judge/executive and magistrates are selected to four-year terms.

### Planning and Zoning

There are no planning and zoning commissions in Carlisle County at the present time.

Mandatory state codes enforced - Kentucky Plumbing code, National Electric Code, Kentucky Boiler Regulations and Standards, Kentucky Building Code (modeled after BOCA code)

### Local Fees and Licenses

The city of Arlington levies annual occupational license fees ranging from \$15 to \$40. An unloading license fee of \$10.50 per year is also charged.

The city of Bardwell levies annual occupational license fees ranging from \$25 to \$50. The city also levies an unloading license fee of \$25 per year and an auto vehicle sticker fee of \$7.50 per year.

A 3 percent tax is levied on utilities receipts for schools in Carlisle County. Tax is paid by all consumers of utilities as an add-on to the utilities bills. Exempted are receipts from utilities services that are resold and the receipts from the sale of energy or energy producing fuels that exceed 3 percent of the cost of production in manufacturing, processing, mining or refining.

## State and Local Property Taxes

All property in Kentucky, except items exempted by the state constitution, is taxed by the state. Property which also may be taxed by local jurisdictions includes land and buildings, finished goods inventories, automobiles, trucks, office furniture and office equipment. Local taxing jurisdictions in Kentucky include counties, cities, and school districts.

All property in Kentucky is assessed at 100 percent of fair cash value.

### COMBINED STATE AND LOCAL RATES PER \$100 VALUATION, 1986

	Arlington	Bardwell	Unincorporated Carlisle County
Land and Buildings	\$1.0623	\$0.8923	\$0.6323
Manufacturing			
Machinery	0.1500	0.1500	0.1500
Pollution Control			
Equipment	0.1500	0.1500	0.1500
Inventories			
Raw materials	0.0010	0.0010	0.0010
Goods in Process	0.0010	0.0010	0.0010
Finished Goods	0.8479	0.6779	0.4179
Automobiles & Trucks	1.2989	1.1289	0.8689
Other Tangible			
Personal Property	1.2969	1.1269	0.8669
Intangibles (Accounts receivable*, money in hand, stock, notes, bonds)	0.2500	0.2500	0.2500
Goods Stored in Public Warehouses in Transit Status	0.0010	0.0010	0.0010
Private Leaseholds in Industrial Revenue Bond Financed Facilities	0.0150	0.0150	0.0150

\* Accounts receivable are taxed at 85 percent of face value, for an effective rate of \$0.2125 per \$100 valuation.

## Safety

Police	Arlington	Bardwell	Carlisle County
Total staff	1	1	2
Radio-patrol cars	1	1	1
<b>Fire*</b>			
Insurance Services Office, Public Protection Classification	7	8	**
Full-time staff	1	-	-
Volunteers	25	12	40
<b>Rescue Service</b>			

Carlisle County is provided rescue service by the Carlisle County Rescue Squad.

## Refuse Collection and Disposal

Refuse collection is provided by private contractors for Carlisle County.

\* Includes copyrighted material of ISO Commercial Risk Services, Inc., with its permission.

\*\* The fire protection districts of Cunningham and Lovelaceville have an insurance rating of class 9. Fancy Farm has a class rating of 8 in which the recognized protection is limited to 3 road miles from the responding fire station. Class 10 applies to unincorporated areas in Carlisle County not contained within a fire district.

## EDUCATION

### Public Schools

	Carlisle County*
Total Enrollment (Spring 1987)	931
Kindergarten	78
Elementary	359
Middle School	193
High School	301
Pupil-Teacher Ratio (1985-86)	19 to 1
Percent High School Graduates to College (1985-86)	50.0
Expenditures Per Pupil (1985-86)	\$2,020.16

\* The Carlisle County School System is currently renovating the high school and building a large storage barn. Cost of both projects is estimated to be \$600,000. The completion date is scheduled for fall of 1988.

Area Colleges and Universities

<u>Name</u>	<u>Location (Miles distant)</u>	<u>Enrollment (Fall, 1986)</u>	<u>Highest Degree Conferred</u>
Paducah Community College	Paducah, Kentucky (30)	2,005	Associate
Murray State University	Murray, Kentucky (31)	7,073	Masters, Specialist*
University of Tennessee at Martin	Martin, Tennessee (41)	5,534	Masters
Bethel College	McKenzie, Tennessee (62)	471	Baccalaureate
Southeast Missouri State University	Cape Girardeau, Missouri (50)	9,017	Masters
Southern Illinois University at Carbondale	Carbondale, Illinois (65)	23,733	Academic & Professional

\* Joint doctoral degree programs are offered in cooperation with the University of Kentucky, Lexington. The degrees are issued by the University of Kentucky.



## Vocational Training

The Bluegrass State Skills Corporation, an independent public corporation created and funded by the Kentucky General Assembly, provides programs of skills training to meet the needs of business and industry from entry level to advanced training, and from upgrading present employees to retraining experienced workers.

The Bluegrass State Skills Corporation is the primary source for skills training assistance for a new or existing company. The Corporation works in partnership with other employment and job training resources and programs, as well as Kentucky's economic development activities, to package a program customized to meet the specific needs of a company.

Vocational training is available at both the state vocational-technical schools and the area vocational education centers. The state vocational-technical schools are post-secondary institutions. The area vocational education centers are designed to supplement the curriculum of high school students. Both the state vocational-technical schools and the area vocational education centers offer evening courses to enable working adults to upgrade current job skills.

Arrangements can be made to provide training in the specific production skills required by an industrial plant. Instruction may be conducted either in the vocational school or in the industrial plant, depending upon the desired arrangement and the availability of special equipment.

(Continued)

Nearest State School

West Kentucky State Vocational-Technical School  
Paducah, 30 miles distant

Business & Office	Auto Mechanics
Accounting/Management	Carpentry
Clerical	Civil & Highway Technology
Secretarial	Diesel Mechanics
Word Processing	Electricity
Health Occupations	Electronics
Dental Assisting	Graphic Arts
Medical Assisting	Masonry
Practical Nursing	Machine Shop
Radiologic Technology	Tailoring
Respiratory Therapy	Welding
Technician	Learning Resource Center
Surgical Technology	Special Vocational Programs
Personal Services Occupations	Vocational Improvement Program
Barbering	Public Service Occupations
Cosmetology	Business/Industry Security
Consumer & Home Economics	Training
Commercial Foods	CPR Training
Consumer & Family Life	Electrical Safety Training
Skills	Emergency Medical Care
Industrial Education	Fire Service Training
Air Conditioning	First Aid & Safety
Drafting	Rescue & Emergency Services
Auto Body Repair	Training

Nearest Area Education Centers

Ballard County Area Vocational Education Center  
Barlow, 16 miles distant

Business & Office	Auto Mechanics
Accounting Management	Carpentry
Clerical	Electricity
Secretarial	
Industrial Education	
Auto Body Repair	

(Continued)

Paducah Area Vocational Education Center  
Paducah, 30 miles distant

Health & Personal Services

Occupations

    Cosmetology

    Health Services

Industrial Education

    Auto Body Repair

    Auto Mechanics

    Carpentry

    Electricity

Electronics

Machine Shop

Masonry

Small Engine Repair

Welding

Special Vocation

Developmental Occupation

    Program

Learning Resource Center

## HEALTH

### Local Medical Personnel

Physicians - 3

Dentists - 1

### Hospitals

<u>General Hospital</u>	<u>Location</u>	<u>Beds</u>
Parkway Regional	Fulton, 29 miles south	70
Community Hospital, Inc.	Mayfield, 31 miles east	116

#### Parkway Regional

Medical staff - 33 doctors, 23 registered nurses, and 19 licensed practical nurses

#### Community Hospital, Inc.

Medical staff - 25 doctors, 39 registered nurses, 33 licensed practical nurses

### Other Medical Facilities

Carlisle County Health Department  
Western Baptist Outpatient Clinic (Bardwell)

### Ambulance Service

Name - Carlisle County Emergency Ambulance Service  
Staff - Five emergency medical technicians

## OTHER LOCAL FACILITIES

### Communications

Telephone -	Continental Telephone Company of Kentucky
Telegraph -	Western Union Toll-Free number, 1-800-325-6000
Newspapers - Wednesday only - Thursday only -	Carlisle County Courier - 1,650 Carlisle County News - 2,250
Television - Airwave reception from -	Paducah, Kentucky; Cape Girardeau, Missouri; and Harrisburg, Illinois Bardwell and Arlington
Cable service - Educational Television -	The Kentucky Educational Television (K.E.T.) network is available statewide

### Library Services

Carlisle County is served by a bookmobile. The bookmobile route originates from the Carlisle County High School located in Bardwell.

### Religious Institutions

Denominations -	Assembly of God Baptist Catholic	Christian Church of Christ Methodist
Nearest Synagogues - Congregations -	Paducah, Kentucky (30 miles northeast of Bardwell) Temple Israel (reform)	

### Financial Institutions

<u>Banks</u>	<u>Assets</u>	<u>Deposits</u>	<u>Statement Date</u>
Bardwell Deposit Bank	\$29,111,630.41	\$10,830,762.90	12/31/86
Citizens Deposit Bank of Arlington	19,414,353.44	16,716,099.29	12/31/86

## RECREATION

### Local

The 20-acre Carlisle County Park near Bardwell features a community center, a ball diamond, a horse show ring, two lighted tennis courts, shelter and picnic facilities, and public restrooms.

The Arlington American Legion Park, which is privately owned and operated, features a five-acre site with two ball diamonds and skating rink, and concession stand.

The Winford Hunting Preserve in Carlisle County features a 235-acre hunting and fishing area with eastern woodlands and swamp terrain. The preserve is state owned and maintained.

The Great River Road promises to help boost tourist and recreational opportunities for the county. This scenic drive along the Mississippi River from New Orleans, Louisiana, to Canada has unlimited potential to bring new recreational benefits to the area.

### Area (Within 60 miles)

A Confederate cannon, a network of earthen trenches, and a massive chain and anchor give the feeling of being transported back to the Civil War. All of this and more can be discovered at **Columbus-Belmont Battlefield State Park** at Columbus, 11 miles southwest of Bardwell. Other attractions at the 156-acre park include a 38-site campground, a gift shop, a historical hiking trail, miniature golf, a picnic area, and a playground. A visit to the museum at the park, which is in a building that served as a Civil War infirmary, offers a display of Civil War relics and early Indian artifacts and an audiovisual slide program on the Battle of Belmont.

The **Ballard County Wildlife Management Area**, 21 miles north of Bardwell, offers an 8,400-acre paradise for hunters and fishermen. There are controlled hunting seasons on dove, squirrel, and water fowl. Easy access roads provide designated areas for picnicking and camping during the summer season. Some of the wild animals and fowl that might be seen are whitetail deer, wild turkeys and eagles. In addition, hunting and fishing are welcomed in many privately owned areas throughout the four counties.

**Reelfoot Lake** and the **Kentucky Bend** are located in southwest Fulton County, 43 miles southwest of Bardwell. Reelfoot Lake is a 70-square-mile lake in Kentucky and Tennessee known for its fishing. Kentucky maintains a 2,000-acre wildlife area near the lake for hunting. The Kentucky Bend is land totally separated from the state by the Mississippi River.

**Kentucky Lake**, 50 miles northeast of Bardwell, is one of the top fishing, water sport and recreational areas in southeastern United States. The 184-mile-long lake, covering more than 160,300 total surface acres of water, was impounded from the Tennessee River in 1944 by the Tennessee Valley Authority.

Kentucky Dam Village State Resort Park, located 50 miles east of Bardwell near Gilbertsville, is one of the largest and most popular vacation resorts in Kentucky. A modern lodge with 46 rooms, 67 cottages, and a 225-site campground make up the accommodations. The park includes a 4,000-foot lighted airstrip. There is also a dining room overlooking Kentucky Lake, a coffee shop, a snack bar, two gift shops, a meeting room, an activities center, and a recreation room. Recreational activities to choose from include boating and fishing at the largest docking facility in the Kentucky parks system, golf at the 18-hole Village Green Course, fishing, hiking, horseback riding, picnicking, swimming at the lodge pool or off the sand beach, and tennis.

Lake Barkley, "twin" to Kentucky Lake, 55 miles northeast of Bardwell, is a 118-mile-long impoundment of the Cumberland River. The two lakes are connected by a 1 3/4-mile-long freeflowing canal at their northern ends. Lake Barkley is a major fishing and recreational area covering approximately 58,000 acres.

The Land Between the Lakes, located on a 170,000-acre wooded peninsula, is an outdoor recreational and conservational education center. The Golden Pond Visitors Center offers a multimedia theatre/planetarium and observatory. Camping, swimming, fishing, boating, hiking, a buffalo herd on a 250-acre range, an Environmental Education Center for school study groups, an educational farm and a central station with films and displays are among the attractions. Kentucky Lake and Lake Barkley are among the top fishing and water sport recreation areas in the southeastern United States. The Land Between the Lakes area is 60 miles northeast of Bardwell.

Charm and serenity exemplify Kenlake State Resort Park which is located on Kentucky Lake, 60 miles southeast of Bardwell. The park offers hotel and cottage accommodations and an efficient camping site. Other facilities include a 9-hole golf course, pool and lake swimming, horseback riding, hiking trails, fishing, boating, picnicking, planned recreation, and one of the finest tennis complexes in the area.

## COMMUNITY IMPROVEMENTS

### Recent

The City of Arlington has completed construction of a new water treatment plant. The new plant has a 576,000-gallon per day treatment capacity. In addition, storage capacity was increased to 212,000 gallons and several 2- and 4-inch lines were replaced by 6-inch lines. Cost of the project was \$610,000.

All city streets in Arlington have been recently repaved at a cost of \$80,000. A new city hall and fire station was recently constructed at a cost of \$100,000 and two new fire trucks were purchased at an additional \$100,000. A new Community Center was completed in 1987 at a cost of \$8,000. Over \$42,000 in compliance improvements will have taken place at the sewage treatment plant by the end of 1987. The Citizens Deposit Bank has just completed construction of its new bank building at a cost of \$330,000. Cable TV service was recently installed at a cost of \$85,000. Over \$300,000 in construction of section 8 housing has taken place recently in Arlington.

A \$4,000 improvement at the Milburn Community Center has recently taken place.

Over 4 miles of grade and drain work have taken place recently along Carlisle County roads. Several county bridge improvement projects has been completed at a cost of \$200,000.

### Under Way

Construction of a new Community Center at Cunningham is under way. Completion is scheduled for September 1987.

The Carlisle County School System is currently renovating the high school and building a large storage barn. Cost of both projects is estimated to be \$600,000 and the completion date is scheduled for the fall of 1988.

### Planned

Tentative plans are under way to construct an air strip near Bardwell.



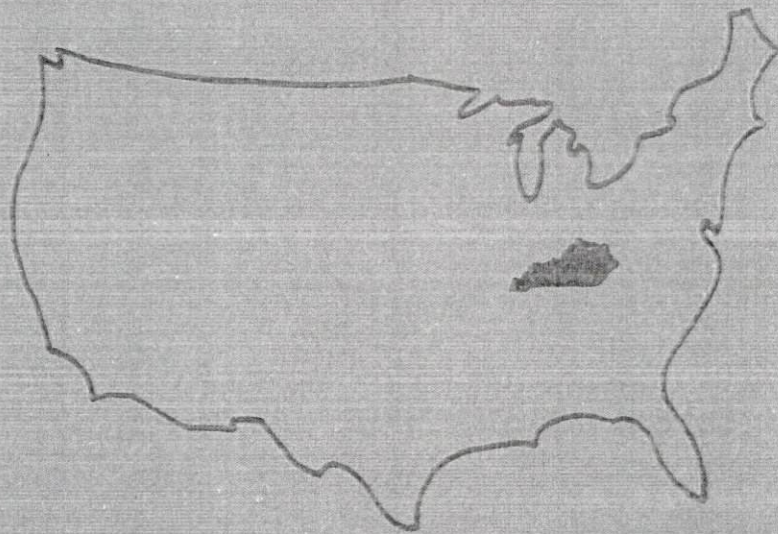

**Kentucky Commerce Cabinet  
Department of Economic Development  
Capital Plaza Tower  
Frankfort, Kentucky 40601  
(502) 564-7140**