

1988

Industrial Resources: Lawrence County - Louisa

Kentucky Library Research Collections
Western Kentucky University, spcol@wku.edu

Follow this and additional works at: https://digitalcommons.wku.edu/lawrence_cty

 Part of the [Business Administration, Management, and Operations Commons](#), [Growth and Development Commons](#), and the [Infrastructure Commons](#)

Recommended Citation

Kentucky Library Research Collections, "Industrial Resources: Lawrence County - Louisa" (1988). *Lawrence County*. Paper 6.
https://digitalcommons.wku.edu/lawrence_cty/6

This Report is brought to you for free and open access by TopSCHOLAR®. It has been accepted for inclusion in Lawrence County by an authorized administrator of TopSCHOLAR®. For more information, please contact topscholar@wku.edu.

RESOURCES FOR ECONOMIC DEVELOPMENT

Louisa

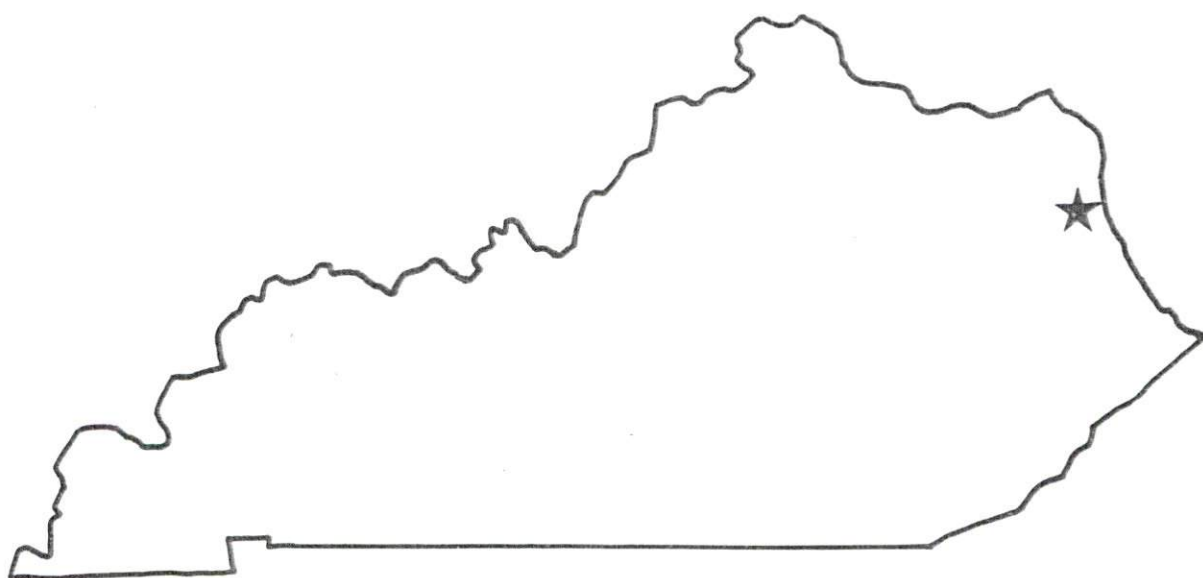

KENTUCKY
Open for Business

LOUISA, KENTUCKY --- Site 188 --- 12 Acres

For more information contact the Cabinet for Economic Development, Department of Business Development,
Industrial Development & Marketing Division, Capital Plaza Tower, Frankfort, Kentucky 40601
(502-564-7140)

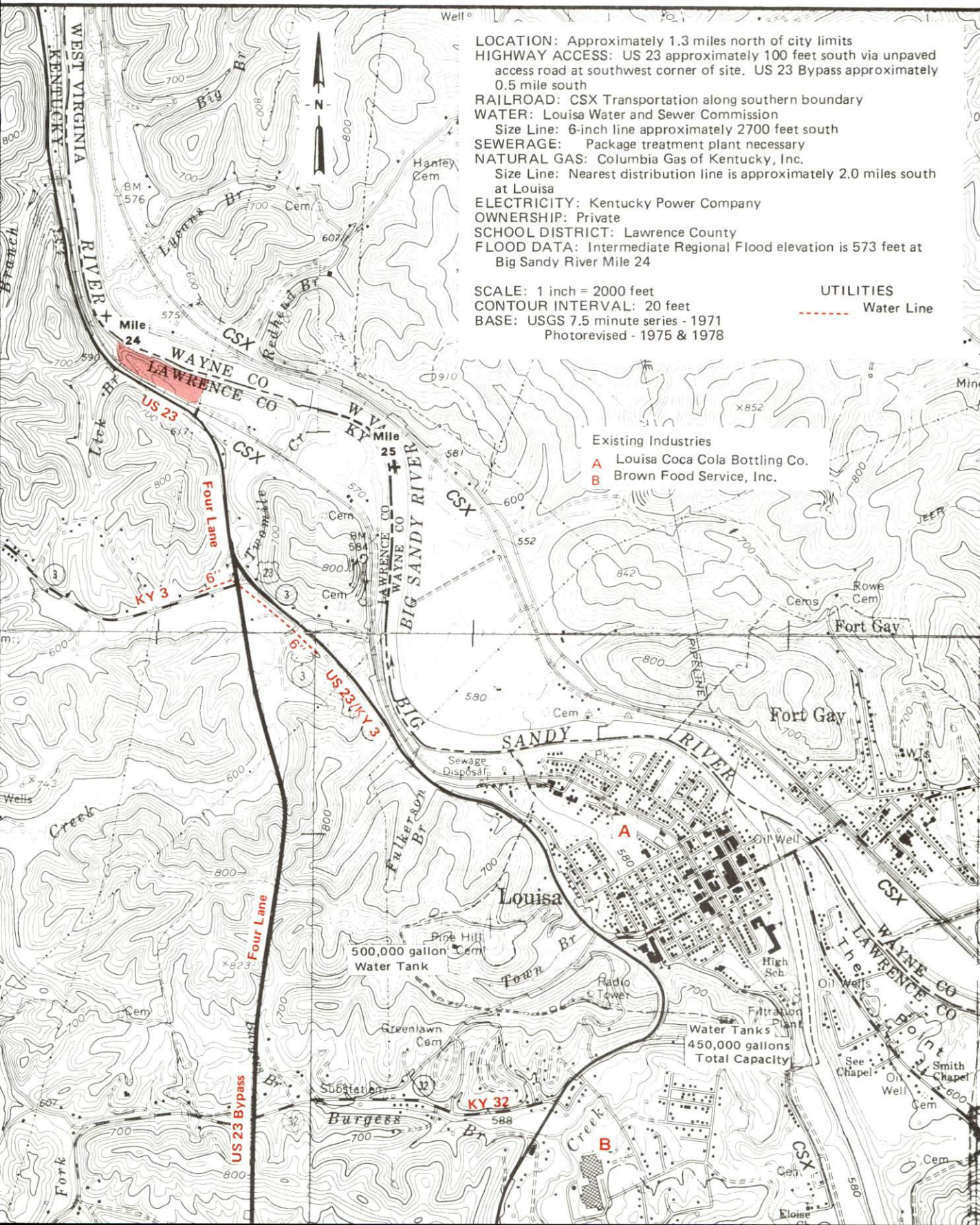

LOCATION: Approximately 1.3 miles north of city limits
HIGHWAY ACCESS: US 23 approximately 100 feet south via unpaved access road at southwest corner of site. US 23 Bypass approximately 0.5 mile south
RAILROAD: CSX Transportation along southern boundary
WATER: Louisa Water and Sewer Commission
Size Line: 6-inch line approximately 2700 feet south
SEWERAGE: Package treatment plant necessary
NATURAL GAS: Columbia Gas of Kentucky, Inc.
Size Line: Nearest distribution line is approximately 2.0 miles south at Louisa
ELECTRICITY: Kentucky Power Company
OWNERSHIP: Private
SCHOOL DISTRICT: Lawrence County
FLOOD DATA: Intermediate Regional Flood elevation is 573 feet at Big Sandy River Mile 24

SCALE: 1 inch = 2000 feet
CONTOUR INTERVAL: 20 feet
BASE: USGS 7.5 minute series - 1971
 Photorevised - 1975 & 1978

UTILITIES
 ----- Water Line

Existing Industries
A Louisa Coca Cola Bottling Co.
B Brown Food Service, Inc.

RESOURCES FOR ECONOMIC DEVELOPMENT
LOUISA, KENTUCKY

Prepared by
The Kentucky Department of Business Development
Division of Research and Planning
in cooperation with
The Greater Louisa Industrial Foundation

1988

Program manager - Andrew Dennis; research - Barry K. Holder, Jr.; clerical - Bobbi Graves; graphics - Tony Cecconi, Robert Owens, Pat Coleman; cartography - Site Evaluation Branch, Division of Industrial Development and Marketing. Cost of printing paid from state funds.

TABLE OF CONTENTS

<u>Chapter</u>	<u>Page</u>
INDUSTRIAL SITES	i
LOUISA, KENTUCKY - A RESOURCE PROFILE	1
THE LABOR MARKET STATISTICS	2
Labor Market Area Map	2
Population	3
Population Projections	3
Unemployment Rates, 1980-1987 - Line Chart	4
Labor Force Characteristics of Residents, 1987	5
Selected Components of Nonagricultural Employment, by Place of Work, 1986	5
Estimated Male Labor Supply	6
Estimated Female Labor Supply	6
Average Placement Wages	7
Per Capita Personal Income	7
Average Weekly Wages of Workers Covered by Unemployment Insurance F.Y. 1986-87 - Bar Chart	8
Average Weekly Wages by Industry, by Place of Work, 1986.	9
EXISTING INDUSTRY	10
Louisa Manufacturing Firms, Their Products and Employment	10
Labor Organizations in Manufacturing Firms	10
Major Non-Manufacturing Firms.	10
Selected Industrial Services.	11
TRANSPORTATION	12
Rail	12
Highways.	12
Truck Service.	12
Air	13
Air Express Service	14
Water	14
POWER AND FUEL	15
Electricity	15
Natural Gas	16
Other Fuels	16
WATER AND SEWERAGE	17
Public Water Supply	17
Sewerage	18

<u>Chapter</u>	<u>Page</u>
CLIMATE	21
LOCAL GOVERNMENT	22
Structure	22
Planning and Zoning	22
Local Fees and Licenses	22
State and Local Property Taxes	23
Combined State and Local Rates Per \$100 Valuation, 1987	23
Safety	24
Police	24
Fire	24
Rescue Service	24
Refuse Collection and Disposal	24
EDUCATION	25
Public Schools	25
Area Colleges and Universities	26
Vocational Training	27
HEALTH	29
Local Medical Personnel	29
Hospitals	29
Other Medical Facilities	29
Ambulance Service	29
OTHER LOCAL FACILITIES	30
Communications	30
Library Services	30
Religious Institutions	30
Financial Institutions	31
Hotels and Motels	31
Clubs and Organizations	31
RECREATION	32
COMMUNITY IMPROVEMENTS	34

LOUISA, KENTUCKY - A RESOURCE PROFILE

Louisa, the county seat of Lawrence County, lies on the Kentucky-West Virginia border in the northeastern section of Kentucky's Eastern Coal Fields Region. Lawrence County's eastern border is formed by the Big Sandy River. Its river valleys become narrower and the elevation generally higher as one moves westward.

Louisa is located 33 miles south of Ashland, Kentucky; 84 miles southwest of Charleston, West Virginia; 247 miles northeast of Knoxville, Tennessee; and 212 miles east of Louisville, Kentucky. Louisa had an estimated population of 1,820 in 1986, while Lawrence County, with a land area of 420 square miles, had an estimated population of 14,417 in 1986.

The Economic Framework - The total number of Lawrence County residents employed in 1987 averaged 4,160. In 1986, manufacturing firms in the county reported 50 employees; wholesale and retail trade provided 500 jobs; 380 people were employed in service occupations; state and local government accounted for 435 employees; contract construction firms provided 90 jobs; and 150 people were employed by mining and quarrying operations.

Labor Supply - There is a current estimated labor supply of 16,690 men and 20,750 women available for industrial jobs in the labor market area. In addition, from 1988 through 1992, 6,580 young men and 6,380 young women in the area will become 18 years of age and potentially available for industrial jobs.

Transportation - CSX Transportation provides main line rail service to Louisa. U.S. Highway 23, a "AAA"-rated (80,000-pound gross load limit) trucking highway, serves Louisa and provides access to Interstate Highway 64, 25 miles north of Louisa. Kentucky Highways 3 and 32, both "AA"-rated (62,000-pound gross load limit) trucking highways, also serve Louisa. U.S. Highway 52 is located just across the Kentucky-West Virginia border via West Virginia Route 37. Three common carrier trucking companies serve Louisa, providing both interstate and intrastate service. The nearest scheduled commercial airline service is available at Tri-State Airport, 31 miles northeast of Louisa near Huntington, West Virginia.

Power and Fuel - Kentucky Power Company, an electric power generation and transmission company, serves Louisa and a major portion of Lawrence County. The remainder of the county is served by the Big Sandy Rural Electric Cooperative Corporation and the Grayson Rural Electric Cooperative Corporation. Columbia Gas of Kentucky, Inc., provides natural gas service to Louisa. There are two propane distributors and two distillate fuel oil dealers within 35 miles of Louisa.

Education - The Lawrence County Public Schools provide primary and secondary education to students in Lawrence County. Nine institutions of higher learning are located within 75 miles of Louisa. The Mayo State Vocational-Technical School at Paintsville and the Ashland State Vocational-Technical School at Ashland are located within 35 miles of Louisa.

LABOR MARKET STATISTICS

The Louisa Labor Market Area includes Lawrence County and the adjoining Kentucky counties of Boyd, Carter, Elliott, Johnson, Martin, and Morgan. In addition, the Labor Market Area is supplemented by Wayne County in West Virginia, which forms the eastern boundary of Lawrence County.

POPULATION

Area	1986*	1980	1970	Percent Nonwhite
				1980
Louisa	1,820	1,832	1,781	2.1
Blaine	340	358	168	0.3
Labor Market Area	151,913	152,062	125,820	-
Lawrence County	14,417	14,121	10,726	0.4
Boyd County	53,268	55,513	52,376	2.3
Carter County	25,440	25,060	19,850	0.2
Elliott County	6,630	6,908	5,933	0.0
Johnson County	25,822	24,432	17,539	0.3
Martin County	14,350	13,925	9,377	0.2
Morgan County	11,986	12,103	10,019	0.4

* Population estimates.

Note: The 1980 city counts of population by race are provisional.

Sources: U.S. Department of Commerce, Bureau of the Census, 1980 Census of Population and Housing, March 1981; 1980 Census of Population, Number of Inhabitants. University of Louisville, Urban Studies Center, Population Unit.

POPULATION PROJECTIONS

Area	1990	1995	2000	2010
Labor Market Area	164,112	172,001	178,485	188,416
Lawrence County	16,826	18,544	20,005	22,614
Boyd County	56,503	57,664	58,356	58,665
Carter County	27,007	28,144	29,114	30,571
Elliott County	7,275	7,600	7,905	8,355
Johnson County	28,235	30,364	32,113	35,081
Martin County	15,669	16,662	17,583	19,105
Morgan County	12,597	13,023	13,409	14,025

Source: University of Louisville, Urban Studies Center, Population Research Unit, How Many Kentuckians: Population Forecasts, 1980-2020, the 1986 Edition, Spring 1986.

UNEMPLOYMENT RATES

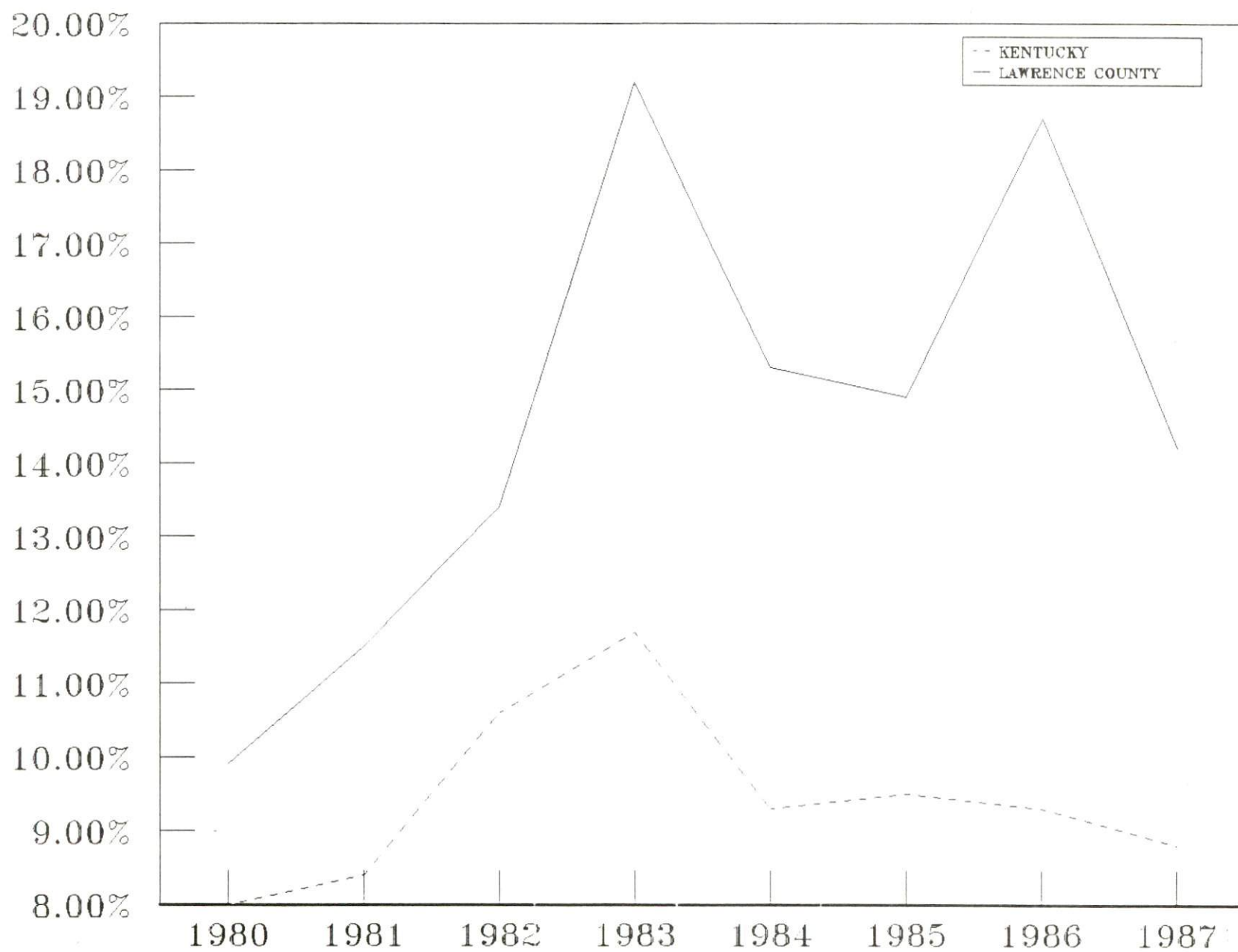

LABOR FORCE CHARACTERISTICS OF RESIDENTS, 1987

	Lawrence County	Labor Market Area*
Civilian Labor Force	4,845	52,994
Employment	4,157	45,225
Unemployment	688	7,769
Rate of Unemployment (%)	14.2	14.7

* Includes Lawrence County and the adjoining Kentucky counties.

Source: Kentucky Cabinet for Human Resources, Kentucky Labor Force Estimates, Annual Averages, 1987.

SELECTED COMPONENTS OF NONAGRICULTURAL EMPLOYMENT BY PLACE OF WORK, 1986

	Lawrence County	Labor Market Area*
All Industries (total)	1,962	36,758
Manufacturing	52	6,042
Wholesale & Retail Trade	501	9,708
Services	384	6,057
State/Local Government	435	5,693
Contract Construction	94	1,538
Mining & Quarrying	147	3,145

* Includes Lawrence County and the adjoining Kentucky counties.

Note: Excludes domestic workers, railway workers, certain nonprofit corporations, majority of federal government workers, and self-employed workers.

Source: Kentucky Cabinet for Human Resources, Average Monthly Workers Covered by Kentucky Unemployment Insurance Law, 1986.

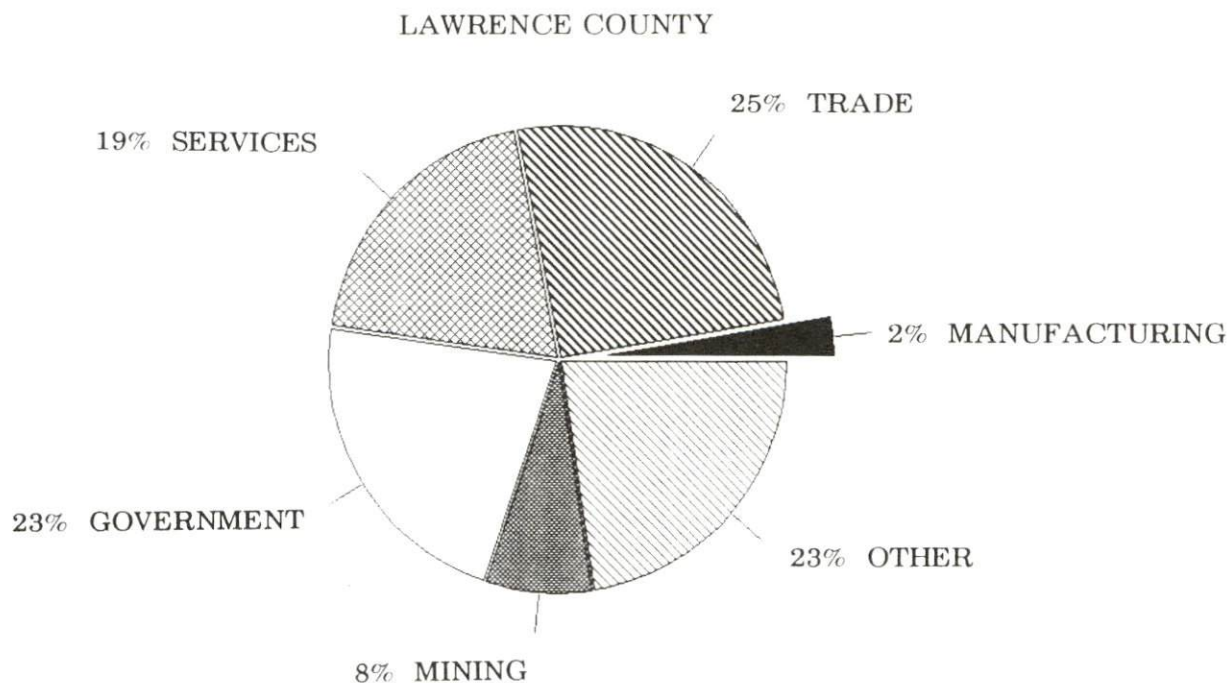

ESTIMATED MALE LABOR SUPPLY
LOUISA LABOR MARKET AREA

Area	Current				Future
	Total Male	Unemployed	Under-employed	Not in Labor Force	Becoming 18 years of age 1988 thru 1992
Labor Market					
Area*	16,694	5,958	3,876	6,860	6,580
Lawrence	1,958	633	367	958	618
Boyd	4,301	1,578	1,273	1,450	2,079
Carter	2,839	1,459	757	623	1,144
Elliott	1,294	332	294	668	346
Johnson	2,764	865	563	1,336	1,078
Martin	1,879	467	240	1,172	729
Morgan	1,659	624	382	653	586

ESTIMATED FEMALE LABOR SUPPLY
LOUISA LABOR MARKET AREA

Area	Current				Future
	Total Female	Unemployed	Under-employed	Not in Labor Force	Becoming 18 years of age 1988 thru 1992
Labor Market					
Area*	20,751	3,053	3,139	14,559	6,379
Lawrence	2,190	273	263	1,654	630
Boyd	6,599	883	1,290	4,426	2,092
Carter	3,221	772	488	1,961	1,095
Elliott	1,072	83	152	837	305
Johnson	3,474	677	442	2,355	1,017
Martin	2,436	173	303	1,960	729
Morgan	1,759	192	201	1,366	511

* Additional workers may be drawn from other nearby counties.

Note: Unemployed - persons unemployed and actively seeking work; Underemployed - persons employed but working only 14 to 26 weeks per year; Not in Labor Force - represents the number of persons who would enter the labor force if suitable employment were available (based on the assumption that persons in Kentucky would like to participate in the labor force in the same proportion that they do nationally).

Sources: Kentucky Cabinet for Human Resources, Kentucky Labor Supply Estimates by County, 1986. Kentucky Department of Economic Development, Future Labor Supply Becoming 18 Years of Age, 1988 thru 1992.

AVERAGE PLACEMENT WAGES

Lawrence County is served by the Ashland local office of the Kentucky Department for Employment Services. The focus of the following data is on job placements made by the Ashland local office and may therefore be used as an indicator of the wages which employers in the area pay new employees. During the twelve months which ended on June 30, 1987, the local employment office filled 2,649 job openings in various occupational categories. The average hourly wage for selected occupational categories were:

<u>OCCUPATIONAL CATEGORY</u>	<u>NUMBER OF PLACEMENTS</u>	<u>AVERAGE WAGE(\$)</u>
All Occupations	2,649	3.95
Clerical	793	3.45
Sales	163	3.71
Services (excluding domestic)	996	3.31
Agricultural, Fishery, Forestry, etc.	8	4.71
Processing	154	8.70
Machine Trades	45	5.98
Bench Work	93	3.39
Structural	138	4.86
Motor Freight/ Transportation	63	5.34
Packaging and Materials Handling	120	4.37
Other	6	5.67

The Ashland local office also serves Boyd, Carter, Elliott, Greenup, and Lawrence Counties. The above occupational categories are taken from the Dictionary of Occupational Titles published by the U.S. Department of Labor.

Source: Kentucky Cabinet for Human Resources, Department for Employment Services.

PER CAPITA PERSONAL INCOME

<u>Area</u>	<u>1980</u>	<u>1984</u>	<u>Percent Change</u>
Lawrence County	\$ 5,814	\$ 7,249	24.7
Labor Market Area Range*	\$4,405 - 9,432	\$5,395 - 11,335	-
Kentucky	7,644	10,232	33.9
U.S.	9,494	12,772	34.5

* Includes Lawrence County and the adjoining Kentucky counties.

Sources: U.S. Department of Commerce, Bureau of Economic Analysis. Kentucky Economic Information System, June 1986.

AVERAGE WEEKLY WAGES OF WORKERS COVERED BY
UNEMPLOYMENT INSURANCE F.Y. 1986-87

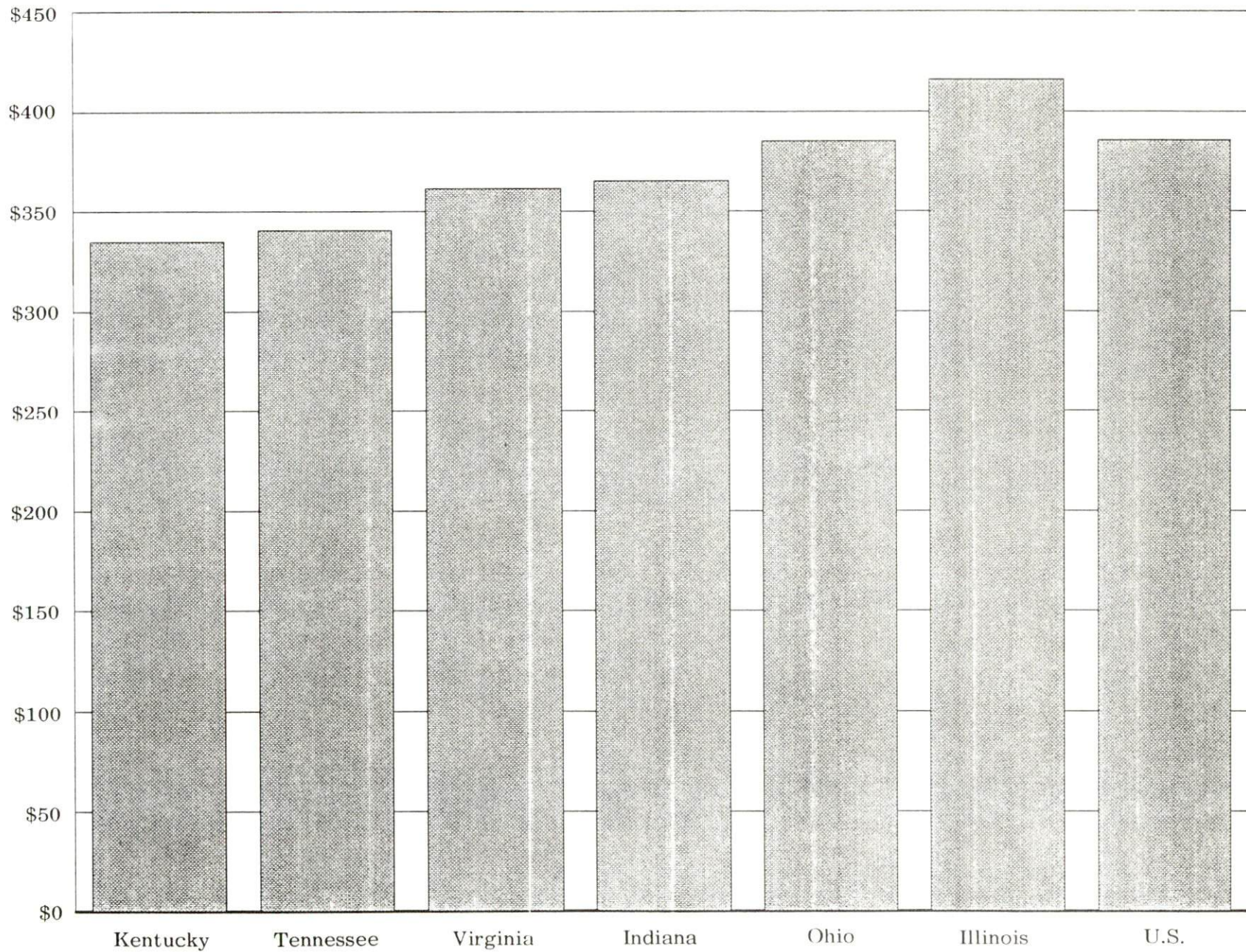

AVERAGE WEEKLY WAGES BY INDUSTRY
BY PLACE OF WORK, 1986

	Lawrence County	Boyd County	Carter County	Elliott County
All Industries	\$296.76	\$365.29	\$240.97	\$246.46
Mining & Quarrying	409.42	379.93	388.76	314.66
Contract Construction	274.20	396.67	384.61	*
Manufacturing	224.42	544.34	187.86	172.94
Transportation, Communications & Public Utilities	*	495.23	419.44	386.72
Wholesale & Retail Trade	190.30	225.19	170.34	128.70
Finance, Insurance & Real Estate	250.90	389.94	261.43	245.88
Services	250.81	295.70	173.98	133.52
State/Local Government	282.27	330.88	310.71	264.12
Other	*	205.31	162.28	0
	Johnson County	Martin County	Morgan County	
All Industries	\$281.61	\$559.73	\$264.48	
Mining & Quarrying	426.19	755.64	433.46	
Contract Construction	221.29	549.55	255.26	
Manufacturing	*	*	180.57	
Transportation, Communications & Public Utilities	384.92	331.03	333.43	
Wholesale & Retail Trade	225.42	210.37	189.58	
Finance, Insurance & Real Estate	301.76	*	305.35	
Services	255.27	318.11	241.99	
State/Local Government	300.63	255.25	296.25	
Other	328.30	*	102.65	

* Not disclosed.

Note: The average weekly wage for each category includes the salaries and wages of all persons working for that type business. For example, the manufacturing category includes both production workers and administrative personnel. Excludes domestic workers, railway workers, certain nonprofit corporations, majority of federal government workers, and self-employed workers.

Source: Kentucky Cabinet for Human Resources, Average Weekly Wages of Workers Covered by Kentucky Unemployment Insurance Law, 1986.

EXISTING INDUSTRY

LOUISA MANUFACTURING FIRMS, THEIR PRODUCTS AND EMPLOYMENT

Firm (Establishment date)	Product	Average Employment		
		Total	Male	Female
Big Sandy Publishing Company, Inc. (1885)	Newspaper	7	2	5
Louisa Coca-Cola Bottling Company (1905)	Soft drinks	16	14	2
Louisa Supply Company, Inc. (1915)	Feed	8	6	2
Mid-American Printing Corporation (1988)	Business forms, publishing, graphic designs	3	-	-
Mosley Machine, Inc. (1984)	Machine shop, diesel engine repair	5	4	1
Pyramid Enterprises (1983)	Offset printing, special effects graphics	3	-	-

Sources: Kentucky Department of Economic Development, 1988 Kentucky Directory of Manufacturers; Division of Research and Planning.

LABOR ORGANIZATIONS IN MANUFACTURING FIRMS

Presently, there are no labor unions representing workers in Louisa manufacturing firms.

MAJOR NON-MANUFACTURING FIRMS

Brown Food Service, a distribution center for institutional foods and supplies, is a major non-manufacturing employer in Louisa. The operation has an employment of 105, and serves eastern Kentucky, southern Ohio, and nearby counties in Virginia and West Virginia.

SELECTED INDUSTRIAL SERVICES

<u>Types of Service</u>	<u>Location</u>	<u>Mileage from Louisa</u>
Custom Data Processing	Prestonsburg, Kentucky	44
Custom Plastics Producers	Ashland, Kentucky	33
Electric Motor Repair	Huntington, West Virginia	34
Grinding, Precision & Tool	Huntington, West Virginia	34
Heat Treating Facilities	Lexington, Kentucky	140
Industrial Equipment & Supplies	Ashland, Kentucky	33
	Huntington, West Virginia	34
Industrial Gases	Huntington, West Virginia	34
Industrial Waste Removal	Ashland, Kentucky	33
Machine Shops, Tool & Die	Louisa, Kentucky	
Metal Castings	Cynthiana, Kentucky	149
Metal Finishers	Lexington, Kentucky	140
Metal Service Centers	Huntington, West Virginia	34
Millwrights	Stanton, Kentucky	103
Public Warehouse Facilities	Paris, Kentucky	134

Sources: Kentucky Department of Economic Development, Kentucky Directory of Selected Industrial Services, 1987; Division of Research and Planning.

TRANSPORTATION

Rail

CSX Transportation provides main line rail service to Louisa. The nearest piggyback facilities are provided by Southern Railway System in Georgetown, Kentucky, 152 miles west of Louisa.

For details on routing, schedules, rates, and services contact:

Manager
Industrial Development
CSX Transportation
908 West Broadway
P. O. Box 2157
Louisville, Kentucky 40201
(502) 587-7746

Highways

U.S. Highway 23, a "AAA"-rated (80,000-pound gross load limit) trucking highway, serves Louisa, and connects with Interstate Highway 64, 25 miles north of the city. Kentucky Highways 3 and 32, both "AA"-rated (62,000-pound gross load limit) trucking highways, also serve Louisa. Kentucky Route 645 is a multilane highway from its intersection with U.S. 23, 14 miles south of Louisa, to Inez.

U.S. Highway 52, a major trucking highway, is accessible 2 miles east of Louisa in West Virginia, via West Virginia Route 37.

U.S. Highway 23 was recently widened to four lanes from Paintsville to the Louisa area. Construction of a 3.5-mile bypass around Louisa is under way and scheduled for completion in late 1988.

Truck Service

American Freight System, Inc.*
Manning Motor Express, Inc.**

Overnite Transportation Company**
Yellow Freight System, Inc.**

* Interstate service only.

** Interstate and intrastate service.

Source: American Motor Carrier Directory, Spring 1988.

HIGHWAY MILES AND TRUCK TRANSIT TIME IN DAYS FROM
LOUISA, KENTUCKY, TO SELECTED MARKET CENTERS

City	Highway Miles	Delivery Time TL	City	Highway Miles	Delivery Time TL
Atlanta, GA	440	1	Los Angeles, CA	2,320	3
Baltimore MD	465	1	Louisville, KY	212	1
Birmingham, AL	501	1	Nashville, TN	348	1
Chicago, IL	492	1	New Orleans, LA	843	2
Cincinnati, OH	218	1	New York, NY	637	3
Cleveland, OH	327	1	Pittsburgh, PA	297	2
Detroit, MI	477	1	St. Louis, MO	475	1
Knoxville, TN	247	1			

Note: Mileage computations are via the best interstate or primary highways, not necessarily the most direct route of travel.

Sources: Rand McNally Deluxe Motor Carriers' Road Atlas, 1987. Official Kentucky Mileage Map, 1980. Delivery time - Manning Motor Express, Inc., 601 Cavalry Drive, Glasgow, Kentucky 42141.

Air

Nearest Scheduled Commercial Airline Service*

Location:	Tri-State Airport (Walker-Long Field) 3 miles southwest of Huntington, West Virginia; 31 miles northeast of Louisa
Runways:	2 paved
Length:	6,509 feet and 3,007 feet
Traffic	
Control:	Control tower
Lighting:	Beacon, runway
Services:	Piedmont, USAir, Comair, Christman; fuel - 100LL, jet-A; tie-downs, hangars; major A & P repairs, major Avionics repairs; APU, charter, flight instruction, oxygen, plane rental, survival equipment, U.S. Customs; taxi, limousine, car rental; weather information; restaurant
Air Freight Service:	Air freight terminal

* Other airports located within approximately 40 miles of Louisa include Combs Field southwest of Louisa near Paintsville, Kentucky; the Ashland-Boyd County Airport north of Louisa near Raceland, Kentucky; and the Big Sandy Regional Airport, which maintains a 7,000-foot runway, is located south of Louisa between Prestonsburg and Inez, Kentucky.

Air Express Service

Several major companies offer air express services in Kentucky. These companies provide a quick means of shipping small to medium-sized packages expeditiously.

Water

Louisa is located on the Big Sandy River, approximately 5 miles south of a point where a 6-foot navigation channel begins, and approximately 20 miles south of a point where a 9-foot navigation channel begins. A public riverport is under construction on the Ohio River at Ashland, 33 miles north of Louisa, with completion scheduled for 1989. When completed, the riverport will have railroad frontage; highway access; and facilities for indoor and outdoor storage, coal preparation and loading, and general cargo.

POWER AND FUEL

Electricity

Company serving Louisa and a major portion of Lawrence County - Kentucky
Power Company

Source of power - Kentucky Power Company
For industrial rates contact:

Kentucky Power Company
1701 Central Avenue
P. O. Box 1428
Ashland, Kentucky 41101
(606) 327-1111

Company serving portions of southern and southwestern Lawrence County -
Big Sandy Rural Electric Cooperative Corporation and Grayson Rural
Electric Cooperative Corporation

Source of power - East Kentucky Power Cooperative
For industrial rates contact:

Industrial Development Division
East Kentucky Power Cooperative
P. O. Box 707
Winchester, Kentucky 40391
(606) 744-4812

and/or

Big Sandy RECC
P. O. Box 1746
Paintsville, Kentucky 41240
(606) 789-4095

and/or

Grayson RECC
109 Bagby Park
Grayson, Kentucky 41143
(606) 474-5136

Natural Gas

Company serving Louisa - Columbia Gas of Kentucky, Inc.

Source of supply - Columbia Gas Transmission Corporation

Size of transmission mains - 10 and 20 inches (supplier); 2, 3, 4 and 8 inches (distributor)

Distribution mains - 2 inches through 8 inches

Distribution pressure - 6 ounces to 30 psi

Btu content - 1,020 per cubic foot

Specific gravity - 0.60

For rates and supplies contact:

Division Manager
Columbia Gas of Kentucky, Inc.
1733 Winchester Avenue
Ashland, Kentucky 41101
(606) 324-7114

Other Fuels

Propane (Within 35 miles)

Ferrellgas, Inc.
Route 2, Box 288
Catlettsburg, Kentucky 41129

Hardware Charlie Gas Company
P. O. Box 590
Paintsville, Kentucky 41240

Ferrellgas, Inc.
HC 77, P. O. Box 15
Hagar Hill, Kentucky 41222

Fuel oils

Distillate fuel oil -

Ashland Oil Bulk Plant
Route 4, Box 13A
Louisa, Kentucky 41230

Wheeler Clevenger Oil Company,
Inc.
Court and Madison Streets
Louisa, Kentucky 41230

Residual fuel oil - Arrangements must be made with the refinery.

Low sulphur content coal - Available locally.

WATER AND SEWERAGE

Public Water Supply

Company serving Louisa - City of Louisa, Board of Water and
Sewer Commissioners*
P. O. Box 608
Louisa, Kentucky 41230-0608
(606) 638-9322

Source - Levisa Fork of the Big Sandy River

Treatment plant capacity - 1,300,000 gallons per day

Average daily consumption - 430,000 gallons

Peak daily consumption - 588,000 gallons

Treatment processes - Rapid mix, coagulation, flocculation, sedimentation,
filtration, chlorination, fluoridation

Storage capacity - 1,336,000 gallons (including clear well)

Size lines - 1 1/2 through 12 inches

Water pressure - 30 to 160 psi

MONTHLY WATER RATES

Inside City

First	1,000 gallons (Residential minimum)	\$8.40
First	2,000 gallons (Commercial minimum)	\$10.60

Thereafter:

Usage to	5,000 gallons	\$0.22 per 100 gallons
Next	5,000 gallons	0.19 per 100 gallons
Next	10,000 gallons	0.17 per 100 gallons
Next	30,000 gallons	1.40 per M gallons
Next	50,000 gallons	1.10 per M gallons
All over	100,000 gallons	0.70 per M gallons

Outside City

First	1,000 gallons (Residential minimum)	\$10.40
First	2,000 gallons (Commercial minimum)	\$13.00

Thereafter:

Usage to	5,000 gallons	\$0.26 per 100 gallons
Next	5,000 gallons	0.23 per 100 gallons
Next	10,000 gallons	0.19 per 100 gallons
Next	30,000 gallons	1.60 per M gallons
Next	50,000 gallons	1.20 per M gallons
All over	100,000 gallons	0.80 per M gallons

(Continued)

* The city of Louisa, Board of Water and Sewer Commissioners recently constructed a 79,000-gallon standpipe water storage tank and built water lines at the Yatesville Dam site.

Minimum Charges by Meter Size

Inside City

5/8-inch to 3/4-inch meter - Residential - \$8.40 for 1,000 gallons
Commercial - \$10.60 for 2,000 gallons

	1-inch meter -	\$ 17.20	for	5,000	gallons
1	1/4-inch meter -	22.90	for	8,000	gallons
1	1/2-inch meter -	30.10	for	12,000	gallons
	2-inch meter -	43.70	for	20,000	gallons
	3-inch meter -	85.70	for	50,000	gallons
	4-inch meter -	124.20	for	85,000	gallons
	6-inch meter -	203.70	for	190,000	gallons
	8-inch meter -	315.70	for	350,000	gallons

Outside City

5/8-inch to 3/4-inch meter - Residential - \$10.40 for 1,000 gallons
Commercial - \$13.00 for 2,000 gallons

	1-inch meter -	\$ 20.80	for	5,000	gallons
1	1/4-inch meter -	27.70	for	8,000	gallons
1	1/2-inch meter -	36.10	for	12,000	gallons
	2-inch meter -	51.30	for	20,000	gallons
	3-inch meter -	99.30	for	50,000	gallons
	4-inch meter -	141.30	for	85,000	gallons
	6-inch meter -	231.30	for	190,000	gallons
	8-inch meter -	359.30	for	350,000	gallons

Tap-on charge: Inside city - \$250; Outside city - \$400

Sewerage

Company serving Louisa - City of Louisa, Board of Water and
Sewer Commissioners
P. O. Box 608
Louisa, Kentucky 41230-0608
(606) 638-9322

Design capacity - 1,090,000 gallons per day

Average daily flow - 300,000 gallons

Type of treatment - Secondary

Treatment processes - Screening, grit removal, contact stabilization,
secondary sedimentation, chlorination, aerobic digester, sludge
drying beds

Treated effluent discharged into - Big Sandy River

Size of sanitary mains - 6 through 15 inches

Size of storm mains - Up to 24 inches

(Continued)

Monthly rates - Based upon water usage and size of water meter

MONTHLY SEWER RATES

Inside City

First	1,000 gallons (Residential minimum)	\$10.00
First	2,000 gallons (Commercial minimum)	\$13.00

Thereafter:

Usage to	5,000 gallons	\$0.30 per 100 gallons
Next	5,000 gallons	0.25 per 100 gallons
Next	10,000 gallons	0.20 per 100 gallons
Next	30,000 gallons	1.60 per M gallons
Next	50,000 gallons	1.20 per M gallons
All over	100,000 gallons	.80 per M gallons

Outside City

First	1,000 gallons (Residential minimum)	\$12.00
First	2,000 gallons (Commercial minimum)	\$15.60

Thereafter:

Usage to	5,000 gallons	\$0.36 per 100 gallons
Next	5,000 gallons	0.32 per 100 gallons
Next	10,000 gallons	0.26 per 100 gallons
Next	30,000 gallons	2.20 per M gallons
Next	50,000 gallons	1.70 per M gallons
All over	100,000 gallons	1.20 per M gallons

Minimum Charges by Water Meter Size

Inside City

5/8-inch to 3/4-inch meter -	Residential - \$10.00
	Commercial - \$13.00
1-inch meter -	\$ 22.00 for 5,000 gallons
1 1/4-inch meter -	29.50 for 8,000 gallons
1 1/2-inch meter -	38.50 for 12,000 gallons
2-inch meter -	54.50 for 20,000 gallons
3-inch meter -	102.50 for 50,000 gallons
4-inch meter -	144.50 for 85,000 gallons
6-inch meter -	234.50 for 190,000 gallons
8-inch meter -	362.50 for 350,000 gallons

(Continued)

Outside City

5/8-inch to 3/4-inch meter - Residential - \$12.00
Commercial - \$15.60

	1-inch meter -	\$ 26.40	for	5,000	gallons
1	1/4-inch meter -	36.00	for	8,000	gallons
1	1/2-inch meter -	47.60	for	12,000	gallons
	2-inch meter -	68.40	for	20,000	gallons
	3-inch meter -	134.40	for	50,000	gallons
	4-inch meter -	193.90	for	85,000	gallons
	6-inch meter -	327.40	for	190,000	gallons
	8-inch meter -	519.40	for	350,000	gallons

Tap-on charge: Inside city - \$250; Outside city - \$400

CLIMATE

Lawrence County

Temperature

Normal (30-year record)	55.10 degrees
Average annual 1986	56.70 degrees
Record highest, July 1983 (26-year record)	100.00 degrees
Record lowest, January 1985 (26-year record)	-16.00 degrees
Normal heating degree days (30-year record)	4,676
(Heating degree day totals are the sums of negative departures of average daily temperatures from 65 degrees F.)	

Precipitation

Normal (30-year record)	40.74 inches
Mean annual snowfall (30-year record)	26.40 inches
Total precipitation 1986	39.26 inches
Mean number days precipitation (.01 inch or more) (25-year record)	140.50
Mean number days thunderstorms (24-year record)	42.10

Prevailing winds N/A

Relative Humidity

1 a.m.	78 percent (24-year record)
7 a.m.	83 percent (25-year record)
1 p.m.	59 percent (25-year record)
7 p.m.	61 percent (25-year record)

Source: U.S. Department of Commerce, Environmental Science Services Administration, Climatological Data, 1986. Station of record: Huntington, West Virginia.

LOCAL GOVERNMENT

Structure

The city of Louisa is served by a mayor and six council members. The mayor is elected to a four-year term while the council members each serve two-year terms. Lawrence County is served by a county judge/executive and four magistrates. Each official is elected to a four-year term.

Planning and Zoning

The Lawrence County/Louisa Planning Commission presently is inactive.

Mandatory state codes enforced - Kentucky Plumbing code, National Electric Code, Kentucky Boiler Regulations and Standards, Kentucky Building Code (modeled after BOCA code)

Local Fees and Licenses

Business licenses in Louisa range from \$20 to \$95 annually. A \$30 truck unloading fee and \$10 automobile sticker fee is assessed annually.

State and Local Property Taxes

All property in Kentucky, except items exempted by the state constitution, is taxed by the state. Property which also may be taxed by local jurisdictions includes land and buildings, finished goods inventories, automobiles, trucks, office furniture and office equipment. Local taxing jurisdictions in Kentucky include counties, cities, and school districts.

All property in Kentucky is assessed at 100 percent of fair cash value.

COMBINED STATE AND LOCAL RATES PER \$100 VALUATION, 1987

	Louisa	Unincorporated Lawrence County
Land and Buildings	\$0.9741	\$0.7741
Manufacturing		
Machinery	0.150	0.150
Pollution Control		
Equipment	0.150	0.150
Inventories		
Raw materials	0.001	0.001
Goods in Process	0.001	0.001
Finished Goods	0.7579	0.4069
Automobiles & Trucks	1.0559	0.8559
Other Tangible		
Personal Property	1.2069	1.0069
Intangibles (Accounts		
receivable*, money		
in hand, stock,		
notes, bonds)	0.250	0.250
Goods Stored in Public		
Warehouses in Transit		
Status	0.001	0.001
Private Leaseholds in		
Industrial Revenue		
Bond Financed		
Facilities	0.015	0.015

* Accounts receivable are taxed at 85 percent of face value, for an effective rate of \$0.2125 per \$100 valuation.

Safety

Police	Louisa	Lawrence County
Total staff	4	6
Radio-patrol cars	3	3
Fire*		
Insurance Services Office, Public Protection Classification	7	**
Volunteers	25	66
Rescue Service		

Rescue service is provided to Louisa and Lawrence County by the Louisa Rescue Squad.

Refuse Collection and Disposal

The city of Louisa provides refuse collection and disposal service to commercial and residential customers within the Louisa city limits. Municipal refuse collection outside the city limits is available only to customers of the Louisa Water System.

A franchise service provides refuse collection in Lawrence County. Commercial and industrial customers in unincorporated areas must contract with private firms for this service.

* Includes copyrighted material of ISO Commercial Risk Services, Inc., with its permission.

** Five volunteer fire departments serve Lawrence County. The Big Sandy Fire Protection District has a public protection classification of 9 for all property located within five road miles of its district fire station. Class 10 applies to the remainder of Lawrence County, except for Louisa.

EDUCATION

Public Schools

	Lawrence County*
Total Enrollment (Spring, 1988)	2,969
Kindergarten	238
Elementary	1,225
Middle School	669
High School	837
Pupil-Teacher Ratio (1985-86)	21-1
Percent High School Graduates to College (1985-86)	30.1
Expenditures Per Pupil (1985-86)	\$1,834.04

* Lawrence County School System recently completed several projects, including the reconstruction of gymnasium floors at both the high school and the middle school, construction of a running track, and the installation of an engine analyzer for the vocational school. Total combined cost of the projects was approximately \$100,000. In addition, the school system plans to automate its record system and construct a new roof for Louisa Elementary School.

Area Colleges and Universities

<u>Name</u>	<u>Location (Miles distant)</u>	<u>Enrollment (Fall, 1987)</u>	<u>Highest Degree Conferred</u>
Ashland Community College	Ashland, Kentucky (33)	2,286	Associate
Marshall University	Huntington, West Virginia (34)	12,030	Academic & Professional
Ohio University (Ironton Campus)	Ironton, Ohio (38)	1,406	Academic & Professional
Prestonsburg Community College	Prestonsburg, Kentucky (44)	1,990	Associate
Kentucky Christian College	Grayson, Kentucky (45)	567	Masters
Southern West Virginia Community College	Williamson, West Virginia (50)	909	Associate
Southern West Virginia Community College	Logan, West Virginia (62)	1,233	Associate
Shawnee State Community College	Portsmouth, Ohio (67)	2,622	Associate
Pikeville College	Pikeville, Kentucky (71)	824	Baccalaureate*

* Courses in masters degree programs are taught on the Pikeville campus by faculty members of Pikeville College and Morehead State University. The degrees are issued by Morehead State University.

Vocational Training

The Bluegrass State Skills Corporation, an independent public corporation created and funded by the Kentucky General Assembly, provides programs of skills training to meet the needs of business and industry from entry level to advanced training, and from upgrading present employees to retraining experienced workers.

The Bluegrass State Skills Corporation is the primary source for skills training assistance for a new or existing company. The Corporation works in partnership with other employment and job training resources and programs, as well as Kentucky's economic development activities, to package a program customized to meet the specific needs of a company.

Vocational training is available at both the state vocational-technical schools and the area vocational education centers. The state vocational-technical schools are post-secondary institutions. The area vocational education centers are designed to supplement the curriculum of high school students. Both the state vocational-technical schools and the area vocational education centers offer evening courses to enable working adults to upgrade current job skills.

Arrangements can be made to provide training in the specific production skills required by an industrial plant. Instruction may be conducted either in the vocational school or in the industrial plant, depending upon the desired arrangement and the availability of special equipment.

Nearest State Schools

Mayo State Vocational-Technical School
Paintsville, Kentucky, 31 miles distant

Business & Office	Drafting
Accounting/Management	Electricity
Clerical	Electronics
Data Processing	Graphic Arts
Secretarial	Machine Shop
Consumer & Home Economics	Mine Equipment Operator
Consumer & Family Life	Mine Maintenance Technology
Skills	Welding
Health & Personal Services	Learning Resource Center
Occupations	Public Service Occupations
Cosmetology	Business/Industry Security
Practical Nursing	Training
Industrial Education	CPR Training
Air Conditioning	Electrical Safety Training
Auto Body Repair	Emergency Medical Care
Auto Mechanics	Fire Service Training
Carpentry	First Aid & Safety
Civil & Highway Technology	Rescue & Emergency Services
Diesel Mechanics	Training

(Continued)

Ashland State Vocational-Technical School
Ashland, Kentucky, 33 miles distant

Business & Office	Industrial Machine Maintenance
Clerical	Machine Shop
Secretarial	Radio & TV Repair
Consumer & Home Economics	Tool & Die Making
Commercial Foods	Welding
Health & Personal Services	Learning Resources Center
Occupations	Public Service Occupations
Cosmetology	Business/Industry Security
Practical Nursing	Training
Industrial Education	CPR Training
Auto Body Repair	Electrical Safety Training
Auto Mechanics	Emergency Medical Care
Carpentry	Fire Service Training
Drafting (with CAD/CAM)	First Aid & Safety
Electricity	Rescue & Emergency Services
Electronics	Training
Heavy Equipment Repair	

Nearest Area Education Center

Martin County Area Vocational Education Center
Inez, Kentucky, 25 miles distant

Business & Office	Carpentry
Clerical	Electricity
Secretarial	General Miner
Industrial Education	
Auto Mechanics	

High School Vocational Education Program

The Lawrence County High School Vocational Education Department offers Agribusiness, Auto Mechanics, Carpentry, Distributive Education, Health Careers, Business and Office Programs, Home Economics, and Industrial Arts.

HEALTH

Local Medical Personnel

Physicians - 18

Dentists - 6

Hospitals

<u>General Hospital</u>	<u>Location</u>	<u>Beds</u>
Humana Hospital-Louisa	Louisa	90 (acute)

Medical staff - 11 family practitioners, two general surgeons, one vascular surgeon, one thoracic surgeon, 41 registered nurses, 24 licensed practical nurses, 97 additional support staff personnel

Other Medical Facilities

Fivco District Health Department, Lawrence County Health Center (a public health facility)

Humana Medical Plaza (adjacent to hospital) - Offices for physicians

J.J. Jordan Geriatric Center - Skilled care, intermediate care, and personal care nursing facility

Louisa Medical Clinic

Pathways, Inc. (a comprehensive care center)

Riverview Medical Clinic

Ambulance Service

Name - Life Star Ambulance Service, Inc.

Staff - Eight emergency medical technicians

OTHER LOCAL FACILITIES

Communications

Telephone -	South Central Bell Telephone Company
Telegraph -	Western Union
	Toll-Free number, 1-800-325-6000
Newspapers -	Big Sandy News
Weekly and circulation -	4,200
Radio -	WVKY-AM/FM
Television -	
Airwave reception from -	Lexington, Kentucky; Huntington and Charleston, West Virginia
Cable service -	Available locally
Educational Television -	The Kentucky Educational Television (K.E.T.) network is available statewide

Library Services

Public library - Lawrence County Public Library (Regional headquarters
for FIVCO library district)
Size collection - 45,500 volumes
Circulation, 1986-87 - 99,000

Religious Institutions

Denominations -	Assembly of God	Freewill Baptist
	Baptist	Jehovah's Witnesses
	Catholic	Nazarene
	Christian	Southern Methodist
	Church of Christ	United Methodist
	Church of God	
Nearest Synagogues -	Ashland, 33 miles north of Louisa; Huntington, West Virginia, 34 miles northeast of Louisa	
Congregations -	Agudath Achim (reform) B'nai Shalom (conservative and reform)	

Financial Institutions

<u>Banks</u>	<u>Assets</u>	<u>Deposits</u>	<u>Statement Date</u>
First National Bank of Louisa	\$32,114,108.00	\$29,140,208.00	12/31/87
Peoples Security Bank	24,345,502.87	22,223,379.94	12/31/87

<u>Savings and Loan Associations</u>	<u>Assets</u>	<u>Savings Accounts</u>	<u>Statement Date</u>
Home Federal Savings and Loan	\$65,319,174.40	\$58,279,655.76	9/30/87

Hotels and Motels

Total number - 2
Total rooms - 49

Clubs and Organizations

Louisa and Lawrence County provide various types of social and civic clubs. Each organization is involved with community projects and other avenues of service.

RECREATION

Local

Louisa offers a variety of recreational opportunities for all ages. Facilities include Stella-Moore Park, which features a softball field, tennis courts, and a basketball court. Additional football and baseball fields are available at the local schools. The city of Louisa operates a swimming pool, and is developing a recreation area with a picnic area, a shelter house, horseshoe pits, grills, and a pond. A minipark and a playground are maintained in the downtown area as well.

A softball field is located in the Lawrence County community of Martha, approximately 15 miles southwest of Louisa.

Louisa sponsors several recreational programs each year, including Little League baseball, basketball, and football. Adult baseball and basketball leagues are offered as well. In addition, the Lawrence County Potato Festival is held in mid-September. The two-day gala event is held annually.

The Louisa Junior Woman's Club recently sponsored a civic project that included construction of a playground in the local community park. In addition, they are in the process of building a recreation center and picnic area at the same facility.

Construction of the Yatesville Dam, a 13,000-acre lake, and a 7,000-acre recreational area is under way in Lawrence County, four miles northwest of Louisa. The project is being administered by the U.S. Army Corps of Engineers and is scheduled for completion in early 1989.

Area (Within 60 miles)

The Big Sandy area provides a variety of recreational attractions including nine lakes, five golf courses, several parks and other sources of entertainment.

Ashland, 33 miles north of Louisa, offers many recreational and cultural facilities.

The Paramount Arts Center is owned and operated by the Greater Ashland Foundation, a non-profit group. The center is the site of many cultural events, including plays, concerts, and ballets. Groups may rent the facility for conventions and performances.

The 141-acre American Heritage Park at Ashland contains the Jean Thomas Museum and a 750-seat amphitheater. The museum displays a variety of Appalachian artifacts, including photographs, books, musical instruments and records. Jean Thomas is best remembered as a preserver and recorder of Appalachian folk songs. The amphitheater accommodates a variety of musical and theatrical performances, including Jean Thomas' American Folk Song Festival.

The Kentucky Highland Museum, also at Ashland, is the former Mayo Manor Mansion, and features displays of clothing, artwork, and changing exhibits relating to Appalachian culture.

Ashland's Tri-State Fair and Regatta features a beauty pageant, power boat races, go-cart races, and other entertainment.

Jenny Wiley State Resort Park, 52 miles south of Louisa near Prestonsburg, takes full advantage of its picturesque highland setting. The 1,700-acre park offers facilities and activities such as a 49-room lodge, a dining room, a gift shop, cottages, a lodge pool, sky lift, recreation rooms, campsites, picnic areas, planned recreation, playground, golf, hiking, horseback riding, miniature golf, shuffleboard, fishing, and fishing boat and pedal boat rentals. A summer music theatre presents Broadway musicals in a 90-seat amphitheater.

Grayson Lake State Park is located 53 miles northwest of Louisa near Grayson. Facilities available include 71 campsites, a beach, and a picnic area. Good fishing and organized recreational programs can be found during the summer. The park is located in the 7,350-acre Grayson Lake Wildlife Area.

Carter Caves State Resort Park, 58 miles northwest of Louisa, provides a restful atmosphere with its mountain wildflowers, a rippling stream, the underground wonders of three caves, a 28-room lodge, a restaurant, and a gift shop. Recreational facilities available include something for the whole family with playgrounds, two swimming pools (one Olympic-size), tennis courts, shuffleboard, a 9-hole golf course, miniature golf, boating, fishing, hiking, horseback riding, picnicking, and cave tours.

Greenbo Lake State Resort Park, which is located 59 miles northwest of Louisa near Ashland, has a magnificent fieldstone lodge. The lodge offers 36 rooms, a dining room, a gift shop, a meeting room, a lodge pool, and a recreation room. Other facilities and activities at or near the park include a well-equipped campground, a marina, miniature golf, tennis courts, playgrounds, shuffleboard, planned recreation, fishing, hiking, horseback riding, and picnicking.

COMMUNITY IMPROVEMENTS

Recent

U.S. Highway 23 was recently widened to four lanes from Paintsville to the Louisa area.

The city of Louisa, Board of Water and Sewer Commissioners recently constructed a 79,000-gallon standpipe water storage tank and built water lines at the Yatesville Dam site.

Lawrence County School System recently completed several projects including the reconstruction of gymnasium floors, at both the high school and the middle school, construction of a running track, and the installation of an engine analyzer for the vocational school. Total combined cost of the projects was approximately \$100,000.

The Louisa Junior Woman's Club recently sponsored a civic project that included construction of a playground in the local community park. In addition, they are in the process of building a recreation center and picnic area at the same facility.

The city of Louisa recently completed a neighborhood revitalization project for Lackey Avenue and is currently rehabilitating the Eloise area.

Under Way

Construction of the Yatesville Dam, a 13,000-acre lake, and a 7,000-acre recreational area is under way in Lawrence County, four miles northwest of Louisa. The project is being administered by the U.S. Army Corps of Engineers and is scheduled for completion in early 1989.

Construction of a 3.5-mile bypass around Louisa is under way and scheduled for completion in late 1988.

Planned

Pyrochem plans to build a \$147 million waste incineration operation. The facility will eventually employ approximately 200 persons. In addition, the waste incineration company will develop an industrial park at that site and provide the park's customers with electricity at a discounted rate.

Lawrence County School System plans to automate its record system and construct a new roof for Louisa Elementary School. Total combined cost of the two projects is estimated at \$100,000.