

1985

Industrial Resources: Whitley County - Williamsburg

Kentucky Library Research Collections
Western Kentucky University, spcol@wku.edu

Follow this and additional works at: https://digitalcommons.wku.edu/whitley_cty



Part of the [Business Administration, Management, and Operations Commons](#), [Growth and Development Commons](#), and the [Infrastructure Commons](#)

Recommended Citation

Kentucky Library Research Collections, "Industrial Resources: Whitley County - Williamsburg" (1985). *Whitley County*. Paper 18.
https://digitalcommons.wku.edu/whitley_cty/18

This Report is brought to you for free and open access by TopSCHOLAR®. It has been accepted for inclusion in Whitley County by an authorized administrator of TopSCHOLAR®. For more information, please contact topscholar@wku.edu.

IF
418
Whitley County

RESOURCES
FOR
ECONOMIC
DEVELOPMENT

WILLIAMSBURG



KENTUCKY
The Business Environment is Right

WILLIAMSBURG, KENTUCKY

Site 185 — 30 Acres

For more information contact the Kentucky Department of Economic Development, Industrial Development & Marketing Division, Capital Plaza Tower, Frankfort, Kentucky 40601 (502-564-7140).

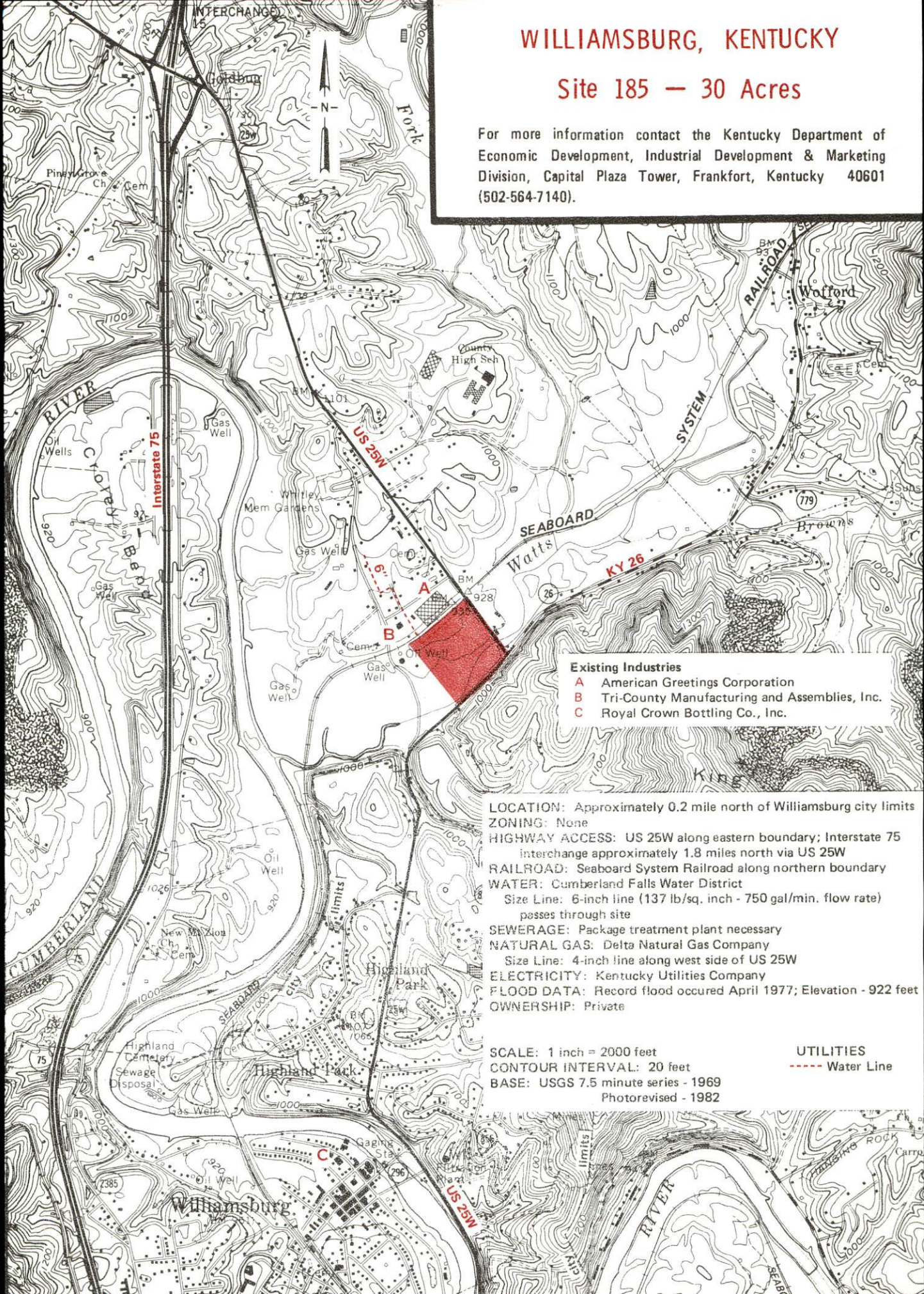

Existing Industries

- A American Greetings Corporation
- B Tri-County Manufacturing and Assemblies, Inc.
- C Royal Crown Bottling Co., Inc.

LOCATION: Approximately 0.2 mile north of Williamsburg city limits
ZONING: None

HIGHWAY ACCESS: US 25W along eastern boundary; Interstate 75 interchange approximately 1.8 miles north via US 25W

RAILROAD: Seaboard System Railroad along northern boundary

WATER: Cumberland Falls Water District

Size Line: 6-inch line (137 lb/sq. inch - 750 gal/min. flow rate) passes through site

SEWERAGE: Package treatment plant necessary

NATURAL GAS: Delta Natural Gas Company

Size Line: 4-inch line along west side of US 25W

ELECTRICITY: Kentucky Utilities Company

FLOOD DATA: Record flood occurred April 1977; Elevation - 922 feet

OWNERSHIP: Private

SCALE: 1 inch = 2000 feet

CONTOUR INTERVAL: 20 feet

BASE: USGS 7.5 minute series - 1969

Photorevised - 1982

UTILITIES

----- Water Line

RESOURCES FOR ECONOMIC DEVELOPMENT
WILLIAMSBURG, KENTUCKY

Prepared by
The Kentucky Department of Economic Development
Division of Research and Planning
in cooperation with
The Williamsburg Chamber of Commerce

1985

Program manager - Andrew Dennis; research - James R. Thompson; clerical - Bobbi Graves; graphics - Frank Ferrante, Tony Cecconi, Robert Owens; cartography - Site Evaluation Branch, Division of Industrial Development and Marketing. Cost of printing paid from state funds.

TABLE OF CONTENTS

<u>Chapter</u>	<u>Page</u>
INDUSTRIAL SITES	i
WILLIAMSBURG, KENTUCKY - A RESOURCE PROFILE	1
THE LABOR MARKET AREA	3
Population	3
Labor Force Characteristics of Residents, 1983	3
Selected Components of Nonagricultural Employment, by Place of Work, 1983	4
Williamsburg Manufacturing Firms, Their Products and Employment	5
Labor Organizations in Manufacturing Firms	5
Industrial Services	6
Estimated Male Labor Supply	7
Estimated Female Labor Supply	7
Average Weekly Wages By Industry, by Place of Work, 1983	8
Per Capita Personal Income	10
TRANSPORTATION	11
Rail	11
Highways	11
Truck Service	12
Air	13
Bus	14
Taxi	14
Rental Services	14
POWER AND FUEL	15
Electricity	15
Natural Gas	15
Other Fuels	16
WATER AND SEWERAGE	17
Public Water Supply	17
Raw Water	17
Sewerage	19
CLIMATE	20

<u>Chapter</u>	<u>Page</u>
LOCAL GOVERNMENT	21
City	21
County	21
Assessed Value of Property, 1984	21
Property Taxes	21
Combined State and Local Rates Per \$100 Valuation, 1984	22
Utilities Gross Receipts Tax for Schools	22
Planning and Zoning	22
Safety	23
Police	23
Fire	23
Rescue Service	23
Refuse Collection and Disposal	23
EDUCATION	24
Public Schools	24
Area Colleges and Universities	25
Vocational Schools	26
HEALTH	27
Local Medical Personnel	27
Hospitals	27
Ambulance Service	27
Public Health	27
OTHER LOCAL FACILITIES	28
Communications	28
Library Services	28
Religious Institutions	29
Financial Institutions	29
Hotels and Motels	29
Clubs and Organizations	30
RECREATION	31
COMMUNITY IMPROVEMENTS	33

1984 EDITION
GENERAL HIGHWAY MAP
WHITLEY COUNTY
KENTUCKY

PREPARED BY THE
KENTUCKY TRANSPORTATION CABINET
DEPARTMENT OF HIGHWAYS
DIVISION OF PLANNING
IN COOPERATION WITH THE
U.S. DEPARTMENT OF TRANSPORTATION
FEDERAL HIGHWAY ADMINISTRATION

0 1 2 3 4 MILES

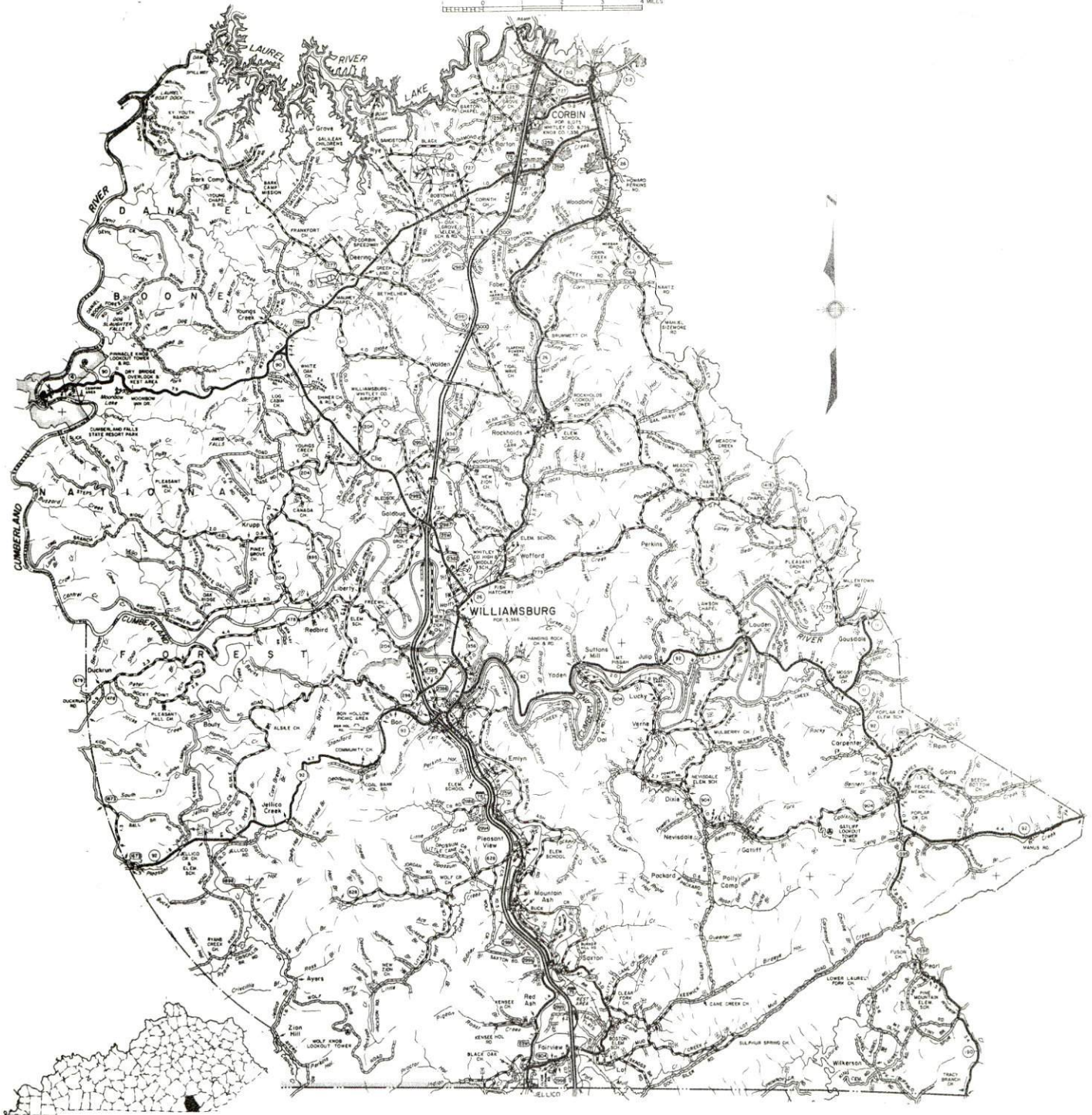

[illegible]

WILLIAMSBURG, KENTUCKY - A RESOURCE PROFILE

Williamsburg, the county seat of Whitley County, is located on the southern border of the Eastern Kentucky Coal Field. Williamsburg is located 69 miles north of Knoxville, Tennessee; 174 miles southeast of Louisville, Kentucky; and 180 miles south of Cincinnati, Ohio. In 1982, Williamsburg had an estimated population of 5,385.

Whitley County covers a total land area of 443 square miles. Whitley County is a well-dissected upland with a hilly to mountainous terrain. The county's southern boundary is formed by the Kentucky-Tennessee state line. In 1982, Whitley County had an estimated population of 33,900.

The Economic Framework

The total number of Whitley County residents employed in 1983 averaged 8,390, with nonagricultural jobs accounting for 8,300. Manufacturing employers in the county reported 1,100 workers; wholesale and retail trade 2,160 employees; services 1,830 employees; and state and local government 1,110 employees. Manufacturing employment is greatest in the nonelectrical machinery industry.

Per capita personal income in Whitley County in 1982 was \$7,177. Between 1978 and 1982, per capita income increased by 35 percent.

The Williamsburg labor market area includes Whitley County and the adjoining Kentucky counties of Bell, Knox, Laurel, and McCreary, plus Campbell and Claiborne Counties in Tennessee. The total number of residents in the Kentucky portion of the labor market area employed in 1983 averaged 54,100 with nonagricultural jobs accounting for 52,970 workers. Manufacturing employers in the area reported 7,270 workers; wholesale and retail trade 8,850 employees; services 5,670 employees; and state and local government 4,960 employees.

Resources for Growth

1. Labor Supply - There is a current labor supply of 20,230 men and 16,730 women available for industrial jobs in the labor market area. In addition, from 1985 through 1989, 10,100 young men and 9,370 young women in the area will become 18 years of age and potentially available for industrial jobs.

2. Transportation - The Seaboard System Railroad provides main line rail service to Williamsburg. Williamsburg is served directly by U.S. 25W, a "AAA" rated trucking highway, and Kentucky Highway 92, a "AA" rated trucking highway. Interstate 75, a major north-south, multi-lane highway, is located one mile east of Williamsburg. Fifteen common carriers have the authority to serve Williamsburg. The nearest commercial airport, McGhee-Tyson Airport near Knoxville, Tennessee, is located 81 miles south of Williamsburg. Commuter air service is available at the London-Corbin Airport (Magee Field), 28 miles north of Williamsburg. The Whitley County Airport, 8 miles north of Williamsburg, has a 2,500-foot paved runway to accommodate small aircraft.

3. Power and Fuel - Electric power is provided to Williamsburg and parts of Whitley County by the Kentucky Utilities Company, an electric generation and transmission company. Portions of Whitley County are served by Cumberland Valley RECC, which is supplied by the East Kentucky Power Cooperative. Natural gas service is provided to Williamsburg by the Delta Natural Gas Company. Two distributors of propane and four distributors of distillate fuel oil serve Williamsburg.

4. Education - Primary and secondary education is provided by the Williamsburg Independent School System and the Whitley County School System.

Cumberland College, established in 1889, is a four-year, coeducational, liberal arts college located in Williamsburg. The college offers the degrees of Associate in Science, Bachelor of Arts, Bachelor of Science, Bachelor of Music, and Master of Arts in Education. In addition, three universities, four senior colleges, one two-year college, one bible college, and one community college are located within 80 miles of Williamsburg.

The Laurel County State Vocational-Technical School in London, 31 miles north of Williamsburg, offers training in 14 courses. The Corbin Area Vocational Education Center, 15 miles north of Williamsburg, offers training in 6 courses.

THE LABOR MARKET AREA

The Williamsburg Labor Market Area includes Whitley County and the adjoining Kentucky counties of Bell, Knox, Laurel and McCreary. The southern boundary of Whitley County is formed by the Tennessee state line. The Williamsburg Labor Market Area also encompasses two of the adjoining Tennessee counties.

POPULATION				
Area	1982*	1980	1970	Percent Nonwhite 1980
Williamsburg	5,385	5,560	3,687	3.8
Labor Market Area	155,100	152,581	118,889	N/A
Whitley County	33,900	33,396	24,145	0.9
Bell County	34,500	34,330	31,121	2.8
Knox County	30,500	30,239	23,689	1.3
Laurel County	40,100	38,982	27,386	1.0
McCreary County	16,100	15,634	12,548	1.7

* Population estimates.

Note: The 1980 city counts of population by race are provisional.

Sources: U.S. Department of Commerce, Bureau of the Census, 1980 Census of Population and Housing, March 1981; 1980 Census of Population, Number of Inhabitants; Local Population Estimates, Series P-26, No. 82-17-C, June 1984.

LABOR FORCE CHARACTERISTICS OF RESIDENTS, 1983

	Whitley County	Labor Market Area*
Civilian Labor Force	10,217	62,634
Employment	8,393	54,101
Agricultural	97	1,134
Nonagricultural	8,296	52,967
Unemployment	1,824	8,533
Rate of Unemployment (%)	17.9	13.6

* Whitley County and the four adjoining Kentucky counties.

Source: Kentucky Cabinet for Human Resources, Kentucky Labor Force Estimates, Annual Averages, 1983.

SELECTED COMPONENTS OF NONAGRICULTURAL EMPLOYMENT,
BY PLACE OF WORK, 1983

	<u>Whitley County</u>	<u>Labor Market Area*</u>
All Industries (total)	7,933	34,268
Manufacturing	1,102	7,268
Wholesale & Retail Trade	2,158	8,847
Services	1,833	5,674
State/Local Government	1,114	4,964
Contract Construction	317	1,470
Mining & Quarrying	729	3,236

* Whitley County and the four adjoining Kentucky counties.

Note: Excludes domestic workers, railway workers, certain nonprofit corporations, majority of federal government workers, and self-employed workers.

Source: Kentucky Cabinet for Human Resources, Average Monthly Workers Covered by Kentucky Unemployment Insurance Law, 1983.

WILLIAMSBURG MANUFACTURING FIRMS,
THEIR PRODUCTS AND EMPLOYMENT

<u>Firm (Establishment date)</u>	<u>Product</u>	<u>Employment</u>			<u>Labor Unions</u>
		<u>Total</u>	<u>Male</u>	<u>Female</u>	
Lion Uniform, Inc. (1959)	Industrial work clothing and government uniform	202	18	184	
Roper Outdoor Products (1969)	Roto till, mowers, snow throws, log splitters, ranges	455	210	245	Steelworkers*
Royal Crown Bottling Company, Inc. (1935)	Soft drinks	35	32	3	
Whitley County Concrete and Supply Company, Inc. (1963)	Ready mixed concrete, concrete septic tanks	31	27	4	
Whitley Republican, Inc. (1908)	Newspaper, commercial printing	9	5	4	

* See Labor Organizations below.

Sources: Kentucky Department of Economic Development, 1985 Kentucky Directory of Manufacturers; Division of Research and Planning.

LABOR ORGANIZATIONS IN MANUFACTURING FIRMS

<u>Union</u>	<u>Representing workers at:</u>
United Steelworkers of America, AFL-CIO	Roper Outdoor Products

INDUSTRIAL SERVICES

<u>Types of Services</u>	<u>Location</u>	<u>Mileage from Williamsburg</u>
Custom Plastics Producers	Corbin, Kentucky	15
Electric Motor Repair	Corbin, Kentucky	15
	London, Kentucky	31
Grinding, Precision & Tool	Richmond, Kentucky	78
Heat Treating Facilities	Richmond, Kentucky	78
Industrial Equipment & Supplies	Knoxville, Tennessee	69
	Lexington, Kentucky	102
Industrial Gases	Somerset, Kentucky	52
	Knoxville, Tennessee	69
	Richmond, Kentucky	78
Industrial Waste Removal	Somerset, Kentucky	52
	Knoxville, Tennessee	69
Machine Shops, Tool & Die	Corbin, Kentucky	15
Metal Finishers	Richmond, Kentucky	78
Metal Service Centers	Knoxville, Tennessee	69
	Lexington, Kentucky	102
Millwrights	Knoxville, Tennessee	69
	Lexington, Kentucky	102

Sources: Kentucky Department of Economic Development, Kentucky Directory of Selected Industrial Services, 1983; Division of Research and Planning.

ESTIMATED MALE LABOR SUPPLY
WILLIAMSBURG LABOR MARKET AREA

Area	Current			Future	
	Total Male	Unemployed	Under-employed	Not in Labor Force	Becoming 18 years of age 1985 thru 1989
Labor Market					
Area*	20,231				10,102
Whitley	5,966	1,249	1,263	3,454	1,463
Bell	2,931	1,536	428	967	1,632
Knox	2,650	997	580	1,073	1,525
Laurel	2,096	1,417	679	0	1,899
McCreary	3,147	640	360	2,147	828
Campbell (Tenn.)	2,330	N/A	N/A	N/A	1,656
Claiborne (Tenn.)	1,111	N/A	N/A	N/A	1,099

ESTIMATED FEMALE LABOR SUPPLY
WILLIAMSBURG LABOR MARKET AREA

Area	Current			Future	
	Total Female	Unemployed	Under-employed	Not in Labor Force	Becoming 18 years of age 1985 thru 1989
Labor Market					
Area*	16,732				9,367
Whitley	4,526	575	646	3,305	1,439
Bell	3,553	450	443	2,660	1,579
Knox	2,872	533	423	1,916	1,379
Laurel	1,777	827	601	349	1,658
McCreary	2,476	309	136	2,031	788
Campbell (Tenn.)	903	N/A	N/A	N/A	1,497
Claiborne (Tenn.)	625	N/A	N/A	N/A	1,027

* Additional workers may be drawn from other nearby counties.

Note: Unemployed - persons unemployed and actively seeking work;
Underemployed - persons employed but working only 14 to 26 weeks per year;
Not in Labor Force - represents the number of persons who would enter the labor force if suitable employment were available (based on the assumption that persons in Kentucky would like to participate in the labor force in the same proportion that they do nationally).

Sources: Kentucky Cabinet for Human Resources, Kentucky Labor Supply Estimates by County, 1983. Tennessee Department of Economic and Community Development, Tennessee Available Labor, 1983. Kentucky Department of Economic Development, Future Labor Supply Becoming 18 Years of Age, 1985 thru 1989.

AVERAGE WEEKLY WAGES BY INDUSTRY,
BY PLACE OF WORK, 1983

	<u>Whitley County</u>	<u>Bell County</u>	<u>Knox County</u>
All Industries	\$ 254.88	\$ 311.05	\$ 248.43
Mining & Quarrying	387.31	558.35	386.38
Contract Construction	253.89	267.66	327.98
Manufacturing	268.86	288.29	294.20
Transportation, Communications & Public Utilities	302.23	369.05	314.80
Wholesale & Retail Trade	221.06	190.34	193.75
Finance, Insurance & Real Estate	222.50	325.10	240.44
Services	234.98	246.93	192.44
State/Local Government	258.90	286.19	244.39
Other	230.94	176.41	*
	<u>Laurel County</u>	<u>McCreary County</u>	
All Industries	\$ 270.34	\$ 211.59	
Mining & Quarrying	416.12	278.00	
Contract Construction	348.18	*	
Manufacturing	283.41	195.89	
Transportation, Communications & Public Utilities	354.45	299.47	
Wholesale & Retail Trade	222.06	141.38	
Finance, Insurance & Real Estate	246.68	310.98	
Services	204.99	185.96	
State/Local Government	295.10	239.67	
Other	212.21	*	

* Not disclosed.

Note: Excludes domestic workers, railway workers, certain nonprofit corporations, majority of federal government workers, and self-employed workers.

Source: Kentucky Cabinet for Human Resources, Average Weekly Wages of Workers Covered by Kentucky Unemployment Insurance Law, 1983.

Occupational wage rates for specific industries are usually not available to most government agencies, and wage data furnished to state employment agencies by individual industrial employers are protected from disclosure by federal law. The most reliable up-to-date wage information can be obtained by direct contact with local employers.

Associated Industries of Kentucky, a voluntary organization of Kentucky businesses, regularly collects occupational wage rates and fringe benefits data from participating member firms. Data are compiled for over 127 clearly defined office, production, and service occupations. Tabulations are published for nine geographical areas of Kentucky, as shown on the map below. It should be noted that the data may be weighted by the preponderance of firms in the larger cities and may be somewhat higher than the rates paid in the smaller communities. Data from these tabulations are available, upon request, from the Kentucky Department of Economic Development, Frankfort, Kentucky 40601.

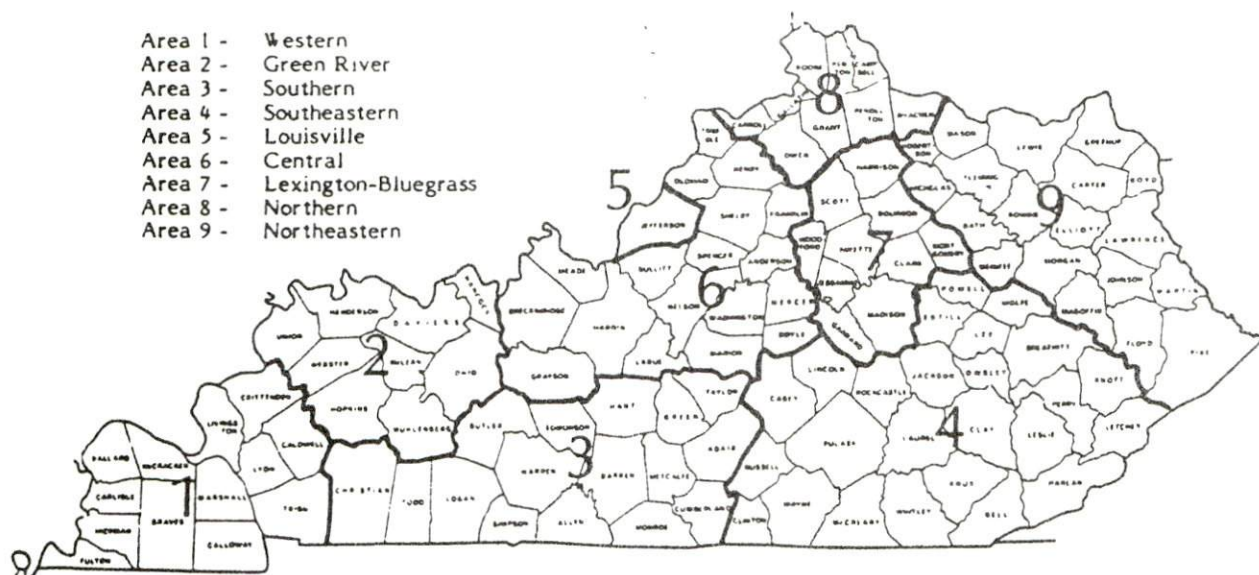

Associated Industries of Kentucky Area Wage Surveys

PER CAPITA PERSONAL INCOME

<u>Area</u>	<u>1978</u>	<u>1982</u>	<u>Percent Change</u>
Whitley County	\$ 5,300	\$ 7,177	35.4
Labor Market Area Range*	\$3,245 - 5,300	\$4,522 - 7,397	N/A
Kentucky	6,389	8,893	39.2
U. S.	7,776	11,100	42.7

* Whitley County and the four adjoining Kentucky counties.

Sources: U.S. Department of Commerce, Bureau of Economic Analysis, Survey of Current Business, April 1983; Commerce News, April 29, 1984. Kentucky Economic Information System, July 1984.

TRANSPORTATION

Rail

Line serving **Williamsburg** - Seaboard System Railroad

Services - Main line; one northbound and one southbound freights making daily stops; 12 northbound and 12 southbound through freights daily; switching services; team track space for 6 cars; siding space for 85 cars; nearest piggyback facilities are operated by the Southern Railway System in Knoxville, Tennessee, 69 miles south of Williamsburg

For details on routing, schedules, rates, and services, contact:

Manager of Industrial Development
Seaboard System Railroad
P.O. Box 2157
Louisville, Kentucky 40201
(502) 587-5228

Highways

Interstate 75, a major north-south multi-lane highway, has two interchanges located within four miles of Williamsburg. The city is also served directly by U.S. 25W, a "AAA" rated (80,000-pound gross load limit) trucking highway and Kentucky Highway 92, a "AA" rated (62,000-pound gross load limit) trucking highway. Access to the Daniel Boone Parkway, a multi-lane toll road, is 31 miles north at London.

Truck Service

Company

Bailey's Express Company, Inc.*
Bestway Express, Inc.*
C W Transport, Inc.*

Central Transport, Inc.**
Consolidated Freightways
Corporation of Delaware*

Eldridge Truck Line*
Interstate System*
Maryland Transportation
Company**

The Mason and Dixon Lines, Inc.**

Middlewest Freightways, Inc.*

Overnite Transportation Company*

Roadway Express, Inc.*

Skyline Transportation, Inc.**

Smith's Transfer Corporation*

Suburban Motor Freights, Inc.*

Home Office

Middletown, Connecticut 06457
Nashville, Tennessee 37210
610 High Street
Wisconsin Rapids, Wisconsin 54494
Sterling Heights, Michigan 48077

175 Linfield Drive
Menlo Park, California 94025
Somerset, Kentucky 42501
Grand Rapids, Michigan 49503

1111 Frankfurst Avenue
Baltimore, Maryland 21225
P.O. Box 969

Kingsport, Tennessee 37662
6810 Prescott Avenue
St. Louis, Missouri 63147

P.O. Box 1216
Richmond, Virginia 23209
1077 Gorge Boulevard
Akron, Ohio 44310

P.O. Box 3569
Knoxville, Tennessee 37917

P.O. Box 1000
Staunton, Virginia 24401

P.O. Box 1739
Columbus, Ohio 43216

* Interstate and intrastate service.

** Interstate service only.

Source: American Motor Carrier Directory, Spring 1985.

Other Freight Services

Emery

Federal Express

Purolator Courier

United Parcel Service

Nearest Office or Shipping Center

Lexington, Kentucky, 102 miles north of
Williamsburg

Knoxville, Tennessee, 69 miles south of
Williamsburg

Lexington, Kentucky, 102 miles north of
Williamsburg

London, Kentucky, 31 miles north of
Williamsburg

HIGHWAY MILES AND TRUCK TRANSIT TIME IN DAYS FROM
WILLIAMSBURG, KENTUCKY, TO SELECTED MARKET CENTERS

City	Highway Miles	Delivery Time TL	City	Highway Miles	Delivery Time TL
Atlanta, Ga.	262	2	Los Angeles, Ca.	2,282	4
Baltimore, Md.	643	2	Louisville, Ky.	174	1
Birmingham, Ala.	323	2	Nashville, Tenn.	246	2
Chicago, Ill.	454	2	New Orleans, La.	665	2
Cincinnati, Ohio	180	2	New York, N. Y.	805	N/A
Cleveland, Ohio	419	2	Pittsburgh, Pa.	445	2
Detroit, Mich.	439	2	St. Louis, Mo.	437	2
Knoxville, Tenn.	69	2			

Note: Mileage computations are via the best interstate or primary highways, not necessarily the most direct route of travel.

Sources: Rand McNally Road Atlas, 1979. Official Kentucky Mileage Map, 1980.
Delivery time - Overnite Transportation Company, P.O. Box 1216, Richmond,
Virginia 23209.

Air

Local

Location: Whitley County Airport
8 miles north of Williamsburg
Runways: 1 paved
Length: 2,500 feet
Traffic
Control: Wind sock
Lighting: None
Services: Tie-down

Location: London-Corbin Airport (Magee Field)
28 miles north of Williamsburg
Runways: 1 paved
Length: 6,000 feet
Traffic
Control: Wind sock and FSS advisory service
Lighting: Beacon, runway and obstruction lights, REIL, VASI
Services: Tennessee Airways; fuel (100 octane, JP-A-50); minor
A & P repairs; tie-downs; aircraft rental; auto
rental; taxi; weather data; flight training;
charter; ambulance service

Air Freight
Service: Air carriers accept freight on a space available basis

(Cont'd)

Nearest Scheduled Commercial Airline Service

Location: McGhee Tyson Airport
12 miles south of Knoxville, Tennessee;
81 miles south of Williamsburg

Runways: 2 paved

Length: 9,000 feet and 6,000 feet

Traffic

Control: Tower

Lighting: Beacon, runway

Services: Delta, Eastern, Republic, United, USAir, Atlantis,
Comair, New York Air, Scheduled Skyways, Tennessee
Airways; fuel - 100, jet-A; tie-downs, hangars;
minor A & P repairs, major Avionics repairs; APU,
charter, flight instruction, oxygen, plane rental,
U. S. Customs; limousine, car rental, public
transit; weather information; restaurant, snack bar

Air Freight
Service: Air freight terminal

Bus - Southern Greyhound Bus Lines; Trailways Bus Lines

Taxi - Four companies with 24-hour, radio-dispatched service

Rental Services - Truck and trailer rentals are available locally; car rentals are available at the London-Corbin Airport, 28 miles north of Williamsburg

POWER AND FUEL

Electricity

Company serving **Williamsburg and part of Whitley County** - Kentucky Utilities Company

Source of power - Kentucky Utilities Company

Total generating capacity - 3,164,000 KW*

For industrial rates contact:

Industrial Development Department
Kentucky Utilities Company
One Quality Street
Lexington, Kentucky 40507
(606) 255-1461

Company serving **a major portion of Whitley County** - Cumberland Valley Rural Electric Cooperative Corporation

Source of power - East Kentucky Power Cooperative

Total generating capacity - 1,309,000 KW**

For industrial rates contact:

Industrial Development Division
East Kentucky Power Cooperative
P.O. Box 707
Winchester, Kentucky 40391
(606) 744-4812

Natural Gas

Company serving **Williamsburg** - Delta Natural Gas Company

Source of supply - Delta Natural Gas Company

Size of transmission mains - 6-inch (supplier); 6-inch (distributor)

Distribution mains - 2 through 6 inches

Distribution pressure - 15 to 45 psi

Btu content - 1,100 per cubic foot

Specific gravity - .65

For rates and supplies contact:

Delta Natural Gas Company
Marketing Manager
Route 1, Box 30-A
Winchester, Kentucky 40391
(606) 744-6171

* Kentucky Utilities Company's total generating capacity will be increased when a new 650,000 KW generation plant is completed in Hancock County in 1993.

** East Kentucky Power Cooperative's total generating capacity will be increased when a new 650,000 KW coal-fired generation plant is completed in southeast Clark County in 1992.

Other Fuels (Within 15 miles)

Propane

Buckeye Gas Products Company
(Doxol Propane)*
Camp Ground Road
Corbin, Kentucky 40701

Rains Gas and Appliance Company
(Pyrofax Gas)*
Cumberland Falls Road
Williamsburg, Kentucky 40769

Fuel oils

Distillate fuel oil -

Combs Fuels, Inc.
420 South Fifth Street
Williamsburg, Kentucky 40769

Michael-Walters Industries
Barbourville Road
Corbin, Kentucky 40701

Helton's Oil Corporation and
Service Station
Highway 312 East
Corbin, Kentucky 40701

R C Miller Oil Company, Inc.
Route 7
Corbin, Kentucky 40701

Residual fuel oil - Arrangements must be made with the refinery.

Low sulphur content coal - Available locally.

* Bulk plant.

WATER AND SEWERAGE

Public Water Supply

Company serving **Williamsburg** - City of Williamsburg
P.O. Box 119
Williamsburg, Kentucky 40769
(606) 549-3300

Source - Cumberland River
Treatment plant capacity - 2,000,000 gallons per day
Average daily consumption - 680,000 gallons
Peak daily consumption - 750,000 gallons
Type treatment - Filtration, coagulation, chlorination
Storage capacity - 2,000,000 gallons
Size lines - 4, 6, 8, 10, and 12 inches
Average pressure - 70 psi
Average temperature - 65 degrees F.

MONTHLY WATER RATES

First	2,000 gallons	\$5.90 (Minimum)
Next	3,000 gallons	2.00 per M gallons
Next	10,000 gallons	1.70 per M gallons
Next	10,000 gallons	1.55 per M gallons
Next	10,000 gallons	1.40 per M gallons
Next	10,000 gallons	1.30 per M gallons
All over	45,000 gallons	1.20 per M gallons

Tap-on charge:

Residential - \$100
Commercial - \$500

Raw Water

Surface water sources - Cumberland River; Laurel River; Laurel River Reservoir
Average discharge - Cumberland River at Williamsburg, 2,736 cfs (33 years, USGS)
Expected ground water yield - 50 to 200 gpm in the eastern three-fourths of the county; 5 to 50 gpm in the western one-fourth of the county

Name of water district - Cumberland Falls Highway Water District*
Route 8, Box 511A
Corbin, Kentucky 40701
(606) 528-0222

Area served - Central Whitley County along U.S. 25 W between Corbin and Williamsburg

Date when water district began operating - 1970

Source of supply of treated water - City of Williamsburg, Corbin City Utilities, Woods Creek Water District

Average amount of water used in a 24-hour period - 140,000 gallons

Peak amount of water used in a 24-hour period - 200,000 gallons

Storage capacity - 180,000 gallons

Size lines - 2, 3, 4, 6 and 8 inches

Water pressure - 50 to 137 psi

MONTHLY WATER RATES

3/4-inch meter

First	1,000 gallons	\$ 9.75 (Minimum)
Next	4,000 gallons	3.00 per M gallons
Next	5,000 gallons	2.25 per M gallons
All over	10,000 gallons	1.75 per M gallons

1-inch meter

First	5,000 gallons	\$21.75 (Minimum)
Next	5,000 gallons	2.25 per M gallons
All over	10,000 gallons	1.75 per M gallons

2-inch meter

First	25,000 gallons	\$59.25 (Minimum)
All over	25,000 gallons	1.75 per M gallons

Tap-on charge:

3/4-inch meter - \$300

Larger meters - Actual cost of labor and materials

* The Cumberland Falls Highway Water District has plans for the expansion of 25 miles of six-inch water line. The \$1-million project is scheduled for Spring 1986.

Sewerage

Company serving **Williamsburg** - City of Williamsburg*
P.O. Box 119
Williamsburg, Kentucky 40769
(606) 549-3300

Design capacity - 480,000 gallons per day

Average daily flow - 380,000 gallons

Type of treatment - Primary and secondary

Treatment processes - Trickle filter, clarifier, drying beds

Treated effluent discharged into - Cumberland River

Size of sanitary mains - 6, 8, 10, and 12 inches

Size of storm mains - 24 and 30 inches

Monthly rates - One-half of monthly water bill

Tap-on charge:

Residential - \$100

Commercial - \$500

* Phase I of a 201 study was recently completed.

CLIMATE

Whitley County

Temperature

Normal (30-year record)	58.90 degrees
Average annual 1983	57.70 degrees
Record highest, September 1954 (42-year record)	103.00 degrees
Record lowest, January 1966 (42-year record)	-9.00 degrees
Normal heating degree days (30-year record)	3,658
(Heating degree day totals are the sums of negative departures of average daily temperatures from 65 degrees F.)	

Precipitation

Normal (30-year record)	47.29 inches
Mean annual snowfall (41-year record)	12.40 inches
Total precipitation 1983	42.48 inches
Mean number days precipitation (.01 inch or more)	
(41-year record)	127
Mean number days thunderstorms (41-year record)	47

Prevailing Winds (14-year record)

Northeast

Relative Humidity (23-year record)

1 a.m.	80 percent
7 a.m.	85 percent
1 p.m.	59 percent
7 p.m.	63 percent

Source: U.S. Department of Commerce, Environmental Science Services Administration, Climatological Data, 1983. Station of record: Knoxville, Tennessee.

LOCAL GOVERNMENT

City

Structure - Mayor - 4-year term; 4 council members - 2-year terms

Budget 1984 - General Fund \$626,801

Water and Sewer Fund 548,160

Fees and licenses - Business privilege licenses range from \$20 to \$100 annually; automobile tax \$8.50 annually

County

Structure - County Judge/Executive - 4-year term; 3 magistrates - 4-year terms

Budget 1984-85 - General Fund \$436,000; Road Fund \$454,000

Assessed Value of Property, 1984*

<u>Classes of Property</u>	<u>Williamsburg</u>	<u>Whitley County</u>
Real Estate	\$37,503,108	\$228,282,644
Tangibles	19,742,027	117,040,043

Property Taxes

All property in Kentucky is assessed at 100 percent of fair cash value.

Land and buildings are taxed by the state and may be taxed by local jurisdictions. The 1984 state rate is \$0.22 per \$100 of assessed valuation.

Manufacturing machinery, raw materials inventories, pollution control equipment, and goods in the process of manufacture are not subject to local taxation. The state rate is \$0.15 per \$100.

Other tangible personal property owned by manufacturers (finished goods, office furniture, office equipment) is taxed by the state at \$0.45 per \$100 and may be taxed by local jurisdictions.

Intangible personal property located in Kentucky (money in hand, shares of stock, notes, bonds, accounts receivable, and other credits) is taxed by the state at \$0.25 per \$100, and is not subject to local taxation.

Property stored in public warehouses in a transit status is not subject to local taxation. The state rate is only \$0.015 per \$100.

Private leaseholds in industrial facilities owned by cities or counties and financed by industrial revenue bonds are subject to a state tax of \$0.015 per \$100 of value (essentially the lessee's equity, adjusted for appreciation or depreciation). Local taxation is not permitted.

* Excludes Homestead Exemptions.

Combined State and Local Rates Per \$100 Valuation, 1984*
(100% assessment)

	Site Inside City of <u>Williamsburg</u>	Site Inside Unincorporated <u>Whitley County</u>
1. Land and buildings	\$0.8500	\$0.5320
2. Mfg. machinery, raw materials, goods in process, pollution control equipment	0.1500	0.1500
3. Finished goods, office equipment, other tangibles	1.0809	0.7629
4. Intangibles (accounts receivable, notes, bonds, etc.)	0.2500	0.2500
5. Property stored in public warehouses in a transit status	0.0150	0.0150
6. Leaseholds in industrial revenue bond financed plants	0.0150	0.0150

Utilities Gross Receipts Tax for Schools

A 3 percent tax is levied on utilities receipts for schools in the Williamsburg Independent School District. Tax is paid by all consumers of utilities as an add-on to the utilities bills. Exempted are receipts from utilities services that are resold and the receipts from the sale of energy or energy producing fuels that exceed 3 percent of the cost of production in manufacturing, processing, mining or refining.

Planning and Zoning

City agency - Williamsburg Planning and Zoning Commission

Zoning enforced - Yes

Subdivision regulations enforced - Within city only

Local codes enforced - Building

Mandatory state codes enforced - Kentucky Plumbing Code, National Electric Code, Kentucky Boiler Regulations and Standards, Kentucky Building Code (modeled after BOCA code)

* Kentucky Department of Economic Development.

Safety

Police

	Williamsburg	Whitley County
Total staff	8	7
Radio-patrol cars	4	2

Fire

Insurance Services Office,
Public Protection

Classification	7	9*
Full-time staff	5	
Volunteers	20	60

Rescue Service

Williamsburg Rescue Squad:

Number of volunteers - 27

Equipment - 4-wheel drive truck, van, 4-wheel drive rescue truck, jeep, 2 boats and trailers, dragging equipment, two generators, radiology equipment

Personnel training - All members are trained in first aid, fire fighting, CPR, and 2 members are emergency medical technicians

Refuse Collection and Disposal

	Williamsburg	Whitley County
Type service	Municipal	Private
Fee charged:		
residential	\$3.00 per month	\$5.00 to \$7.00 per month
business	\$5.00 to \$30.00 per month	Contract
industrial	\$50.00 per month	Contract
Collection frequency:		
residential	Weekly	Weekly
business	Two to five times weekly	As needed
industrial	Two to five times weekly	As needed
Trash pickup	As needed	As needed
Disposal method	Sanitary Landfill	Sanitary landfill

* Whitley County is served by three fire departments, each having a rating of 9.

EDUCATION

Public Schools

	Williamsburg Independent	Whitley County
Total Enrollment		
(Fall 1984)	810	4,615
Elementary	420	2,779
Junior High	149	--
Middle School	--	973
High School	241	863
Student-Teacher Ratio	16-1	20-1
Elementary	17-1	21-1
Junior High	30-1	
Middle School		19-1
High School	12-1	20-1
Percent High School		
Graduates to College		
(1983)	54.5	21.5
Expenditures Per Pupil		
(1982-83)	\$ 1,498.78	\$ 1,311.64
Bonded Indebtedness		
(June 30, 1984)	\$3,000,000*	\$2,915,000

* Includes School Building Authority bonds outstanding \$3,000,000 -- local school district obligation \$1,587,540.

Area Colleges and Universities

<u>Name</u>	<u>Location (Miles distant)</u>	<u>Enrollment (Fall, 1984)</u>	<u>Highest Degree Conferred</u>
Cumberland College	Williamsburg, Kentucky	2,106	Masters
Sue Bennett College	London, Kentucky (31)	330	Associate
Union College	Barbourville, Kentucky (31)	887	Masters, Specialist
Somerset Community College	Somerset, Kentucky (52)	1,153	Associate
Lincoln Memorial University	Harrogate, Tennessee (56)	1,425	Masters
Berea College	Berea, Kentucky (65)	1,554	Baccalaureate
Johnson Bible College	Knoxville, Tennessee (69)	374	Baccalaureate
Knoxville College	Knoxville, Tennessee (69)	560	Baccalaureate
University of Tennessee, at Knoxville	Knoxville, Tennessee (69)	25,619	Academic & Professional
Eastern Kentucky University	Richmond, Kentucky (78)	12,357	Masters, Specialist*

Cumberland College

Cumberland College, a four-year, coeducational, liberal arts college, is located in Williamsburg. Cumberland College, established in 1889, is one of Kentucky's largest private colleges. With a truly distinctive Christian atmosphere, Cumberland College offers the degrees of Associate in Science, Bachelor of Arts, Bachelor of Science, Bachelor of Music, and Master of Arts in Education.

* Joint doctoral degree programs are offered in cooperation with the University of Kentucky, Lexington. The degrees are issued by the University of Kentucky.

Vocational Schools

Both the state vocational-technical schools and the area vocational education centers are operated by the Kentucky Department of Education. The state vocational-technical schools enroll persons full time who are at least 16 years of age and not in school. These students attend classes for six hours each day. The area vocational education centers are designed to accommodate high school students who are at least 15 years of age. These students attend vocational school for three hours each day. The state vocational-technical schools and the area education centers offer evening courses to enable working adults to upgrade current job skills.

Nearest State School

Location	Laurel County State Vocational-Technical School
Miles Distant	London
Curriculum	31
	Consumer and Home Economics
	Commercial Foods
	Consumer and Family Life Skills
	Health and Personal Services Occupations
	Cosmetology
	Medical Assistant
	Industrial Education
	Air Conditioning and Heating
	Auto Body Repair
	Auto Mechanics
	Carpentry
	Drafting (with CAD/CAM)
	Electricity
	Machine Shop
	Masonry
	Plant Maintenance
	Welding
	Learning Resource Center

Nearest Area Education Center

Location	Corbin Area Vocational Education Center
Miles Distant	Corbin
Curriculum	15
	Health and Personal Services Occupations
	Health Services
	Industrial Education
	Auto Mechanics
	Drafting
	Industrial Electricity
	Major Appliance Repair
	Welding

Arrangements can be made to provide training in the specific production skills required by an industrial plant. Instruction may be conducted either in the vocational school or in the industrial plant, depending upon the desired arrangement and the availability of special equipment.

HEALTH

Local Medical Personnel

Physicians - 7
Dentists - 5

Hospitals

<u>General Hospital</u>	<u>Location</u>	<u>Beds*</u>
Southeastern Kentucky Baptist Hospital	Corbin, 15 miles north of Williamsburg	149 plus 4 neonatal

General hospital facilities - Four operating rooms, outpatient surgery, delivery room, laboratory, non-invasive laboratory, X-ray, ultrasound, nuclear medicine, dietary, pediatrics, obstetrics, respiratory therapy, physical therapy, chaplain, social services, education rooms, gift shop

Medical staff - 39 active physicians, 89 registered nurses, 31 licensed practical nurses

Ambulance Service

Name - Professional Medical Transport**
Staff - 20 emergency medical technicians
Service - 24-hour, county-wide
Equipment - 10 ambulances

Public Health

Facility - Whitley County Health Department***
Staff - Full-time: Nine registered nurses, two health environmentalists, five health service aides, six clerks, two social workers, nutritionist, two licensed practical nurses, health educators, one administrator
Part-time: Registered nurse, two janitors

* Construction of the \$40 million Baptist Regional Medical Center, in Corbin, is currently under way. The 202-bed hospital, which will replace the existing hospital, is scheduled for completion in the fall of 1986.

** Ambulance stations are located in Williamsburg and Corbin.

*** Health centers are located in Williamsburg and Corbin.

OTHER LOCAL FACILITIES

Communications

Telephone -	South Central Bell Telephone Company
Telegraph -	Western Union
Services -	Toll-free number, 1-800-325-5100
Postal -	U.S. Post Office
Class -	First
Mail received -	Once daily
Mail dispatched	Once daily
Newspapers -	Whitley Republican
Weekly and circulation -	5,500
Other papers received from -	Louisville, Lexington, and Corbin, Kentucky; Knoxville, Tennessee
Radio -	WEZJ-AM
Major stations received from -	Corbin and Lexington, Kentucky; Knoxville, Tennessee
Television -	
Cable service	
Reception from -	Lexington, Kentucky; Knoxville, Tennessee; Asheville, North Carolina (plus a local cable access channel)
Kentucky Educational Television -	Somerset transmitter - Channel 29

Library Services

- Public library - Whitley County Public Library
Size collection - 42,403 volumes
Circulation, 1983-84 - 108,108 (includes bookmobile)
Services - Community room, films, records, art, bookmobile, Interlibrary Loan
- College library - Norman Peeking Hagan Memorial Library (Cumberland College)
Size collection - Approximately 150,000 volumes
Special collections - Appalachian Collection, ERIC documents
Services - Dialog, Bibliographic Retrieval System, magazines, interlibrary loans, microfilm, microfiche, reader-printer, photo-copy machine

Religious Institutions

Number of churches - 12
 Denominations - Baptist
 Catholic
 Christian
 Church of Christ
 Church of God
 Methodist
 Seventh Day Adventist

Nearest Synagogues - Knoxville, Tennessee, 69 miles south
 Congregations - Heska Amuna Congregation (orthodox)
 Temple Bethel (reform)

Financial Institutions

<u>Banks</u>	<u>Assets</u>	<u>Deposits</u>	<u>Statement Date</u>
Bank of Williamsburg	\$36,272,000.00	\$34,454,000.00	6/30/84
Farmers National Bank	69,151,450.93	62,076,623.98	6/30/84
<u>Savings and Loan Associations</u>	<u>Assets</u>	<u>Savings Accounts</u>	<u>Statement Date</u>
First Federal Savings and Loan Association*	\$59,635,235.67	\$54,499,674.34	7/31/84

Hotels and Motels

Total number - 7
 Total rooms - 400

* The First Federal Savings and Loan Association has branch offices located in Williamsburg, Corbin, Barbourville, and London, with its main office located in Pineville.

Clubs and Organizations

American Legion
Boy Scouts
Business and Professional Women
Chamber of Commerce
Daughters of American Revolution
Disabled American Veterans
Eastern Star
4-H Club
Future Homemakers of America
Future Farmers of America
Girl Scouts
Independent Order of Odd Fellows
Junior Little League Baseball
Junior Little League Basketball
Junior Little League Football
Kiwanis
Masons
Optimist
Rotary
Shriners
Veteran's of Foreign Wars
Williamsburg Bass Club
Williamsburg Ministerial Association
Woman's Club
Younger Woman's Club

RECREATION

Local

Public recreation facilities in Williamsburg include a park with a swimming pool, playground, little league field, tennis courts and baseball fields. The American Legion football and baseball fields are also available for public use. Private recreation facilities include a country club with golf course and swimming pool, and one indoor and one outdoor movie theater. Future plans include the construction of two lighted softball fields.

Laurel River Lake, located in Whitley County, is a 5,600-acre lake that offers camping, fishing, boating, and swimming. Several areas around this new lake are now under development. A 28-acre picnic area, picnic shelter, playground area, hiking trail, and restroom facilities, were recently completed. A 50-slip marina, vehicle-access campground, and an amphitheater are under construction.

Whitley County is located in the southern portion of the **Daniel Boone National Forest**, which covers 640,000 acres of timberland in eastern Kentucky. It encompasses much of Kentucky's great beauty and provides a vacation paradise. There are scenic hiking trails, rivers and streams stocked with a variety of fish, hunting preserves, camping sites, and numerous other natural and historical attractions.

Cumberland Falls State Resort Park is located 19 miles northwest of Williamsburg in the Daniel Boone National Forest. The park is famous for Cumberland Falls which drops 68 feet over a rock precipice and shows one of only two known "moonbows" in the world at full moon. The park offers 53 lodge rooms, woodland suites, 27 cottages, camping, fishing, swimming, hiking, horseback riding, picnicking, tennis, backpacking, shuffleboard, planned recreation, a playground, and an amphitheater.

Area (Within 55 miles)

The Big South Fork National River and Recreation Area, 28 miles west of Williamsburg near Whitley City, is being developed as an outdoor recreation area by the U.S. Army Corps of Engineers in cooperation with the National Park Service. The area lies along the Big South Fork of the Cumberland River in Kentucky and Tennessee and encompasses some of the state's most rugged and scenic terrain. Recreational opportunities in the "National Area" include hiking, camping, horseback riding and picnicking, whitewater rafting, canoeing and kayaking trips. The Big South Fork Scenic Railway offers a chance to see part of the rugged Cumberland River area by rail. The train operates on a regular schedule between Stearns and the Big South Fork National River and Recreation Area near the historic Blue Heron Coal Tipple, a distance of about 5 miles each direction.

Levi Jackson Wilderness Road State Park, 28 miles north of Williamsburg at London, is an 815-acre park located where the Boone Trace and Wilderness Road pioneer trails converge. In addition to a reproduced pioneer settlement, the park offers a pool, a bathhouse, hiking trails, horseback riding, shuffleboard, 200 campsites, a picnic area, a playground, and an amphitheater.

Pine Mountain State Resort Park in Pineville, 39 miles east from Williamsburg, provides the finest in mountain scenery and the ultimate in quiet comfort. The 2,500-acre park is located in the Kentucky Ridge State Forest and is the scene of the Mountain Laurel Festival each spring. Also featured is a 35-acre lake, 330 lodge rooms, 20 cottages, a dining room, a gift shop, a meeting room, 36 camping sites, a lodge pool, fishing, a 9-hole golf course, hiking trails, a nature center, picnicking, playgrounds, shuffleboard, and planned recreation.

Dr. Thomas Walker State Shrine, 42 miles east of Williamsburg near Barbourville, is the site of the cabin built by Dr. Walker, who led an expedition through Cumberland Gap around 1750. This 12-acre park contains a replica of the cabin, a playground, a picnic shelter, and an amphitheater.

General Burnside State Park, 43 miles northwest of Williamsburg, is Kentucky's only island state park. Rising out of Lake Cumberland and surrounded by beautiful Kentucky mountains, the park offers excellent fishing, an 18-hole golf course which is open year-round, a picnic area, a 161-site camping area for tents and recreational vehicles, a marina on the mainland near the park, and recreation.

Cumberland Gap National Historic Park is located 54 miles southeast of Williamsburg near Middlesboro. The 20,270-acre park, located in Kentucky, Virginia and Tennessee, is the second largest national historic park in the United States. Features at the park include a frontier museum, Pinnacle Mountain, a restored mountain village, an old iron furnace and caves.

COMMUNITY IMPROVEMENTS

Recent

Construction of a 104-unit apartment complex for low to moderate income was completed in the fall of 1982. Total cost of the project was \$1.2 million.

Cumberland College recently completed several projects which include the construction of a \$1.5 million men's dormitory; the \$500,000 renovation of the old Williamsburg city school building into classrooms; and the addition of a football program.

Phase one of a 201 study of the Williamsburg Sewerage System was recently completed.

The Williamsburg Independent School System recently completed the construction of a new \$4 million school building which houses the entire school system.

The City of Williamsburg recently purchased a new \$680,000 pumper tanker fire truck.

The construction of the Bank of Williamsburg, a \$2 million four-story building, was recently completed.

The construction of two shopping centers, the Jackson Mall and the Downtown Plaza, were recently completed.

Under Way

Projects currently under way at Cumberland College include a \$500,000 renovation of the gymnasium and a \$500,000 renovation of Mahan Hall, a men's dormitory.

Planned

The Whitley County School System has plans for the addition to and remodeling of the bus maintenance garage.

The Cumberland Falls Highway Water District has plans for the expansion of 25 miles of six-inch water line. The \$1 million project is scheduled for Spring 1986.