

1984

# Industrial Resources: Christian County - Hopkinsville

Kentucky Library Research Collections  
Western Kentucky University, [spcol@wku.edu](mailto:spcol@wku.edu)

Follow this and additional works at: [https://digitalcommons.wku.edu/christian\\_cty](https://digitalcommons.wku.edu/christian_cty)

 Part of the [Business Administration, Management, and Operations Commons](#), [Growth and Development Commons](#), and the [Infrastructure Commons](#)

---

## Recommended Citation

Kentucky Library Research Collections, "Industrial Resources: Christian County - Hopkinsville" (1984). *Christian County*. Paper 7.  
[https://digitalcommons.wku.edu/christian\\_cty/7](https://digitalcommons.wku.edu/christian_cty/7)

This Report is brought to you for free and open access by TopSCHOLAR®. It has been accepted for inclusion in Christian County by an authorized administrator of TopSCHOLAR®. For more information, please contact [topscholar@wku.edu](mailto:topscholar@wku.edu).

IA  
437

CHRISTIAN COUNTY

RESOURCES  
FOR  
ECONOMIC  
DEVELOPMENT

**CROFTON**



**KENTUCKY**

The Business Environment is Right

# CROFTON, KENTUCKY --- Site 184 --- 52 Acres

For more information contact the Kentucky Department of Economic Development, Industrial Development & Marketing Division, Capital Plaza Tower, Frankfort, Kentucky 40601 (502-564-7140).

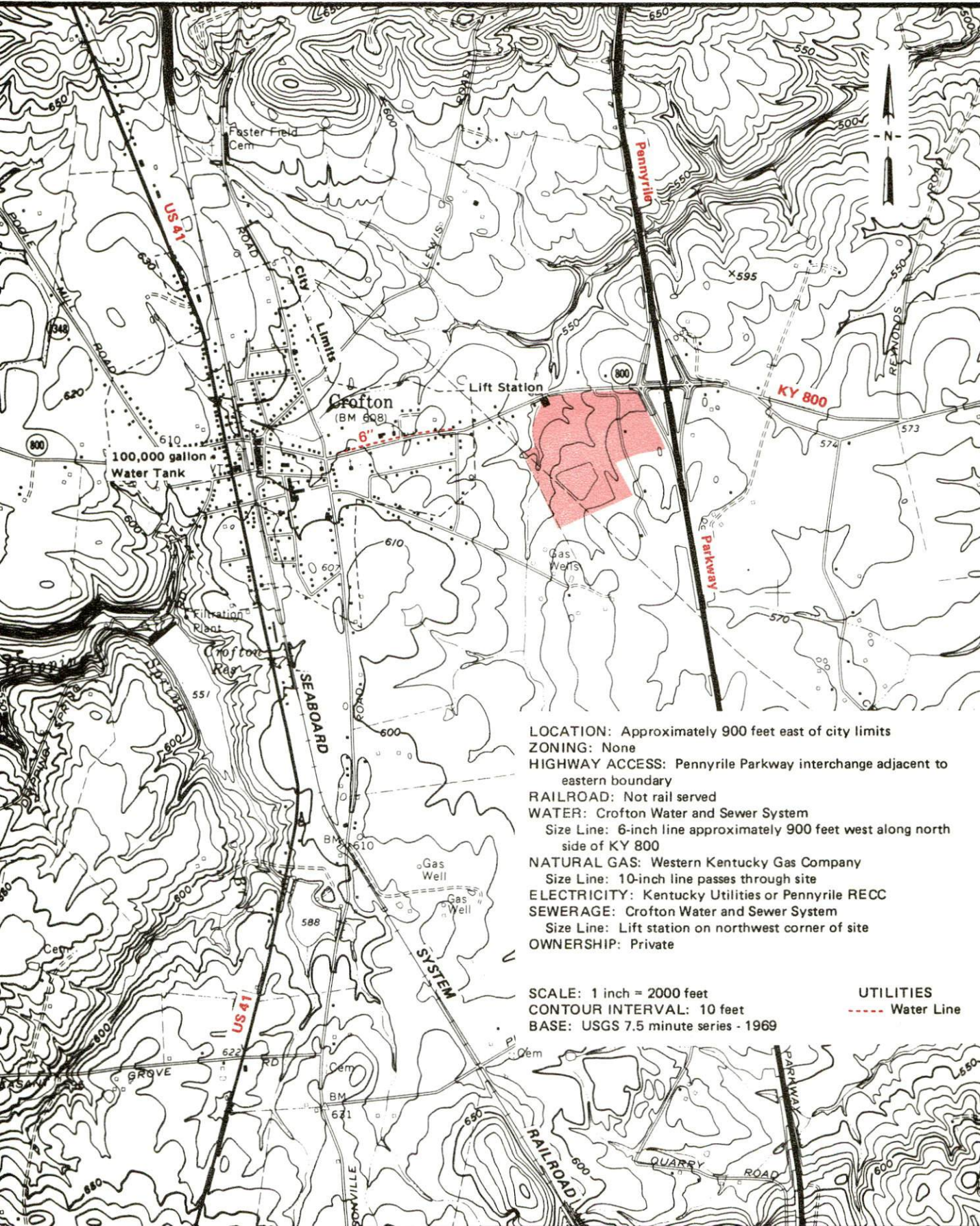

**LOCATION:** Approximately 900 feet east of city limits  
**ZONING:** None  
**HIGHWAY ACCESS:** Pennyriple Parkway interchange adjacent to eastern boundary  
**RAILROAD:** Not rail served  
**WATER:** Crofton Water and Sewer System  
Size Line: 6-inch line approximately 900 feet west along north side of KY 800  
**NATURAL GAS:** Western Kentucky Gas Company  
Size Line: 10-inch line passes through site  
**ELECTRICITY:** Kentucky Utilities or Pennyriple RECC  
**SEWERAGE:** Crofton Water and Sewer System  
Size Line: Lift station on northwest corner of site  
**OWNERSHIP:** Private

**SCALE:** 1 inch = 2000 feet  
**CONTOUR INTERVAL:** 10 feet  
**BASE:** USGS 7.5 minute series - 1969

**UTILITIES**  
--- Water Line

RESOURCES FOR ECONOMIC DEVELOPMENT  
CROFTON, KENTUCKY

Prepared by  
The Kentucky Department of Economic Development  
Division of Research and Planning  
in cooperation with  
The North Christian Industrial Foundation

1984

Program manager - Pamela Riley; research - James Thompson; clerical - Bobbi Graves; graphics - Frank Ferrante, Tony Cecconi, Robert Owens; cartography - Site Evaluation Branch, Division of Industrial Development and Marketing. Cost of printing paid from state funds.

## TABLE OF CONTENTS

<u>Chapter</u>	<u>Page</u>
INDUSTRIAL SITES .....	i
CROFTON, KENTUCKY - A RESOURCE PROFILE .....	1
THE LABOR MARKET AREA .....	3
Population .....	3
Labor Force Characteristics of Residents, 1983 .....	3
Selected Components of Nonagricultural Employment, by Place of Work, 1983 .....	4
Crofton Manufacturing Firms, Their Products and Employment .....	4
Labor Organizations in Manufacturing Firms .....	4
Industrial Services .....	5
Estimated Male Labor Supply .....	6
Estimated Female Labor Supply .....	7
Average Weekly Wages By Industry, by Place of Work, 1983 .....	8
Per Capita Personal Income .....	10
TRANSPORTATION .....	11
Rail .....	11
Highways .....	11
Truck Service .....	11
Air .....	12
Bus .....	13
Taxi .....	13
Rental Services .....	13
Water .....	14
POWER AND FUEL .....	15
Electricity .....	15
Natural Gas .....	16
Other Fuels .....	17
WATER AND SEWERAGE .....	18
Public Water Supply .....	18
Raw Water .....	18
Sewerage .....	19
CLIMATE .....	20

<u>Chapter</u>	<u>Page</u>
LOCAL GOVERNMENT .....	21
City .....	21
County .....	21
Assessed Value of Property, 1983 .....	21
Property Taxes .....	21
Combined State and Local Rates Per \$100 Valuation, 1983 .....	22
Utilities Gross Receipts Tax for Schools .....	22
Planning and Zoning .....	22
Safety .....	23
Police .....	23
Fire .....	23
Rescue Service .....	23
Refuse Collection and Disposal .....	23
EDUCATION .....	24
Public Schools .....	24
Nonpublic Schools .....	24
Area Colleges and Universities .....	25
Vocational Schools .....	26
HEALTH .....	28
Hospitals .....	28
Ambulance Service .....	28
Public Health .....	29
OTHER LOCAL FACILITIES .....	30
Communications .....	30
Library Services .....	30
Religious Institutions .....	31
Financial Institutions .....	31
Hotels and Motels .....	31
Clubs and Organizations .....	31
RECREATION .....	32
COMMUNITY IMPROVEMENTS .....	34



1984 EDITION  
GENERAL HIGHWAY MAP  
**CHRISTIAN COUNTY**  
KENTUCKY

PREPARED BY THE  
KENTUCKY TRANSPORTATION CABINET  
DEPARTMENT OF HIGHWAYS  
DIVISION OF PLANNING  
IN COOPERATION WITH THE  
U.S. DEPARTMENT OF TRANSPORTATION  
FEDERAL HIGHWAY ADMINISTRATION







## CROFTON, KENTUCKY - A RESOURCE PROFILE

Crofton, a small community in northern Christian County, is located in southwestern Kentucky. Crofton, with a 1980 population of 823, is located 84 miles northwest of Nashville, Tennessee; 157 miles southwest of Louisville, Kentucky; and 236 miles southeast of St. Louis, Missouri.

Christian County, with a land area of 722 square miles, is Kentucky's second largest county. Located within Kentucky's Pennyroyal Region, Christian County is bordered on the south by the Kentucky-Tennessee state line and to the north is the Western Coal Field Region. In 1980, Christian County had a population of 66,878.

### The Economic Framework

The total number of Christian County residents employed in 1983 averaged 21,440, with nonagricultural jobs accounting for 20,095 jobs. Manufacturing employers in the county reported 3,480 workers; wholesale and retail trade 4,070; services 2,830; and state and local government 2,430. Manufacturing products in Crofton are pallets and custom wood products.

Per capita personal income in Christian County in 1982 was \$8,644. Between 1978 and 1982 per capita income increased by 47 percent.

The Crofton labor market area includes Christian County and the adjoining Kentucky counties of Caldwell, Hopkins, Muhlenberg, Todd and Trigg, plus Montgomery and Stewart Counties in Tennessee. The total number of residents in the Kentucky portion of the labor market area employed in 1983 averaged 67,350 with nonagricultural jobs accounting for 63,480 workers. Manufacturing employers in this area reported 8,990 workers; wholesale and retail trade 10,180; services, 8,190; and state and local government 6,570.

### Resources for Growth

1. Labor Supply - There is a current labor supply of 11,750 men and 14,190 women available for industrial jobs in the labor market area. In addition, from 1984 through 1988, 10,770 young men and 10,060 young women in the area will become 18 years of age and potentially available for industrial jobs.

2. Transportation - Main line rail service is provided to Crofton by the Seaboard System Railroad. Major highways serving Crofton are U.S. Highway 41, a "AAA" rated trucking highway, and the Pennyryle Parkway, a multilane toll road. The Western Kentucky Parkway, a multilane toll road, is located only 12 miles north of Crofton via the Pennyryle Parkway. Eight common carriers have authority to serve Crofton. The Hopkinsville-Christian County Airport, located 14 miles south, has one runway 5,000 feet in length. Commuter air service is available 31 miles south at Outlaw Field, near Clarksville, Tennessee. The nearest scheduled commercial airline service is available at Nashville Metropolitan Airport, 90 miles southeast.

3. Power and Fuel - Crofton is provided electric power by the Pennyrile Rural Electric Cooperative Corporation, which is supplied by Tennessee Valley Authority. Christian County is provided electric power by the Pennyrile Rural Electric Cooperative Corporation, which is supplied by Tennessee Valley Authority; the Kentucky Utilities Company, an electric generation and transmission company; and the Hopkinsville Electric Plant Board, which is supplied by the Tennessee Valley Authority. Natural gas service is provided by the Western Kentucky Gas Company, which is supplied by Texas Gas Resources Corporation. There are two distributors of propane and eight distributors of distillate fuel oil serving Crofton.

4. Education - The Christian County School System is accredited by the Southern Association of Colleges and Schools and serves 9,220 primary and secondary students. In addition, there are four nonpublic schools in Hopkinsville, 13 miles south of Crofton.

There are five universities and three community colleges located within 70 miles of Crofton.

The Madisonville State Vocational-Technical School in Madisonville, 21 miles north, offers training in 20 courses. The Christian County Area Vocational Education Center offers training in 13 courses.

## THE LABOR MARKET AREA

The Crofton Labor Market Area includes Christian County and the adjoining Kentucky counties of Caldwell, Hopkins, Muhlenberg, Todd and Trigg. The southern boundary of Christian County is formed by the Tennessee state line. The Crofton Labor Market Area also includes the two adjoining Tennessee counties of Montgomery and Stewart.

POPULATION			
<u>Area</u>	<u>1980</u>	<u>1970</u>	<u>Percent Nonwhite</u>
Crofton	823	631	18.5
Labor Market Area	180,021	154,550	N/A
Christian County	66,878	56,224	28.9
Caldwell County	13,473	13,179	6.4
Hopkins County	46,174	38,167	7.2
Muhlenberg County	32,238	27,537	5.3
Todd County	11,874	10,823	12.4
Trigg County	9,384	8,620	12.7

Note: The 1980 counts of population by race are provisional.

Sources: U.S. Department of Commerce, Bureau of the Census, 1980 Census of Population and Housing, March 1981; 1980 Census of Population, Number of Inhabitants. Population Research Unit, Urban Studies Center, University of Louisville, Kentucky Demographics: The 1980 Census of Kentucky, Characteristics of Population, Households, Housing, January 1982.

### LABOR FORCE CHARACTERISTICS OF RESIDENTS, 1983

	<u>Christian County</u>	<u>Labor Market Area*</u>
Civilian Labor Force	23,440	76,412
Employment	21,441	67,351
Agricultural	1,346	3,867
Nonagricultural	20,095	63,484
Unemployment	1,999	9,061
Rate of Unemployment (%)	8.5	11.9

\* Christian County and the five adjoining Kentucky counties.

Source: Kentucky Cabinet for Human Resources, Kentucky Labor Force Estimates, Annual Averages, 1983.

SELECTED COMPONENTS OF NONAGRICULTURAL EMPLOYMENT,  
BY PLACE OF WORK, 1983

	Christian County	Labor Market Area*
All Industries (total)	14,791	43,032
Manufacturing	3,479	8,991
Wholesale & Retail Trade	4,068	10,181
Services	2,826	8,189
State/Local Government	2,434	6,570
Contract Construction	518	1,349
Mining & Quarrying	82	3,786

\* Christian County and the five adjoining Kentucky counties.

Note: Excludes domestic workers, railway workers, certain nonprofit corporations, majority of federal government workers, and self-employed workers.

Source: Kentucky Cabinet for Human Resources, Average Monthly Workers Covered by Kentucky Unemployment Insurance Law, 1983.

CROFTON MANUFACTURING FIRMS,  
THEIR PRODUCTS AND EMPLOYMENT

Firm (Establishment date)	Product	Employment		
		Total	Male	Female
Pennyrile Pallet Company (1983)	Wood pallets	8	--	--
Yoder Wood Products (1982)	Custom wood furniture	1	1	0

Sources: Kentucky Department of Economic Development, 1984 Kentucky Directory of Manufacturers; Division of Research and Planning.

LABOR ORGANIZATIONS IN MANUFACTURING FIRMS

There are no unions representing manufacturing workers in Crofton at the present time.

## INDUSTRIAL SERVICES

<u>Types of Services</u>	<u>Location</u>	<u>Mileage from Crofton</u>
Custom Plastics Producers	Providence, Kentucky	42
	Livermore, Kentucky	48
	Kuttawa, Kentucky	55
	Henderson, Kentucky	58
Electric Motor Repair	Hopkinsville, Kentucky	13
	Madisonville, Kentucky	21
Grinding, Precision & Tool	Evansville, Indiana	68
	Nashville, Tennessee	84
	Paducah, Kentucky	87
Heat Treating Facilities	Evansville, Indiana	68
	Nashville, Tennessee	84
	Paducah, Kentucky	87
Industrial Equipment & Supplies	Greenville, Kentucky	28
Industrial Gases	Henderson, Kentucky	58
	Bowling Green, Kentucky	66
	Evansville, Indiana	68
Industrial Waste Removal	Dawson Springs, Kentucky	28
	Russellville, Kentucky	37
Machine Shops, Tool & Die	Hopkinsville, Kentucky	13
Metal Finishers	Hartford, Kentucky	56
	Evansville, Indiana	68
Metal Service Centers	Greenville, Kentucky	28
	Russellville, Kentucky	37
Millwrights	Hopkinsville, Kentucky	13

Sources: Kentucky Department of Economic Development, Kentucky Directory of Selected Industrial Services, 1983; Division of Research and Planning.

ESTIMATED MALE LABOR SUPPLY  
CROFTON LABOR MARKET AREA

Area	Current			Not in Labor Force	Future Becoming 18 years of age 1984 thru 1988
	Total	Unemployed	Under- employed		
Labor Market					
Area*	11,752				10,769
Christian	3,175	1,034	1,767	374	2,524
Caldwell	856	494	186	176	537
Hopkins	1,754	1,211	543	0	1,965
Muhlenberg	1,603	1,209	394	0	1,346
Todd	1,041	252	223	566	545
Trigg	492	322	170	0	429
Montgomery (Tenn.)	2,263	N/A	N/A	N/A	3,068
Stewart (Tenn.)	568	N/A	N/A	N/A	355

\* Additional workers may be drawn from other nearby counties.

Note: Unemployed - persons unemployed and actively seeking work;  
Underemployed - persons employed but working only 14 to 26 weeks per year;  
Not in Labor Force - represents the number of persons who would enter the labor force if suitable employment were available (based on the assumption that persons in Kentucky would like to participate in the labor force in the same proportion that they do nationally).

Sources: Kentucky Cabinet for Human Resources, Kentucky Labor Supply Estimates by Area Development District and County, 1982. Tennessee Department of Economic and Community Development, Tennessee Available Labor, 1982. Kentucky Department of Economic Development, Future Labor Supply Becoming 18 Years of Age, 1984 thru 1988.

ESTIMATED FEMALE LABOR SUPPLY  
CROFTON LABOR MARKET AREA

Area	Current			Not in Labor Force	Future
	Total	Unemployed	Under- employed		Becoming 18 years of age 1984 thru 1988
Labor Market					
Area*	14,191				10,060
Christian	2,675	1,202	1,099	374	2,391
Caldwell	1,230	341	311	578	483
Hopkins	3,000	764	777	1,459	1,865
Muhlenberg	2,379	572	388	1,419	1,230
Todd	1,181	271	192	718	461
Trigg	404	217	187	0	374
Montgomery (Tenn.)	2,974	N/A	N/A	N/A	2,923
Stewart (Tenn.)	348	N/A	N/A	N/A	333

\* Additional workers may be drawn from other nearby counties.

Note: Unemployed - persons unemployed and actively seeking work;  
Underemployed - persons employed but working only 14 to 26 weeks per year;  
Not in Labor Force - represents the number of persons who would enter the labor force if suitable employment were available (based on the assumption that persons in Kentucky would like to participate in the labor force in the same proportion that they do nationally).

Sources: Kentucky Cabinet for Human Resources, Kentucky Labor Supply Estimates by Area Development District and County, 1982. Tennessee Department of Economic and Community Development, Tennessee Available Labor, 1982. Kentucky Department of Economic Development, Future Labor Supply Becoming 18 Years of Age, 1984 thru 1988.



AVERAGE WEEKLY WAGES BY INDUSTRY,  
BY PLACE OF WORK, 1983

	<u>Christian County</u>	<u>Caldwell County</u>	<u>Hopkins County</u>
All Industries	\$ 247.25	\$ 241.69	\$ 328.80
Mining & Quarrying	294.14	422.50	639.57
Contract Construction	296.98	192.89	347.42
Manufacturing	300.93	288.79	381.50
Transportation, Communications & Public Utilities	305.96	333.50	374.13
Wholesale & Retail Trade	199.50	171.16	221.88
Finance, Insurance & Real Estate	265.68	252.32	250.30
Services	200.07	199.86	241.32
State/Local Government	276.28	259.25	292.67
Other	175.09	208.28	186.45
	<u>Muhlenberg County</u>	<u>Todd County</u>	<u>Trigg County</u>
All Industries	\$ 370.20	\$ 217.80	\$ 238.36
Mining & Quarrying	712.48	*	*
Contract Construction	250.78	234.89	278.07
Manufacturing	242.11	242.16	300.16
Transportation, Communications & Public Utilities	425.99	337.07	337.93
Wholesale & Retail Trade	218.72	167.59	139.59
Finance, Insurance & Real Estate	260.94	223.07	243.88
Services	211.54	123.45	162.68
State/Local Government	272.87	215.00	230.75
Other	316.25	*	177.79

\* Not disclosed.

Note: Excludes domestic workers, railway workers, certain nonprofit corporations, majority of federal government workers, and self-employed workers.

Source: Kentucky Cabinet for Human Resources, Average Weekly Wages of Workers Covered by Kentucky Unemployment Insurance Law, 1983.

Occupational wage rates for specific industries are usually not available to most government agencies, and wage data furnished to state employment agencies by individual industrial employers are protected from disclosure by federal law. The most reliable up-to-date wage information can be obtained by direct contact with local employers.

Associated Industries of Kentucky, a voluntary organization of Kentucky businesses, regularly collects occupational wage rates and fringe benefits data from participating member firms. Data are compiled for over 127 clearly defined office, production, and service occupations. Tabulations are published for nine geographical areas of Kentucky, as shown on the map below. It should be noted that the data may be weighted by the preponderance of firms in the larger cities and may be somewhat higher than the rates paid in the smaller communities. Data from these tabulations are available, upon request, from the Kentucky Department of Economic Development, Frankfort, Kentucky 40601.

- Area 1 - Western
- Area 2 - Green River
- Area 3 - Southern
- Area 4 - Southeastern
- Area 5 - Louisville
- Area 6 - Central
- Area 7 - Lexington-Bluegrass
- Area 8 - Northern
- Area 9 - Northeastern

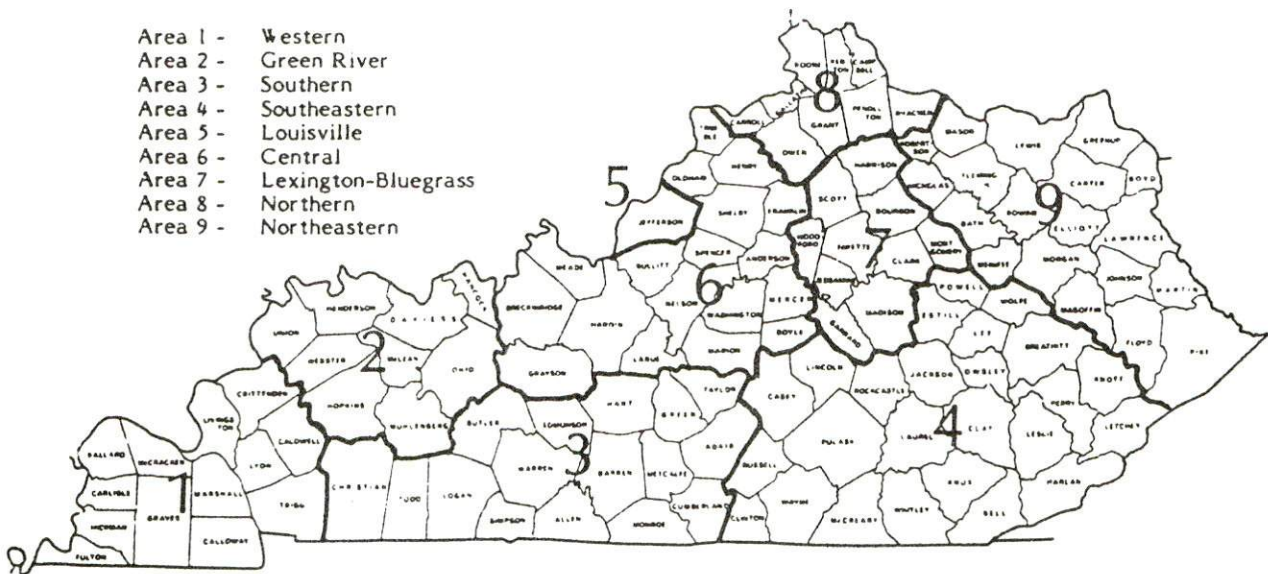

Associated Industries of Kentucky Area Wage Surveys

Up to date occupational wage rates of the existing industries are maintained by South Kentucky Industrial Development Association, Post Office Box 726, Hopkinsville, Kentucky 42240.

PER CAPITA PERSONAL INCOME

<u>Area</u>	<u>1978</u>	<u>1982</u>	<u>Percent Change</u>
Christian County	\$ 5,864	\$ 8,644	47.4
Labor Market Area Range*	\$5,128 - 7,620	\$7,229 - 10,777	N/A
Kentucky	6,389	8,893	39.2
U. S.	7,776	11,100	42.7

\* Christian County and the five adjoining Kentucky counties.

Sources: U.S. Department of Commerce, Bureau of Economic Analysis, Survey of Current Business, April 1983; Commerce News, April 29, 1984. Kentucky Economic Information System, July 1984.

## TRANSPORTATION

### Rail

Line serving **Crofton** - Seaboard System Railroad

Services - Main line; eleven southbound and nine northbound through freights daily; local freight service is available Monday through Friday; switching services; team track space for 5 cars; nearest Seaboard System Railroad piggyback facilities at Evansville, Indiana, 68 miles north, Nashville Tennessee, 84 miles southeast, or Owensboro, Kentucky, 82 miles northeast

For details on routing, schedules, rates, and services, contact:

Manager of Industrial Development  
Seaboard System Railroad  
P.O. Box 32290  
Louisville, Kentucky 40232  
(502) 587-5228

### Highways

Crofton is served directly by U.S. Highway 41, a "AAA" rated (80,000-pound gross load limit) trucking highway, and Kentucky Highways 800 and 1348. The Pennyriple Parkway, a multilane toll road, is located 1 mile east of Crofton. The Pennyriple Parkway connects with the Western Kentucky Parkway, a multilane toll road, 12 miles north of Crofton. Interstate 24, a major east-west route, is located 26 miles south of Crofton via U.S. 41 and U.S. 41A.

### Truck Services

<u>Company</u>	<u>Home Office</u>
A & H Truck Line, Inc.*	Evansville, Indiana 47711
American Freight System, Inc.**	9393 W. 110th Street Overland Park, Kansas 66210
Majors Transit, Inc.*	P.O. Box 9 Caneyville, Kentucky 42721
The Mason and Dixon Lines, Inc.*	P.O. Box 969 Kingsport, Tennessee 37662
McLean Trucking Company**	P.O. Box 213 Winston-Salem, North Carolina 27154
Overnite Transportation Company*	P.O. Box 1216 Richmond, Virginia 23209
Renner's Express, Inc.***	P.O. Box 882 Indianapolis, Indiana 46206
Smith's Transfer Corporation*	P.O. Box 1000 Staunton, Virginia 24401

\* Interstate and intrastate service.

\*\* Interstate service only.

\*\*\* Intrastate service only.

Source: American Motor Carrier Directory, Spring 1984.

Other Freight Services

Emery  
 Federal Express  
 KATO Express, Inc. (air cargo service)

Purolator Courier  
 United Parcel Service

Nearest Office or Shipping Center

Evansville, Indiana, 68 miles north  
 Clarksville, Tennessee, 38 miles south

Elizabethtown, Kentucky, 113 miles northeast

Evansville, Indiana, 68 miles north  
 Hopkinsville, Kentucky, 13 miles south

HIGHWAY MILES AND TRUCK TRANSIT TIME IN DAYS FROM  
 CROFTON, KENTUCKY, TO SELECTED MARKET CENTERS

City	Highway Miles	Delivery	City	Highway Miles	Delivery
		Time TL			Time TL
Atlanta, Ga.	326	2	Los Angeles, Ca.	2,081	5
Baltimore, Md.	736	3	Louisville, Ky.	157	-
Birmingham, Ala.	280	2	Nashville, Tenn.	84	-
Chicago, Ill.	360	3	New Orleans, La.	601	2
Cincinnati, Ohio	258	2	New York, N. Y.	898	4
Cleveland, Ohio	502	3	Pittsburgh, Pa.	538	3
Detroit, Mich.	517	2	St. Louis, Mo.	236	2
Knoxville, Tenn.	261	2			

Note: Mileage computations are via the best interstate or primary highways, not necessarily the most direct route of travel.

Sources: Rand McNally Road Atlas, 1979. Official Kentucky Mileage Map, 1980.  
 Delivery time - Smith's Transfer Corporation, P.O. Box 1000, Staunton, Virginia 24401.

**Air**Local

Hopkinsville-Christian County Airport  
 14 miles south of Crofton

Location: 14 miles south of Crofton  
 Runways: 1 paved  
 Length: 5,000 feet  
 Traffic  
 Control: Wind sock on northwest corner, unicom  
 Lighting: Sundown to sunrise  
 Services: 100LL octane and jet fuel; major and minor A & P repairs; tie-down, taxi and T-hangar; charter; flight training; car rental

Navigation: SDF, localizer, radar

Air Freight Service: Chartered air freight services must be arranged

(Cont'd)

Nearest Scheduled Commercial Airline Service\*

**Location:** Evansville Dress Regional Airport  
4 miles north of Evansville, Indiana;  
72 miles north of Crofton

**Runways:** 3 paved  
**Length:** 8,021 feet; 5,088 feet; 3,500 feet

**Traffic Control:** Tower

**Lighting:** Beacon, runway

**Services:** Eastern, USAir, Allegheny Commuter, Britt Airways, Comair; fuel - 100LL, jet-A; hangars, tie-downs; major A & P repairs, major Avionics repairs; flight instruction, APU, charter, oxygen, plane rental, survival equipment; taxi, car rentals, courtesy car; weather information; restaurant

**Air Freight Service:** Air freight terminal

**Location:** Nashville Metropolitan Airport  
6 miles southeast of Nashville, Tennessee;  
90 miles southeast of Crofton

**Runways:** 3 paved  
**Length:** 8,000 feet; 7,700 feet; 4,320 feet

**Traffic Control:** Tower

**Lighting:** Beacon, runway

**Services:** American, Delta, Eastern, Ozark, Pan Am, Piedmont, Republic, TWA, United, USAir, Allegheny Commuter, Comair, Florida Express, Scheduled Skyways, Sunbird, Tennessee Airways; fuel - 100LL, jet-A; tie-downs, hangars; major A & P repairs, major Avionics repairs; APU, charter, flight instruction, oxygen, plane rental, survival equipment, U. S. Customs; taxi, limousine, car rental, courtesy car, public transit; weather information; restaurant, snack bar

**Air Freight Service:** Air freight terminal

**Bus** - Greyhound Bus Lines provides service in Hopkinsville, 13 miles south

**Taxi** - Taxi service is available in Hopkinsville, 13 miles south

**Rental Services** - Car, truck and trailer rentals are available in Hopkinsville, 13 miles south

\* Commuter air carrier service is provided by Allegheny Commuter at Outlaw Field which is located 7 miles northwest of Clarksville, Tennessee; 31 miles south of Crofton.

## Water

The nearest navigable waterway is Lake Barkley. Lake Barkley, part of the inland waterway system, is formed by the Cumberland River and a nine-foot navigation channel is maintained. The Ohio, Tennessee and Cumberland Rivers are all part of the inland waterway system and are interconnected at or near the northwestern portion of Lake Barkley.

The Port of Lyon County operates a public port facility on Lake Barkley which is located 54 miles west of Crofton. The Port consists of a 32-acre public port which includes loading facilities for grain, coal and limestone; a public dock with crane service; and outside storage areas. Planned facilities include a public warehouse; establishment of a Foreign Trade Zone; and the addition of rail service.

## POWER AND FUEL

### Electricity

Company serving **Crofton and a major portion of Christian County** - Pennyrile Rural Electric Cooperative Corporation  
Source of power - Tennessee Valley Authority  
Total generating capacity - 31,109,160 KW  
For industrial rates contact:

South Kentucky Industrial Development  
Association, Inc.  
P.O. Box 726  
Hopkinsville, Kentucky 42240  
(502) 885-5392

and/or

Pennyrile RECC  
2000 Harrison Street  
P.O. Box 551  
Hopkinsville, Kentucky 42240  
(502) 886-2555

Company serving a portion of northern **Christian County** - Kentucky Utilities Company  
Source of power - Kentucky Utilities Company  
Total generating capacity - 3,164,000 KW\*  
For industrial rates contact:

Industrial Development Department  
Kentucky Utilities Company  
One Quality Street  
Lexington, Kentucky 40507  
(606) 255-1461

\* Kentucky Utilities Company's total generating capacity will be increased when a new 650,000 KW generation plant is completed in Hancock County in 1993.



Company serving a small portion of **Christian County** - Hopkinsville Electric Plant Board

Source of power - Tennessee Valley Authority

Total generating capacity - 31,109,160 KW

For industrial rates contact:

South Kentucky Industrial Development  
Association, Inc.

P.O. Box 726

Hopkinsville, Kentucky 42240

(502) 885-5392

and/or

Hopkinsville Electric Plant Board

101 North Main Street

P.O. Box 544

Hopkinsville, Kentucky 42240

(502) 887-4200

## Natural Gas

Company serving **Crofton** - Western Kentucky Gas Company

Source of supply - Texas Gas Resources Corporation

Size of transmission mains - 10-inch (supplier); 2-inch (distributor)

Distribution mains - 1½ to 2 inches

Distribution pressure - 10 to 20 psi

Btu content - 1,000 per cubic foot

Specific gravity - .60

For rates and supplies contact:

Western Kentucky Gas Company  
Director of Industrial Customer

Relations

311 West 7th Street

P.O. Box 866

Owensboro, Kentucky 42302

(502) 685-8000

## Other Fuels

### Propane (Christian County)

Pargas of Hopkinsville\*  
Fort Campbell Boulevard  
Hopkinsville, Kentucky 42240

Southern States Hopkinsville  
Petroleum Cooperative\*  
520 Wooldridge Road  
Hopkinsville, Kentucky 42240

### Fuel oils (Christian County)

#### Distillate fuel oil -

Ashland Petroleum Company\*  
West 15th Street  
Hopkinsville, Kentucky 42240

Chevron USA, Inc.\*  
118 South Clay Street  
Hopkinsville, Kentucky 42240

Home Oil and Gas Company\*  
(Conoco jobber)  
Nashville Road  
Hopkinsville, Kentucky 42240

Hopkinsville Oil Company\*  
(Phillips 66 jobber)  
708 North Main Street  
Hopkinsville, Kentucky 42240

J. B. Hyde Distributing Company\*  
(Gulf jobber)  
700 West 15th Street  
Hopkinsville, Kentucky 42240

Key Oil Company\*  
206 East 25th Street  
Hopkinsville, Kentucky 42240

Monarch Oil Company\*  
(Shell Oil jobber)  
2500 South Virginia Street  
Hopkinsville, Kentucky 42240

Southern States Hopkinsville  
Petroleum Cooperative\*  
520 Wooldridge Road  
Hopkinsville, Kentucky 42240

Residual fuel oil - Arrangements must be made with the refinery.

Low sulphur content coal - Available in Kentucky.

\* Bulk plant.

## WATER AND SEWERAGE

### Public Water Supply

Company serving **Crofton** - Crofton Water and Sewer System  
P.O. Box 243  
Crofton, Kentucky 42217  
(502) 424-5111

Source - Reservoir

Treatment plant capacity - 324,000 gallons per day

Average daily consumption - 90,000 gallons

Peak daily consumption - 175,000 gallons

Type treatment - Filtration, coagulation, and chlorination

Storage capacity - 150,000 gallons

Size lines - 3, 6, and 8 inches

### MONTHLY WATER RATES

First	2,000 gallons	\$ 8.00 (Minimum)
Next	1,000 gallons	1.75 per M gallons
Next	3,000 gallons	1.50 per M gallons
Next	9,000 gallons	1.25 per M gallons
All over	15,000 gallons	1.00 per M gallons

Tap-on charge:

Inside City	Outside City
\$150	\$200

### Raw Water

Surface water sources - Little River, Sinking Fork and Tradewater River

Average discharge - Little River near Cadiz, Kentucky - 345 cfs (42 years, USGS)

Expected ground water yield - Varies throughout the county from a high of 200-500 gpm to a low of 5 gpm or less. Along the Little River the yield is 50 to 200 gpm. The majority of the county falls in the 5 to 50 gpm range.

## Sewerage

Company serving **Crofton** - Crofton Water and Sewer System  
P.O. Box 243  
Crofton, Kentucky 42217  
(502) 424-5111

Design capacity - 100,000 gallons per day

Average daily flow - 60,000 gallons

Type of treatment - Secondary

Treatment process - Aeration

Treated effluent discharged into - Snorton Branch

Size of sanitary mains - 6, 8, and 10 inches

Monthly rates -

First	1,500 gallons	\$ 8.55 (Minimum)
All over	1,500 gallons	1.80 per M gallons

Tap-on charge:

Inside City	Outside City
\$150	\$200

## CLIMATE

### Christian County

#### Temperature

Normal (30-year record)	59.20 degrees
Average annual 1983	59.20 degrees
Record highest, July 1952 (44-year record)	107.00 degrees
Record lowest, January 1963 (44-year record)	-15.00 degrees
Normal heating degree days (30-year record) (Heating degree day totals are the sums of negative departures of average daily temperatures from 65 degrees F.)	3,756

#### Precipitation

Normal (30-year record)	48.49 inches
Mean annual snowfall (42-year record)	11.20 inches
Total precipitation 1983	51.72 inches
Mean number days precipitation (.01 inch or more) (42-year record)	119
Mean number days thunderstorms (42-year record)	54

#### Prevailing Winds (22-year record)

South

#### Relative Humidity (18-year record)

Midnight	79 percent
6 a.m.	84 percent
Noon	58 percent
6 p.m.	61 percent

Source: U.S. Department of Commerce, Environmental Science Services Administration, Climatological Data, 1983. Station of record: Nashville, Tennessee.

## LOCAL GOVERNMENT

### City

Structure - Mayor - 4-year term; 6 council members - 2-year terms  
Budget 1983-84 - General Fund \$ 54,740  
Water and Sewer Fund 125,000  
Fees and licenses - Business license fees range from \$25 to \$65

### County

Structure - County Judge/Executive - 4-year term; 8 magistrates - 4-year terms  
Budget 1983-84 - General Fund \$1,408,598; Road Fund \$661,855

### Assessed Value of Property, 1983\*

<u>Classes of Property</u>	<u>Crofton</u>	<u>Christian County</u>
Real Estate	\$ 2,942,261	\$488,998,822
Tangibles	841,596	143,594,619

### Property Taxes

All property in Kentucky is assessed at 100 percent of fair cash value.

Land and buildings are taxed by the state and may be taxed by local jurisdictions. The state rate is \$0.221 per \$100 of assessed valuation.

Manufacturing machinery, raw materials inventories, pollution control equipment, and goods in the process of manufacture are not subject to local taxation. The state rate is \$0.15 per \$100.

Other tangible personal property owned by manufacturers (automobiles, trucks, finished goods, office furniture, office equipment) is taxed by the state at \$0.45 per \$100 and may be taxed by local jurisdictions.

Intangible personal property located in Kentucky (money in hand, shares of stock, notes, bonds, accounts receivable, and other credits) is taxed by the state at \$0.25 per \$100, and is not subject to local taxation.

Property stored in public warehouses in a transit status is not subject to local taxation. The state rate is only \$0.015 per \$100.

Private leaseholds in industrial facilities owned by cities or counties and financed by industrial revenue bonds are subject to a state tax of \$0.015 per \$100 of value (essentially the lessee's equity, adjusted for appreciation or depreciation). Local taxation is not permitted.

\* Excludes Homestead Exemptions.

**Combined State and Local Rates Per \$100 Valuation, 1983\***  
(100% assessment)

	<u>Site Inside City of Crofton</u>	<u>Site Inside Unincorporated Christian County</u>
1. Land and buildings	\$0.7520	\$0.4520
2. Mfg. machinery, raw materials, goods in process, pollution control equipment	0.1500	0.1500
3. Finished goods, office equipment, vehicles, other tangibles	1.0122	0.7122
4. Intangibles (accounts receivable, notes, bonds, etc.)	0.2500	0.2500
5. Property stored in public warehouses in a transit status	0.0150	0.0150
6. Leaseholds in industrial revenue bond financed plants	0.0150	0.0150

**Utilities Gross Receipts Tax for Schools**

A 3 percent tax is levied on utilities receipts for schools in Christian County. Tax is paid by all consumers of utilities as an add-on to the utilities bills. Exempted are receipts from utilities services that are resold and the receipts from the sale of energy or energy producing fuels that exceed 3 percent of the cost of production in manufacturing, processing, mining or refining.

**Planning and Zoning**

Joint agency - Hopkinsville-Christian County Planning Commission\*\*  
 Zoning enforced - Within the city of Hopkinsville only  
 Subdivision regulations enforced - Within the city of Hopkinsville only  
 Local codes enforced - Building and housing within the city of Hopkinsville only  
 Mandatory state codes enforced - Kentucky Plumbing Code, National Electric Code, Kentucky Boiler Regulations and Standards, Kentucky Building Code (modeled after BOCA code)

\* Kentucky Department of Economic Development.  
 \*\* The participating cities are Crofton, Hopkinsville, Pembroke, Oak Grove, and LaFayette.

## Safety

Police	Crofton	Christian County Sheriff Police	
Total staff	1	15	4
Radio-patrol cars	1	9	2

## Fire

Insurance Services Office, Public Protection Classification	7*	*
Volunteers	20	--

## Rescue Service

### Christian County Rescue Team

Number of volunteers - 32

Equipment - Two generators, two boats, lake dragging equipment, eight privately-owned boats available for use, 30 radio-equipped cars (citizen band), a ton truck used as first run vehicle, a field kitchen, two oxygen units, other heavy duty rescue equipment, "Jaws of Life", and miscellaneous rescue equipment

Personnel training - All persons are trained in standard First Aid and some have advanced Red Cross training and cardiopulmonary resuscitation. Eleven men are emergency medical technicians, and a professional scuba diver is available.

## Refuse Collection and Disposal

Residents of Crofton and Christian County may deposit refuse at collection points maintained throughout the county. Pickup service is provided at these points three days per week with disposal at the sanitary landfill. Refuse collection and disposal for business and industry must be arranged through a private contractor.

\* Crofton (outside protected area) has an insurance rating of 9 within five road miles of a fire station.

\*\* Christian County (including the cities of Hopkinsville, LaFayette, Oak Grove and Pembroke) is served by 12 volunteer fire departments and one full-time municipal fire department. The insurance class ranges from 5 to 10.



## EDUCATION

### Public Schools

#### Christian County

Total Enrollment (Spring 1984)	9,221
Elementary	5,002*
Junior High	1,621
High School	2,598
Student-Teacher Ratio	20-1
Elementary	20-1
Junior High	22-1
High School	20-1
Accreditation	Southern Association of Colleges and Schools
Percent High School Graduates to College (1983)	45.3
Expenditures Per Pupil (1982-83)	\$ 1,569.26
Bonded Indebtedness (June 30, 1983)	\$7,670,000

### Nonpublic Schools

There are four nonpublic schools located in Hopkinsville, 13 miles south of Crofton.

\* Includes kindergarten.

## Area Colleges and Universities

<u>Name</u>	<u>Location (Miles distant)</u>	<u>Enrollment (Fall, 1983)</u>	<u>Highest Degree Conferred</u>
Hopkinsville Community College	Hopkinsville, Kentucky (13)	1,284	Associate
Madisonville Community College	Madisonville, Kentucky (21)	1,409	Associate
Austin Peay State University	Clarksville, Tennessee (38)	5,493	Academic & Professional
Henderson Community College	Henderson, Kentucky (58)	1,092	Associate
Murray State University	Murray, Kentucky (59)	7,591	Masters, Specialist*
Western Kentucky University	Bowling Green, Kentucky (66)	12,666	Masters, Specialist**
Indiana State University, Evansville Campus	Evansville, Indiana (68)	3,806	Baccalaureate
University of Evansville	Evansville, Indiana (68)	4,499	Masters

\* Joint doctoral degree programs are offered in cooperation with the University of Kentucky, Lexington. The degrees are issued by the University of Kentucky.

\*\* Joint doctoral degree programs are offered in cooperation with the University of Kentucky, Lexington, and cooperative doctoral degree programs are offered with the University of Louisville. The degrees are issued by the University of Kentucky or the University of Louisville.

## Vocational Schools

Both the state vocational-technical schools and the area vocational education centers are operated by the Kentucky Department of Education. The state vocational-technical schools enroll persons full time who are at least 16 years of age and not in school. These students attend classes for six hours each day. The area vocational education centers are designed to accommodate high school students who are at least 15 years of age. These students attend vocational school for three hours each day. The state vocational-technical schools and the area education centers offer evening courses to enable working adults to upgrade current job skills.

### Nearest State School

Location	Madisonville State Vocational-Technical School
Miles Distant	Madisonville
Curriculum	21
	Health and Personal Services Occupations
	Bimedical Equipment Technician
	Licensed Practical Nursing
	Medical Laboratory Technician - C
	Medical Secretary/Medical Office Clerk
	Health Services
	Radiologic Technology
	Respiratory Therapy
	Surgical Techologist
	Industrial Education
	Auto Body Repair
	Auto Mechanics
	Carpentry
	Diesel Mechanics
	Drafting (with CAD/CAM)
	Electronics
	Industrial Electricity
	Machine Shop
	Mine Equipment Operator
	Mine Maintenance Technology
	Tool and Die
	Welding
	Learning Resource Center

(Cont'd)

Nearest Area Education Center

Location	Christian County Area Vocational Education Center
Miles Distant	Hopkinsville
Curriculum	13
	Agriculture
	Adult Farmer
	Young Adult Farmer
	Clerical
	Clerical Cluster
	Industrial Education
	Auto Body Repair
	Auto Mechanics
	Basic Home Repair
	Carpentry/Building Trades
	Electricity
	Heating and Air Conditioning
	Industrial Mechanics
	Machine Shop
	Masonry
	Welding

Arrangements can be made to provide training in the specific production skills required by an industrial plant. Instruction may be conducted either in the vocational school or in the industrial plant, depending upon the desired arrangement and the availability of special equipment.

## HEALTH

### Hospitals

<u>General Hospital</u>	<u>Location</u>	<u>Beds</u>
Jeannie Stuart Medical Center	Hopkinsville, Kentucky, 13 miles south	216
Regional Medical Center of Hopkins County	Madisonville, Kentucky, 21 miles north	401

#### Jeannie Stuart Medical Center

General hospital facilities - 9 operating rooms, 10 emergency rooms (with 24-hour physician coverage), critical care unit, OB section, pediatrics, X-ray, C.A.T. Scan, radioisotope, laboratory, pathology, physical therapy, respiratory therapy, recovery room, renal dialysis unit, cobalt treatment unit, blood bank, pharmacy, associate degree nursing program with Hopkinsville Community College, laboratory technological school, licensed practical nursing program with Madisonville Community College

Medical staff - 63 physicians, 124 registered nurses, 64 licensed practical nurses and 41 aides

#### Regional Medical Center of Hopkins County

General hospital facilities - Emergency department (includes cardiac room and two trauma rooms); 12 operating rooms; intensive care and coronary care units; physical and respiratory therapy; pharmacy; laboratory; radiology department (includes nuclear medicine and ultrasound); obstetrics; C.A.T. Scan; nursery; pediatric intensive care unit; gastrointestinal laboratory/endoscopy; electrocardiography; electroencephalography; electromyography; dietary department

Medical staff - 122 physicians, 214 registered nurses, 134 licensed practical nurses, and 95 aides

#### Ambulance Service

Name - Hopkinsville-Christian County Emergency Ambulance Service\*

Staff - 15 full-time medical technicians and approximately 24 volunteers

Service - 24-hour, county-wide

Equipment - Five fully equipped ambulances (two in Hopkinsville, one in Crofton, one in Oak Grove, plus one back-up ambulance)

\* Ambulance stations are located in Hopkinsville, Crofton and Oak Grove.

## **Public Health**

Facility - East Pennyrile District Health Department (Christian County Health Department)

Staff - 2 administrators, physician (part-time), 15 registered nurses, 3 licensed practical nurses, 3 health environmentalists, 3 community health workers, health educator, medical records administrator, and 13 clerks

## OTHER LOCAL FACILITIES

### Communications

Telephone - Services -	South Central Bell Telephone Company Standard
Telegraph - Services -	Western Union Toll-free number, 1-800-325-5100
Postal - Class - Mail received - Mail dispatched -	U.S. Post Office Third Once daily Once daily
Newspapers - Papers received from -	Hopkinsville and Louisville, Kentucky; Evansville Indiana
Radio - Stations received from -	Hopkinsville, Madisonville, Russellville, and Louisville, Kentucky; Nashville, Tennessee
Television - Cable service Reception from -	Madisonville, Paducah, and Bowling Green, Kentucky; Evansville, Indiana; Nashville, Tennessee; Atlanta, Georgia; Chicago, Illinois
Kentucky Educational Television -	Madisonville, Kentucky, Transmitter - Channel 35

### Library Services

Public library - Hopkinsville-Christian County Public Library

Size collection - Approximately 70,000 volumes

Circulation, 1982-83 - 121,000

Services - Student services (assistance with research projects), bookmobile, children's department, story hour, talking books, microfilm, records, community room, newspapers, magazines, films, filmstrips, slides, tape recordings, book reviews, film on children and reading (shown to Parent/Teacher Associations, etc.)

College library - Hopkinsville Community College Library (open to public)

Size collection - Approximately 40,000 volumes

Special collections - Kentucky Collection, Government Documents, Law Books

Services - 17 newspapers; 160 periodicals; 9,000 records, cassettes, filmstrips, video tapes, reel-to-reel tapes, audiovisual equipment, microfilm of census records, copying machine

### Religious Institutions

Number of churches - 9  
Denominations - Assembly of God  
Baptist  
Christian  
Church of God  
Methodist  
Pentecostal

Nearest Synagogues - Evansville, Indiana, 68 miles north  
Congregations - Adath Israel (Reform)

### Financial Institutions

<u>Banks</u>	<u>Assets</u>	<u>Deposits</u>	<u>Statement Date</u>
Pennyrile Citizens Bank and Trust Company	\$ 26,965,787.00	\$ 22,217,616.30	12/31/83

### Hotels and Motels

Total number - 1  
Total rooms - 10

### Clubs and Organizations

Crofton Community Black Action Club  
Crofton Community Women's Club  
4-H  
Homemakers  
Karate Club  
Lions Club  
North Christian Boosters Club  
North Christian Industrial Foundation  
Parents/Teachers Organization  
Sportsman Club  
Youth Organizations



## RECREATION

### Local

Crofton offers a variety of recreational opportunities. The North Christian Lions Community Park offers a shelter, playground area, and a baseball/softball field.

Several events held in Crofton each year include a 4th of July Homecoming, PTO Fall Festival and a Freedom Day.

Hopkinsville, located 13 miles south of Crofton, offers a variety of recreational facilities. Points of interest include the Pennyroyal Museum, the Pennyrile Players, the Hopkinsville Art Guild, and many other attractions.

The Western Kentucky State Fair is held at the Christian County Fairgrounds each summer. A horse show, horse races, tractor pulls, and performances by famous entertainers are featured. The fair is the largest in western Kentucky.

### Area (Within 60 miles)

**Jefferson Davis Monument State Shrine** is located 24 miles southeast of Crofton at Fairview. The shrine is at the site of the birthplace of Jefferson Davis, a former U.S. Senator, Secretary of War, and the only president of the Confederate States of America. The park contains a 351-foot obelisk with an elevator to the top for viewing, a museum, a gift shop, and a playground with picnic tables.

**Pennyrile Forest State Resort Park** near Dawson Springs is located 33 miles northwest of Crofton. The 24-room lodge and cottages nestled within the trees provide excellent accommodations. Other facilities and activities include a dining room, a gift shop, rental rowboats and pedal boats, a 9-hole golf course, hiking trails, horseback riding, picnicking, playgrounds, shuffleboard, swimming at the lodge pool and off a sand beach, and two tennis courts. Lake Beshear, only four miles from the lodge, sports good fishing.

**Lake Malone State Park**, located in southern Muhlenberg County, 39 miles east of Crofton, offers camping facilities, swimming, fishing, and boating on a 788-acre lake. Playground facilities and picnic shelters are located in a beautiful scenic cliff area. Located across from the entrance to the park is an inn featuring luxury rooms, a restaurant, a swimming lake, a beach, boating, fishing, tennis, and nature trails.

**Lake Barkley State Resort Park**, 40 miles southwest of Crofton near Cadiz, is located on an embayment of Lake Barkley. The magnificent lodge includes 120 rooms, four suites, nine cottages, a dining room, a coffee shop, a gift shop, two meeting rooms, and a recreation room. An activities center with a capacity for 400 and an 80-site campground are located near the lodge. A lodge pool, a beach and a bathhouse, an 18-hole golf course, tennis courts, a riding stable, a trapshooting range, a basketball court, hiking trails, playgrounds, and a picnic area comprise the recreational facilities. The marina near the lodge has everything for the "boat lover": covered and open slips, launching ramp, and rentals for fishing boats, skiing boats, and pleasure ride pontoons.

**The Land Between the Lakes**, located on a 170,000-acre wooded peninsula, is an outdoor recreational and conservational education center. Camping, swimming, fishing, boating, hiking, a buffalo herd on a 250-acre range, an Environmental Education Center for school study groups, an educational farm and a central station with films and displays are among the attractions. Kentucky Lake and Lake Barkley are among the top fishing and water sport recreation areas in the southeastern United States. The Land Between the Lakes area is approximately 50 miles southwest of Crofton.

Charm and serenity exemplify **Kenlake State Resort Park** which is located on Kentucky Lake, 59 miles southwest of Crofton. The park offers hotel and cottage accommodations and an efficient camping site. Other facilities include a 9-hole golf course, pool and lake swimming, horseback riding, hiking trails, fishing, boating, picnicking, planned recreation, and one of the finest tennis complexes in the area.

Just north of Henderson, 60 miles north of Crofton, is the **John James Audubon State Park**, a 692-acre park where the famed naturalist gathered material for his painting, "The Birds of America." Many paintings by Audubon and his sons, and 126 first-edition prints of his paintings are on display at the Audubon Memorial and Nature Museum which is the focal point of the park. Other park features include the Audubon woods, a bird sanctuary, and a 12-acre nature preserve lake. The park has cottages and camping sites. Recreational facilities include a 28-acre recreational lake, a beach and a bathhouse, rental rowboats and pedal boats, a dock, a 9-hole golf course, hiking trails, picnic shelters, and playgrounds. Organized recreation programs are offered during the summer.

**Kentucky Dam Village State Resort Park**, located 69 miles west of Crofton near Gilbertsville, is one of the largest and most popular vacation resorts in Kentucky. A modern lodge with 72 rooms, six different cottage types, and a 225-site campground make up the accommodations. There is also a dining room overlooking Kentucky Lake, a coffee shop, a snack bar, two gift shops, a meeting room, an activities center, and a recreation room. Recreational activities to choose from include boating and fishing at the largest docking facility in the Kentucky parks system, golf at the 18-hole Village Green Course, fishing, hiking, horseback riding, picnicking, swimming at the lodge pool or off the sand beach, and tennis.

## COMMUNITY IMPROVEMENTS

### Recent

Several businesses have recently located in Crofton. They include a ceramic shop, an arts and crafts shop, a pallet company, a television shop, a car wash and a pharmacy.

The construction of a \$55,000 maintenance building at the water plant was completed in the spring of 1984.

Kentucky Commerce Cabinet  
Department of Economic Development  
Capital Plaza Tower  
Frankfort, Kentucky 40601  
(502) 564-7140