

1974

Industrial Resources: Pulaski County - Somerset and Burnside

Kentucky Library Research Collections
Western Kentucky University, spcol@wku.edu

Follow this and additional works at: https://digitalcommons.wku.edu/pulaski_cty

 Part of the [Business Administration, Management, and Operations Commons](#), [Growth and Development Commons](#), and the [Infrastructure Commons](#)

Recommended Citation

Kentucky Library Research Collections, "Industrial Resources: Pulaski County - Somerset and Burnside" (1974). *Pulaski County*. Paper 29.
https://digitalcommons.wku.edu/pulaski_cty/29

This Report is brought to you for free and open access by TopSCHOLAR®. It has been accepted for inclusion in Pulaski County by an authorized administrator of TopSCHOLAR®. For more information, please contact topscholar@wku.edu.

CURRENT INDUSTRIAL RESOURCES, SOMERSET AND
BURNSIDE, KENTUCKY

This is a 1974 supplement to "Industrial Resources, Somerset and Burnside, Kentucky" which was published in 1973.

Population

	<u>1972</u> (Provisional)	<u>1970</u>	<u>1960</u>
Somerset	N. A.	10,436	7,112
Burnside	N. A.	586	575
Pulaski County	37,900	35,234	34,403
Labor Market Area (Includes Pulaski, Casey, Laurel, Lincoln, McCreary, Rockcastle, Russell and Wayne Counties.)	149,200	141,876	140,707

General Employment Characteristics

<u>Industry</u>	<u>Employment 1972</u>	
	<u>Pulaski County</u>	<u>Labor Market Area</u>
TOTAL	13,890	44,780
Agricultural	2,120	8,750
Nonagricultural	11,770	36,030
Manufacturing	2,960	8,683
Trades and Services	3,095	7,844
Government	2,120	6,570
Other	3,595	12,933

Manufacturing Employment

<u>Type Industry</u>	<u>Pulaski County</u>			<u>Labor Market Area</u>		
	March	March	%Change	March	March	%Change
	1973	1963		1973	1963	
TOTAL	3,623	1,314	175.7	9,460	3,810	148.3
Food & Kindred Products	230	176	30.7	939	520	80.6
Tobacco	1	2	- 50.0	1	2	- 50.0
Apparel, Textiles, Leather	577	557	3.6	3,399	1,861	82.6
Lumber, Furniture	1,466	325	351.1	2,534	1,005	152.1
Printing & Publishing, Paper	56	26	115.4	828	49	1589.8
Chemicals, Petroleum & Coal, Rubber	402	84	378.6	470	135	248.2
Stone, Clay & Glass	469	122	284.4	498	150	232.0
Machinery & Metal Products, Equipment	422	13	3146.2	770	70	1000.0
Other	0	9	--	21	18	16.7

There are presently 35 manufacturing firms in Somerset, Ferguson and Burnside. Major firms, employment, and year started operations:

<u>Firms</u>	<u>Employment</u>	<u>Year started operations</u>
<u>Somerset-Ferguson</u>		
Cumberland Wood and Chair Corp.	186	1958
General Electric Co.	126	1958
Palm Beach Co.	590	1945
Somerset Cruisers	68	1971
Southern Bell Dairy Co., Inc.	192	1951
Tecumseh Products Co.	500	1970
Crane Co.	275	1963
Lear Siegler, Inc.	650	1965
Mid-State Generator Co.	53	1962
<u>Burnside</u>		
Cumberland Charcoal Corp.	174	1963
Hamer Hardwood Mfrs., Inc.	76	1958

Source: Kentucky Department of Commerce, 1974 Kentucky Directory of Manufacturers.

Labor Supply

	<u>Pulaski County</u>			<u>Labor Market Area</u>		
	<u>Total</u>	<u>Male</u>	<u>Female</u>	<u>Total</u>	<u>Male</u>	<u>Female</u>
Current (1973)	3,850	1,520	2,330	18,820	8,730	10,090
Potential additions next five years	3,500	1,816	1,684	14,734	7,551	7,183

Personal Income

Pulaski County, 1971: Per Capita - \$2,464
1961: Per Capita - \$1,015

Local Government

Property Tax Rates

Property tax rates per \$100 of assessed valuation, 1973.

	<u>Somerset</u>	<u>Burnside</u>	<u>Pulaski County</u>
State	\$.015	\$.015	\$.015
County	.164	.164	.164
School	.704	.286	.286
City	.330	.260	
Total	\$1,213	\$.725	\$.465

SOMERSET INDUSTRIAL SITES

1974

SOMERSET INDUSTRIAL SITES

1974

For more information about the following sites, contact Mr. A. B. Kopenhoefer, Chairman, Industrial Committee, Somerset-Pulaski County Chamber of Commerce, P. O. Box 106, Somerset, Kentucky 42501 or the Kentucky Department of Commerce, Capital Plaza Office Tower, Frankfort, Kentucky 40601.

SITE #5: ACREAGE: 49 acres; Tract #1 - 31 acres, Tract #2 - 18 acres
LOCATION: In county, south of Somerset and Ferguson and north of Elihu
ZONING: None
HIGHWAY ACCESS: Kentucky 1247 forms the south boundary of Tract #1; an access road of approximately 1,200 feet needed to provide access to Tract #2
RAILROAD: Southern Railway along eastern boundary of Tract #1, and along the western boundary of Tract #2
WATER: Kentucky Water Service Company, Incorporated
SIZE LINE: 16-inch line approximately 1,500 feet northwest from Tract #1 and approximately 2,500 feet northwest from Tract #2
GAS: Somerset Municipal Gas
SIZE MAIN: 6-inch main approximately 1,500 feet from site
ELECTRICITY: Kentucky Utilities and South Kentucky RECC
SEWERAGE: Somerset Sewer Department
SIZE LINE: 8-inch line approximately 1,500 feet from site
OWNERSHIP: Southern Railway System

SITE #6: ACREAGE: 25 acres
LOCATION: In county, 6 miles southwest of Somerset via Kentucky 80
ZONING: None
HIGHWAY ACCESS: County road adjacent to site provides access to Kentucky 80
RAILROAD: Not rail served
WATER: Pulaski County Water District, Number 2
SIZE LINE: 6-inch line approximately 250 feet north of site
GAS: Natural gas not available
ELECTRICITY: South Kentucky RECC
SEWERAGE: Package plant necessary
OWNERSHIP: South Kentucky RECC

SITE #8: ACREAGE: 121 acres
LOCATION: In city, south of Somerset proper
ZONING: None
HIGHWAY ACCESS: County road access to Kentucky 1247
RAILROAD: Not rail served
WATER: Kentucky Water Service Company, Inc.
SIZE LINE: 6-inch line along northern boundary, 10-inch line approximately 800 feet west of site
GAS: Somerset Gas Service
SIZE MAIN: 6-inch main approximately 750 feet from western boundary
ELECTRICITY: South Kentucky RECC and Kentucky Utilities
SEWERAGE: Somerset Sewer Department
SIZE LINE: 8-inch line approximately 1,500 feet southwest of site
OWNERSHIP: Private

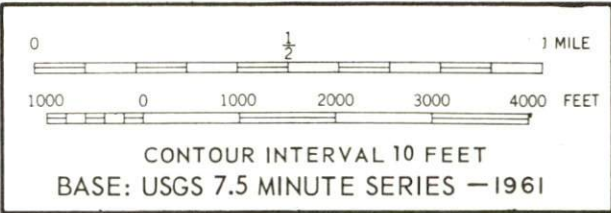
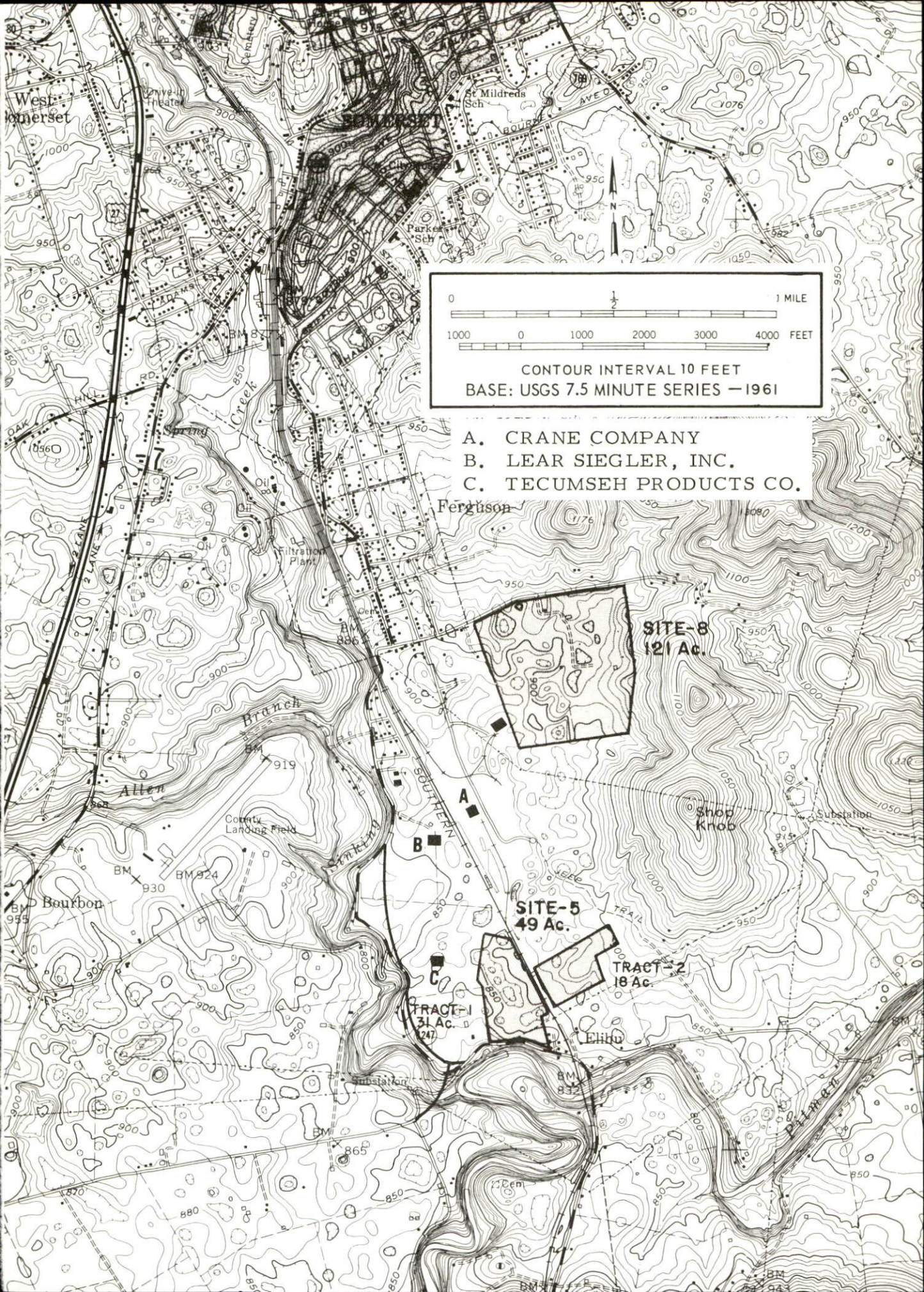

- A. CRANE COMPANY
- B. LEAR SIEGLER, INC.
- C. TECUMSEH PRODUCTS CO.

- SITE-8
121 Ac.
- SITE-5
49 Ac.
- TRACT-1
31 Ac.
- TRACT-2
18 Ac.

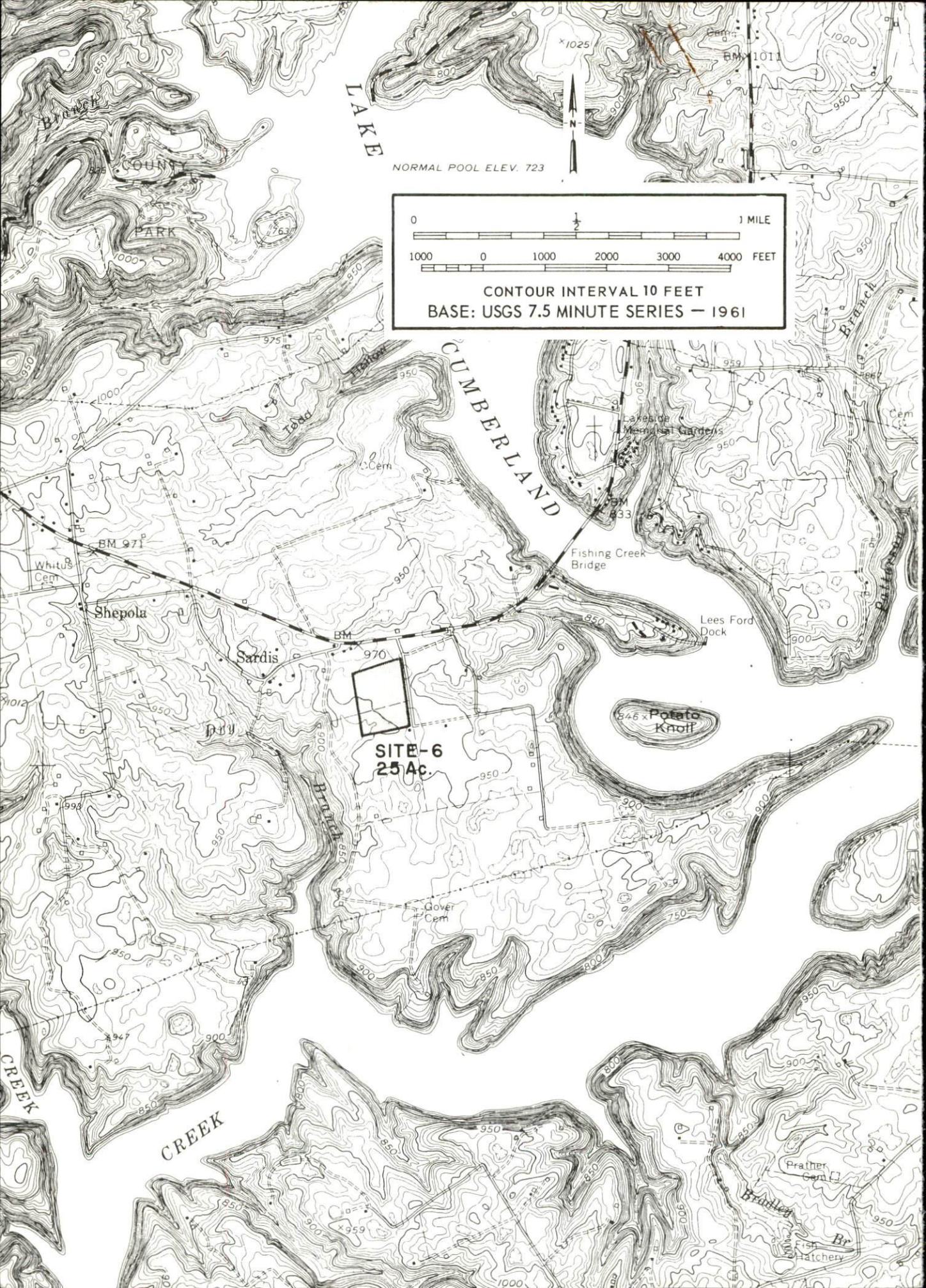

LAKE

NORMAL POOL ELEV. 723

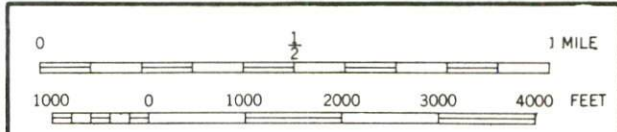

CONTOUR INTERVAL 10 FEET
BASE: USGS 7.5 MINUTE SERIES - 1961

CUMBERLAND

SITE-6
25Ac.

Shepola

Sardis

Potato Knoll

Fishing Creek Bridge

Lees Ford Dock

CREEK

Prather Cem

Bradley Br Hatchery

Gover Cem

BM 971

BM 970

BM 833

BM 1011

x 1025

7637

1000

975

950

950

950

970

850

900

900

950

950

900

900

950

950

900

900

850

850

800

750

950

950

900

850

850

950

950

850

850

900

950

900

850

900

950

1000

950

900

850

950

950