

1986

Industrial Resources: Christian County - Hopkinsville

Kentucky Library Research Collections
Western Kentucky University, spcol@wku.edu

Follow this and additional works at: https://digitalcommons.wku.edu/christian_cty

 Part of the [Business Administration, Management, and Operations Commons](#), [Growth and Development Commons](#), and the [Infrastructure Commons](#)

Recommended Citation

Kentucky Library Research Collections, "Industrial Resources: Christian County - Hopkinsville" (1986). *Christian County*. Paper 6. https://digitalcommons.wku.edu/christian_cty/6

This Report is brought to you for free and open access by TopSCHOLAR®. It has been accepted for inclusion in Christian County by an authorized administrator of TopSCHOLAR®. For more information, please contact topscholar@wku.edu.

IR
466

Christian County

RESOURCES FOR ECONOMIC DEVELOPMENT

Hopkinsville

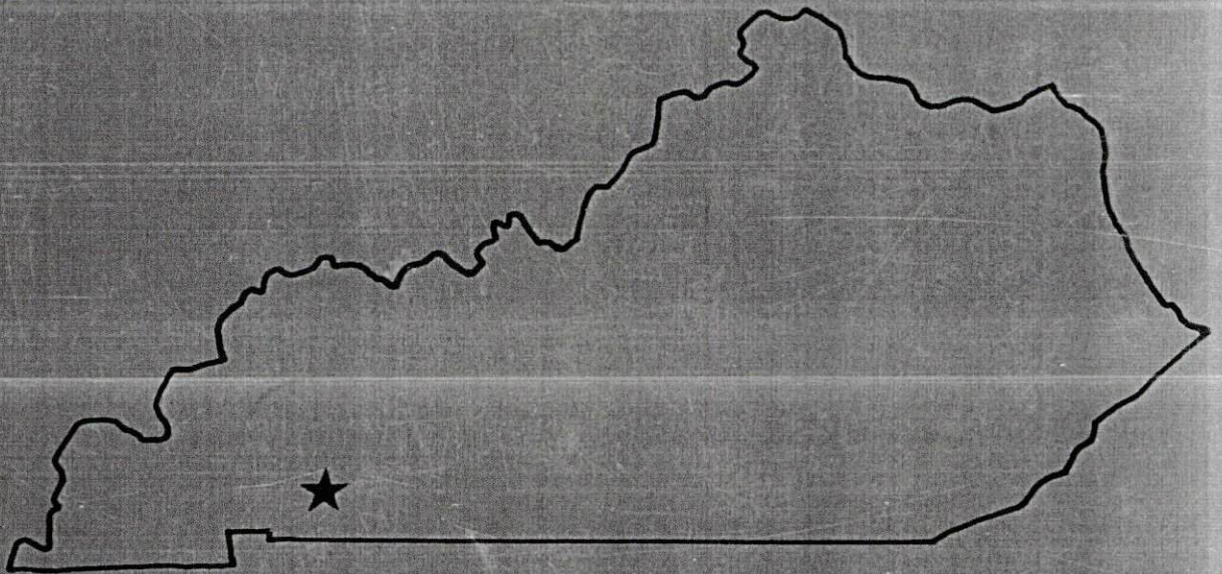

KENTUCKY
The business environment is right.

HOPKINSVILLE, KENTUCKY --- Index to Industrial Sites --- 1986

For more information contact the Department of Economic Development, Office of Business Development, Industrial Development Division, Capital Plaza Tower, Frankfort, Kentucky 40601 (502-564-7140).

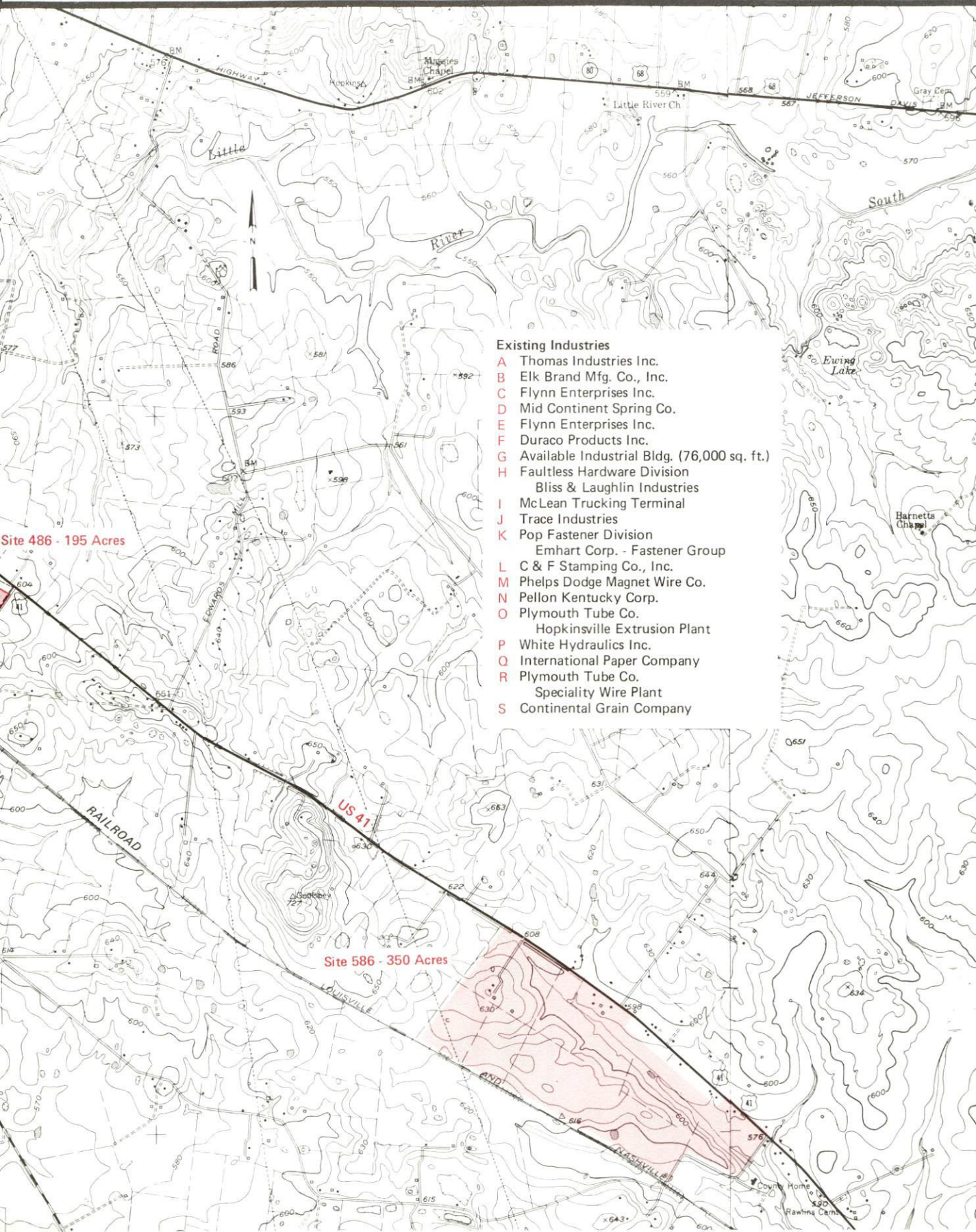

Existing Industries

- A Thomas Industries Inc.
- B Elk Brand Mfg. Co., Inc.
- C Flynn Enterprises Inc.
- D Mid Continent Spring Co.
- E Flynn Enterprises Inc.
- F Duraco Products Inc.
- G Available Industrial Bldg. (76,000 sq. ft.)
- H Faultless Hardware Division
Bliss & Laughlin Industries
- I McLean Trucking Terminal
- J Trace Industries
- K Pop Fastener Division
Emhart Corp. - Fastener Group
- L C & F Stamping Co., Inc.
- M Phelps Dodge Magnet Wire Co.
- N Pellon Kentucky Corp.
- O Plymouth Tube Co.
Hopkinsville Extrusion Plant
- P White Hydraulics Inc.
- Q International Paper Company
- R Plymouth Tube Co.
Speciality Wire Plant
- S Continental Grain Company

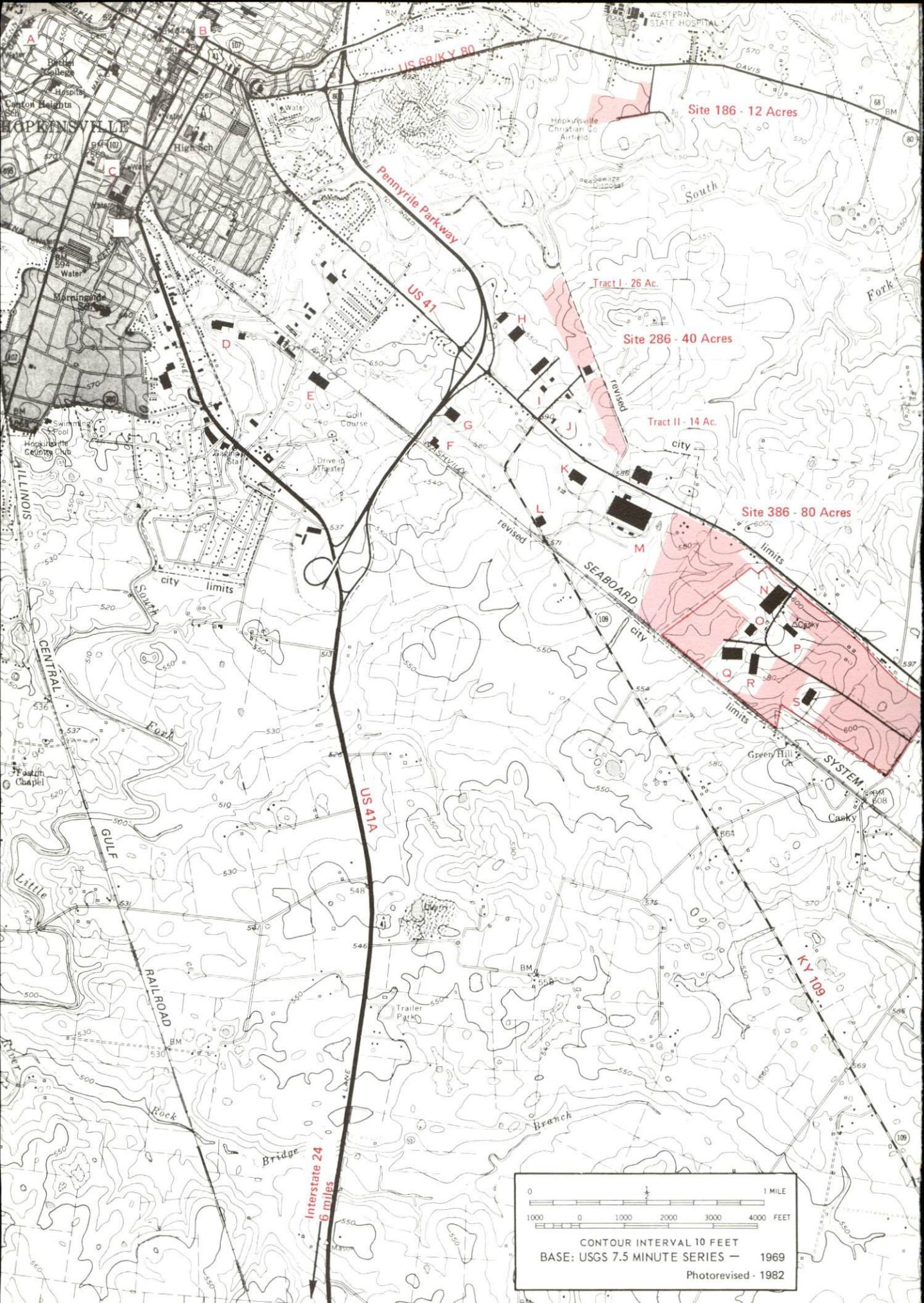

Site 186 - 12 Acres

Tract I - 26 Ac.

Site 286 - 40 Acres

Tract II - 14 Ac.

Site 386 - 80 Acres

Interstate 24
6 miles

0 1 MILE

1000 0 1000 2000 3000 4000 FEET

CONTOUR INTERVAL 10 FEET
 BASE: USGS 7.5 MINUTE SERIES — 1969
 Photorevised - 1982

RESOURCES FOR ECONOMIC DEVELOPMENT
HOPKINSVILLE, KENTUCKY

Prepared by
The Kentucky Department of Economic Development
Division of Research and Planning
in cooperation with
The Hopkinsville-Christian County
Chamber of Commerce

1986

Program manager - Andrew Dennis; research - Bill Morris; clerical - Bobbi Graves; graphics - Frank Ferrante, Tony Cecconi, Robert Owens; cartography - Site Evaluation Branch, Division of Industrial Development and Marketing. Cost of printing paid from state funds.

TABLE OF CONTENTS

| <u>Chapter</u> | <u>Page</u> |
|--|-------------|
| INDUSTRIAL SITES | i |
| HOPKINSVILLE, KENTUCKY - A RESOURCE PROFILE | 1 |
| THE LABOR MARKET AREA..... | 3 |
| Population | 3 |
| Labor Force Characteristics of Residents, 1984 | 3 |
| Selected Components of Nonagricultural Employment, by Place of Work, 1984 | 4 |
| Major Hopkinsville Manufacturing Firms, Their Products and Employment | 4 |
| Labor Organizations in Manufacturing Firms | 7 |
| Industrial Services | 8 |
| Estimated Male Labor Supply | 9 |
| Estimated Female Labor Supply | 9 |
| Average Weekly Wages By Industry, by Place of Work, 1984 | 10 |
| Per Capita Personal Income | 12 |
| TRANSPORTATION | 13 |
| Rail | 13 |
| Highways | 13 |
| Truck Service | 13 |
| Air | 16 |
| Bus | 16 |
| Taxi..... | 16 |
| Rental Services | 16 |
| Water | 17 |
| POWER AND FUEL | 18 |
| Electricity | 18 |
| Natural Gas | 19 |
| Other Fuels | 19 |
| WATER AND SEWERAGE | 20 |
| Public Water Supply | 20 |
| Raw Water | 21 |
| Sewerage | 21 |
| CLIMATE | 23 |

| <u>Chapter</u> | <u>Page</u> |
|---|-------------|
| LOCAL GOVERNMENT | 24 |
| City | 24 |
| County | 24 |
| Assessed Value of Property, 1985..... | 24 |
| State and Local Property Taxes | 25 |
| Utilities Gross Receipts Tax for Schools..... | 26 |
| Planning and Zoning | 26 |
| Safety | 26 |
| Police | 26 |
| Fire | 26 |
| Rescue Service | 27 |
| Refuse Collection and Disposal | 27 |
| EDUCATION | 28 |
| Public Schools | 28 |
| Nonpublic Schools | 28 |
| Area Colleges and Universities | 29 |
| Vocational Schools | 30 |
| HEALTH..... | 32 |
| Local Medical Personnel | 32 |
| Hospitals | 32 |
| Other Medical Facilities | 32 |
| Ambulance Service | 32 |
| OTHER LOCAL FACILITIES..... | 33 |
| Communications | 33 |
| Library Services | 34 |
| Religious Institutions | 34 |
| Financial Institutions | 35 |
| Hotels and Motels | 35 |
| Clubs and Organizations | 36 |
| RECREATION | 37 |
| COMMUNITY IMPROVEMENTS | 39 |

1985 EDITION
GENERAL HIGHWAY MAP
CHRISTIAN COUNTY
KENTUCKY

PREPARED BY THE
KENTUCKY TRANSPORTATION CABINET
DEPARTMENT OF HIGHWAYS
DIVISION OF PLANNING
IN COOPERATION WITH THE
U.S. DEPARTMENT OF TRANSPORTATION
FEDERAL HIGHWAY ADMINISTRATION

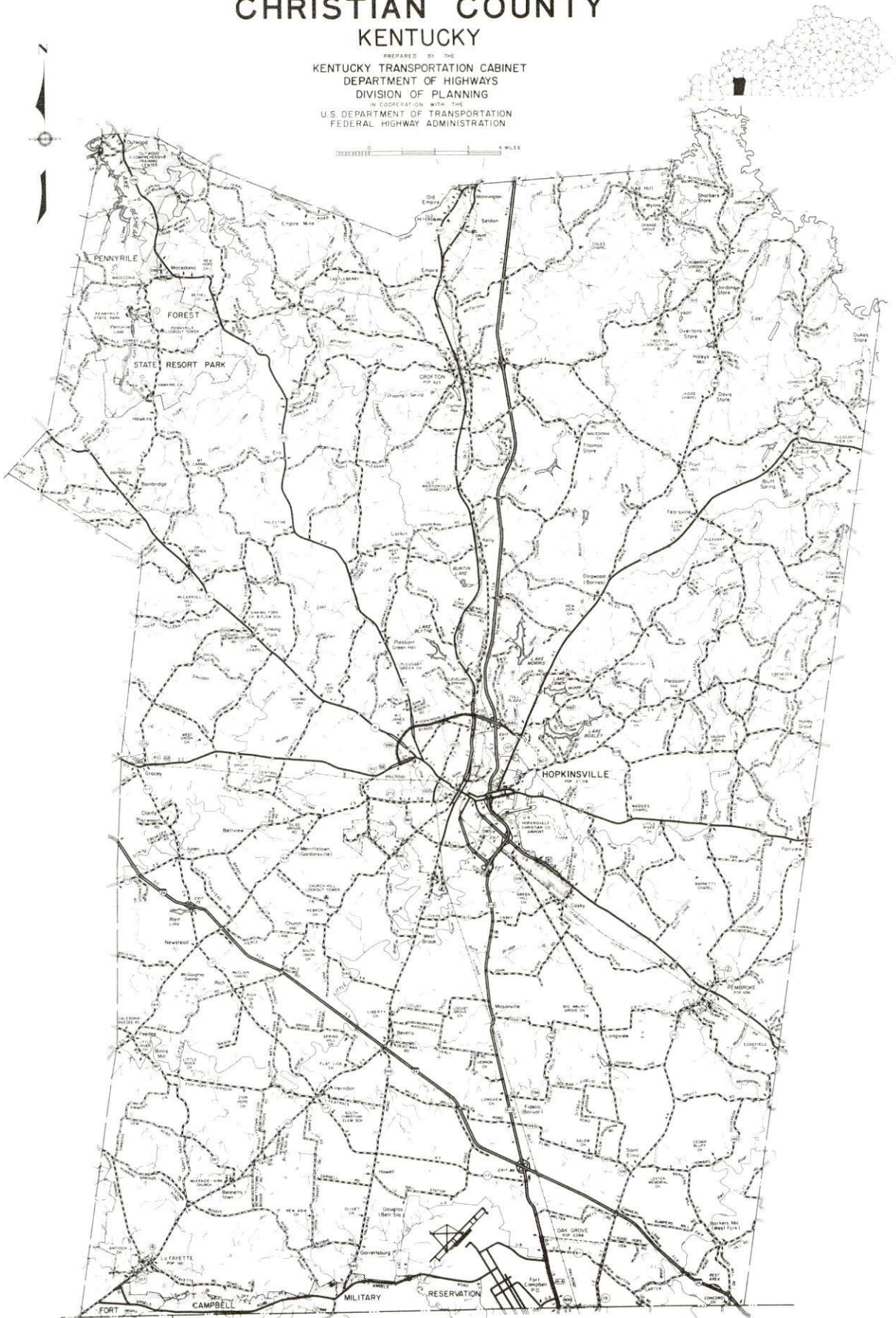

HOPKINSVILLE LABOR MARKET AREA With MAJOR HIGHWAYS & RAILROAD SYSTEM

Shaded area denotes Labor Market Area.

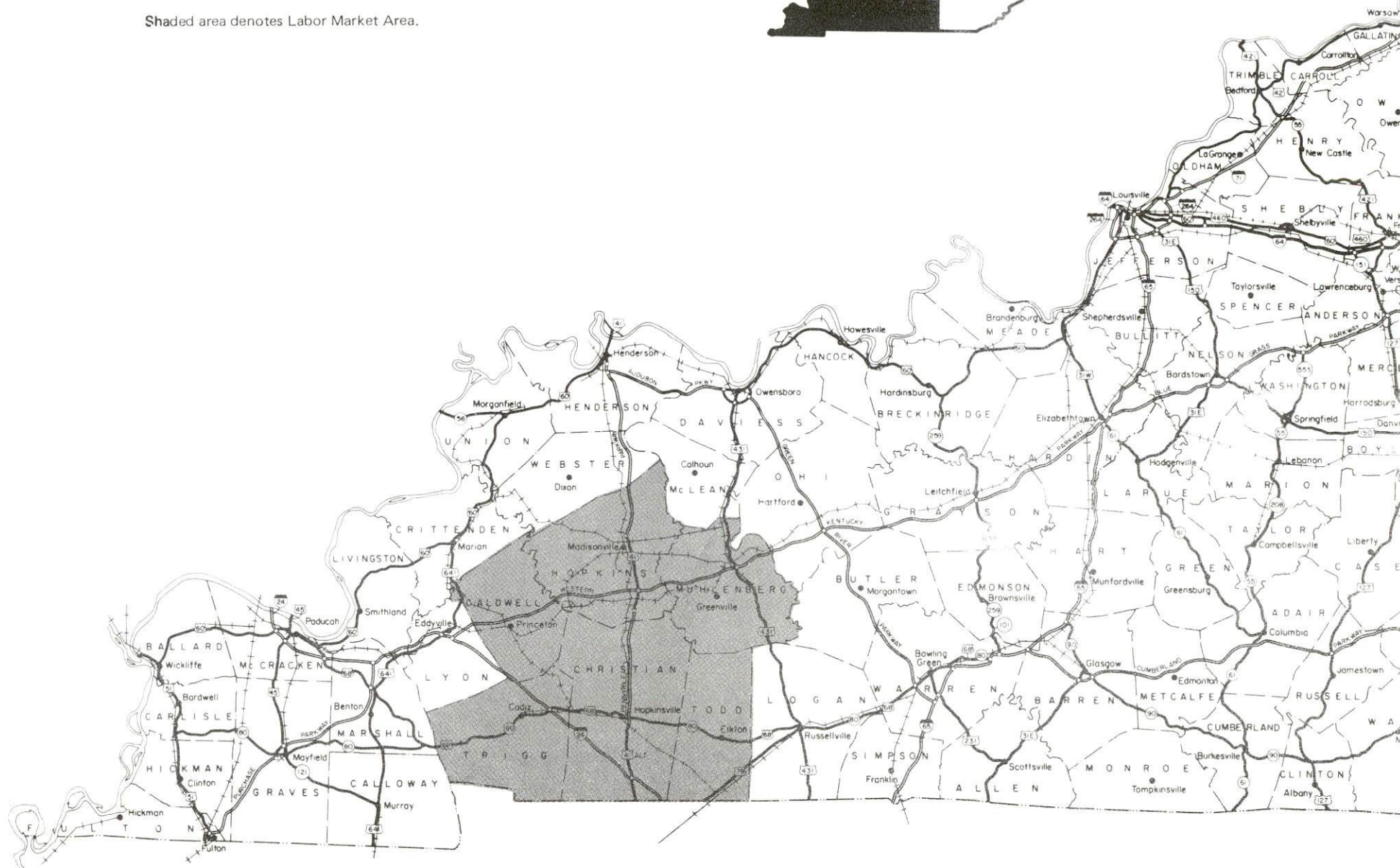
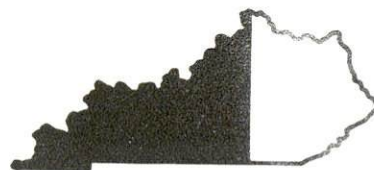

HOPKINSVILLE, KENTUCKY - A RESOURCE PROFILE

Hopkinsville, the county seat of Christian County, is situated in southwestern Kentucky, 73 miles northwest of Nashville, Tennessee; 170 miles southwest of Louisville, Kentucky; and 245 miles southeast of St. Louis, Missouri. Hopkinsville had a 1984 estimated population of 27,864 persons.

Christian County, covering a land area of 722 square miles, is Kentucky's second-largest county. The county is situated in the Mississippian Plateaus area of southwestern Kentucky, and the topography of the county ranges from nearly level or gently rolling limestone plain in the southern sections to a higher, more rugged plateau to the north. The county borders Tennessee on the south, and the Western Coal Field Region on the north. Christian County had a 1984 estimated population of 64,880 persons.

The Clarksville-Hopkinsville, Tennessee-Kentucky Metropolitan Statistical Area includes Montgomery County in Tennessee and Christian County in Kentucky. The MSA had a 1984 estimated population of 152,600.

The Economic Framework

The total number of Christian County residents employed in 1984 averaged 21,645, with nonagricultural jobs accounting for 20,330 workers. Manufacturing firms in the county reported 3,560 employees; wholesale and retail trade provided 4,415 jobs; 2,970 people were employed in service occupations; state and local government accounted for 2,400 employees; contract construction firms provided 585 jobs; and 90 people were employed by mining and quarrying operations.

Per capita personal income in Christian County in 1983 was \$8,810. Between 1979 and 1983, per capita income increased by 37 percent.

The Hopkinsville labor market area includes Christian County and the adjoining Kentucky counties of Caldwell, Hopkins, Muhlenberg, Todd, and Trigg, plus Montgomery and Stewart Counties in Tennessee. The total number of residents employed in the Kentucky portion of the labor market area in 1984 averaged 67,530, with nonagricultural jobs accounting for 63,760 workers. Manufacturing firms in the area reported 9,950 employees; wholesale and retail trade provided 10,780 jobs; 8,455 people were employed in service occupations; state and local government accounted for 6,570 employees; contract construction firms provided 1,490 jobs; and 3,790 people were employed by mining and quarrying operations.

Resources for Growth

1. Labor Supply - There is a current estimated labor supply of 11,340 men and 15,160 women available for industrial jobs in the labor market area. In addition, from 1986 through 1990, 10,715 young men and 9,715 young women in the area will become 18 years of age and potentially available for industrial jobs.

2. Transportation - The Seaboard System Railroad provides main line freight service to Hopkinsville. Hopkinsville is the southern terminus of the Pennyrile Parkway - a multilane toll road. Other "AAA"-rated (80,000-pound gross load limit) trucking highways serving Hopkinsville include U.S. Highways 41, 41A, and 68. Interstate Highway 24 passes through southern Christian County, and is accessible 13 miles south of Hopkinsville, and 16 miles west of Hopkinsville. Of the 27 common carrier trucking companies serving Hopkinsville, six maintain local terminals. The Hopkinsville-Christian County Airport has a paved 5,000-foot runway. The nearest scheduled commercial airline service is at Nashville Metropolitan Airport, 79 miles southeast of Hopkinsville, near Nashville Tennessee. The nearest navigable waterway is Lake Barkley. The Port Authority of Lyon County operates a public riverport facility near Eddyville, Kentucky, 43 miles northwest of Hopkinsville.

3. Power and Fuel - The Hopkinsville Electric Plant Board, supplied by Tennessee Valley Authority, provides electricity to Hopkinsville. Electric power is provided to Christian County by Pennyrile RECC, whose source of power is Tennessee Valley Authority, and by Kentucky Utilities Company, an electric power generation and transmission company. Natural gas service is provided by Western Kentucky Gas Company whose source of supply is Texas Gas Transmission Corporation. There are two distributors of propane and seven distributors of distillate fuel oil in Hopkinsville.

4. Education - The Christian County School System is accredited by the Southern Association of Colleges and Schools and serves 9,280 primary and secondary students. In addition, there are six nonpublic schools in Hopkinsville, and the Fort Campbell School System operates in southern Christian County.

Hopkinsville Community College, a part of the University of Kentucky Community College System, offers associate degrees, industrial training programs, job-related programs, and continuing education programs. The Fall 1985 headcount enrollment was 942.

Draughon's Junior College of Business, an accredited junior college of business, is also located at Hopkinsville. The school had a 1985 enrollment of 269.

There are three universities and two other community colleges within 72 miles of Hopkinsville. In addition, nine institutions of higher education are located in Nashville, Tennessee, 73 miles from Hopkinsville.

The Madisonville State Vocational-Technical School in Madisonville, 34 miles north, offers instruction in 20 courses. The Christian County Area Vocational Education Center in Hopkinsville offers training in 11 courses.

THE LABOR MARKET AREA

The Hopkinsville Labor Market Area includes Christian County and the adjoining Kentucky counties of Caldwell, Hopkins, Muhlenberg, Todd, and Trigg, plus Montgomery and Stewart Counties in Tennessee.

| POPULATION | | | | |
|--|---------|---------|---------|--------------------------|
| Area | 1984* | 1980 | 1970 | Percent Nonwhite 1980 |
| Hopkinsville | 27,864 | 27,318 | 21,395 | 25.7 |
| Clarksville-Hopkinsville, Tenn.-Ky. MSA** | 152,600 | 150,220 | 118,945 | N/A |
| Labor Market Area | 176,676 | 180,021 | 154,550 | N/A |
| Christian County | 64,880 | 66,878 | 56,224 | 28.9 |
| Caldwell County | 13,310 | 13,473 | 13,179 | 6.4 |
| Hopkins County | 46,384 | 46,174 | 38,167 | 7.2 |
| Muhlenberg County | 31,814 | 32,238 | 27,537 | 5.3 |
| Todd County | 10,898 | 11,874 | 10,823 | 12.4 |
| Trigg County | 9,390 | 9,384 | 8,620 | 12.7 |

* Population estimates.

** Clarksville-Hopkinsville, Tenn.-Ky. MSA includes Montgomery County in Tennessee, and Christian County in Kentucky.

Note: The 1980 city counts of population by race are provisional.

Sources: U.S. Department of Commerce, Bureau of the Census, 1980 Census of Population and Housing, March 1981; 1980 Census of Population, Number of Inhabitants. University of Louisville, Urban Studies Center, Population Unit, October 1985; Kentucky Population Research Notes, Issue Number One, May 1985.

LABOR FORCE CHARACTERISTICS OF RESIDENTS, 1984

| | Christian County | Labor Market Area* |
|--------------------------|------------------|--------------------|
| Civilian Labor Force | 23,431 | 75,046 |
| Employment | 21,645 | 67,532 |
| Agricultural | 1,317 | 3,776 |
| Nonagricultural | 20,328 | 63,756 |
| Unemployment | 1,786 | 7,514 |
| Rate of Unemployment (%) | 7.6 | 10.0 |

* Christian County and the five adjoining Kentucky counties.

Source: Kentucky Cabinet for Human Resources, Kentucky Labor Force Estimates, Annual Averages, 1984.

SELECTED COMPONENTS OF NONAGRICULTURAL EMPLOYMENT,
BY PLACE OF WORK, 1984

| | <u>Christian County</u> | <u>Labor Market Area*</u> |
|--------------------------|-------------------------|---------------------------|
| All Industries (total) | 15,402 | 45,085 |
| Manufacturing | 3,556 | 9,953 |
| Wholesale & Retail Trade | 4,415 | 10,783 |
| Services | 2,966 | 8,455 |
| State/Local Government | 2,398 | 6,573 |
| Contract Construction | 585 | 1,489 |
| Mining & Quarrying | 87 | 3,791 |

* Christian County and the five adjoining Kentucky counties.

Note: Excludes domestic workers, railway workers, certain nonprofit corporations, majority of federal government workers, and self-employed workers.

Sources: Kentucky Cabinet for Human Resources, Average Monthly Workers Covered by Kentucky Unemployment Insurance Law, 1984. Tennessee Department of Employment Security.

MAJOR HOPKINSVILLE MANUFACTURING FIRMS,
THEIR PRODUCTS AND EMPLOYMENT*

| <u>Firm (Establishment date)</u> | <u>Product</u> | <u>Employment</u> | | | <u>Labor Unions</u> |
|--|---|-------------------|-------------|---------------|----------------------------|
| | | <u>Total</u> | <u>Male</u> | <u>Female</u> | |
| C & F Stamping Company, Inc. (1982) | Plastic injection molding, BMC injection molding, automotive stampings | 675 | 450 | 225 | |
| Duraco Products, Inc. (1982) | Custom injection molding | 254 | 198 | 56 | Teamsters** |
| Ebonite International, Inc. (1967) | Bowling balls, bags, gloves | 209 | 155 | 54 | Leather Goods Workers** |

(Continued)

| <u>Firm (Establishment date)</u> | <u>Product</u> | <u>Employment</u> | | | <u>Labor Unions</u> |
|---|---|-------------------|-------------|---------------|---------------------|
| | | <u>Total</u> | <u>Male</u> | <u>Female</u> | |
| Elk Brand Manufacturing Company, Inc. (1930) | Men's and boys' jeans, slacks, walking shorts, and jackets | 240 | 40 | 200 | |
| Faultless Hardware Division (1970) | Decorative furniture, cabinet hardware, plastic products | 110 | 57 | 53 | |
| Flynn Enterprises, Inc. (1976) | Men's, boys' and girls' jeans | 780 | 197 | 583 | |
| Hopkinsville Milling Company (1874) | Wheat flour, corn meal | 67 | 60 | 7 | Retail, Wholesale** |
| Hopkinsville Stone Company (1930) | Crushed and agricultural limestone, bituminous concrete, ready-mixed concrete | 55 | 45 | 10 | |
| International Paper Company, Folding Carton and Label Division (1982) | Folding cartons | 112 | 85 | 27 | |
| Kentucky New Era, Inc. (1869) | Newspaper | 80 | 47 | 33 | |
| Mid Continent Spring Company (1957) | Compression torsion springs, precision springs | 140 | 60 | 80 | |
| R. C. Owen Company (1936) | Hardwood flooring and lumber, pallets | 66 | 64 | 2 | |

(Continued)

| Firm (Establishment date) | Product | Employment | | | Labor Unions |
|---|---|------------|------|--------|---------------------------------------|
| | | Total | Male | Female | |
| Pellon Kentucky Corporation (1973) | Nonwoven textiles | 89 | 73 | 16 | |
| Phelps Dodge Magnet Wire Company, Hopkinsville Plant (1965) | Copper magnet wire | 438 | 378 | 60 | Auto Workers** |
| Pop Fastener Division, Emhart Corporation - Fastener Group (1965) | Fasteners | 95 | 81 | 14 | Machinists** |
| Smith & Proffit Machine and Engineering Company, Inc. (1963) | Special machinery, machine shop, jigs, fixtures, tools and dies | 58 | 53 | 5 | |
| Southwestern Tobacco Company, Inc. (1918) | Tobacco redrying | 125 | 80 | 45 | |
| Thomas Industries, Inc., Residential Lighting Division (1955) | Lighting fixtures | 404 | 220 | 184 | Electrical Workers, IBEW; Teamsters** |
| Trace Industries (1980) | Wooden stools, tables and chairs | 56 | 32 | 24 | |
| U.S. Tobacco Company (1978) | Tobacco processing, snuff flour | 50 | 45 | 5 | |
| White Hydraulics, Inc. (1983) | Hydraulic motors | 55 | 48 | 7 | |

* Manufacturing firms with 50 or more employees.

** See Labor Organizations on next page.

Sources: Kentucky Department of Economic Development, 1985 Kentucky Directory of Manufacturers; Division of Research and Planning; Hopkinsville-Christian County Chamber of Commerce.

LABOR ORGANIZATIONS IN MANUFACTURING FIRMS

Union

International Association of
Machinists and Aerospace
Workers, AFL-CIO

International Brotherhood of
Electrical Workers, AFL-CIO

International Brotherhood of
Teamsters, Chauffeurs,
Warehousemen and Helpers
of America

International Leather Goods,
Plastic and Novelty Workers
International Union, United
Automobile, Aerospace and
Agricultural Implement
Workers of America

Retail, Wholesale and
Department Store Union,
AFL-CIO

Representing workers at:

Pop Fastener Division, Emhart
Corporation - Fastener Group

Thomas Industries, Inc., Residential
Lighting Division

Duraco Products, Inc.; Thomas Industries,
Inc., Residential Lighting Division

Ebonite International, Inc.

Phelps Dodge Magnet Wire Company,
Hopkinsille Plant

Hopkinsville Milling Company

INDUSTRIAL SERVICES

| <u>Types of Services</u> | <u>Location</u> | <u>Mileage from Hopkinsville</u> |
|---------------------------------|--------------------------|--------------------------------------|
| Custom Plastics Producers | Hopkinsville, Kentucky | - |
| Electric Motor Repair | Hopkinsville, Kentucky | - |
| Grinding, Precision & Tool | Hopkinsville, Kentucky | - |
| Heat Treating Facilities | Nashville, Tennessee | 73 |
| | Evansville, Indiana | 81 |
| Industrial Equipment & Supplies | Hopkinsville, Kentucky | - |
| Industrial Gases | Hopkinsville, Kentucky | - |
| Industrial Waste Removal | Russellville, Kentucky | 36 |
| | Dawson Springs, Kentucky | 41 |
| Machine Shops, Tool & Die | Hopkinsville, Kentucky | - |
| Metal Finishers | Hartford, Kentucky | 69 |
| | Nashville, Tennessee | 73 |
| Metal Service Centers | Hopkinsville, Kentucky | - |
| Millwrights | Hopkinsville, Kentucky | - |
| Public Warehouse Facilities | Hopkinsville, Kentucky | - |

Sources: Kentucky Department of Economic Development, Kentucky Directory of Selected Industrial Services, 1985; Division of Research and Planning.

ESTIMATED MALE LABOR SUPPLY
HOPKINSVILLE LABOR MARKET AREA

| Area | Current | | | | Future |
|--------------------|------------|------------|----------------|--------------------|---|
| | Total Male | Unemployed | Under-employed | Not in Labor Force | Becoming 18 years of age 1986 thru 1990 |
| Labor Market Area* | 11,343 | | | | 10,715 |
| Christian | 2,363 | 826 | 1,537 | 0 | 2,631 |
| Caldwell | 1,316 | 528 | 293 | 495 | 544 |
| Hopkins | 2,214 | 1,165 | 935 | 114 | 1,934 |
| Muhlenberg | 2,098 | 1,348 | 750 | 0 | 1,338 |
| Todd | 1,094 | 184 | 257 | 653 | 490 |
| Trigg | 504 | 339 | 165 | 0 | 378 |
| Montgomery (Tenn.) | 1,446 | N/A | N/A | N/A | 3,065 |
| Stewart (Tenn.) | 308 | N/A | N/A | N/A | 335 |

ESTIMATED FEMALE LABOR SUPPLY
HOPKINSVILLE LABOR MARKET AREA

| Area | Current | | | | Future |
|--------------------|--------------|------------|----------------|--------------------|---|
| | Total Female | Unemployed | Under-employed | Not in Labor Force | Becoming 18 years of age 1986 thru 1990 |
| Labor Market Area* | 15,159 | | | | 9,715 |
| Christian | 3,427 | 960 | 1,636 | 831 | 2,051 |
| Caldwell | 1,267 | 364 | 356 | 547 | 468 |
| Hopkins | 3,552 | 735 | 1,202 | 1,615 | 1,773 |
| Muhlenberg | 3,124 | 638 | 742 | 1,744 | 1,253 |
| Todd | 963 | 198 | 207 | 558 | 481 |
| Trigg | 465 | 229 | 236 | 0 | 352 |
| Montgomery (Tenn.) | 2,145 | N/A | N/A | N/A | 3,033 |
| Stewart (Tenn.) | 216 | N/A | N/A | N/A | 304 |

* Additional workers may be drawn from other nearby counties.

Note: Unemployed - persons unemployed and actively seeking work;
Underemployed - persons employed but working only 14 to 26 weeks per year;
Not in Labor Force - represents the number of persons who would enter the labor force if suitable employment were available (based on the assumption that persons in Kentucky would like to participate in the labor force in the same proportion that they do nationally).

Sources: Kentucky Cabinet for Human Resources, Kentucky Labor Supply Estimates by County, 1984. Tennessee Department of Economic and Community Development, Industrial Research, 1984. Kentucky Department of Economic Development, Future Labor Supply Becoming 18 Years of Age, 1986 thru 1990.

AVERAGE WEEKLY WAGES BY INDUSTRY,
BY PLACE OF WORK, 1984

| | <u>Christian County</u> | <u>Caldwell County</u> | <u>Hopkins County</u> |
|---|------------------------------|----------------------------|---------------------------|
| All Industries | \$ 259.08 | \$ 252.24 | \$ 339.64 |
| Mining & Quarrying | 340.66 | 388.89 | 681.27 |
| Contract Construction | 290.38 | 174.62 | 300.59 |
| Manufacturing | 332.52 | 320.45 | 398.03 |
| Transportation, Communications & Public Utilities | 319.34 | 374.72 | 388.90 |
| Wholesale & Retail Trade | 199.75 | 180.59 | 226.01 |
| Finance, Insurance & Real Estate | 279.58 | 261.06 | 262.82 |
| Services | 205.14 | 208.42 | 241.67 |
| State/Local Government | 297.30 | 264.47 | 310.80 |
| Other | 186.58 | 138.57 | 185.11 |
| | <u>Muhlenberg County</u> | <u>Todd County</u> | <u>Trigg County</u> |
| All Industries | \$ 375.44 | \$ 228.34 | \$ 251.21 |
| Mining & Quarrying | 728.94 | * | * |
| Contract Construction | 294.80 | 279.01 | 259.10 |
| Manufacturing | 238.83 | 243.58 | 312.04 |
| Transportation, Communications & Public Utilities | 450.04 | 327.08 | 310.67 |
| Wholesale & Retail Trade | 220.46 | 175.49 | 153.31 |
| Finance, Insurance & Real Estate | 266.25 | 231.16 | 257.25 |
| Services | 218.60 | 158.14 | 160.51 |
| State/Local Government | 275.90 | 234.98 | 243.93 |
| Other | 275.55 | 135.30 | 169.28 |

* Not disclosed.

Note: Excludes domestic workers, railway workers, certain nonprofit corporations, majority of federal government workers, and self-employed workers.

Sources: Kentucky Cabinet for Human Resources, Average Weekly Wages of Workers Covered by Kentucky Unemployment Insurance Law, 1984.

Occupational wage rates for specific industries are usually not available to most government agencies, and wage data furnished to state employment agencies by individual industrial employers are protected from disclosure by federal law. The most reliable up-to-date wage information can be obtained by direct contact with local employers.

Associated Industries of Kentucky, a voluntary organization of Kentucky businesses, regularly collects occupational wage rates and fringe benefits data from participating member firms. Data are compiled for over 127 clearly defined office, production, and service occupations. Tabulations are published for nine geographical areas of Kentucky, as shown on the map below. It should be noted that the data may be weighted by the preponderance of firms in the larger cities and may be somewhat higher than the rates paid in the smaller communities. Data from these tabulations are available, upon request, from the Kentucky Department of Economic Development, Frankfort, Kentucky 40601.

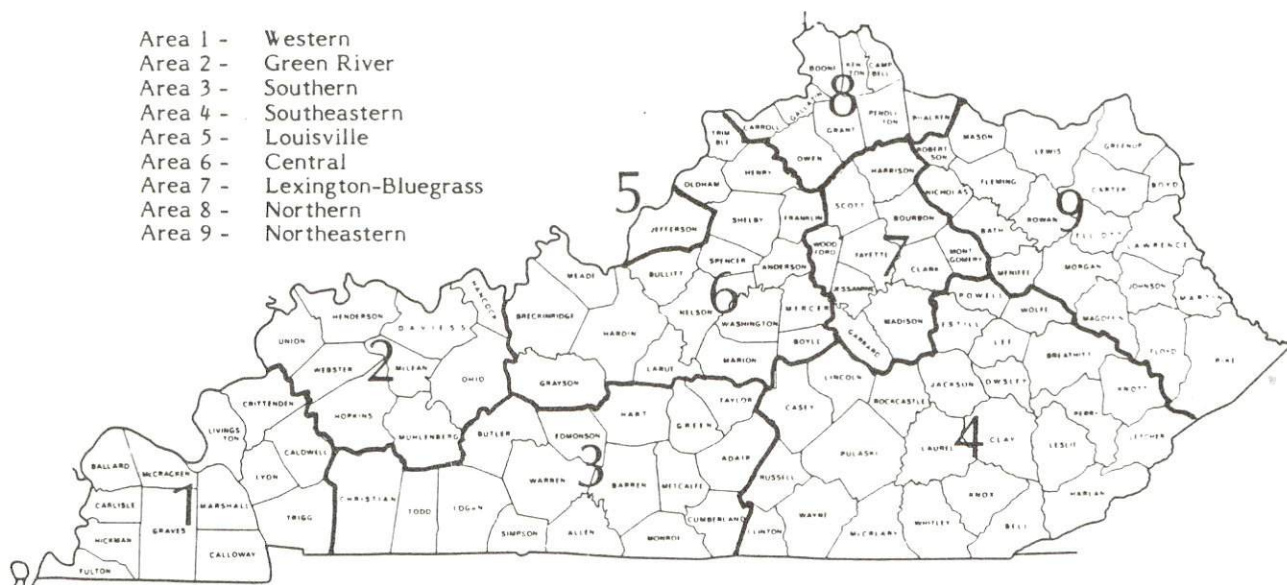

Associated Industries of Kentucky Area Wage Surveys

Up to date occupational wage rates of the existing industries are maintained by South Kentucky Industrial Development Association, Post Office Box 726, Hopkinsville, Kentucky 42240.

PER CAPITA PERSONAL INCOME

| <u>Area</u> | <u>1979</u> | <u>1983</u> | <u>Percent Change</u> |
|--------------------------|-----------------|------------------|-----------------------|
| Christian County | \$ 6,450 | \$ 8,810 | 36.6 |
| Labor Market Area Range* | \$5,786 - 8,798 | \$6,184 - 10,855 | N/A |
| Kentucky | 7,124 | 9,396 | 31.9 |
| U. S. | 8,651 | 11,687 | 35.1 |

* Christian County and the five adjoining Kentucky counties.

Sources: U.S. Department of Commerce, Bureau of Economic Analysis; Commerce News, August 28, 1984; May 7, 1985. Kentucky Economic Information System, June 1985.

TRANSPORTATION

Rail

Line serving **Hopkinsville** - Seaboard System Railroad

Services - Main line; one local freight from north of Madisonville to Guthrie and return makes daily stops at Hopkinsville; four northbound and three southbound through freights daily; switching handled by the daily local freight; team track space for two cars; nearest Seaboard piggyback facilities at Nashville, Tennessee, 73 miles southeast, or at Evansville, Indiana, 81 miles north

For details on routing, schedules, rates, and services, contact:

Manager of Industrial Development
Seaboard System Railroad
P. O. Box 2157
Louisville, Kentucky 40201
(502) 587-5228

Highways

Interstate 24, a major east-west route, serves Christian County. Interstate 24 is accessible 13 miles south of Hopkinsville via U. S. 41A or 16 miles west of Hopkinsville via U. S. 68. Other major highways serving Hopkinsville are U. S. Highways 41, 41A and 68, all "AAA"-rated (80,000-pound gross load limit) trucking highways. Hopkinsville is the southern terminus of the Pennyriple Parkway, a multi-lane toll road. The Pennyriple Parkway serves Hopkinsville with four interchanges and extends north to connect with the Western Kentucky Parkway, 25 miles from Hopkinsville.

Truck Service

| <u>Company</u> | <u>Home Office</u> |
|-------------------------------------|---|
| AAA Cooper Transportation* | P. O. Box 6827 Dothan, Alabama 36302 |
| A&H Truck Line, Inc.** | Evansville, Indiana 47711 |
| ANR Freight System, Inc.** | P. O. Box 5070 Denver, Colorado 80217 |
| ARA/Smith's**(T) | P. O. Box 1000 Staunton, Virginia 24401 |
| Advance Transportation Company** | 5005 South 6th Street P. O. Box 2011 Milwaukee, Wisconsin 53201 |
| American Freight System, Inc.***(T) | 9393 West 110th Street Overland Park, Kansas 66210 |
| Averitt Express, Inc.** | 115 Dacco Drive P. O. Box 3166 Cookeville, Tennessee 38502-3166 |

(Continued)

CompanyHome Office

| | |
|---|---|
| Bailey's Express, Inc.** | Middletown, Connecticut 06457 |
| Bestway Express, Inc.** | Nashville, Tennessee 37210 |
| Birmingham-Nashville Express, Inc.* | 715 Poplar Avenue P. O. Box 100417 Nashville, Tennessee 37210 |
| Buske Lines, Inc.* | P. O. Box 349 123 West Tyler Street Litchfield, Illinois 62056 |
| C & H Transportation Company, Inc.* | Dallas, Texas 75227 |
| CW Transport, Inc.** | 610 High Street Wisconsin Rapids, Wisconsin 54494 |
| Carolina Freight Carriers Corporation** | P. O. Box 697 Cherryville, North Carolina 28021 |
| Frame Motor Freight, Inc.** | West Chester, Pennsylvania 19386 |
| Marvin Hayes Lines, Inc.* | P. O. Box 468 Clarksville, Tennessee 37040 |
| Jones Truck Lines, Inc.** (T) | 610 East Emma Avenue Springdale, Arkansas 72764 |
| Kentucky Western Truck Lines, Inc.** (T) | P. O. Box 623 Hopkinsville, Kentucky 42240 |
| Majors Transit, Inc.** | P. O. Box 9 Caneyville, Kentucky 42721 |
| The Maryland Transportation Company* | 1111 Frankfurst Avenue Baltimore, Maryland 21225 |
| McLean Trucking Company* (T) | P. O. Box 213 Winston-Salem, North Carolina 27154 |
| Nashville Clarksville Express** | Terminal Road and Highway 79 North P. O. Box 607 St. Bethlehem, Tennessee 37155 |
| Overnite Transportation Company** | 1000 Semmes Avenue P.O. Box 1216 Richmond, Virginia 23209 |
| Renner's Express, Inc.** (T) | 1350 South West Street P. O. Box 882 Indianapolis, Indiana 46206 |
| Roadway Express, Inc.** | 1077 Gorge Boulevard Akron, Ohio 44310 |
| TSC Express** | 2704 Bouldercrest Road P. O. Box 1695 Atlanta, Georgia 30301 |
| Thurston Motor Lines, Inc.* (T) | 600 Johnston Road Charlotte, North Carolina 28206 |

(Continued)

CompanyHome Office

Yellow Freight System, Inc.**

10990 Roe Avenue
P. O. Box 7270
Overland Park, Kansas 66207

* Interstate service only.

** Interstate and intrastate service.

(T) Local terminal.

Sources: American Motor Carrier Directory, Fall 1985; Kentucky Department of Economic Development, Division of Research and Planning.Other Freight ServicesNearest Office or Shipping Center

United Parcel Service

Hopkinsville, Kentucky

Airborne Express

Clarksville, Tennessee, 27 miles south

Emery

Nashville, Tennessee, 73 miles southeast

Federal Express

Nashville, Tennessee, 73 miles southeast

KATO Express, Inc.

Elizabethtown, Kentucky, 126 miles
northeast

Purolator Courier

Nashville, Tennessee, 73 miles southeast

HIGHWAY MILES AND TRUCK TRANSIT TIME IN DAYS FROM
HOPKINSVILLE, KENTUCKY, TO SELECTED MARKET CENTERS

| City | Highway Miles | Delivery | City | Highway Miles | Delivery |
|------------------|------------------|------------|------------------|------------------|------------|
| | | Time TL | | | Time TL |
| Atlanta, Ga. | 315 | 1 | Los Angeles, Ca. | 2,090 | 3-4 |
| Baltimore, Md. | 749 | 2 | Louisville, Ky. | 170 | 1 |
| Birmingham, Ala. | 269 | 1 | Nashville, Ky. | 73 | 1 |
| Chicago, Ill. | 373 | 1 | New Orleans, La. | 590 | 2 |
| Cincinnati, Ohio | 271 | 1 | New York, N.Y. | 911 | 3 |
| Cleveland, Ohio | 515 | 2 | Pittsburgh, Pa. | 551 | 2 |
| Detroit, Mich. | 530 | 2 | St. Louis, Mo. | 245 | 1 |
| Knoxville, Tenn. | 250 | 1 | | | |

Note: Mileage computations are via the best interstate or primary highways, not necessarily the most direct route of travel.

Sources: Rand McNally Road Atlas, 1979. Official Kentucky Mileage Map, 1980.
Delivery time - Majors Transit, Inc., P. O. Box 9, Caneyville, Kentucky 42721.

Air

Local

Hopkinsville-Christian County Airport
Location: 1 mile east of Hopkinsville
Runways: 1 paved
Length: 5,000 feet
Traffic
Control: Wind socks on northwest and northeast corners, unicom
Lighting: Sundown to sunrise
Services: 100 LL octane and jet fuel; major and minor A & P repairs; tie-down, taxi and 20 T-hangars; charter; heated storage hangar; flight training; car rental
Navigation: SDF, localizer, radar
Air Freight Service: Chartered air freight services must be arranged.

Nearest Scheduled Commercial Airline Service*

Nashville Metropolitan Airport
Location: 6 miles southeast of Nashville, Tennessee;
79 miles southeast of Hopkinsville
Runways: 3 paved
Length: 8,000 feet; 7,700 feet; 4,320 feet
Traffic
Control: Tower
Lighting: Beacon, runway
Services: American, Delta, Eastern, Ozark, Pan Am, Piedmont, Republic, TWA, United, USAir, Allegheny Commuter, Comair, Florida Express, Air Midwest, Peoples Express, Prime Air, Sunbird, Tennessee Airways; fuel - 100LL, jet-A; tie-downs, hangars; major A & P repairs, major Avionics repairs; APU, charter, flight instruction, oxygen, plane rental, survival equipment, U. S. Customs; taxi, limousine, car rental, courtesy car, public transit; weather information; restaurant, snack bar
Air Freight Service: Air freight terminal

Bus - Greyhound Bus Lines

Taxi - Four companies, 24-hour service, radio-dispatched

Rental Services - Car, truck and trailer rentals are available locally.

* Commuter air carrier service is provided by Prime Air at Outlaw Field which is located 7 miles northwest of Clarksville, Tennessee; 20 miles south of Hopkinsville.

Water

The nearest navigable waterway is Lake Barkley. The Port Authority of Lyon County operates a public riverport on Lake Barkley near Eddyville, Kentucky, 43 miles northwest of Hopkinsville. Lake Barkley connects with the Ohio River via the Cumberland River. The Tennessee-Tombigbee Waterway Corridor includes Christian County, Kentucky.

POWER AND FUEL

Electricity

Company serving **the majority of Hopkinsville and a small portion of Christian County** - Electric Plant Board of the City of Hopkinsville, Kentucky
Source of power - Tennessee Valley Authority
Total generating capacity - 30,900,470 KW
For industrial rates contact:

Hopkinsville Electric Plant Board
101 North Main Street
P. O. Box 544
Hopkinsville, Kentucky 42240
(502) 887-4210

Company serving **the majority of Christian County and a small portion of Hopkinsville** - Pennyrile Rural Electric Cooperative Corporation
Source of power - Tennessee Valley Authority
Total generating capacity - 30,900,470 KW
For industrial rates contact:

Pennyrile RECC
2000 Harrison Street
P. O. Box 551
Hopkinsville, Kentucky 42240
(502) 886-2555

Company serving **a portion of northern Christian County** - Kentucky Utilities Company
Source of power - Kentucky Utilities Company
Total generating capacity - 3,164,000 KW*
For industrial rates contact:

Industrial Development Department
Kentucky Utilities Company
One Quality Street
Lexington, Kentucky 40507
(606) 255-1461

Natural Gas

Company serving **Hopkinsville** - Western Kentucky Gas Company
Source of supply - Texas Gas Transmission Corporation
Size of transmission mains - 10-inch (supplier); 8 and 6-inch (distributor)
Distribution mains - 2 to 8 inches
Distribution pressure - 25 to 30 psi
Btu content - 1,000 per cubic foot
Specific gravity - .60
For rates and supplies contact:

Western Kentucky Gas Company
311 West 7th Street
Owensboro, Kentucky 42301
(502) 685-8067

Other Fuels

Propane

Pargas of Hopkinsville
2232 Fort Campbell Boulevard
Hopkinsville, Kentucky 42240

Southern States Hopkinsville
Petroleum Cooperative
520 Wooldridge Road
Hopkinsville, Kentucky 42240

Fuel oils

Distillate fuel oil -

Ashland Petroleum Company
West 15th Street
Hopkinsville, Kentucky 42240

J. B. Hyde Distributing Company
700 West 15th Street
Hopkinsville, Kentucky 42240

Chevron USA, Inc.
118 South Clay Street
Hopkinsville, Kentucky 42240

Key Oil Company
206 East 25th Street
Hopkinsville, Kentucky 42240

Home Oil and Gas Company
Nashville Road
Hopkinsville, Kentucky 42240

Southern States Hopkinsville
Petroleum Cooperative
520 Wooldridge Road
Hopkinsville, Kentucky 42240

Hopkinsville Oil Company
708 North Main Street
Hopkinsville, Kentucky 42240

Residual fuel oil - Arrangements must be made with the refinery.

Low sulphur content coal - Available in Kentucky.

* Kentucky Utilities Company's total generating capacity will be increased when a new 650,000 KW generation plant is completed in Hancock County in 1993.

WATER AND SEWERAGE

Public Water Supply

Company serving **Hopkinsville** - Sewerage and Water Works Commission
 101 North Main Street
 P. O. Box 628
 Hopkinsville, Kentucky 42240
 (502) 887-4241

Source - North Fork of Little River and four small lakes

Treatment plant capacity - 7,000,000 gallons per day

Average daily consumption - 4,000,000 gallons

Peak daily consumption - 5,200,000 gallons

Treatment processes - Rapid mix, coagulation, flocculation, sedimentation, filtration, chlorination, and fluoridation

Storage capacity - 7,300,000 gallons including clear well

Size lines - 4 to 18 inches

Average pressure - 56 psi to 92 psi

MONTHLY WATER RATES

| | | |
|----------|-------------------|---------------------------|
| First | 3,000 cubic feet | \$1.20 per 100 cubic feet |
| Next | 3,000 cubic feet | .95 per 100 cubic feet |
| Next | 3,000 cubic feet | .75 per 100 cubic feet |
| Next | 3,000 cubic feet | .65 per 100 cubic feet |
| Next | 3,000 cubic feet | .55 per 100 cubic feet |
| All over | 15,000 cubic feet | .45 per 100 cubic feet |

Meter Minimum Rate

| | |
|------------|-------------------|
| 5/8-inch | \$ 3.60 per month |
| 3/4-inch | 4.80 per month |
| 1-inch | 7.25 per month |
| 1 1/2-inch | 14.50 per month |
| 2-inch | 23.75 per month |
| 3-inch | 43.20 per month |
| 4-inch | 72.60 per month |
| 6-inch | 283.80 per month |

Tap-on charge:

| | |
|-------------------------------|--------|
| 1-inch and smaller connection | \$ 400 |
| 1 1/2-inch connection | 600 |
| 2-inch connection | 900 |
| 3-inch connection | 1,200 |
| 4-inch connection | 1,400 |
| 6-inch connection | 2,000 |

(Continued)

Private Fire Protection

| | |
|----------------------------|-------------------|
| Through 2-inch connection | \$ 59.40 per year |
| Through 3-inch connection | 85.80 per year |
| Through 4-inch connection | 138.60 per year |
| Through 6-inch connection | 250.80 per year |
| Through 8-inch connection | 363.00 per year |
| Through 10-inch connection | 554.40 per year |
| Through 12-inch connection | 792.00 per year |

Rates and charges not metered - Billed semi-annually in advance.

Tap-on charge: (Fire Service)

| | |
|-------------------|--------|
| 4-inch main size | \$ 600 |
| 6-inch main size | 900 |
| 8-inch main size | 1,200 |
| 10-inch main size | 1,400 |
| 12-inch main size | 1,600 |
| 14-inch main size | 2,000 |

Raw Water

Surface water sources - Little River, Sinking Fork and Tradewater River
Average discharge - Little River near Cadiz, Kentucky - 353 cfs (44 years, USGS)
Expected ground water yield - Varies throughout the county from a high of 200 to 500 gpm to a low of 5 gpm or less. Along the Little River the yield is 50 to 200 gpm. The majority of the county falls in the 5 to 50 gpm range.

Sewerage

Company serving **Hopkinsville** - Sewerage and Water Works Commission
101 North Main Street
P. O. Box 628
Hopkinsville, Kentucky 42240
(502) 887-4241

Design capacity - 6,000,000 gallons per day (2 plants)
Average daily flow - 3,000,000 gallons
Type of treatment - Tertiary
Treatment processes - Flow equalization, screening, grit removal, primary sedimentation, lagoon system, activated sludge, trickling filter, rotating biological contactors, secondary sedimentation, chlorination, anaerobic digester, sludge drying beds, filter press, tertiary filter
Treated effluent discharged into - North Fork of Little River
Size of sanitary mains - 8 to 48 inches

(Continued)

Monthly rates -

| | | |
|-------|-------------------|-------------------------|
| First | 300 cubic feet | \$6.30 (Minimum) |
| Next | 2,700 cubic feet | 2.10 per 100 cubic feet |
| Next | 3,000 cubic feet | 1.80 per 100 cubic feet |
| Next | 3,000 cubic feet | 1.50 per 100 cubic feet |
| Next | 3,000 cubic feet | 1.30 per 100 cubic feet |
| Next | 3,000 cubic feet | 1.20 per 100 cubic feet |
| Over | 15,000 cubic feet | 1.10 per 100 cubic feet |

Additional sewer rates are charged to users who discharge wastewater which exceeds specific standards of strength. These rates are based upon the strength of such contaminants as B.O.D., suspended solids and other parameters in excess of standards established by the Sewerage and Water Works Commission.

Tap-on charge: None

CLIMATE

Christian County

Temperature

| | |
|---|----------------|
| Normal (30-year record) | 59.10 degrees |
| Average annual 1984 | 58.80 degrees |
| Record highest, July 1952 (45-year record) | 107.00 degrees |
| Record lowest, January 1963 (45-year record) | -15.00 degrees |
| Normal heating degree days (30-year record) (Heating degree day totals are the sums of negative departures of average daily temperatures from 65 degrees F.) | 3,756 |

Precipitation

| | |
|---|--------------|
| Normal (30-year record) | 48.49 inches |
| Mean annual snowfall (29-year record) | 11.10 inches |
| Total precipitation 1984 | 56.49 inches |
| Mean number days precipitation (.01 inch or more) (43-year record) | 119.40 |
| Mean number days thunderstorms (43-year record) | 54.40 |

Prevailing Winds (through 1963)

South

Relative Humidity (19-year record)

| | |
|----------|------------|
| Midnight | 79 percent |
| 6 a.m. | 84 percent |
| Noon | 58 percent |
| 6 p.m. | 61 percent |

Source: U.S. Department of Commerce, Environmental Science Services Administration, Climatological Data, 1984. Station of record: Nashville, Tennessee.

LOCAL GOVERNMENT

City

Structure - Mayor - 4-year term; 12 council members - 2-year terms; city administrative officer

| | |
|-------------------------------|---------------|
| Budget 1984-85 - General Fund | \$ 6,571,400* |
| Water and Sewer Fund | 4,365,820 |
| City Electric System | 15,900,000 |

Fees and licenses - Occupational license tax - one percent of wages; business licenses vary. Most itinerant businesses pay an annual fixed fee, while other businesses pay a fee based upon gross receipts. Business license fees for manufacturers are based on number of employees: less than 50 employees - \$100; 50 to 99 employees - \$150; 100 or more employees - \$200.

County

Structure - County Judge/Executive - 4-year term; 8 magistrates - 4-year terms
Budget 1984-85 - General Fund \$1,614,121; Road Fund \$763,876

Assessed Value of Property, 1985**

| <u>Classes of Property</u> | Hopkinsville | Christian County |
|----------------------------|---------------------|-------------------------|
| Real Estate | \$328,132,487 | \$533,150,498 |
| Tangibles | 120,296,495 | 187,940,671 |

* Includes revenue sharing and road aid funds.

** Excludes Homestead Exemptions.

State and Local Property Taxes

All property in Kentucky, except items exempted by the state constitution, is taxed by the state. Property which also may be taxed by local jurisdiction includes land and buildings, finished goods inventories, automobiles, trucks, office furniture and office equipment. Local taxing jurisdictions in Kentucky include counties, cities, and school districts.

All property in Kentucky is assessed at 100 percent of fair cash value.

COMBINED STATE AND LOCAL RATES PER \$100 VALUATION, 1985

| | <u>Hopkinsville</u> | <u>Unincorporated Christian County</u> |
|--|---------------------|--|
| Land and Buildings | \$ 0.7700 | \$ 0.5000 |
| Manufacturing Machinery | 0.150 | 0.150 |
| Pollution Control Equipment | 0.150 | 0.150 |
| Inventories | | |
| Raw materials | 0.001* | 0.001* |
| Goods in Process | 0.001* | 0.001* |
| Finished Goods | 0.5442* | 0.2932* |
| Automobiles and Trucks | 1.0122 | 0.7422 |
| Other Tangible Personal Property | 0.9932 | 0.7422 |
| Intangibles (Accounts receivable, money in hand, stock, notes, bonds) | 0.250** | 0.250** |
| Goods Stored in Public Warehouses in Transit Status | 0.001* | 0.001* |
| Private Leaseholds in Industrial Revenue Bond Financed Facilities | 0.015 | 0.015 |

Three special taxing districts in Christian County levy property taxes in their district boundaries at rates ranging from \$0.09 to \$0.12 per \$100 valuation. One special taxing district also levies a tax within its boundaries at a rate of \$0.015 per acre of land.

* Includes 1986 state rate.

** Accounts receivable are taxed at 85 percent of face value, for an effective rate of \$0.2125 per \$100 valuation.

Utilities Gross Receipts Tax for Schools

A 3 percent tax is levied on utilities receipts for schools in Christian County. Tax is paid by all consumers of utilities as an add-on to the utilities bills. Exempted are receipts from utilities services that are resold and the receipts from the sale of energy or energy producing fuels that exceed 3 percent of the cost of production in manufacturing, processing, mining or refining.

Planning and Zoning

Joint agency - Hopkinsville-Christian County Planning Commission
 Participating cities - Hopkinsville, Crofton, Lafayette, Oak Grove, Pembroke
 Zoning enforced - Within the city of Hopkinsville
 Subdivision regulations enforced - Within the city of Hopkinsville and unincorporated Christian County
 Local codes enforced - Kentucky Building Code
 Mandatory state codes enforced - Kentucky Plumbing Code, National Electric Code, Kentucky Boiler Regulations and Standards, Kentucky Building Code (modeled after BOCA code)

Safety

Hopkinsville operates an Emergency Operations Center which connects the police, fire and ambulance services. A central dispatcher relays all emergency calls and the dispatching office contains equipment capable of tracing calls when false alarms are suspected or when an excited caller fails to give an address or other pertinent information about an emergency.

A 911 emergency number system has been installed to be used in calling the police, fire or ambulance services. During emergencies, the services can tune to a common radio frequency to communicate with each other.

| Police | Hopkinsville | Christian County | |
|---|---------------------|-------------------------|--------|
| | | Sheriff | Police |
| Total staff | 50 | 17 | 4 |
| Radio-patrol cars | 9 | 7 | 2 |
| Fire | Hopkinsville | Christian County | |
| Insurance Services Office, Public Protection Classification | 5 | * | |
| Full-time staff | 61 | | |
| Volunteers | - | | |

* Recognized fire protection districts in Christian County include Crofton, Fairview, Herndon, Highland, Pembroke, South Christian County, Square Deal, and Westside, all with public protection classifications of nine. Incorporated areas in Christian County with recognized fire protection include Crofton, Oak Grove, and Pembroke, all with public protection classifications of seven. All other unincorporated areas of the county are class 10.

Rescue Service

Rescue service in Christian County is provided by the Christian County Rescue Team. All 32 volunteers are trained in standard First Aid, and some have training in advanced Red Cross First Aid and cardiopulmonary resuscitation. The team has 12 emergency medical technicians and a professional scuba diver. Rescue equipment includes "Jaws of Life", generators, boats, a field kitchen, and an oxygen unit. A one-ton truck is used as a first-run vehicle, and four radio-equipped cars also are available for rescue runs.

Refuse Collection and Disposal

| | Hopkinsville | Christian County |
|-----------------------|-------------------------------|------------------|
| Type service | Municipal | Private |
| Fee charged: | | |
| residential | \$5.80 per month | By contract |
| commercial | Based on volume and frequency | By contract |
| industrial | \$80.00 per load, per pickup | By contract |
| Collection frequency: | | |
| residential | Weekly | By contract |
| commercial | As requested | By contract |
| industrial | As requested | By contract |
| Disposal method | Landfill | Landfill |

Christian County residents may deposit refuse at collection points maintained throughout the county. Pickup service is provided at these points three days per week with disposal at the sanitary landfill.

EDUCATION

Public Schools

Christian County

| | | |
|--|--|---|
| Total Enrollment (Fall, 1985) | | 9,280 |
| Kindergarten | | 721 |
| Elementary | | 4,257 |
| Middle School | | 1,532 |
| High School | | 2,770 |
| Accreditation | | Southern Association of Colleges and Schools |
| Pupil-Teacher Ratio (1984-85) | | 21-1 |
| Percent High School Graduates to College (1984-85) | | 36.7 |
| Expenditures Per Pupil (1984-85) | | \$ 1,779.63 |

Nonpublic Schools

| | Fort Campbell | Crofton Amish Parochial | Hopkinsville Seventh Day Adventist |
|--|------------------------------|----------------------------|---------------------------------------|
| Total Enrollment | 4,398 | 22 | 8 |
| Kindergarten, Elementary and Middle School | 3,798 | 22 | 8 |
| High School | 600 | -- | -- |
| Pupil-Teacher Ratio | 20-1 | 22-1 | 8-1 |
| | Life Tabernacle Christian | Pennyrile Christian | Saints Peter and Paul |
| Total Enrollment | 34 | 50 | 90 |
| Kindergarten and Elementary | 19 | 50 | 90 |
| High School | 15 | -- | -- |
| Pupil Teacher Ratio | 10-1 | 13-1 | 13-1 |

(Continued)

**University Heights
Academy**

| | |
|--------------------------------|------|
| Total Enrollment | 245 |
| Kindergarten and Elementary | 125 |
| High School | 120 |
| Pupil-Teacher Ratio | 12-1 |

Area Colleges and Universities

| <u>Name</u> | <u>Location (Miles distant)</u> | <u>Enrollment (Fall, 1985)</u> | <u>Highest Degree Conferred</u> |
|-----------------------------------|-------------------------------------|------------------------------------|-------------------------------------|
| Hopkinsville Community College | Hopkinsville, Kentucky | 942 | Associate |
| Austin Peay State University | Clarksville, Tennessee (27) | 5,012 | Academic & Professional |
| Madisonville Community College | Madisonville, Kentucky (34) | 1,330 | Associate |
| Murray State University | Murray, Kentucky (57) | 7,294 | Masters, Specialist* |
| Western Kentucky University | Bowling Green, Kentucky (65) | 11,259 | Masters, Specialist** |
| Henderson Community College | Henderson, Kentucky (71) | 1,859 | Associate |

In addition, there are nine colleges and universities in Nashville, Tennessee, 73 miles from Hopkinsville.

-
- * Joint doctoral degree programs are offered in cooperation with the University of Kentucky, Lexington. The degrees are issued by the University of Kentucky.
- ** Joint doctoral degree programs are offered in cooperation with the University of Kentucky, Lexington, and cooperative doctoral degree programs are offered with the University of Louisville. The degrees are issued by the University of Kentucky or the University of Louisville.

Hopkinsville Community College

The University of Kentucky's Hopkinsville Community College offers two years of transfer or college parallel courses; associate degrees in Business Technology (with options in banking, management, management information systems, and agri-business); Human Services Technology, Law Enforcement, Nursing, and Secretarial and Office Administration; and a variety of credit and noncredit courses. In addition, the college works with business and industry to provide job-related programs. These include pre-employment training, middle management training, and an industrial training institute. A continuing education program in statistical quality control was begun in 1985.

The community college conducts examinations for the certification of professional secretaries, General Education Development Tests (G.E.D.'s), and State Merit Examinations (for employment with state government) twice monthly. The college's Fall 1985 enrollment was 942.

Draughon's Junior College

Draughon's Junior College of Business is an accredited, two-year junior college of business located in Hopkinsville. The college confers an associate degree. The school's 1985 student enrollment was 269.

Vocational Schools

Both the state vocational-technical schools and the area vocational education centers are operated by the Kentucky Department of Education. The state vocational-technical schools enroll persons full time who are at least 16 years of age and not in school. These students attend classes for six hours each day. The area vocational education centers are designed to accommodate high school students who are at least 15 years of age. These students attend vocational school for three hours each day. The state vocational-technical schools and the area education centers offer evening courses to enable working adults to upgrade current job skills.

(Continued)

Nearest State School

Madisonville State Vocational-Technical School
Madisonville, Kentucky, 34 miles distant

| | |
|--|-----------------------------|
| Health & Personal Services Occupations | Carpentry |
| Bimedical Equipment Technician | Diesel Mechanics |
| Licensed Practical Nursing | Drafting (with CAD/CAM) |
| Medical Laboratory Technician | Electronics |
| Medical Secretary/Medical Office Clerk | Industrial Electricity |
| Health Services | Machine Shop |
| Radiologic Technology | Mine Equipment Operator |
| Respiratory Therapy | Mine Maintenance Technology |
| Surgical Techologist | Tool & Die |
| Industrial Education | Welding |
| Auto Body Repair | Learning Resource Center |
| Auto Mechanics | |

Nearest Area Education Center

Christian County Area Vocational Education Center
Hopkinsville

| | |
|---------------------------|---------------------------------|
| Agriculture | Electricity |
| Adult Farmer | Heating and Air Conditioning |
| Young Adult Farmer | Machine Shop |
| Industrial Education | Masonry |
| Auto Body Repair | Welding |
| Auto Mechanics | JTPA Program - Clerical Cluster |
| Carpentry/Building Trades | |

Arrangements can be made to provide training in the specific production skills required by an industrial plant. Instruction may be conducted either in the vocational school or in the industrial plant, depending upon the desired arrangement and the availability of special equipment.

HEALTH

Local Medical Personnel

Physicians - 76
Dentists - 22

Hospitals

| <u>General Hospital</u> | <u>Location</u> | <u>Beds</u> |
|------------------------------|-----------------|-------------|
| Jennie Stuart Medical Center | Hopkinsville | 222 |

General hospital facilities - 9 operating rooms, 10 emergency rooms with 24-hour physician coverage, blood bank, cardiographics, critical care units (intensive, coronary, progressive), dialysis unit, laboratory, level II intermediate care nursery, obstetrics, outpatient services, pediatrics, pharmacy, physical therapy, respiratory therapy, radiology/nuclear medicine (including cobalt, DVI, CAT scan, and ultrasound), surgery (including same day), social services. RN students from Hopkinsville Community College, Murray State University, and Austin Peay State University, and LPN students from Madisonville State Vocational-Technical School affiliate at Jennie Stuart Medical Center for clinical practice.

Medical staff - 76 physicians and 515 employees

Other Medical Facilities

Christian County Health Department (a public health agency)
Pennyroyal Regional Mental Health - Mental Retardation Center
Trover Clinic
Western State Hospital (psychiatric)

Ambulance Service

Name - Hopkinsville-Christian County Emergency Ambulance Service
Staff - 16 full-time emergency medical technicians and 24 volunteers
Service - 24-hour, county-wide service (stations are located in Hopkinsville, Crofton, and Oak Grove)
Equipment - Five fully equipped ambulances (two at main station in Hopkinsville, one in Crofton, one in Oak Grove, plus one back-up ambulance)

OTHER LOCAL FACILITIES

Communications

| | |
|---|---|
| Telephone - | South Central Bell Telephone Company |
| Telegraph - Services - | Western Union Toll-free number, 1-800-325-6000; counter service available locally |
| Postal - Class - Mail received - Mail dispatched - | U.S. Post Office First Twice daily Three times daily |
| Newspapers - Daily (except Sunday) and circulation - Other papers received from - | The Kentucky New Era; 16,500 Louisville, Kentucky; Evansville, Indiana; Nashville, Tennessee |
| Radio - Stations received from - | WHOP-AM/FM, WKOA-AM, WKOF-FM, WNKJ-FM Cadiz, Louisville, Ft. Campbell, and Russellville, Kentucky; Nashville, Tennessee |
| Television - Airwave reception from - | W43AG - Local low-power station Nashville, Tennessee (6 stations); Paducah and Bowling Green, Kentucky; Evansville, Indiana (4 stations) |
| Cable service Number of cable channels - | 37 |
| Educational Television - | Madisonville, Kentucky, transmitter - Channel 35; Nashville, Tennessee, transmitter - Channel 8 |

Library Services

Public library - Hopkinsville-Christian County Public Library

Size collection - 75,000 volumes

Circulation, 1984-85 - 176,000

Special collections - McCarroll Genealogy Collection

Services - Student services (assistance with research projects), bookmobile, children's department, story hour, talking books, microfilm, records, community room, magazines, films, filmstrips, book reviews, Interlibrary Loan

College library - Hopkinsville Community College (open to the public)

Size collection - 42,390 volumes

Special collections - Kentucky Collection; Government Documents; microfilm of Christian County deeds, wills, and other records; over 100 years of Kentucky New Era on microfilm

Services - 19 newspapers; 144 periodicals; 7,000 records, cassettes, filmstrips, and reel-to-reel tapes; audiovisual equipment; microfilm of census records; copying machine

Religious Institutions

Denominations -

Apostolic

Assembly of God

Baptist

Catholic

Christian

Christian Methodist

Episcopal

Christian Science

Church of Christ

Church of God

Church of Nazarene

Episcopal

Interdenominational

Latter Day Saints

Lutheran

Methodist

Nazarene

Pentecostal

Presbyterian

Salvation Army

Seventh Day Adventist

United Methodist

Nearest synagogues - Nashville, Tennessee, 73 miles southeast

Congregations - Sherith Israel (orthodox)

Ohabai Shalom (reform)

West End Synagogue (conservative)

Financial Institutions

| <u>Banks</u> | <u>Assets</u> | <u>Deposits</u> | <u>Statement Date</u> |
|--|------------------|-------------------------|-----------------------|
| First City Bank and Trust Company | \$132,308,143.00 | \$113,748,389.00 | 6/30/85 |
| Pennyrile Citizens Bank and Trust Company | 35,825,049.62 | 27,193,898.01 | 6/30/85 |
| Planters Bank and Trust Company | 163,030,000.00 | 144,272,000.00 | 9/30/85 |
| <u>Savings and Loan Associations</u> | <u>Assets</u> | <u>Savings Accounts</u> | <u>Statement Date</u> |
| First Federal Savings and Loan Association of Hopkinsville | \$ 48,001,437.42 | \$ 44,706,023.87 | 6/30/85 |
| Hopkinsville Federal Savings Bank | 125,205,639.39 | 125,205,639.39 | 12/31/84 |

Hotels and Motels

Total number - 14
Total rooms - 509

Clubs and Organizations

Alpha Delta Chapter Epsilon Sigma
Alpha International
Alpha Phi Alpha Fraternity
American Legion
Beta Gamma Chapter, Epsilon Sigma
Alpha
Boy Scouts of America
Bronze Twilight Club
Buddies, Inc.
Cavalier Club
Central Western Kentucky CB Radio
Club (CWKY)
Christian County Baptist Association
Christian County Bar Association
Christian County Farm Bureau
Christian County Historical Society
Christian County Red Cross
Christian County Republican Women
Community Concert Association
Community Players
Crofton Women Community Club
Delta Sigma Theta
Disabled American Veterans
Disabled American Veterans
Auxiliary
The Dream Factory
Eagles
Girl Scouts
Golden Saints Motorcycle Club
Hopkinsville Art Guild
Hopkinsville Business and
Professional Women's Club
Hopkinsville-Christian County Board
of Realtors, Inc.
Hopkinsville-Christian County
Chamber of Commerce
Hopkinsville-Christian County
Jaycees
Hopkinsville-Christian County
Lioness
Hopkinsville-Christian County
National Association of the
Advancement of Colored People
(NAACP)
Hopkinsville Civitan Club
Hopkinsville Elks Lodge
Hopkinsville Hunting and Fishing
Club
Hopkinsville Junior Auxiliary, Inc.
Hopkinsville Noon Kiwanis
Hopkinsville Optimist Club
Hopkinsville Shrine Club
Katherine Peden Business and
Professional Women's Club
The League of Women Voters
Lion's Club - Day
Lion's Club - Evening
Little River Audubon Society
The Loyal Order of Moose
Masonic Lodge
Modern Matrons Club
Modernettes Civic Club
Mothers Against Drunk Driving
(M.A.D.D.)
National Association of Career
Women's Civic Club, Inc.
National Association of Retired
Federal Employees
The Newcomers Club of Hopkinsville
Order of the Eastern Star
Pennyrile Home Builders Association
Pennyrile Hospice, Inc.
Pennyrile Industrial Management Club
Pennyrile Philatelic Society
Pennyrile Players, Inc.
Pennyrile Rose Society
Pennyrile Scottish Rite Club
Pennyroyal Arts Council
Pennyroyal Crafts Group, Inc.
Pennyroyal Poets
Pioneer, Inc.
Professional Secretaries, International
Rainbow Girls
Rotary Club of Hopkinsville
The Salvation Army
Sons of American Revolution
Sportsman's Club
University of Kentucky Alumni
Association
Veterans of Foreign Wars (V.F.W.)
Weight Watchers
Welcome Wagon Club of Hopkinsville
Western Kentucky Chapter of American
Society for Personnel Administration
(A.S.P.A.)
Western Kentucky State Fair Board

RECREATION

Local

Hopkinsville offers a variety of public recreation opportunities. Public facilities include ten parks, eight playgrounds, three swimming pools, fifteen tennis courts, eight baseball diamonds, three softball fields, a football field, two soccer fields, a nine-hole golf course (par-3), and a fishing lake. New public facilities include a senior citizen's walking course, a BMX track, an 18-hole miniature golf course, a nature fitness trail, an 18-hole golf course, and a fishing pond. A community shelter (to seat 300) is expected to be built in 1986.

The Hopkinsville-Christian County Recreation Department employs a full-time director and staff. Supervised recreational programs include classes in tennis, swimming, arts and crafts, soccer, aerobics, water aerobics and special programs for the handicapped. Sports leagues include men's and women's softball, basketball and volleyball; co-ed softball and flag football; boys' and girls' softball; Little League and Babe Ruth league baseball; junior league basketball; pee wee football; and soccer. Special events coordinated by the department are: "Life. Be in it. Superday", Christmas Parade, Haunted House, Sports Blast, 911 Program, Little River Days Festival, Giant Christmas Card Contest, Halloween Costume Parade and Pumpkin Painting Contest, Giant Easter Egg Contest and "Life. Be in it. Open House".

The Western Kentucky State Fair is held at the Christian County Fairgrounds each summer. A horse show, horse races, tractor pulls, and performances by famous entertainers are featured. The fair is the third-largest in Kentucky.

The Pennyroyal Area Museum is in Hopkinsville. The museum houses exhibits of Civil War and Jefferson Davis memorabilia, Indian relics, and early pioneer displays.

Private recreational facilities include a golf and country club, swimming pools, bowling lanes, riding stables, five movie theatres, a roller skating rink, trap shooting facilities, and a racquetball and health club.

Several organizations in Hopkinsville hold periodic performances, programs or exhibits throughout the year. These groups include the Community Players, the Hopkinsville Art Guild, the Hopkinsville Madrigal Singers, the Oratorio Society, the Pennyroyal Players, the Pennyroyal Crafts Group, the Pennyroyal Youth Chorale, Hopkinsville Community Concerts, and the Southern Kentucky Independent Theatre (S.K.I.T.).

Area (Within 55 miles)

Jefferson Davis Monument State Shrine is located 10 miles east of Hopkinsville at Fairview. The shrine is at the site of the birthplace of Jefferson Davis, a former U.S. Senator, Secretary of War, and the only president of the Confederate States of America. The park contains a 351-foot obelisk with an elevator to the top for viewing, a museum, a gift shop, and a playground with picnic tables.

Embraced by probably the most beautiful wooded area in Western Kentucky, **Pennyriile Forest State Resort Park** near Dawson Springs is located approximately 21 miles northwest of Hopkinsville. The lodge and cottages nestled within the trees provide excellent accommodations. Other facilities and activities include a dining room, a gift shop, rental rowboats and pedal boats, a 9-hole golf course, hiking trails, horseback riding, picnicking, playgrounds, shuffleboard, swimming at the lodge pool and off a sand beach, and two tennis courts. Lake Beshear, only four miles from the lodge, sports good fishing.

Lake Barkley State Resort Park, 29 miles west of Hopkinsville near Cadiz, is located on the scenic Little River embayment of the 58,000-acre Lake Barkley. The magnificent lodge includes 120 rooms, four suites, nine cottages, a dining room, a coffee shop, a gift shop, two meeting rooms, and a recreation room. An activities center with a capacity for 400 and a 80-site campground are located near the lodge. A lodge pool, a beach and a bathhouse, an 18-hole golf course, tennis courts, a riding stable, a trapshooting range, a basketball court, hiking trails, playgrounds, and a picnic area comprise the recreational facilities. The marina near the lodge has everything for the "boat lover": covered and open slips, launching ramp, and rentals for fishing boats, skiing boats, and pleasure ride pontoons.

The Land Between the Lakes, located on a 170,000-acre wooded peninsula approximately 35 miles from Hopkinsville, is an outdoor recreation and conservational education center. Camping, swimming, fishing, boating, hiking, a buffalo herd on a 250-acre range, an Environmental Education Center for school study groups, an educational farm and a central station with films and displays are among the attractions. Kentucky Lake and Lake Barkley are among the top fishing and water sport recreation areas in the southeastern United States.

Charm and serenity exemplify **Kenlake State Resort Park** which is located on Kentucky Lake, approximately 45 miles west of Hopkinsville. The park offers hotel and cottage accommodations and an efficient camping site. Other facilities include a 9-hole golf course, pool and lake swimming, horseback riding, hiking trails, fishing, boating, picnicking, planned recreation, and one of the finest tennis complexes in the area.

Kentucky Dam Village State Resort Park, located 53 miles northwest of Hopkinsville near Gilbertsville, is one of the largest and most popular vacation resorts in Kentucky. A modern lodge with 72 rooms, six different cottage types, and a 225-site campground make up the accommodations. There is also a dining room overlooking Kentucky Lake, a coffee shop, a snack bar, two gift shops, a meeting room, an activities center, and a recreation room. Recreational activities to choose from include boating and fishing at the largest docking facility in the Kentucky parks system, golf at the 18-hole Village Green Course, hiking, horseback riding, picnicking, swimming at the lodge pool or off the sand beach, and tennis.

Lake Malone State Park, located in southern Muhlenberg County, approximately 55 miles northeast of Hopkinsville, offers camping facilities, swimming, fishing and boating on a 788-acre lake. Playground facilities and picnic shelters are located in a beautiful scenic cliff area. Located across from the entrance to the park is an inn featuring luxury rooms, a restaurant, a swimming lake, a beach, boating, fishing, tennis, and nature trails.

COMMUNITY IMPROVEMENTS

Recent

Hopkinsville has been chosen as a "Kentucky Certified City" in 1983, 1984, and 1985, based upon achievement in economic and community development. The annual certification program is sponsored by the Kentucky Chamber of Commerce.

During 1984, two manufacturing companies announced plans to open plants in Hopkinsville. During 1984 and 1985, 14 Hopkinsville manufacturing plants announced plans to expand their local operations. This represents an estimated investment of over \$40,000,000.

A new 6,400-square-foot multi-purpose hangar was constructed at the Hopkinsville-Christian County Airport recently. A new fuel facility was added also.

The Jennie Stuart Medical Center added plastic and oral/maxillofacial services and new ultrasound systems in 1985.

A new low-power television station began broadcasting in Hopkinsville in 1984.

Thurston Motor Lines, Inc., opened a new motor freight terminal in Hopkinsville in December, 1985.

Planned

Construction of two new motel/meeting facility complexes is scheduled to begin in 1986. Two major department stores also are scheduled to open new retail centers in Hopkinsville in 1986.

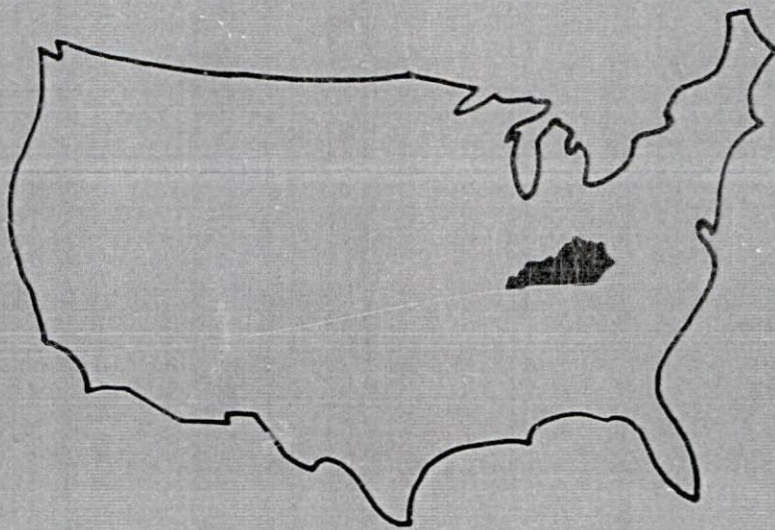

**Kentucky Commerce Cabinet
Department of Economic Development
Capital Plaza Tower
Frankfort, Kentucky 40601
(502) 564-7140**