

1982

Industrial Resources: Lawrence County - Louisa

Kentucky Library Research Collections
Western Kentucky University, spcol@wku.edu

Follow this and additional works at: https://digitalcommons.wku.edu/lawrence_cty

 Part of the [Business Administration, Management, and Operations Commons](#), [Growth and Development Commons](#), and the [Infrastructure Commons](#)

Recommended Citation

Kentucky Library Research Collections, "Industrial Resources: Lawrence County - Louisa" (1982). *Lawrence County*. Paper 1.
https://digitalcommons.wku.edu/lawrence_cty/1

This Report is brought to you for free and open access by TopSCHOLAR®. It has been accepted for inclusion in Lawrence County by an authorized administrator of TopSCHOLAR®. For more information, please contact topscholar@wku.edu.

DK

Lawrence County

A comprehensive
report on
Louisa, Ky.



KENTUCKY & CO.
The state that's run like a business.

LOUISA, KENTUCKY --- Site 182 --- 23.5 Acres

For more information contact the Department of Economic Development, Office of Business Development, Industrial Development Division, Capital Plaza Tower, Frankfort, Kentucky 40601 (502-564-7140).

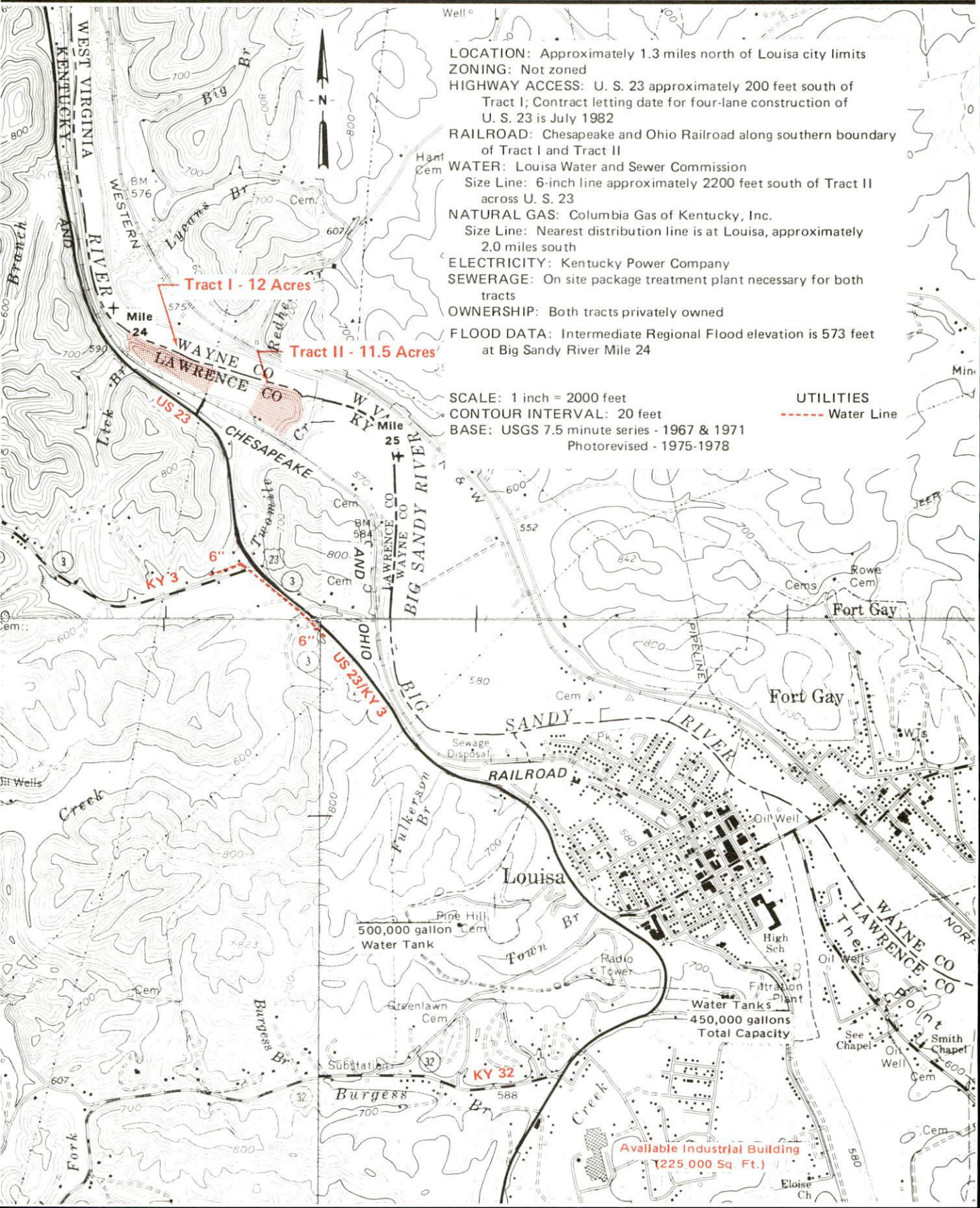

- LOCATION: Approximately 1.3 miles north of Louisa city limits
- ZONING: Not zoned
- HIGHWAY ACCESS: U. S. 23 approximately 200 feet south of Tract I; Contract letting date for four-lane construction of U. S. 23 is July 1982
- RAILROAD: Chesapeake and Ohio Railroad along southern boundary of Tract I and Tract II
- WATER: Louisa Water and Sewer Commission
Size Line: 6-inch line approximately 2200 feet south of Tract II across U. S. 23
- NATURAL GAS: Columbia Gas of Kentucky, Inc.
Size Line: Nearest distribution line is at Louisa, approximately 2.0 miles south
- ELECTRICITY: Kentucky Power Company
- SEWERAGE: On site package treatment plant necessary for both tracts
- OWNERSHIP: Both tracts privately owned
- FLOOD DATA: Intermediate Regional Flood elevation is 573 feet at Big Sandy River Mile 24

SCALE: 1 inch = 2000 feet
 CONTOUR INTERVAL: 20 feet
 BASE: USGS 7.5 minute series - 1967 & 1971
 Photorevised - 1975-1978

UTILITIES
 - - - - - Water Line

Available Industrial Building
 (225,000 Sq. Ft.)

A COMPREHENSIVE REPORT ON
LOUISA, KENTUCKY

Prepared by
The Kentucky Department of Economic Development
Division of Research and Planning
in cooperation with
The Greater Louisa Industrial Foundation

1982

Program manager - Brenda Roberts; research - John McMurray; clerical - Linda Fint; graphics - Frank Ferrante, Tony Cecconi, Jimmy Thompson; cartography - Site Evaluation Section, Division of New Industries. Cost of printing paid from state funds.

TABLE OF CONTENTS

<u>Chapter</u>	<u>Page</u>
INDUSTRIAL SITES	i
LOUISA, KENTUCKY - A RESOURCE PROFILE	1
THE LABOR MARKET AREA	3
Population	3
Labor Force Characteristics of Residents, 1980	3
Estimated Male Labor Supply	4
Estimated Female Labor Supply	4
Louisa Manufacturing Firms, Their Products and Employment	5
Labor Organizations in Manufacturing Firms	5
Industrial Services	5
Average Weekly Wages by Industry, by Place of Work	6
Per Capita Personal Income	8
TRANSPORTATION	9
Rail	9
Highways	9
Truck Service	9
Air	10
Bus	11
Taxi	11
Rental Services	11
Water	11
POWER AND FUEL	12
Electricity	12
Natural Gas	13
Other Fuels	13
WATER AND SEWERAGE	14
Public Water Supply	14
Raw Water	15
Sewerage	16
CLIMATE	17

<u>Chapter</u>	<u>Page</u>
LOCAL GOVERNMENT	18
City	18
County	18
Assessed Value of Property, 1981	18
Property Taxes	18
Combined State and Local Rates Per \$100 Valuation, 1981	19
Planning and Zoning	19
Safety	19
Police	19
Fire	19
Rescue Service	20
Refuse Collection and Disposal	20
EDUCATION	21
Public Schools	21
Area Colleges and Universities	22
Vocational Schools	23
HEALTH	25
Local Medical Personnel	25
Hospitals	25
Other Medical Facilities	25
Ambulance Service	26
Public Health	26
OTHER LOCAL FACILITIES	27
Communications	27
Library Services	27
Religious Institutions	28
Financial Institutions	28
Hotels and Motels	28
Clubs and Organizations	28
RECREATION	29

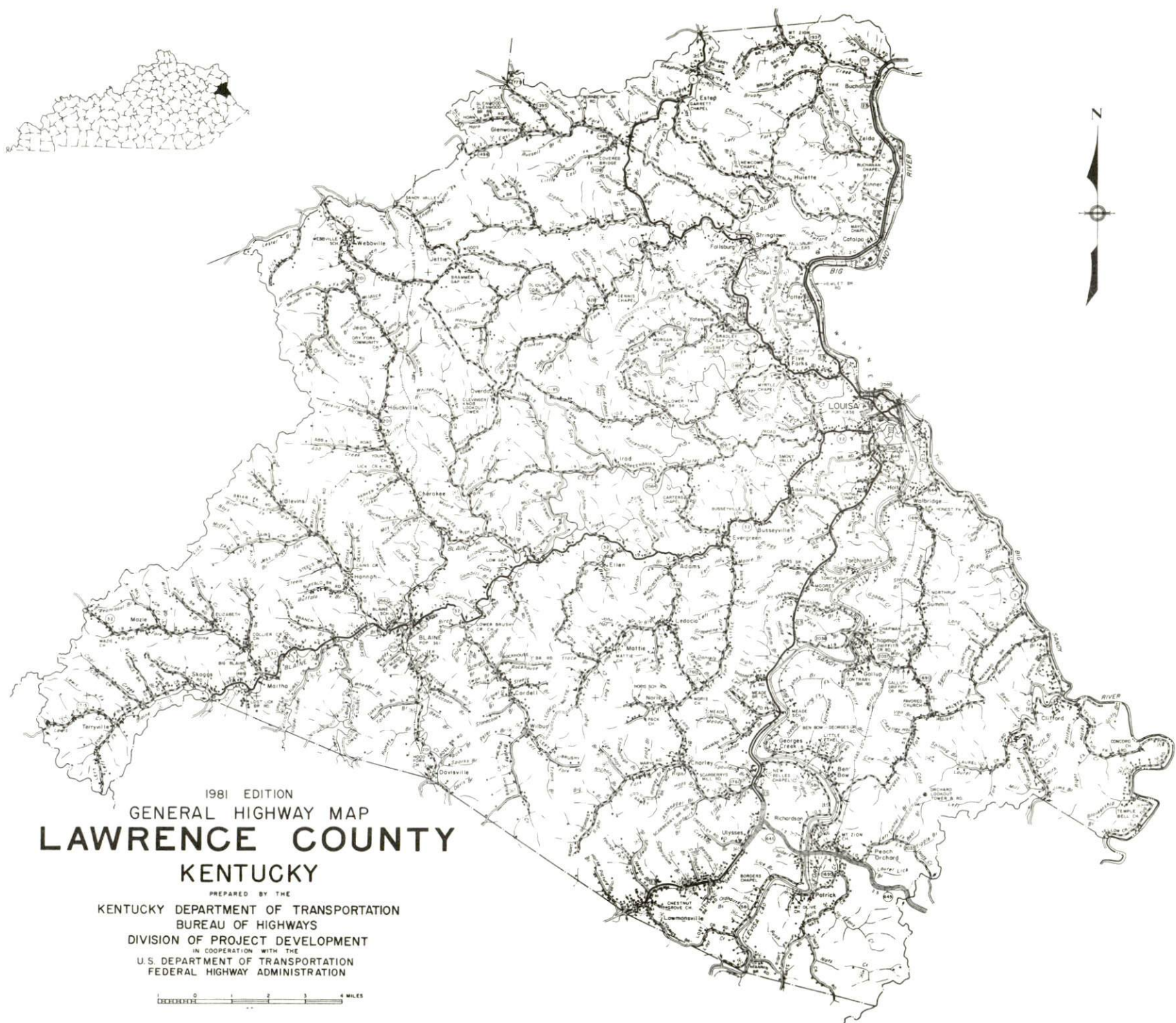

1981 EDITION
GENERAL HIGHWAY MAP
LAWRENCE COUNTY
KENTUCKY

PREPARED BY THE
KENTUCKY DEPARTMENT OF TRANSPORTATION
BUREAU OF HIGHWAYS
DIVISION OF PROJECT DEVELOPMENT
IN COOPERATION WITH THE
U.S. DEPARTMENT OF TRANSPORTATION
FEDERAL HIGHWAY ADMINISTRATION



LOUISA, KENTUCKY - A RESOURCE PROFILE

Louisa, the county seat of Lawrence County, lies in the northern part of the Eastern Coal Field Region along the Kentucky-West Virginia border. Louisa is 33 miles from Ashland, 36 miles from Huntington, West Virginia, 140 miles from Lexington, 212 miles from Louisville and 218 miles from Cincinnati, Ohio.

The 1980 population of Louisa was 1,832. The 1980 population of Lawrence County, an area of 425 square miles, was 14,121. Between 1970 and 1980, Lawrence County had a 31.6 percent increase in population.

The Economic Framework

Total employment in Lawrence County in 1980 averaged 3,255 with 3,034 employed in nonagricultural jobs. Manufacturing provided 85 jobs, wholesale and retail trade provided 491 jobs, service occupations provided 413 jobs and government provided 454 jobs. Manufacturing is greatest in the garment and lumber industries.

Per capita income in the county in 1979 was \$5,707. Between 1975 and 1979, per capita income increased by 63 percent.

The labor market area includes Lawrence County and its six surrounding counties. Area employment in 1980 averaged 54,436 with 52,972 employed in nonagricultural jobs. Manufacturing provided 8,774 jobs, wholesale and retail trade provided 8,860 jobs, service occupations provided 5,683 jobs and government provided 5,549 jobs.

Resources for Growth

1. Labor - There is a current estimated labor supply of 10,314 men and 10,989 women available for industrial jobs in the labor market area. In addition, 5,884 young men and 5,432 young women will become 18 years of age before 1986 and potentially available for work.
2. Transportation - Louisa is served by U.S. Highway 23, a "AAA" rated, multilane highway, which runs north and south out of Louisa. Access to I-64 is available 25 miles north of Louisa via U.S. 23. Other highways serving Louisa are Kentucky highways 3 and 32, both "AA" rated. Mainline rail service is provided by The Chessie System. Commercial air service is available at Tri-State Airport (Walker-Long Field), nine miles southwest of Huntington, West Virginia; 27 miles northeast of Louisa. Louisa is served by three common carrier truck companies providing interstate and intrastate service.
3. Power - Kentucky Power Company provides electricity to Louisa while Big Sandy RECC and Grayson RECC provide electric power to Lawrence County. Columbia Gas of Kentucky, Inc., serves Louisa. Three distributors of propane and butane and two distributors of distillate fuel oil are located in Louisa. Low sulphur content coal is also available locally.

4. Education - Louisa and Lawrence County are served by the Lawrence County School System. There are three universities, one college, and two community colleges within an 85 mile radius of Louisa.

State vocational-technical schools are located in Paintsville, 31 miles from Louisa, and Ashland, 33 miles away. The schools offer training in 28 different courses. An area vocational center is located in Inez, 25 miles from Louisa, and offers six courses.

THE LABOR MARKET AREA

The Louisa Labor Market Area includes Lawrence County and the adjoining Kentucky counties of Boyd, Carter, Elliott, Johnson, Martin and Morgan.

POPULATION

<u>Area</u>	<u>1980</u>	<u>1970</u>	<u>Percent Nonwhite</u>
Louisa	1,832	1,781	2.1
Labor Market Area	152,062	125,820	N/A
Lawrence County	14,121	10,726	0.4
Boyd County	55,513	52,376	2.3
Carter County	25,060	19,850	0.2
Elliott County	6,908	5,933	0.01
Johnson County	24,432	17,539	0.3
Martin County	13,925	9,377	0.2
Morgan County	12,103	10,019	0.4

Note: The 1980 counts of population by race are provisional.

Sources: U.S. Department of Commerce, Bureau of the Census, 1980 Census of Population and Housing, March 1981. Population Research Unit, Urban Studies Center, University of Louisville, Kentucky Demographics: The 1980 Census of Kentucky, Characteristics of Population, Households, Housing, January 1982.

LABOR FORCE CHARACTERISTICS OF RESIDENTS, 1980

	<u>Lawrence County</u>	<u>Labor Market Area</u>
Civilian Labor Force	3,751	60,464
Employment	3,255	54,436
Agricultural	221	1,464
Nonagricultural	3,034	52,972
Unemployment	496	6,028
Rate of Unemployment (%)	13.2	10.0

Source: Kentucky Department for Human Resources, Kentucky Labor Force Estimates, Annual Averages, 1980.

ESTIMATED MALE LABOR SUPPLY
LOUISA LABOR MARKET AREA

Area	Current			Under- employed	Future
	Total	Not in Labor Force	Unemployed		Reaching 18 years of age before 1986
Labor Market					
Area*	10,314	3,184	4,649	2,481	5,884
Lawrence	1,802	1,177	384	241	512
Boyd	2,595	0	1,815	780	2,367
Carter	2,116	840	940	336	948
Elliott	432	0	270	162	286
Johnson	1,980	983	630	367	761
Martin	475	0	261	214	553
Morgan	914	184	349	381	457

*The labor supply will be supplemented by the number of male workers who are available for industrial jobs in the adjoining West Virginia county of Wayne. Additional workers may be drawn from other nearby counties.

Note: Unemployed - persons unemployed and actively seeking work;

Underemployed - persons employed but working only 14 to 26 weeks per year;

Not in Labor Force - represents the number of persons who would enter the labor force if suitable employment were available (based on the assumption that persons in Kentucky would like to participate in the labor force in the same proportion that they do nationally).

Sources: Kentucky Department for Human Resources, Kentucky Labor Supply Estimates by County, 1980. Kentucky Department of Economic Development, Future Labor Supply before 1986.

ESTIMATED FEMALE LABOR SUPPLY
LOUISA LABOR MARKET AREA

Area	Current			Under- employed	Future
	Total	Not in Labor Force	Unemployed		Reaching 18 years of age before 1986
Labor Market					
Area*	10,989	7,541	1,379	2,069	5,432
Lawrence	1,475	1,258	112	105	426
Boyd	4,698	3,258	527	913	2,066
Carter	2,070	1,535	273	262	937
Elliott	188	33	79	76	315
Johnson	1,972	1,454	174	344	713
Martin	284	0	72	212	514
Morgan	302	3	142	157	461

*The labor supply will be supplemented by the number of female workers who are available for industrial jobs in the adjoining West Virginia county of Wayne. Additional workers may be drawn from other nearby counties.

Note: Unemployed - persons unemployed and actively seeking work;

Underemployed - persons employed but working only 14 to 26 weeks per year;

Not in Labor Force - represents the number of persons who would enter the labor force if suitable employment were available (based on the assumption that persons in Kentucky would like to participate in the labor force in the same proportion that they do nationally).

Sources: Kentucky Department for Human Resources, Kentucky Labor Supply Estimates by County, 1980. Kentucky Department of Economic Development, Future Labor Supply before 1986.

LOUISA MANUFACTURING FIRMS,
THEIR PRODUCTS AND EMPLOYMENT

<u>Firm</u> (Establishment date)	<u>Product</u>	<u>Employment</u>		
		<u>Total</u>	<u>Male</u>	<u>Female</u>
Big Sandy Publishing Company, Inc. (1885)	Newspaper, job printing	5	2	3
Louisa Coca-Cola Bottling Company (1905)	Soft drinks	16	14	2
Louisa Manufacturing, Inc. (1978)	Men's and boys' ski jackets, vests	40	2	38
Louisa Pallet Lumber Company (1975)	Pallets, rough lumber, wood chips	25	24	1
Louisa Supply Company, Inc. (1915)	Feed	8	7	1

Source: Kentucky Department of Economic Development; 1982 Kentucky Directory of Manufacturers.

LABOR ORGANIZATIONS IN MANUFACTURING FIRMS

Presently there are no labor unions representing manufacturing workers in Louisa.

INDUSTRIAL SERVICES

<u>Types of Services</u>	<u>Location</u>	<u>Mileage from Louisa</u>
Tool & Die, Machine & Pattern Shops	Ashland, Kentucky	33
Metal Service Centers	Huntington, West Virginia	34
Heat Treating	Richmond, Virginia	143
Metal Finishers	Huntington, West Virginia	34
Electric Motor Repair	Huntington, West Virginia	34

Sources: Kentucky Directory of Selected Industrial Services, 1981; Kentucky Department of Economic Development, Division of Research and Planning.

AVERAGE WEEKLY WAGES BY INDUSTRY,
BY PLACE OF WORK, 1980

	<u>Lawrence County</u>	<u>Boyd County</u>	<u>Carter County</u>	<u>Elliott County</u>
All Industries	\$ 219.62	\$ 300.96	\$ 195.55	\$ 220.21
Mining & Quarrying	238.66	380.82	341.55	445.38
Contract Construction	*	387.65	292.19	*
Manufacturing	165.15	421.71	188.37	202.79
Transportation, Communications & Public Utilities	*	339.30	307.89	180.72
Wholesale & Retail Trade	155.76	199.52	159.39	184.24
Finance, Insurance & Real Estate	214.32	234.81	220.48	*
Services	174.71	215.83	155.13	101.85
State/Local Government	175.10	218.58	210.53	146.03
Other	*	176.14	*	0

	<u>Johnson County</u>	<u>Martin County</u>	<u>Morgan County</u>
All Industries	\$ 237.37	\$ 482.94	\$ 218.78
Mining & Quarrying	391.26	580.54	434.48
Contract Construction	219.39	310.07	213.96
Manufacturing	*	*	145.11
Transportation, Communications & Public Utilities	289.61	274.50	259.83
Wholesale & Retail Trade	183.61	164.54	164.87
Finance, Insurance & Real Estate	223.06	248.93	189.44
Services	225.76	325.49	158.97
State/Local Government	213.58	176.00	228.64
Other	154.62	0	*

*Not disclosed.

Note: Excludes domestic workers, railway workers, certain nonprofit corporations, majority of federal government workers, and self-employed workers.

Source: Kentucky Department for Human Resources, Average Weekly Wages of Workers Covered by Kentucky Unemployment Insurance Law, 1980.

Occupational wage rates for specific industries are usually not available to most government agencies, and wage data furnished to state employment agencies by individual industrial employers are protected from disclosure by federal law. The most reliable up-to-date wage information can be obtained by direct contact with local employers.

Associated Industries of Kentucky, a voluntary organization of Kentucky businesses, regularly collects occupational wage rates and fringe benefits data from participating member firms. Data are compiled for over 127 clearly defined office, production, and service occupations. Tabulations are published for 11 regions of Kentucky, as shown on the map below. It should be noted that the data may be weighted by the preponderance of firms in the larger cities and may be somewhat higher than the rates paid in the smaller communities. Data from these tabulations are available, upon request, from the Kentucky Department of Economic Development, Frankfort, Kentucky 40601.

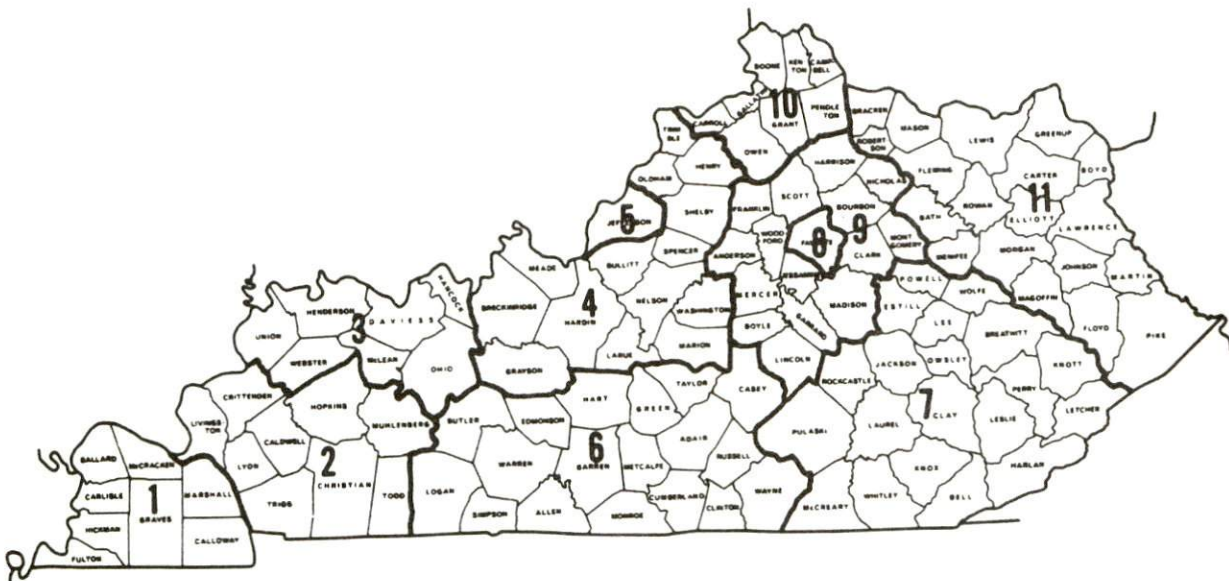

Associated Industries of Kentucky Area Wage Surveys

PER CAPITA PERSONAL INCOME

<u>Area</u>	<u>1979</u>	<u>1975</u>	<u>Percent Change</u>
Lawrence County	\$ 5,707	\$ 3,501	63.0
Labor Market Area Range	\$9,251 - 4,279	\$5,580 - 3,060	N/A
Kentucky	7,052	4,882	44.4
U.S.	8,637	5,861	47.4

Sources: U.S. Department of Commerce, Bureau of Economic Analysis, April 1981.
 U.S. Department of Commerce, Bureau of Economic Analysis, August 1981.

TRANSPORTATION

Rail

Line serving serving Louisa - The Chessie System

Services - Main line; an eastbound freight stops two times per week; seven eastbound and seven westbound through freights daily - November through April, 10 eastbound and 10 westbound through freights daily - May through October; switching facilities; team track space for 20 cars. Piggyback facilities are located at Charleston, West Virginia, 84 miles from Louisa.

For details on routing, schedules, rates, and services, contact:

The Chessie System
Real Estate and Industrial
Development Department
808 Dixie Terminal Building
Cincinnati, Ohio 45202
(513) 369-5258

Highways

Louisa is served by U.S. Highway 23, a "AAA" rated, multilane highway, which runs north and south out of Louisa. Access to I-64 is available 25 miles north of Louisa via U.S. 23. Other highways serving Louisa are Kentucky highways 3 and 32, both "AA" rated.

Truck Service

<u>Company</u>	<u>Home Office</u>
Hogan Storage and Transfer Company*	P. O. Box 377 Williamson, West Virginia 25661
Overnite Transportation Company**	P. O. Box 1216 Richmond, Virginia 23209
Smith's Transfer Corporation*	P. O. Box 1000 Staunton, Virginia 24401

* Interstate only.

** Interstate and Intrastate.

Other Freight ServicesNearest Shipping Center

Purolator Courier Corporation*
 United Parcel Service**

Lexington, 140 miles west of Louisa
 Ashland, 33 miles north of Louisa

HIGHWAY MILES AND TRUCK TRANSIT TIME IN DAYS FROM
 LOUISA, KENTUCKY, TO SELECTED MARKET CENTERS

City	Highway Miles	Delivery Time* TL	City	Highway Miles	Delivery Time* TL
Atlanta, Ga.	446	1	Los Angeles, Ca.	2,320	6-8
Baltimore, Md.	476	1-2	Louisville, Ky.	212	1
Birmingham, Ala.	507	1-2	Nashville, Tenn.	362	1
Chicago, Ill.	492	1-2	New Orleans, La.	892	2
Cincinnati, Ohio	218	1	New York, N. Y.	648	2-3
Cleveland, Ohio	338	1	Pittsburgh, Pa.	308	1
Detroit, Mich.	451	2-3	St. Louis, Mo.	475	1-2
Knoxville, Tenn.	253	1			

*Does not include the day of pickup.

Note: Mileage computations are via the best interstate or primary highways, not necessarily the most direct route of travel.

Sources: Rand McNally Road Atlas, 1979. Official Kentucky Mileage Map, 1979.
 Delivery time - Overnite Transportation Company, 1100 Commerce Road,
 Richmond, Virginia 23209.

AirNearest Local Airport

Location: Ashland-Boyd County Airport
 6 miles northwest of Ashland,
 39 miles north of Louisa

Runways: 1 paved
 Length: 5,600 feet

Traffic Control: Wind sock

Lighting: Sundown to sunrise, VASI

Services: Fuel (Jet A, 100LL), oil, storage

(Contd.)

* For regular scheduled pickups or for occasional pickups, arrangements must be made with the Lexington office of Purolator Courier Corporation.

** For regular scheduled pickups or for occasional pickups, arrangements must be made with the Louisville office of United Parcel Service.

Nearest Scheduled Commercial Airline Service

Location: Tri-State Airport (Walker-Long Field)
9 miles southwest of Huntington, West Virginia;
27 miles northeast of Louisa

Runways: 2 paved
Length: 6,509 feet and 3,007 feet

Traffic Control: Tower

Lighting: Beacon, runway

Services: USAir, Piedmont, Aeromech, Comair; fuel - 100LL,
jet; tie-downs, hangars; major A & P repairs,
major Avionics repairs; APU, charter, flight
instruction, oxygen, plane rental, survival equipment,
U.S. Customs; taxi, limousine, car rental; restaurant

Air Freight Service: Air freight terminal

Bus - Greyhound Bus Lines

Taxi - Two companies, 24-hour service

Rental Services - Auto, truck and trailer rentals available

Water

Louisa is located approximately 21 miles from a point on the Big Sandy River where a 9-foot navigation channel is maintained and approximately five miles from a point on the same river where a 6-foot navigation channel is maintained. An accelerated study is in progress to determine the feasibility of making the Big Sandy River navigable from its mouth near Ashland, Kentucky, to Louisa.

Plans are under way to develop a public riverport at Ashland, 33 miles from Louisa.

POWER AND FUEL

Electricity

Company serving Louisa and major portion of Lawrence County - Kentucky
Power Company

Source of power - Kentucky Power Company

Total generating capacity - 1,065,000 KW

For industrial rates contact:

Kentucky Power Company
P. O. Box 1428
1701 Central Avenue
Ashland, Kentucky 41101
(606) 329-2220

Companies serving south and southwestern portion of Lawrence County - Big
Sandy Rural Electric Cooperative Corporation; Grayson Rural Electric
Cooperative Corporation

Source of power - East Kentucky Power Cooperative

Total generating capacity - 1,304,000 KW

For industrial rates contact:

Industrial Development Division
East Kentucky Power Cooperative
P. O. Box 707
Winchester, Kentucky 40391
(606) 744-4812

and/or

Big Sandy RECC
Eleventh Street
P. O. Box 671
Paintsville, Kentucky 41240
(606) 789-4095

and/or

Grayson RECC
109 Bagby Park
Grayson, Kentucky 41143
(606) 474-5136

Natural Gas

Company serving Louisa - Columbia Gas of Kentucky, Inc.
Source of supply - Columbia Gas Transmission Corporation
Size of transmission mains - 10 and 20 inches (supplier);
3 and 4 inches (distributor)
Distribution mains - 2 inches through 8 inches
Distribution pressure - Intermediate (6 ounces to 42 psi)
Btu content - 1,050 per cubic foot
Specific gravity - 0.065
For rates and supplies contact:

Utilization Representative
Columbia Gas of Kentucky, Inc.
1733 Winchester Avenue
Ashland, Kentucky 41101
(606) 324-7114

Other Fuels

Propane (Within 35 miles)

Buckeye Gas Company
Route 2, Box 288
Catlettsburg, Kentucky 41129

Hardware Charlie Gas Company
P. O. Box 590
Paintsville, Kentucky 41240

Dry's Bottle Gas Service
Mayo Trail
Louisa, Kentucky 41230

Fuel oils

Distillate fuel oil -

Ashland Oil and Refining Company
330 Company, Inc.
Louisa, Kentucky 41230

Wheeler and Clevenger Oil P. O. Box
Main Cross
Louisa, Kentucky 41230

Residual fuel oil - Arrangements must be made with the refinery.

Low sulphur content coal - Available locally.

WATER AND SEWERAGE

Public Water Supply

Company serving Louisa - City of Louisa
 Board of Water and Sewer Commission
 P. O. Box 608
 Louisa, Kentucky 41230
 (606) 638-9322 or 638-4500

Source - Levisa Fork of the Big Sandy River
 Treatment plant capacity - 1,300,000 gallons per day
 Average daily consumption - 400,000 gallons
 Peak daily consumption - 600,000 gallons
 Type treatment - Clarification, coagulation, filtration, fluoridation,
 sedimentation
 Storage capacity - 1,257,000 gallons
 Size lines - 12, 10, 8, 6, 4 and 3 inches
 Average pressure - 65 psi
 Average temperature - 55 degrees F.

MONTHLY WATER RATES

Inside City Limits

5/8 - 3/4-inch meter	First	1,000 gals.	\$ 5.30	Minimum
1-inch meter	First	5,000 gals.	12.10	Minimum
1 1/4-inch meter	First	8,000 gals.	18.25	Minimum
1 1/2-inch meter	First	12,000 gals.	22.00	Minimum
2-inch meter	First	20,000 gals.	30.60	Minimum
3-inch meter	First	50,000 gals.	49.60	Minimum
	Next	50,000 gals.	.50	per M gals.
	Next	100,000 gals.	.45	per M gals.
	Over	200,000 gals.	.40	per M gals.
4-inch meter	First	85,000 gals.	67.10	Minimum
	Next	15,000 gals.	.50	per M gals.
	Next	100,000 gals.	.45	per M gals.
	Over	200,000 gals.	.40	per M gals.
6-inch meter	First	190,000 gals.	115.10	Minimum
	Next	10,000 gals.	.45	per M gals.
	Over	200,000 gals.	.40	per M gals.
8-inch meter	First	350,000 gals.	179.60	
	Over	350,000 gals.	.40	per M gals.

(Contd.)

Outside City Limits

5/8 - 3/4-inch meter	First	1,000 gals.	\$ 6.65 Minimum
1-inch meter	First	5,000 gals.	15.05 Minimum
1 1/4-inch meter	First	8,000 gals.	20.75 Minimum
1 1/2-inch meter	First	12,000 gals.	27.55 Minimum
2-inch meter	First	20,000 gals.	38.30 Minimum
3-inch meter	First	50,000 gals.	63.30 Minimum
	Next	50,000 gals.	.65 per M gals.
	Next	100,000 gals.	.55 per M gals.
	Over	200,000 gals.	.50 per M gals.
4-inch meter	First	85,000 gals.	86.05 Minimum
	Next	15,000 gals.	.65 per M gals.
	Next	100,000 gals.	.55 per M gals.
	Over	200,000 gals.	.50 per M gals.
6-inch meter	First	190,000 gals.	145.30 Minimum
	Next	10,000 gals.	.55 per M gals.
	Over	200,000 gals.	.50 per M gals.
8-inch meter	First	350,000 gals.	225.80 Minimum
	Over	350,000 gals.	.50 per M gals.
Tap-on charge:	Inside city		\$250
	Outside city		400

Raw Water

Surface water sources - Big Sandy River and Levisa Fork

Average discharge - Levisa Fork at Paintsville, Kentucky - 2,515 cfs (52 years, USGS, unadjusted)

Expected ground water yield - 50 to 200 gpm over central portion of county; 5 to 50 gpm over northern and southeastern sections.

Sewerage

Company serving Louisa - City of Louisa
Board of Water and Sewer Commission*
P. O. Box 608
Louisa, Kentucky 41230
(606) 638-9322 or 638-4500

Design capacity - 300,000 gallons per day

Average daily flow - At capacity

Treatment - Primary and secondary

Type treatment - Aeration, clarification and sludge drying beds

Treated effluent discharged into - Big Sandy River

Size of sanitary mains - 15, 12, 10, 8, 6 and 4 inches

Size of storm mains - Up to 24 inches

Rates - Inside city - 100 percent of monthly water bill

Outside city - 150 percent of monthly water bill

Tap-on charge:

Inside city - \$250

Outside city - \$400

*The Louisa Board of Water and Sewer Commission has improvements planned for its sewerage system which will commence in late summer of 1982. The \$2,311,000 project will increase the treatment plant capacity to 1,090,000 gallons per day; provide for the renovation of one lift station and allow for laying of 2,000 feet of interceptor lines. Completion date is approximately one year from the beginning of the project.

CLIMATE

Lawrence County

Temperature

Normal (30-year record)	54.6 degrees
Average annual 1980	52.7 degrees
Record highest, August 1918 (92-year record)	106.0 degrees
Record lowest, February 1899 (92-year record)	-27.0 degrees
Normal heating degree days (30-year record)	4,817
(Heating degree day totals are the sums of negative departures of average daily temperatures from 65 degrees F.)	

Precipitation

Normal (30-year record)	38.44 inches
Mean annual snowfall (93-year record)	24.60 inches
Total precipitation 1980	37.35 inches
Mean number days precipitation (.01 inch or more) (92-year record)	141
Mean number days thunderstorms (76-year record)	44

Prevailing Winds

N/A

Relative Humidity

1 a.m.	N/A
7 a.m.	80 percent (60-year record)
1 p.m.	56 percent (31-year record)
7 p.m.	68 percent (60-year record)

Source: U.S. Department of Commerce, Environmental Science Services Administration, Climatological Data, 1980. Station of record: Parkersburg, West Virginia.

LOCAL GOVERNMENT

City

Structure - Mayor - 4-year term; 6 council members - 2-year terms
Budget 1982 - General Fund \$ 70,000.00 (proposed)
 Water and Sewer Fund 415,526.00
Fees and licenses - Occupational licenses: \$20 to \$95 annually; unloading
 licenses: \$30 annually; city auto sticker: \$10 annually

County

Structure - County Judge/Executive - 4-year term; 4 magistrates - 4-year terms
Budget 1981-82 - General Fund \$482,887; Road Fund \$378,924

Assessed Value of Property, 1981

<u>Classes of Property</u>	<u>Louisa</u>	<u>Lawrence County</u>
Real Estate and Tangibles	\$47,320,000	
Real Estate		\$72,953,942
Tangibles		31,270,756

Property Taxes

All property in Kentucky is assessed at 100 percent of fair cash value.

Land and buildings are taxed by the state and may be taxed by local jurisdictions. The state rate is \$0.229 per \$100 of assessed valuation.

Manufacturing machinery, raw materials inventories, pollution control equipment, and goods in the process of manufacture are not subject to local taxation. The state rate is \$0.15 per \$100.

Other tangible personal property owned by manufacturers (automobiles, trucks, finished goods, office furniture, office equipment) is taxed by the state at \$0.45 per \$100 and may be taxed by local jurisdictions.

Property stored in public warehouses in a transit status is not subject to local taxation. The state rate is only \$0.015 per \$100.

Intangible personal property located in Kentucky (money in hand, shares of stock, notes, bonds, accounts receivable, and other credits) is taxed by the state at \$0.25 per \$100, and is not subject to local taxation.

Private leaseholds in industrial facilities owned by cities or counties and financed by industrial revenue bonds are subject to a state tax of \$0.015 per \$100 of value (essentially the lessee's equity, adjusted for appreciation or depreciation). Local taxation is not permitted.

Combined State and Local Rates Per \$100 Valuation, 1981*
(100% assessment)

	<u>Inside City of Louisa</u>	<u>Outside City</u>
1. Land and buildings	\$ 0.8262	\$ 0.6262
2. Mfg. machinery, raw materials, goods in process, pollution control equipment	0.1500	0.1500
3. Finished goods, office equipment, vehicles, other tangibles	1.0472	0.8472
4. Intangibles (accounts receivable, notes, bonds, etc.)	0.2500	0.2500
5. Leaseholds in industrial revenue bond financed plants	0.0150	0.0150

Planning and Zoning

Joint agency - The Lawrence/Louisa Planning Commission is presently inactive.
Mandatory state codes enforced - Kentucky Plumbing Code, National Electric Code, Kentucky Boiler Regulations and Standards, National Fire Protection Association Standards of Safety (for buildings with an occupancy of less than 100 persons), Kentucky Building code (modeled after BOCA code and applying to buildings with an occupancy of 100 or more persons)

Safety

<u>Police</u>	<u>Louisa</u>	<u>Lawrence County</u>
Total staff	3	6
Radio-patrol cars	2	3
 <u>Fire</u>		
American Insurance Association Fire Rating	7**	10
Volunteers	17	

* Kentucky Department of Economic Development.

** With efforts to improve fire protection within Louisa, the city has purchased a 1,000-gallon pumper fire engine. In addition, 30 fire plugs have been installed and 10,000 feet of 10-, 8- and 6-inch water mains extended from the present system. The result has been a lowered insurance rating from 9 to 7.

Rescue Service

Louisa Rescue Squad:

Number of volunteers - 17

Equipment - Rescue truck, "Jaws of Life", boat, 500-gallon pumper tank

Personnel training - Fire service; 2 volunteers with emergency medical training

Refuse Collection and Disposal

	<u>Louisa</u>
Type service	Municipal
Fee charged:	
residential	Inside city: \$5 per month Outside city: \$6 per month*
business	Negotiated
industrial	Negotiated
Collection frequency:	
residential	Weekly
business	Negotiated
industrial	Negotiated
Trash pickup	Included with refuse
Disposal method	County landfill

*Refuse collection outside of the city limits is provided to customers of the Louisa water department only.

EDUCATION

Public Schools

Lawrence County

Total Enrollment (Winter, 1981)	2,978
Elementary	1,471
Middle School	690
High School	817
Student-Teacher Ratio	19-1*
Elementary	24-1
Middle School	18-1
High School	19-1
Percent High School Graduates to College (1981)	31.7
Expenditures Per Pupil (1980-81)	\$1,217.37
Bonded Indebtedness (June 30, 1981)	\$4,479,000

*Includes 12 itinerant teachers.

Area Colleges and Universities

<u>Name</u>	<u>Location (Miles distant)</u>	<u>Enrollment (Fall, 1981)</u>	<u>Highest Degree Conferred</u>
Ashland Community College	Ashland, Kentucky (33)	1,572	Associate
Marshall University	Huntington, West Virginia (34)	11,846	Academic and Professional
Prestonsburg Community College	Prestonsburg, Kentucky (44)	824	Associate
Pikeville College	Pikeville, Kentucky (71)	650	Baccalaureate, Masters*
Morehead State University	Morehead, Kentucky (75)	6,739	Masters, Specialists/ Doctorate**
University of Charleston	Charleston, West Virginia (84)	2,122	Baccalaureate

* Courses in the masters degree programs are taught on the Pikeville campus by faculty members of Pikeville College and Morehead State University. The degrees are issued by Morehead State University.

** Joint doctoral degree programs are offered in cooperation with the University of Kentucky, Lexington.

Vocational Schools

Both the state vocational-technical schools and the area vocational education centers are operated by the Kentucky Department of Education. The state vocational-technical schools enroll persons full time who are at least 16 years of age and not in school. These students attend classes for six hours each day. The area vocational education centers are designed to accommodate high school students who are at least 15 years of age. These students attend vocational school for three hours each day. The state vocational-technical schools and the area education centers offer evening courses to enable working adults to upgrade current job skills.

Nearest State Schools

Location	Mayo State Vocational- Technical School
Miles Distant	Paintsville 31
Curriculum	Business and Office Accounting/Jr. Management Clerical Court and Conference Reporter Data Processing Secretarial (Legal and Medical) Consumer and Home Economics Consumer and Family Life Skills Health and Personal Services Occupations Cosmetology Nursing Aide Practical Nursing Industrial Education Auto Body Repair Auto Mechanics Carpentry-Building Trades Diesel and Heavy Equipment Maintenance and Repair Drafting (Mechanical) Drafting (Technical) Electronic Communications Graphic Arts (Printing) Highway Technology Industrial Electricity Industrial Electronics Machine Shop Mining Maintenance Mechanics Radio and Television Repair Refrigeration, Air Conditioning and Heating Welding Learning Resource Center

Location	Ashland State Vocational- Technical School
Miles Distant	Ashland 33
Curriculum	Business and Office Clerical Secretarial-Stenographic Consumer and Home Economics Child Care Commercial Foods Health and Personal Services Occupations Cosmetology Nurse Assistant Practical Nursing Industrial Education Auto Body Repair Auto Mechanics Carpentry-Building Trades Drafting Industrial Electricity Industrial Electronics Machine Shop Radio and Television Repair Tool and Die Making Welding

Nearest Area Education Center

Location	Martin County Area Vocational Education Center
Miles Distant	Inez 25
Curriculum	Business and Office Clerical Secretarial Industrial Education Auto Mechanics Carpentry Industrial Electricity Mine Careers

Arrangements can be made to provide training in the specific production skills required by an industrial plant. Instruction may be conducted either in the vocational school or in the industrial plant, depending upon the desired arrangement and the availability of special equipment.

High School Vocational Education Program

The Lawrence County High School Vocational Education Department offers Agri-Business, Auto Mechanics, Carpentry, Distributive Education, Health Careers, Business and Office Program, Home Economics, and Industrial Arts.

HEALTH

Local Medical Personnel

Physicians - 10
Dentists - 5

Hospitals

<u>General Hospital</u>	<u>Location</u>	<u>Beds</u>
Louisa Community Hospital*	Louisa	90 (acute)

General hospital facilities - Emergency room, labor and delivery rooms, operating room, 15-bassinet nursery, respiratory therapy, physical therapy, EKG department, medical surgery, cysto room, recovery room, anesthesia room, X-ray department, laboratory, blood bank, pharmacy, pulmonary laboratory

Medical staff - 17 active general practitioners (including 2 general surgeons, 1 cardiologist, 1 OB/GYN, 1 internist, 1 urologist, 1 orthopedic surgeon), 31 registered nurses, 34 licensed practical nurses and a support staff of 175

Other Medical Facilities

Lawrence County Mental Health-Mental Retardation (a part of Lansdowne Comprehensive Care Center)

Medical staff - Mental health coordinator, psychiatrist, psychologist, child psychologist, psychiatric nurse, alcohol outreach worker, retardation family counselor, registered nurse, developmental disability teacher, 2 aides, recreational director, substance abuse coordinator

Louisa Medical Clinic

Facilities - Emergency room, X-ray room, laboratory
Medical staff - 4 doctors, 1 registered nurse, 2 licensed practical nurses, 1 licensed laboratory technician

Riverview Medical Clinic

Facilities - Emergency room, X-ray room, laboratory, pharmacy adjacent to clinic
Medical staff - 3 doctors, 1 licensed practical nurse

*The Louisa Community Hospital is offering new services and equipment to improve patient care. New equipment installed provides for cardiovascular and internal examination, telemetry monitoring and a multistat chemistry analyzer. New patient services are: ultrasound, cardiovascular ultrasound, electroencephalograph and orthopedic surgery. Patient education is provided by cassette and television monitors. Public instruction in cardiopulmonary resuscitation and prenatal care is provided without charge.

Ambulance Service

Name - Wellman Ambulance Service

Staff - 3 nurses, 20 emergency medical technicians

Service - 24-hour

Equipment - 3 ambulances

Public Health

Facility - Lawrence County Health Center

Staff - Administrator, 2 registered nurses, 1 community health worker for family planning, 1 environmentalist and 2 clerks

OTHER LOCAL FACILITIES

Communications

Telephone - South Central Bell Telephone Company
Services - Standard

Telegraph - Western Union
Services - Toll-free number, 1-800-325-5100

Postal - U.S. Post Office
Class - First
Mail received - Once daily
Mail dispatched - Once daily

Newspapers - Big Sandy News
Weekly and circulation - 3,750
Other papers
received from - Ashland and Louisville, Kentucky; Huntington, West Virginia

Radio - WKY-AM
Major stations
received from - Louisville, Kentucky; Huntington, West Virginia

Television -
Cable Service
Reception from - Lexington, Kentucky; Huntington and Charleston, West Virginia; Atlanta, Georgia

Kentucky Educational
Television - WMUL, Huntington, West Virginia

Library Services

Public library - Lawrence County Public Library (Regional headquarters for FIVCO library district)
Size collection - 42,922 volumes
Circulation, 1979-80 - 99,087
Services - Microfilm, microfiche, films, paintings, records, vertical file, community meeting room, bookmobile, magazines, newspapers, film strips, reference, nursing home programs, day care programs, story hour, special education programs and Interlibrary Loans

Religious Institutions

Number of churches - 7

Denominations - Baptist
Christian
Church of Christ
Freewill Baptist
Jehovah's Witnesses
Southern Methodist
United Methodist

Nearest Synagogues - Ashland, 33 miles distant

Congregations - Agudath Achim (reform)

Financial Institutions

<u>Banks</u>	<u>Assets</u>	<u>Deposits</u>	<u>Statement Date</u>
The First National Bank	\$27,486,000.00	\$24,581,000.00	12/31/80
Peoples Security Bank	11,732,311.06	10,731,430.43	6/30/81
<u>Savings and Loan Associations</u>	<u>Assets</u>	<u>Savings Accounts</u>	<u>Statement Date</u>
First Federal Savings and Loan Association of Louisa	\$ 6,614,637.36	\$ 6,221,436.76	12/31/80

Hotels and Motels

Total number - 2
Total rooms - 49

Clubs and Organizations

Athletic Boosters	Little League baseball
Boy Scouts	Little League basketball
Eastern Star	Little League football
Farm Bureau	Masonic Lodge
4-H	Odd Fellows
Future Farmers of America (FFA)	Parent-Teacher Association
Girl Scouts	Pony League baseball
Greater Louisa Industrial Foundation	Rotary Club
Jaycees	Rotary Ann
Junior Women's Club	Women's Club

RECREATION

Local

Development of the 14-acre Chapman Park at Louisa has been completed. The family-oriented park features equipped playgrounds, a picnic area, a shelter house, restrooms, a baseball/softball diamond and tennis courts.

Other recreational facilities include a downtown minipark, equipped with benches for old-fashioned "people watching," two public parks, one playground, one swimming pool, four tennis courts and two football fields. In addition, there is one private skating rink.

Area (Within 60 miles)

Ashland, located 33 miles north of Louisa, provides facilities for recreational and cultural events.

The Paramount Arts Center which is owned and operated by the Greater Ashland Foundation, a non-profit group, is the site of many cultural events. Subscription series featuring plays, symphony concerts, and ballets are available at the Arts Center as well as individual events. Recent offerings have included a youth education series, a women's series, the Atlanta Symphony, and the Joffrey Ballet. Groups may rent the building for conventions and performances.

Development of the 141-acre Appalachian Cultural Park is nearing completion. The park will house a 750-seat amphitheatre to revive Jean Thomas' American Folk Song Festival and to accommodate other music and drama performances. Jean Thomas' "Wee House In The Woods" and the Caney School where Jesse Stuart taught will be relocated in the park. An 18,000-square-foot Convention Center is being built. The "Wee House In The Woods" is being developed as a museum and research center for Appalachian Culture.

The first Tri-State Fair and Regatta was held in 1978 and has since become an annual event. Fair activities are held over a three week period for one week each in Ashland, Kentucky; the Huntington, West Virginia area; and the Ironton, Ohio area. Events include a Valvoline speed cup boat race, flotilla, a float boat race, sternwheeler rides, air shows, balloon races, fairs, horse shows, exhibitions, musical productions, arts and crafts shows, and a national cycling classic.

Jenny Wiley State Resort Park, 44 miles south of Louisa at Prestonsburg, takes full advantage of its picturesque highland setting. The 1,700-acre park offers facilities and activities such as a lodge, a dining room, a gift shop, cottages, a lodge pool, recreation rooms, primitive campsites, picnic areas, planned recreation, playground, golf, hiking, horseback riding, shuffleboard, fishing, and fishing boat and pedal boat rentals.

Grayson Lake State Park is located 48 miles northwest of Louisa near Grayson. Facilities available include 71 campsites, a beach, and picnic area. Good fishing and organized recreational programs can be found during the summer. The park is located in the 7,350-acre Grayson Lake Wildlife Area. Hunting information is available from the Kentucky Department of Fish and Wildlife Resources. The Rosedale Recreation Area, located near a dam on Grayson Lake, includes Kitchen House, a log house circa 1838 which was the scene of a Civil War skirmish. The nearby Camp Webb Conservation Center has a wildlife museum.

Carter Caves State Resort Park, 60 miles northwest of Louisa, provides a restful atmosphere with its mountain wildflowers, a rippling stream, the underground wonders of three caves, a lodge, a restaurant, and a gift shop. Recreational facilities available include something for the whole family with playgrounds, a swimming pool, tennis courts, shuffleboard, a 9-hole golf course, boating, fishing, horseback riding, picnicking, and cave tours.

Greenbo Lake State Resort Park, which is located 60 miles north of Louisa, has a magnificent fieldstone lodge and every article in each room of the lodge has been made in Kentucky. The lodge offers 36 lodge rooms, a dining room, a gift shop, a meeting room, a lodge pool, and a recreation room. Other facilities and activities at the park include a well-equipped campground, a marina, miniature golf, tennis courts, playgrounds, shuffleboard, planned recreation, fishing, hiking, horseback riding, and picnicking.