

1989

# Industrial Resources: Madison County - Richmond

Kentucky Library Research Collection  
Western Kentucky University, [spcol@wku.edu](mailto:spcol@wku.edu)

Follow this and additional works at: [https://digitalcommons.wku.edu/madison\\_cty](https://digitalcommons.wku.edu/madison_cty)



Part of the [Business Administration, Management, and Operations Commons](#), [Growth and Development Commons](#), and the [Infrastructure Commons](#)

---

## Recommended Citation

Kentucky Library Research Collection, "Industrial Resources: Madison County - Richmond" (1989). *Madison County*. Paper 11.  
[https://digitalcommons.wku.edu/madison\\_cty/11](https://digitalcommons.wku.edu/madison_cty/11)

This Report is brought to you for free and open access by TopSCHOLAR®. It has been accepted for inclusion in Madison County by an authorized administrator of TopSCHOLAR®. For more information, please contact [topscholar@wku.edu](mailto:topscholar@wku.edu).



## RESOURCES FOR ECONOMIC DEVELOPMENT

---

# Richmond



---

**KENTUCKY**

Open for Business



## RICHMOND TECHNOLOGY PARK

### Site 189 - 4 Acres

LOCATION: Within northwestern city limits

ZONING: Industrial (I-2)

HIGHWAY ACCESS: Interstate 75 interchange approximately 0.6 mile north via Keeneland Drive and US 25/421

RAILROAD: Not rail served

WATER: Richmond Utilities

Size Line: 18-inch line approximately 200 feet along east side of Keeneland Drive

SEWERAGE: Richmond Utilities

Size Line: 12-inch line adjacent to eastern boundary

NATURAL GAS: Richmond Utilities

Size Line: 6-inch line adjacent to eastern boundary

ELECTRICITY: Kentucky Utilities Company

OWNERSHIP: City of Richmond

SCHOOL DISTRICT: Madison County

## RICHMOND, KENTUCKY Industrial Sites

For more information contact the Cabinet for Economic Development, Department of Existing Business and Industry, Division of Research and Planning, Capital Plaza Tower, Frankfort, Kentucky 40601 (502-564-7140)

### Existing Industries

- A Sembol Systems
- B KoKoKu Rubber Co., Inc.
- C Electronic Assembly Inc.
- D North American Phillips Lighting Corp.
- E Blue Grass Plating
- F National Metal Processing Inc.
- G Irvin Industries  
Metal Stamping Division
- H Uncle Charles Sausage Co.
- I American Greeting (Distribution)
- J Rand McNally and Co.
- K Beatrice Ice Cream and Novelties
- L Lector dryer Division  
Ajax Magnathermic Corp.
- M Available Industrial Building (104,000 sq. ft.)
- N Exide Company
- O Available Industrial Building (90,885 sq. ft.)
- P Sherwin Williams Company
- Q Concrete Materials Corporation
- R The Okonite Company

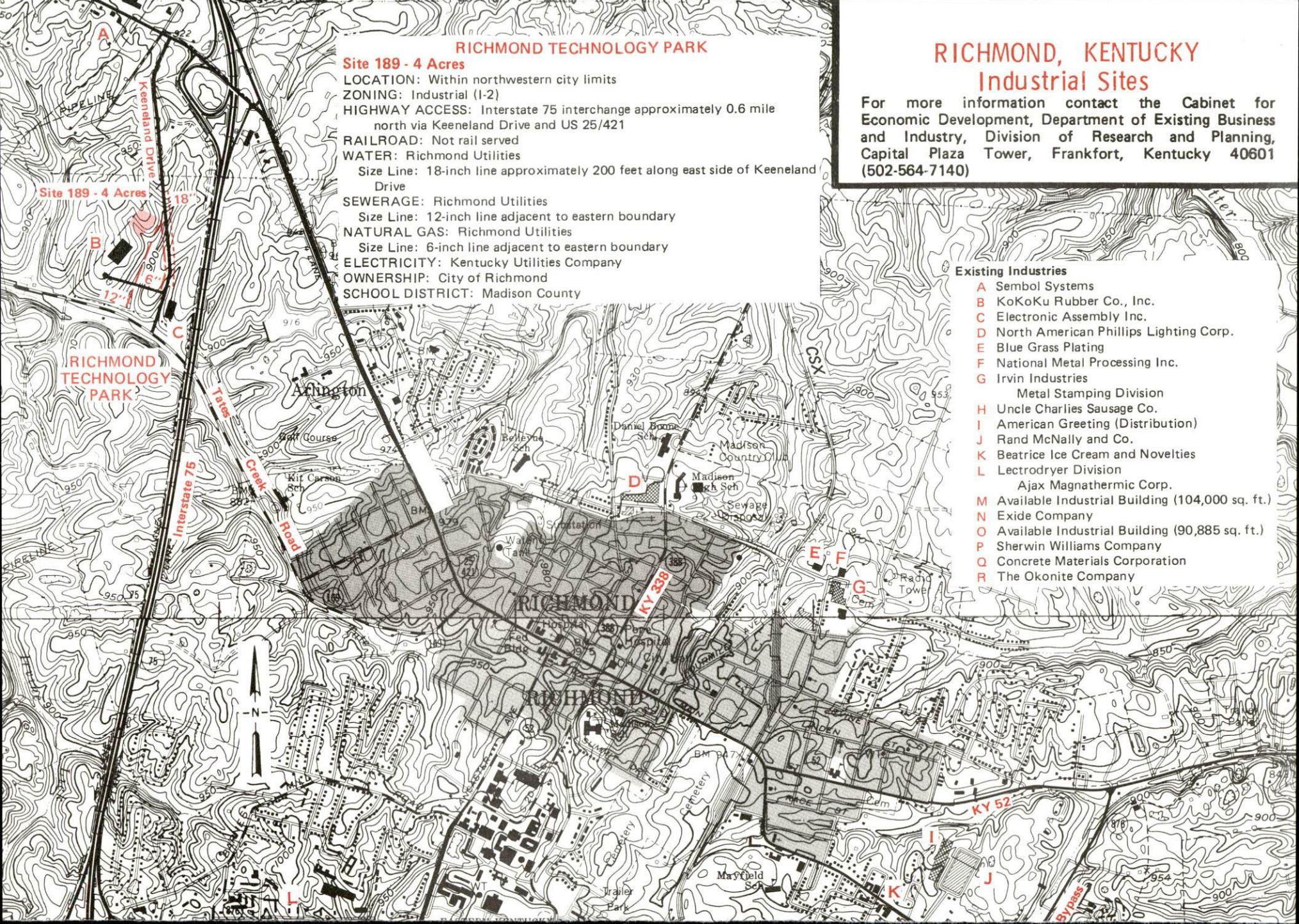



### Site 289 - 56.7 Acres

LOCATION: Partially within southern city limits

ZONING: Tract I - Industrial (I-2); Tracts II & III - Not zoned

HIGHWAY ACCESS: KY 876 (Richmond Bypass) approximately 0.3 mile north via Boggs Lane; Interstate 75 interchange approximately 2.3 miles west via Boggs Lane and KY 876

RAILROAD: CSX 200 feet from northeast corner; spur location graded to site

WATER: Richmond Utilities

Size Line: 16-inch line approximately 100 feet northeast of Tract I;

8-inch line along access road

SEWERAGE: Richmond Utilities

Size Line: 15-inch line approximately 100 feet northeast of Tract I;

6-inch line adjacent to eastern boundary of Tract I

NATURAL GAS: Richmond Utilities

Size Line: 6-inch line approximately 100 feet northeast of Tract I

ELECTRICITY: Kentucky Utilities Company

OWNERSHIP: Private

SCHOOL DISTRICT: Madison County

### RICHMOND INDUSTRIAL PARK

### Site 389 - 170 Acres

LOCATION: Within southeastern city limits

ZONING: Industrial (I-2)

HIGHWAY ACCESS: US 25/421 approximately 0.3 mile east via Duncannon Road; Interstate 75 interchange approximately 5.3 miles northwest via US 25/421 and KY 876

RAILROAD: CSX adjacent to eastern boundary

WATER: Richmond Utilities

Size Line: Industrial capacity water line to be furnished by City of Richmond

SEWERAGE: Richmond Utilities

Size Line: Industrial capacity sewer line to be furnished by City of Richmond

NATURAL GAS: Richmond Utilities

Size Line: Industrial capacity gas line to be provided by City of Richmond

ELECTRICITY: Kentucky Utilities Company and Bluegrass RECC

OWNERSHIP: Richmond/Madison County Industrial Corporation

SCHOOL DISTRICT: Madison County

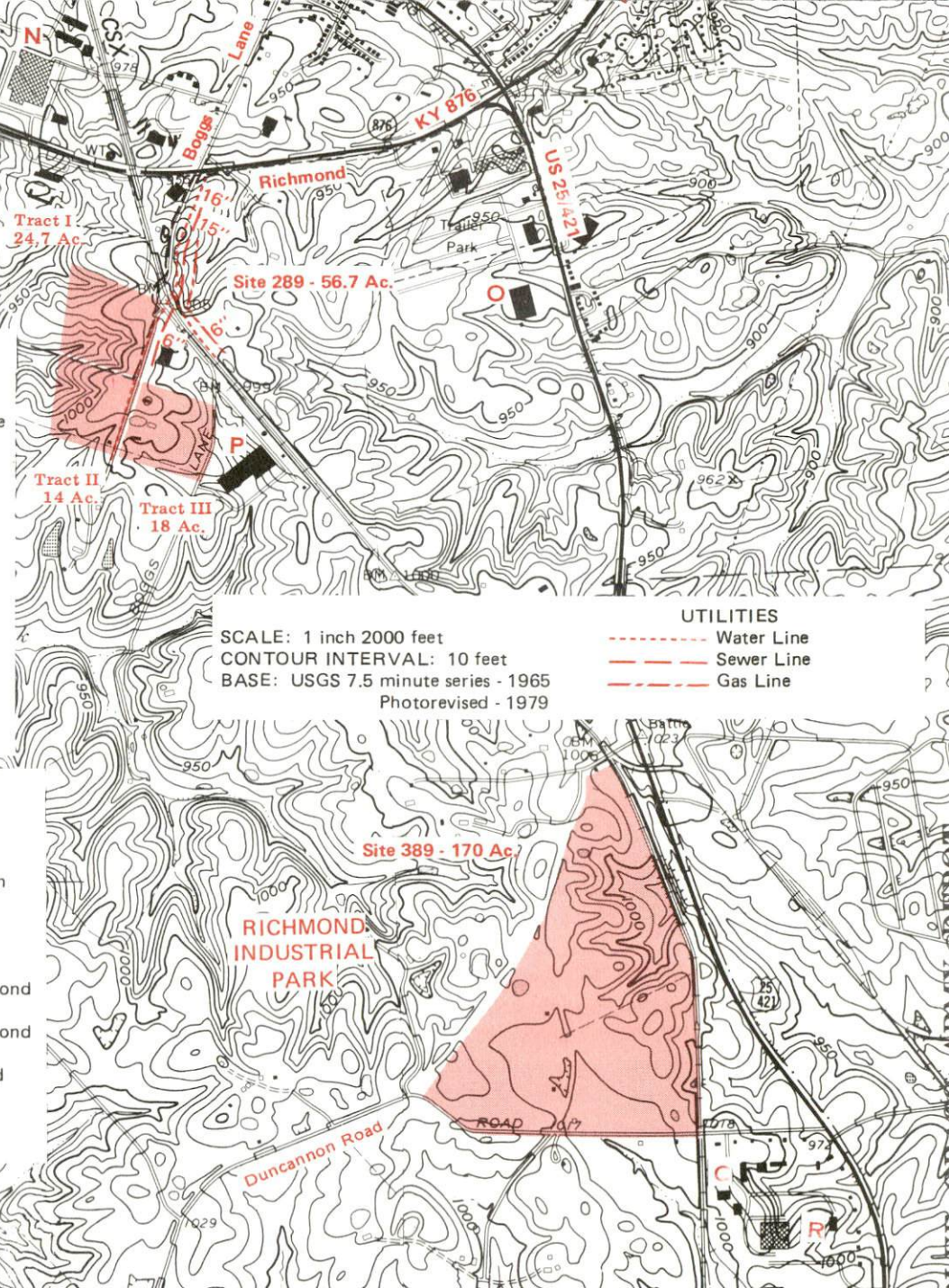



RESOURCES FOR ECONOMIC DEVELOPMENT

RICHMOND, KENTUCKY

Prepared by  
The Kentucky Department of Business Development  
Division of Research and Planning  
in cooperation with  
The Richmond Chamber of Commerce  
and  
The Richmond-Madison County Industrial Corporation, Inc.

1989



## TABLE OF CONTENTS

<u>Chapter</u>	<u>Page</u>
INDUSTRIAL SITES . . . . .	i
RICHMOND, KENTUCKY - A RESOURCE PROFILE . . . . .	1
THE LABOR MARKET STATISTICS . . . . .	2
Labor Market Area Map . . . . .	2
Population . . . . .	3
Population Projections . . . . .	3
Unemployment Rates, 1980-1987 - Line Chart . . . . .	4
Labor Force Characteristics of Residents, 1987 . . . . .	5
Selected Components of Nonagricultural Employment, by Place of Work, 1987 . . . . .	5
Estimated Male Labor Supply . . . . .	6
Estimated Female Labor Supply . . . . .	6
Average Placement Wages . . . . .	7
Per Capita Personal Income . . . . .	7
Average Weekly Wages of Workers Covered by Unemployment Insurance F.Y. 1986-87 - Bar Chart . . . . .	8
Average Weekly Wages by Industry, by Place of Work, 1987 . . . . .	9
EXISTING INDUSTRY . . . . .	10
Major Richmond Manufacturing Firms, Their Products and Employment . . . . .	10
Recent Industrial Developments . . . . .	11
Labor Organizations in Manufacturing Firms . . . . .	12
Selected Industrial Services . . . . .	12
TRANSPORTATION . . . . .	13
Rail . . . . .	13
Highways . . . . .	13
Truck Service . . . . .	13
Air . . . . .	14
Air Express Service . . . . .	15
Water . . . . .	15
POWER AND FUEL . . . . .	16
Electricity . . . . .	16
Natural Gas . . . . .	17
WATER AND SEWERAGE . . . . .	18
Public Water Supply . . . . .	18
Sewerage . . . . .	19



<u>Chapter</u>	<u>Page</u>
CLIMATE . . . . .	20
LOCAL GOVERNMENT . . . . .	21
Structure . . . . .	21
Planning and Zoning . . . . .	21
Local Fees and Licenses . . . . .	21
State and Local Property Taxes . . . . .	22
Combined State and Local Rates Per \$100 Valuation, 1988 . . . . .	22
Safety . . . . .	23
Police . . . . .	23
Fire . . . . .	23
Rescue Service . . . . .	23
Refuse Collection and Disposal . . . . .	23
EDUCATION . . . . .	24
Public Schools . . . . .	24
Nonpublic Schools . . . . .	24
Area Colleges and Universities . . . . .	25
Vocational Training . . . . .	26
HEALTH . . . . .	28
Local Medical Personnel . . . . .	28
Hospitals . . . . .	28
Other Medical Facilities . . . . .	28
Ambulance Service . . . . .	28
OTHER LOCAL FACILITIES . . . . .	29
Communications . . . . .	29
Library Services . . . . .	29
Religious Institutions . . . . .	29
Financial Institutions . . . . .	30
Hotels and Motels . . . . .	30
RECREATION . . . . .	31
COMMUNITY IMPROVEMENTS . . . . .	35



GENERAL HIGHWAY MAP  
**MADISON COUNTY**  
KENTUCKY

PREPARED BY THE  
KENTUCKY TRANSPORTATION CABINET  
DEPARTMENT OF HIGHWAYS  
DIVISION OF PLANNING  
IN COOPERATION WITH THE  
U.S. DEPARTMENT OF TRANSPORTATION  
FEDERAL HIGHWAY ADMINISTRATION

0 1 2 3 4 5 6 MILES

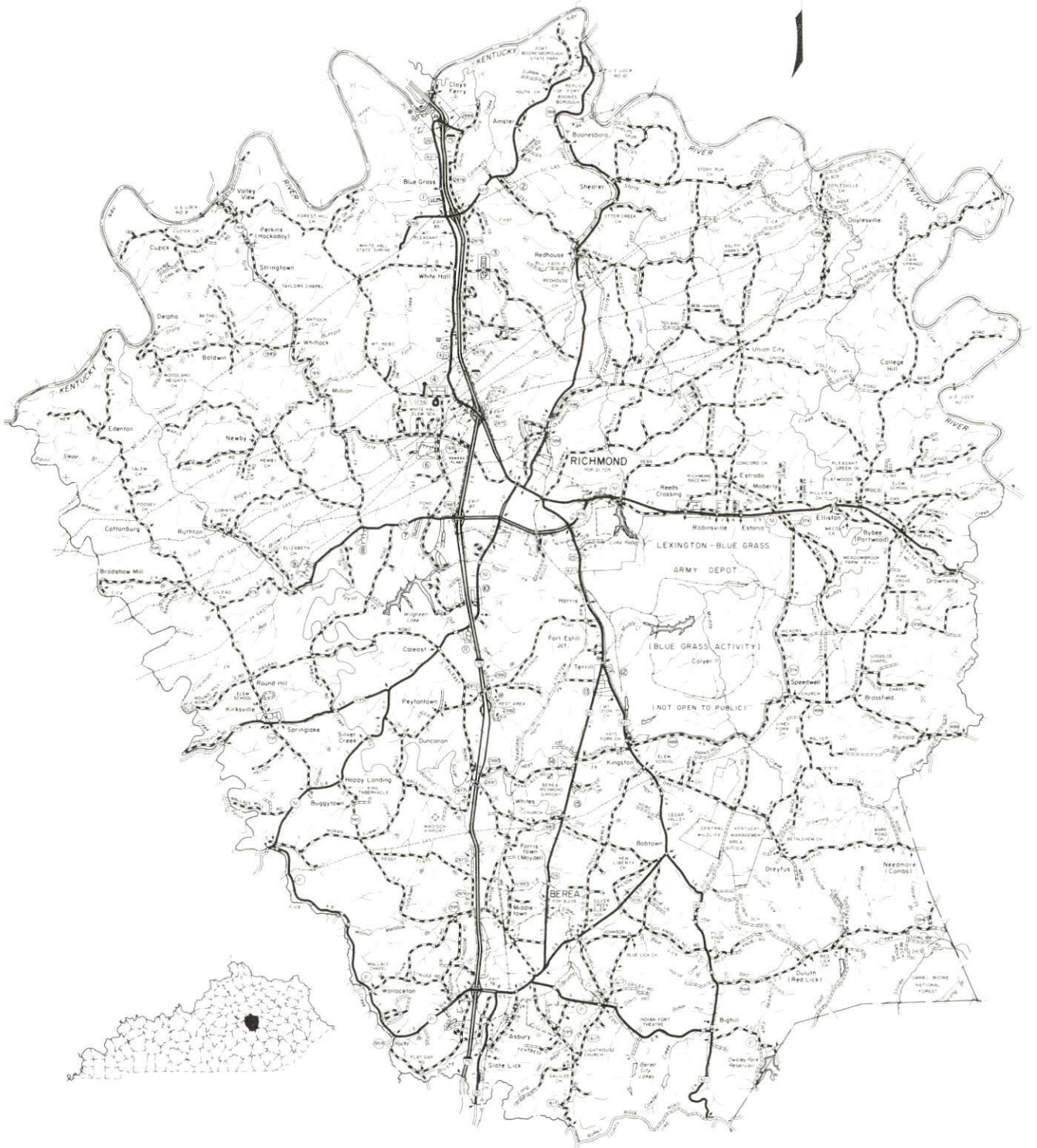



## **RICHMOND, KENTUCKY - A RESOURCE PROFILE**

Richmond, the home of Eastern Kentucky University, is situated in central Kentucky's Blue Grass Region and is the county seat of Madison County. Richmond is located 25 miles southeast of Lexington, Kentucky; 103 miles south of Cincinnati, Ohio; and 146 miles north of Knoxville, Tennessee.

Madison County covers a land area of 443 square miles and had a 1987 estimated population of 56,100 persons. Richmond had a 1986 estimated population of 23,380.

**The Economic Framework** - The total number of Madison County residents employed in 1987 averaged 25,510. Manufacturing firms in the county reported 3,790 employees; wholesale and retail trade provided 5,330 jobs; 3,230 people were employed in service occupations; state and local government accounted for 3,670 employees; and contract construction firms provided 465 jobs.

**Labor Supply** - There is a current estimated labor supply of 18,340 men and 21,700 women available for industrial jobs in the labor market area. In addition, from 1989 through 1993, 13,580 young men and 12,840 young women in the area will become 18 years of age and potentially available for industrial jobs.

**Transportation** - CSX Transportation provides Richmond with main line rail freight service. Two interchanges of Interstate 75 serve Richmond, as do U.S. Highways 25 and 421, and Kentucky Routes 52 and 1295. There are 29 common carrier trucking companies with authority to provide interstate and/or intrastate service to Richmond. The nearest scheduled commercial airline service is available at Lexington, Kentucky's, Bluegrass Airport, 29 miles northwest of Richmond. The Madison Airport, 6 miles south of Richmond, maintains a 4,000-foot paved runway and offers charter service.

**Power and Fuel** - Kentucky Utilities Company provides electricity to Richmond and portions of Madison County. Madison County also receives electricity from Blue Grass Rural Electric Cooperative Corporation and Clark Rural Electric Cooperative Corporation. Richmond Utilities provides natural gas service to Richmond. Delta Natural Gas Company, Inc., also serves portions of Richmond and Madison County.

**Education** - The Madison County School System provides primary and secondary public education to city and county residents. Two nonpublic schools also operate in Richmond. Eastern Kentucky University, a public institution of higher learning, is located in Richmond, and had a Fall 1988 enrollment of 13,600 students. Vocational training is available at Madison County Area Vocational Education Center in Richmond, and at Central Kentucky State Vocational-Technical School in Lexington, 25 miles northwest of Richmond.



**RICHMOND LABOR MARKET AREA**  
**With**  
**MAJOR HIGHWAYS & RAILROAD SYSTEM**

Shaded area denotes Labor Market Area.

The map displays the Richmond Labor Market Area, shaded in gray, covering parts of several counties including Jefferson, Woodford, Madison, and others. Major highways (interstates and state routes) and railroad lines are shown throughout the region. County names are labeled, and major cities and towns are marked. A legend in the top right corner states: "Shaded area denotes Labor Market Area."



## LABOR MARKET STATISTICS

The Richmond Labor Market Area includes Madison County and the adjoining Kentucky counties of Clark, Estill, Fayette, Garrard, Jackson, Jessamine and Rockcastle.

### POPULATION

Area	1987*	1980	1970	Percent Nonwhite
				1980
Richmond	23,380	21,705	16,861	12.3
Labor Market Area	390,100	363,221	303,092	-
Madison County	56,100	53,352	42,730	6.8
Clark County	29,100	28,322	24,090	6.5
Estill County	14,900	14,495	12,752	0.2
Fayette County	221,500	204,165	174,323	14.5
Garrard County	11,500	10,853	9,457	5.5
Jackson County	12,500	11,996	10,005	0.1
Jessamine County	29,900	26,065	17,430	4.6
Rockcastle County	14,600	13,973	12,305	0.3

\* Population estimates. City estimates are for 1986.

Sources: U.S. Department of Commerce, Bureau of the Census, October 1988; University of Louisville, Urban Studies Center, Population Unit.

### POPULATION PROJECTIONS

Area	1990	1995	2000	2010
Labor Market Area	401,834	418,445	430,955	449,390
Madison County	56,391	57,588	58,506	59,502
Clark County	29,827	30,518	31,105	31,785
Estill County	15,589	16,203	16,769	17,639
Fayette County	228,481	238,160	244,932	255,038
Garrard County	12,134	12,749	13,187	13,743
Jackson County	13,440	14,380	15,195	16,525
Jessamine County	30,644	32,685	34,437	37,380
Rockcastle County	15,328	16,162	16,824	17,778

Source: University of Louisville, Urban Studies Center, State Data Center.



# UNEMPLOYMENT RATES

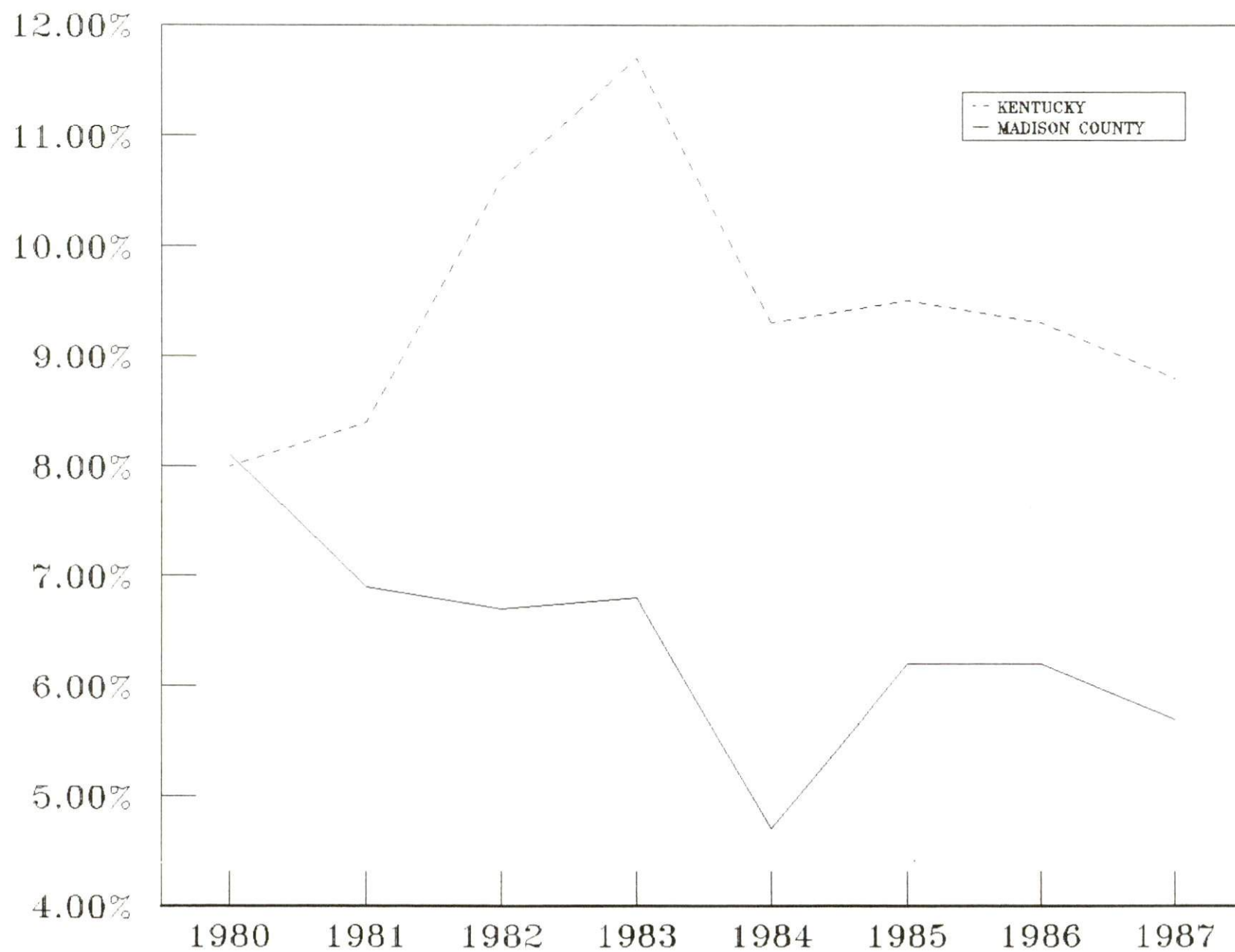



### LABOR FORCE CHARACTERISTICS OF RESIDENTS, 1987

	<u>Madison County</u>	<u>Labor Market Area</u>
Civilian Labor Force	27,041	197,476
Employment	25,511	186,029
Unemployment	1,530	11,447
Rate of Unemployment (%)	5.7	5.8

Source: Kentucky Cabinet for Human Resources, Kentucky Labor Force Estimates, Annual Averages, 1987.

### SELECTED COMPONENTS OF NONAGRICULTURAL EMPLOYMENT BY PLACE OF WORK, 1987

	<u>Madison County</u>	<u>Labor Market Area</u>
All Industries (total)	17,579	166,175
Manufacturing	3,787	27,748
Wholesale & Retail Trade	5,332	43,673
Services	3,234	36,755
State/Local Government	3,667	26,699
Contract Construction	465	9,696

Note: Excludes domestic workers, railway workers, certain nonprofit corporations, majority of federal government workers, and self-employed workers.

Source: Kentucky Cabinet for Human Resources, Average Monthly Workers Covered by Kentucky Unemployment Insurance Law, 1987.

### MADISON COUNTY

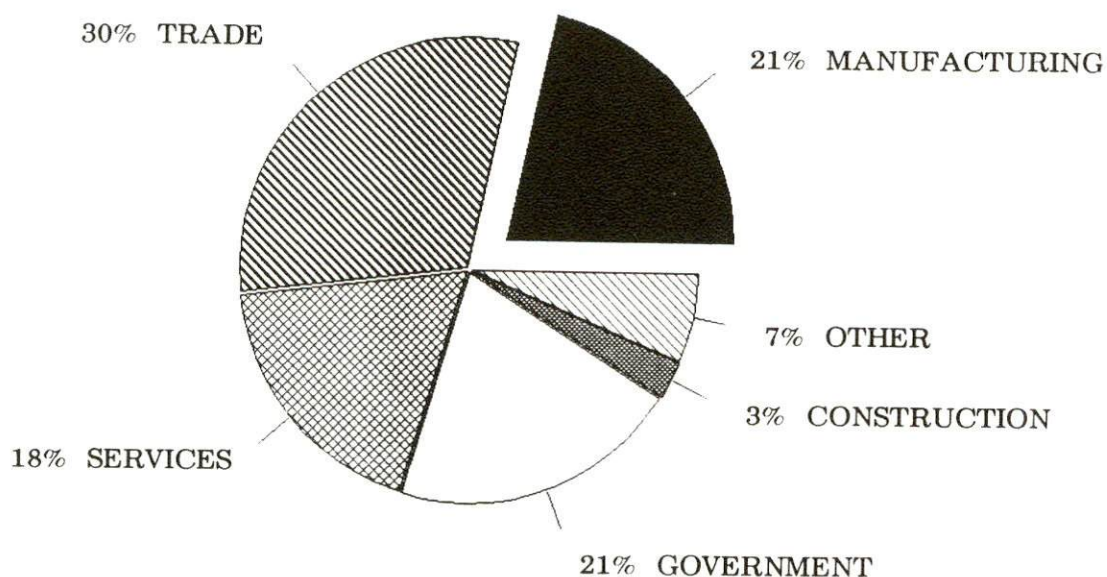



ESTIMATED MALE LABOR SUPPLY  
RICHMOND LABOR MARKET AREA

Area	Current				Future
	Total Male	Unemployed	Under-employed	Not in Labor Force	Becoming 18 years of age 1989 thru 1993
Labor Market Area*	18,340	6,301	10,365	1,674	13,579
Madison	2,542	789	1,753	0	1,826
Clark	1,137	619	518	0	1,237
Estill	1,773	471	436	866	621
Fayette	8,361	2,637	5,724	0	7,136
Garrard	840	353	287	200	427
Jackson	1,447	483	356	608	591
Jessamine	1,395	506	889	0	1,153
Rockcastle	845	443	402	0	588

ESTIMATED FEMALE LABOR SUPPLY  
RICHMOND LABOR MARKET AREA

Area	Current				Future
	Total Female	Unemployed	Under-employed	Not in Labor Force	Becoming 18 years of age 1989 thru 1993
Labor Market Area*	21,696	5,809	11,699	4,188	12,841
Madison	3,290	955	2,335	0	1,734
Clark	1,897	801	656	440	1,106
Estill	1,883	284	312	1,287	599
Fayette	9,322	2,525	6,797	0	6,838
Garrard	1,083	290	199	594	370
Jackson	1,631	229	176	1,226	527
Jessamine	1,426	394	1,032	0	1,052
Rockcastle	1,164	331	192	641	615

\* Additional workers may be drawn from other nearby counties.

Note: Unemployed - persons unemployed and actively seeking work; Underemployed - persons employed but working only 14 to 26 weeks per year; Not in Labor Force - represents the number of persons who would enter the labor force if suitable employment were available (based on the assumption that persons in Kentucky would like to participate in the labor force in the same proportion that they do nationally).

Sources: Kentucky Cabinet for Human Resources, Kentucky Labor Supply Estimates by County, 1986. Kentucky Department of Business Development, Future Labor Supply Becoming 18 Years of Age, 1989 thru 1993.



## AVERAGE PLACEMENT WAGES

Madison County is served by the Winchester local office of the Kentucky Department for Employment Services. The focus of the following data is on job placements made by the Winchester local office and may therefore be used as an indicator of the wages which employers in the area pay new employees. During the twelve months which ended on June 30, 1988, the local employment office filled 3,182 job openings in various occupational categories. The average hourly wage for selected occupational categories were:

<u>OCCUPATIONAL CATEGORY</u>	<u>NUMBER OF PLACEMENTS</u>	<u>AVERAGE WAGE(\$)</u>
All Occupations	3,182	3.82
Clerical	497	3.48
Sales	59	3.64
Services (excluding domestic)	271	3.28
Agricultural, Fishery, Forestry, etc.	19	3.93
Processing	24	6.20
Machine Trades	312	4.96
Bench Work	1,547	3.46
Structural	117	5.38
Motor Freight/ Transportation	45	5.65
Packaging and Materials Handling	247	4.52
Other	9	3.99

The Winchester local office also serves Clark, Estill and Powell Counties. The above occupational categories are taken from the Dictionary of Occupational Titles published by the U.S. Department of Labor.

**Source:** Kentucky Cabinet for Human Resources, Department for Employment Services.

## PER CAPITA PERSONAL INCOME

<u>Area</u>	<u>1982</u>	<u>1986</u>	<u>Percent Change</u>
Madison County	\$7,880	\$9,937	26.1
Labor Market Area Range	\$5,192 - 11,579	\$5,997 - 15,134	-
Kentucky	\$9,277	\$11,268	21.5
U.S.	\$11,480	\$14,606	27.2

**Sources:** Kentucky Economic Information System, April 1988 and August 1988.



AVERAGE WEEKLY WAGES OF WORKERS COVERED BY  
UNEMPLOYMENT INSURANCE F.Y. 1986-87

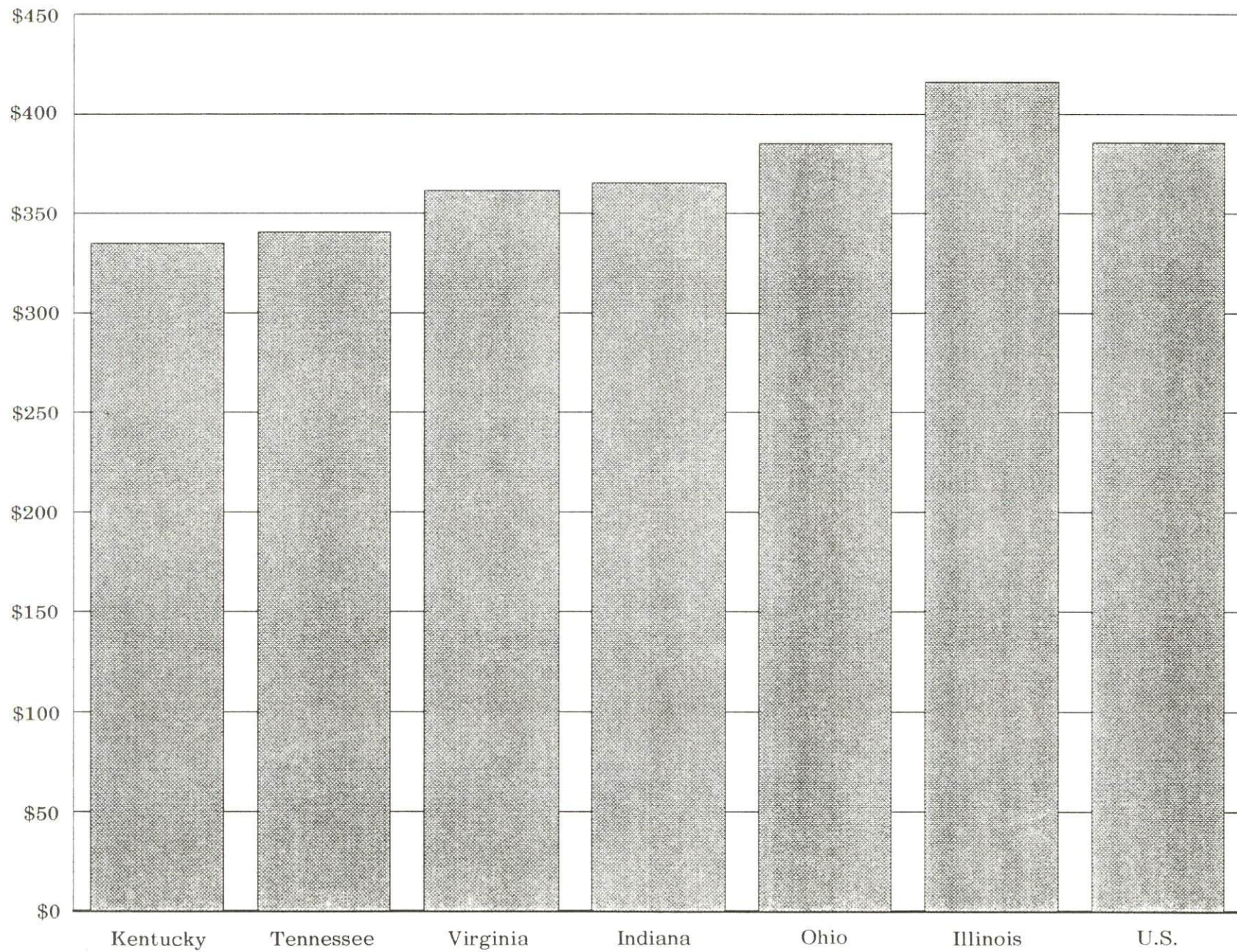



AVERAGE WEEKLY WAGES BY INDUSTRY  
BY PLACE OF WORK, 1987

	<u>Madison County</u>	<u>Clark County</u>	<u>Estill County</u>	<u>Fayette County</u>
All Industries	\$284.52	\$332.60	\$256.92	\$359.90
Mining & Quarrying	*	*	*	815.64
Contract Construction	293.62	397.65	160.10	366.79
Manufacturing	382.87	431.18	*	584.64
Transportation, Communications & Public Utilities	287.38	512.97	363.31	432.39
Wholesale & Retail Trade	178.29	202.17	168.73	229.91
Finance, Insurance & Real Estate	323.93	305.81	248.79	403.27
Services	255.19	237.74	167.03	309.71
State/Local Government	358.92	310.63	297.75	403.01
Other	178.35	133.24	*	333.84
	<u>Garrard County</u>	<u>Jackson County</u>	<u>Jessamine County</u>	<u>Rockcastle County</u>
All Industries	\$223.34	\$253.68	\$299.32	\$220.31
Mining & Quarrying	*	369.16	*	*
Contract Construction	296.96	257.43	315.60	224.33
Manufacturing	168.88	190.85	386.27	235.56
Transportation, Communications & Public Utilities	383.44	328.69	354.83	214.47
Wholesale & Retail Trade	147.03	174.02	246.82	153.37
Finance, Insurance & Real Estate	315.80	*	283.71	261.83
Services	244.95	189.61	227.94	209.57
State/Local Government	259.89	270.72	267.11	264.27
Other	179.20	*	340.44	*

\* Not disclosed.

Note: The average weekly wage for each category includes the salaries and wages of all persons working for that type business. For example, the manufacturing category includes both production workers and administrative personnel. Excludes domestic workers, railway workers, certain nonprofit corporations, majority of federal government workers, and self-employed workers.

Source: Kentucky Cabinet for Human Resources, Average Weekly Wages of Workers Covered by Kentucky Unemployment Insurance Law, 1987.



## EXISTING INDUSTRY

### MAJOR RICHMOND MANUFACTURING FIRMS, THEIR PRODUCTS AND EMPLOYMENT\*

<u>Firm</u> <u>(Establishment date)</u>	<u>Product</u>	<u>1988</u> <u>Average Employment</u>
Ajax Magnethermic Corporation (1972)	Induction melting & heating equipment, industrial dryer equipment	111
B & H Tool Company, Inc. (1978)	Dies, jigs (wire EDM), special machinery, machine design & building	40
Blue Grass Plating (1969)	Electroplating & related services	40
Concrete Materials Corporation (1949)	Septic tanks, manholes, ready-mixed concrete	83
Continental Metal Specialty, Inc. (1969)	Metal stampings, tools, dies, office products	211
Electronic Assembly, Inc. (1985)	Electronic subassemblies	380
Exide Company (1976)	Storage batteries	411
Irvin Industries, Metal Stamping Division (1961)	Metal stampings, automotive parts, appliance oven door hinges	187
Lectrodryer Division, Ajax Magnethermic Corporation (1972)	Industrial dryers, dehydration equipment	45
North American Philips Lighting Corporation (1948)	Miniature electric light bulbs, halogen light sources, halogen coils	450
The Okonite Company (1968)	Insulated cable	270
Rand McNally & Company (1982)	Maps & books	113

(Continued)



<u>Firm</u> <u>(Establishment date)</u>	<u>Product</u>	<u>1987</u> <u>Average Employment</u>
The Richmond Register, A Thomson Group Newspaper (1917)	Newspapers, offset printing	48
Sembol Systems (1978)	Electromechanical assemblies, machine shop	45
Sherwin Williams Company (1974)	Coatings	214
Uncle Charlie's Meats, Inc. (1957)	Sausage, meat processing, ground beef	59

---

\* Firms with 40 or more employees.

Sources: Kentucky Department of Business Development, 1988 Kentucky Directory of Manufacturers; Division of Research and Planning; Richmond-Madison County Industrial Corporation.

#### RECENT INDUSTRIAL DEVELOPMENTS

Kokoku Rubber, Inc., recently located in Richmond. The 40,000-square-foot facility produces rubber molding applications for the medical industry. Twenty million dollars were invested in the 20-employee operation, which is projected to eventually employ 80 persons.

Diversified Tool and Development, Inc., is scheduled to begin operations soon. The 30,000-square-foot facility is a machine screw specialty shop and will employ 19 persons.

Expansions at the Okonite Company and Exide Company are under way. Employment will increase at the two plants by a combined total of 145 persons.

Development of the Richmond Industrial Park is under way. The 173-acre site will be served by rail and utilities.



## LABOR ORGANIZATIONS IN MANUFACTURING FIRMS

<u>Union</u>	<u>Representing workers at:</u>
International Brotherhood of Electrical Workers, AFL-CIO	North American Philips Lighting Corporation; The Okonite Company
International Union of Electronic, Electrical, Technical, Salaried and Machine Workers, AFL-CIO	National Metal Processing, Inc.
International Union, United Automobile, Aerospace and Agricultural Implement Workers of America	Irvin Industries, Metal Stamping Division

## SELECTED INDUSTRIAL SERVICES

<u>Types of Service</u>	<u>Location</u>	<u>Mileage from Richmond</u>
Custom Data Processing	Richmond	-
Custom Plastics Producers	Berea	12
Electric Motor Repair	Lexington	25
Grinding, Precision & Tool	Richmond	-
Heat Treating Facilities	Richmond	-
Industrial Equipment & Supplies	Richmond	-
Industrial Gases	Lexington	25
Industrial Waste Removal	Richmond	-
Machine Shops, Tool & Die	Richmond	-
Metal Castings	Cynthiana	57
Metal Finishers	Richmond	-
Metal Service Centers	Richmond	-
Millwrights	Lexington	25
Public Warehouse Facilities	Lexington	25

Sources: Kentucky Department of Business Development, Kentucky Directory of Selected Industrial Services, 1987; Division of Research and Planning.



## TRANSPORTATION

### Rail

CSX Transportation provides main line rail service to Richmond. The nearest piggyback facilities are maintained by the Southern Railway System at Georgetown, 39 miles northwest of Richmond.

For details on routing, schedules, rates, and services contact:

Manager  
Industrial Development  
CSX Transportation  
908 West Broadway  
P. O. Box 2157  
Louisville, Kentucky 40201  
(502) 587-7746

### Highways

Interstate Highway 75, U.S. Highways 25 and 421, and Kentucky Routes 52, 1295, and a portion of 876 are all "AAA"-rated (80,000-pound gross load limit) trucking highways serving Richmond. Interstate 75 has interchanges 2 miles northwest of the city and 2 miles southwest of the city. Interstate 75 provides direct access to Interstate 64, 24 miles north of Richmond near Lexington. Kentucky Route 876 forms a four-lane bypass around Richmond's south side.

An extension of the Richmond Bypass is planned. The highway will start at Kentucky 52 east of the city and extend north and west to U.S. Highway 25 north of Richmond.

### Truck Service

ABF Freight System, Inc.\*  
ANR Freight System, Inc.\*  
American Freight System, Inc.\*  
Averitt Express, Inc.\*\*  
Bailey's Express, Inc.\*\*  
Bishop Motor Express\*\*  
Bowman Transportation, Inc.\*  
Carolina Freight Carriers  
Corporation\*\*  
Central Transport, Inc.\*  
Consolidated Freightways  
Corporation of Delaware\*\*  
Craig's Express, Inc.\*\*  
Harris Motor Express, Inc.\*\*  
Jones Truck Lines, Inc.\*\*

Lawrenceburg Transfer Company\*\*  
Manning Motor Express, Inc.\*\*  
Middlewest Freightways, Inc.\*\*  
The O.K. Trucking Company\*\*  
Overnite Transportation Company\*\*  
Owenton Express, Inc.\*\*  
P-I-E Nationwide, Inc.\*\*  
Preston Trucking Company, Inc.\*\*  
Quick Freight Systems\*\*  
R & L Transfer, Inc.\*\*  
Roadway Express, Inc.\*\*  
Spartan Express, Inc.\*  
TNT Holland Motor Express, Inc.\*\*  
Transcon Lines\*\*  
Yellow Freight System, Inc.\*\*

\* Provides interstate service only.

\*\* Provides both interstate and intrastate service.

Source: American Motor Carrier Directory, Spring 1989.



HIGHWAY MILES AND TRUCK TRANSIT TIME IN DAYS FROM  
RICHMOND, KENTUCKY, TO SELECTED MARKET CENTERS

City	Highway Miles	Delivery		City	Highway Miles	Delivery	
		Time TL				Time TL	
Atlanta, GA	340	1		Los Angeles, CA	2,184	5	
Baltimore MD	558	2		Louisville, KY	98	1	
Birmingham, AL	396	2		Nashville, TN	233	1	
Chicago, IL	367	1		New Orleans, LA	747	2	
Cincinnati, OH	103	1		New York, NY	736	-	
Cleveland, OH	342	1		Pittsburgh, PA	366	2	
Detroit, MI	361	1		St. Louis, MO	357	2	
Knoxville, TN	146	1					

Note: Mileage computations are via the best interstate or primary highways, not necessarily the most direct route of travel.

Sources: Rand McNally Deluxe Motor Carriers' Road Atlas, 1987. Official Kentucky Mileage Map, 1980. Delivery time - Overnite Transportation Company, Lexington, Kentucky.

Air

Local

Location:	Madison Airport 6 miles south of Richmond
Runways:	1 paved
Length:	4,000 feet
Traffic	
Control:	Lighted wind sock
Lighting:	Runway, taxiway, beacon, VASI, REIL, MIRL
Services:	100LL and jet-A fuel; major A & P repairs; tie-down; hangar with lobby, offices, and maintenance shop; flight instruction; plane rental; charter; car rental; parking
Air Freight	
Service:	Chartered air freight services must be arranged



#### Nearest Scheduled Commercial Airline Service

	Bluegrass Airport
Location:	4 miles west of Lexington, Kentucky; 29 miles northwest of Richmond
Runways:	2 paved
Length:	7,000 feet; 3,500 feet
Traffic	
Control:	Control tower
Lighting:	Approach lighting system, beacon, runways and obstructions lighted, VASI
Services:	Delta, Piedmont, USAir, Allegheny Commuter, TWA, Jetstream United Express, Eastern Metro, Comair, American Eagle; fuel - 100LL and jet-A; hangars, tie-downs; major A & P repairs; major Avionics repairs; APU, charter, flight instruction, oxygen, plane rentals, survival equipment; taxi, limousine, car rentals, courtesy car, weather information; restaurant, snack bar
Air Freight	
Service:	Air freight terminal

#### Air Express Service

Several major companies offer air express services in Kentucky. These companies provide a quick means of shipping small to medium-sized packages expeditiously.

#### Water

The Kentucky River forms the northern boundary of Madison County. The nearest navigable point on the Kentucky River is the beginning of a 6-foot navigation channel at Frankfort, Kentucky, 52 miles northwest of Richmond.



## POWER AND FUEL

### Electricity

Company serving **Richmond and portions of central Madison County** -  
Kentucky Utilities Company  
Source of power - Kentucky Utilities Company  
For industrial rates contact:

Industrial Development Department  
Kentucky Utilities Company  
One Quality Street  
Lexington, Kentucky 40507  
(606) 255-1461

Company serving **northwestern and southern portions of Madison County** -  
Blue Grass Rural Electric Cooperative Corporation  
Source of power - East Kentucky Power Cooperative  
For industrial rates contact:

Industrial Development Division  
East Kentucky Power Cooperative  
P. O. Box 707  
Winchester, Kentucky 40391  
(606) 744-4812

and/or

Blue Grass RECC  
P. O. Drawer D  
Nicholasville, Kentucky 40356  
(606) 885-4191

Company serving **northeastern portion of Madison County** - Clark Rural  
Electric Cooperative Corporation  
Source of power - East Kentucky Power Cooperative  
For industrial rates contact:

Industrial Development Division  
East Kentucky Power Cooperative  
P. O. Box 707  
Winchester, Kentucky 40391  
(606) 744-4812

and/or

Clark RECC  
P. O. Box 748  
Winchester, Kentucky 40391  
(606) 744-4251



## Natural Gas

Company serving **Richmond** - Richmond Utilities

Source of supply - Columbia Gas Transmission Corporation

Size of transmission mains - 6-inch (supplier); 6 to 8 inches (distributor)

Distribution mains - 1 to 8 inches

Distribution pressure - 25 psi to 30 psi

Btu content - 1,026 per cubic foot

Specific gravity - 0.59

For rates and supplies contact:

Richmond Utilities  
300 Hallie Irvine Street  
P. O. Box 700  
Richmond, Kentucky 40475  
(606) 623-2323

Company serving portions of **Richmond and Madison County** - Delta Natural Gas Company, Inc.

Source of supply - Columbia Gas Transmission Corporation and

Tennessee Gas Pipeline Company

Size of transmission mains - Columbia: 30-inch; Tennessee Gas: 24-inch

Distribution mains - 2 and 4 inches

Distribution pressure - 15 psi to 90 psi

Btu content - 1,020 per cubic foot

Specific gravity - 0.65

For rates and supplies contact:

Manager of Marketing and  
Public Relations  
Delta Natural Gas Company, Inc.  
3617 Lexington Road  
Winchester, Kentucky 40391  
(606) 744-6171



## WATER AND SEWERAGE

### Public Water Supply

Company serving Richmond - Richmond Utilities\*  
300 Hallie Irvine Street  
P. O. Box 700  
Richmond, Kentucky 40475  
(606) 623-2323

Source - Kentucky River  
Treatment plant capacity - 7,500,000 gallons per day  
Average daily consumption - 4,500,000 gallons  
Peak daily consumption - 6,200,000 gallons  
Treatment processes - Rapid mix, coagulation, flocculation, sedimentation,  
filtration, chlorination, fluoridation, chloramination  
Storage capacity - 9,300,000 gallons (including 900,000 gallons in  
clear well)  
Size lines - 6 to 24 inches  
Water pressure - 48 psi to 80 psi

### MONTHLY WATER RATES

First	300 cubic feet	\$5.65 (Minimum)
Next	400 cubic feet	1.65 per 100 cubic feet
Next	5,000 cubic feet	1.50 per 100 cubic feet
Next	5,000 cubic feet	1.25 per 100 cubic feet
All over	10,700 cubic feet	.94 per 100 cubic feet

Tap-on charge: Cost of labor and materials

Name of water district - Kingston-Terrill Water District\*\*  
P. O. Box 5204  
Richmond, Kentucky 40475  
(606) 623-7723

Area served - South central Madison County  
Date when water district began operating - 1965  
Source of supply of treated water - Richmond Utilities  
Average amount of water used in a 24-hour period - 400,000 gallons  
Peak amount of water used in a 24-hour period - 500,000 gallons  
Storage capacity - 100,000 gallons  
Size lines - 8, 6, 4 and 3 inches  
Water pressure - 45 psi to 115 psi

(Continued)

\* Richmond Utilities is planning to expand its existing water treatment plant to 9 million gallons-per-day. Construction will begin by 1992.

\*\* Construction of a 500,000-gallon water storage tank is planned for the Kingston-Terrill Water District.



### MONTHLY WATER RATES

First	200 cubic feet	\$7.35 (Minimum)
Next	300 cubic feet	3.25 per 100 cubic feet
Next	300 cubic feet	2.35 per 100 cubic feet
All over	800 cubic feet	1.45 per 100 cubic feet

Tap-on charge:

5/8- x 3/4-inch meter - \$500

Larger meters - Actual cost of labor and materials

### **Sewerage**

Company serving **Richmond** - **Richmond Utilities\***  
300 Hallie Irvine Street  
P. O. Box 700  
Richmond, Kentucky 40475  
(606) 623-2323

Design capacity - 6,640,000 gallons per day (total for two treatment plants)

Average daily flow - 3,500,000 gallons

Type of treatment - Secondary

Treatment processes - Flow equalization, screening, grit removal, primary sedimentation, rotating biological contactors, secondary sedimentation, chlorination, anaerobic digester, sludge drying beds, filter press, post aeration

Treated effluent discharged into - **Tates Creek, Dreaming Creek**

Size of sanitary mains - 4 inches to 24 inches

Monthly rates - Based on water usage:

First	300 cubic feet	\$4.50 (Minimum)
Next	400 cubic feet	1.30 per 100 cubic feet
Next	5,000 cubic feet	1.15 per 100 cubic feet
Next	5,000 cubic feet	1.00 per 100 cubic feet
All over	10,700 cubic feet	.87 per 100 cubic feet

A 100 percent surcharge is added to the above rates for customers outside the city of Richmond.

Surcharges for industrial wastes exceeding specific strengths:

BOD--\$0.065 per pound in excess of 225 mg/l

TSS--\$0.083 per pound in excess of 265 mg/l

NH<sub>3</sub>-N--\$0.293 per pound in excess of 25 mg/l

Tap-on charge:

Most residential and commercial units - \$0.20 per square foot of building size

Industrial units - \$500, plus \$0.02 per square foot of building size

\* **Richmond Utilities** is in the process of replacing a portion of the sewerage system's trunk line. The \$16,000 project will be completed by spring of 1989. In addition, sewer service for areas west of Interstate 75 is being considered.



## CLIMATE

### Madison County

#### Temperature

Normal (30-year record)	54.90 degrees
Average annual 1987	56.80 degrees
Record highest, August 1983 (43-year record)	103.00 degrees
Record lowest, January 1963 (43-year record)	-21.00 degrees
Normal heating degree days (30-year record)	4,814
(Heating degree day totals are the sums of negative departures of average daily temperatures from 65 degrees F.)	

#### Precipitation

Normal (30-year record)	45.68 inches
Mean annual snowfall (43-year record)	16.40 inches
Total precipitation 1987	36.68 inches
Mean number days precipitation (.01 inch or more) (43-year record)	130.10
Mean number days thunderstorms (43-year record)	45.40

#### Prevailing winds (through 1963)

South

#### Relative Humidity (24-year record)

1 a.m.	77 percent
7 a.m.	81 percent
1 p.m.	60 percent
7 p.m.	64 percent

Source: U.S. Department of Commerce, Environmental Science Services Administration, Climatological Data, 1987. Station of record: Lexington, Kentucky.



## LOCAL GOVERNMENT

### Structure

Richmond, a second class city, is governed by a mayor, four commissioners, and a city manager. The mayor is elected to a four-year term, while the commissioners each serve two-year terms. The city manager serves as a full-time employee. Madison County is governed by a county judge/executive and four magistrates. Each county official is elected to a four-year term.

### Planning and Zoning

City agency - Planning Commission of Richmond  
Zoning enforced - Within the corporate limits of Richmond  
Subdivision regulations enforced - Within the corporate limits of Richmond  
and 5 miles beyond  
Local codes enforced - Building and housing  
Mandatory state codes enforced - Kentucky Plumbing code, National  
Electric Code, Kentucky Boiler Regulations and Standards, Kentucky  
Building Code (modeled after BOCA code)

### Local Fees and Licenses

Madison County levies a one percent tax on wages and net profits of businesses. The City of Richmond levies a two percent tax on wages and net profits of businesses located within its corporate limits. Taxpayers located within the city boundaries pay only the city tax.

A 3 percent tax is levied on utilities receipts for schools in Madison County. Tax is paid by all consumers of utilities as an add-on to the utilities bills. Exempted are receipts from utilities services that are resold and the receipts from the sale of energy or energy producing fuels that exceed 3 percent of the cost of production in manufacturing, processing, mining or refining.



## State and Local Property Taxes

All property in Kentucky, except items exempted by the state constitution, is taxed by the state. Property which also may be taxed by local jurisdictions includes land and buildings, finished goods inventories, automobiles, trucks, office furniture and office equipment. Local taxing jurisdictions in Kentucky include counties, cities, and school districts.

All property in Kentucky is assessed at 100 percent of fair cash value.

### COMBINED STATE AND LOCAL RATES PER \$100 VALUATION, 1988

	City of Richmond	Unincorporated Madison County
Land and Buildings	\$1.001	\$0.740
Manufacturing		
Machinery	0.150	0.150
Pollution Control		
Equipment	0.150	0.150
Inventories		
Raw materials	0.001	0.001
Goods in Process	0.001	0.001
Finished Goods	0.831	0.544
Automobiles & Trucks	1.115 *	0.828
Other Tangible		
Personal Property	1.280	0.993
Intangibles (Accounts		
receivable**, money		
in hand, stock,		
notes, bonds)	0.250	0.250
Goods Stored in Public		
Warehouses in Transit		
Status	0.001	0.001
Private Leaseholds in		
Industrial Revenue		
Bond Financed		
Facilities	0.015	0.015

\* Persons residing in the former Richmond Independent School District are assessed \$0.475 per \$100 valuation on motor vehicles. All other residents within the city of Richmond are assessed \$0.15 per \$100 valuation.

\*\* Accounts receivable are taxed at 85 percent of face value, for an effective rate of \$0.2125 per \$100 valuation.



## Safety

Police	Richmond	Madison County
Total staff	47	10
Radio-patrol cars	13	8
Fire*		
Insurance Services Office, Public Protection Classification	3	**
Full-time staff	53	13
Volunteers	16	40
Rescue Service		

Rescue service is provided by Madison County Rescue Squad, whose 44-member staff includes five paramedics and seven emergency medical technicians.

## Refuse Collection and Disposal

The City of Richmond provides municipal refuse collection and disposal service to residential and commercial customers in the city. Industrial customers and residents of unincorporated Madison County must contract with private haulers for refuse collection.

---

\* Includes copyrighted material of ISO Commercial Risk Services, Inc., with its permission.

\*\* Property within the Berea Fire District that is located five road miles or less from a fire station has a class 6 rating if within 1,000 feet of a fire hydrant, and a class 9 rating if more than 1,000 feet from a fire hydrant. Property within the Madison County Fire District or the White Hall Fire District has a class 9 rating if within five road miles of a fire station. The remainder of unincorporated Madison County has a class 10 rating.



## EDUCATION

### Public Schools

#### Madison County\*

Total Enrollment (September, 1988)	7,520
Kindergarten	481
Elementary	3,670
Middle School	1,283
High School	2,086
Pupil-Teacher Ratio (1986-87)	19-1
Percent High School Graduates to College (1986-87)	67.2
Expenditures Per Pupil (1986-87)	\$1,975

### Nonpublic Schools

<u>School</u>	<u>Enrollment</u>	<u>Grades</u>
Model Laboratory**	677	K-12
St. Mark Elementary	160	K-8

\* The Madison County School System recently completed construction of Madison Southern High School in Berea. Cost of the project was approximately \$3.7 million.

\*\* Model Laboratory functions as a public school in cooperation with local school districts in Madison County and Eastern Kentucky University. The institution, which is fully accredited by the Southern Association of Colleges and Schools, provides teacher training for the college students and a small-classroom learning environment for local primary and secondary level students. A tuition fee is required.



## Area Colleges and Universities

<u>Name</u>	<u>Location (Miles distant)</u>	<u>Enrollment (Fall, 1987)</u>	<u>Highest Degree Conferred</u>
Eastern Kentucky University	Richmond	13,600 *	Masters, Specialist**
Berea College Lexington	Berea (12)	1,621	Baccalaureate
Community College	Lexington (25)	2,995	Associate
Transylvania University	Lexington (25)	1,042	Baccalaureate***
University of Kentucky	Lexington (25)	22,461	Doctorate, M.D., D.M.D., J.D.
Asbury College Georgetown	Wilmore (34)	925	Baccalaureate
College	Georgetown (39)	1,424	Masters
Midway College	Midway (41)	335	Associate
Centre College	Danville (45)	881	Baccalaureate

### Eastern Kentucky University

Eastern Kentucky University is a regional, public institution of higher education located in Richmond. The University offers general and liberal arts programs, pre-professional training in education and various other fields at both the undergraduate and graduate levels. Eastern also offers continuing education and special programs to meet the varied needs and interests of the area.

\* Fall 1988 enrollment.

\*\* Joint doctoral degree programs are offered in cooperation with the University of Kentucky, Lexington. The degrees are issued by the University of Kentucky.

\*\*\* Courses in a masters degree program are taught on the Transylvania campus by faculty members of Xavier University of Cincinnati. The degree is issued by Xavier University.



## Vocational Training

The Bluegrass State Skills Corporation, an independent public corporation created and funded by the Kentucky General Assembly, provides programs of skills training to meet the needs of business and industry from entry level to advanced training, and from upgrading present employees to retraining experienced workers.

The Bluegrass State Skills Corporation is the primary source for skills training assistance for a new or existing company. The Corporation works in partnership with other employment and job training resources and programs, as well as Kentucky's economic development activities, to package a program customized to meet the specific needs of a company.

Vocational training is available at both the state vocational-technical schools and the area vocational education centers. The state vocational-technical schools are post-secondary institutions. The area vocational education centers are designed to supplement the curriculum of high school students. Both the state vocational-technical schools and the area vocational education centers offer evening courses to enable working adults to upgrade current job skills.

Arrangements can be made to provide training in the specific production skills required by an industrial plant. Instruction may be conducted either in the vocational school or in the industrial plant, depending upon the desired arrangement and the availability of special equipment.

### Nearest State School

Central Kentucky State Vocational-Technical School  
Lexington, 25 miles distant

Business & Office	Drafting (with CAD/CAM)
Accounting/Management	Electricity
Clerical	Electronics
Secretarial	Graphic Arts
Consumer & Home Economics	Machine Shop
Commercial Foods	Mine Equipment Operator
Consumer & Family Life	Welding
Skills	Learning Resource Center
Health & Personal Services	Public Service Occupations
Occupations	Business/Industry Security
Cosmetology	Training
Dental Assisting	CPR Training
Practical Nursing	Electrical Safety Training
Surgical Technology	Emergency Medical Care
Industrial Education	Fire Service Training
Air Conditioning	First Aid & Safety
Auto Body Repair	Rescue & Emergency Services
Auto Mechanics	Training
Carpentry	



Nearest Area Education Center

Madison County Area Vocational Education Center  
Richmond

Business & Office

Accounting/Management

Clerical

Secretarial

Health & Personal Services

Occupations

Health Services

Industrial Education

Auto Mechanics

Drafting

Machine Shop

Welding



## HEALTH

### Local Medical Personnel

Physicians - 58

Dentists - 32

### Hospitals

<u>General Hospital</u>	<u>Location</u>	<u>Beds</u>
Pattie A. Clay Hospital	Richmond	112

Medical staff - 37 physicians, 95 registered nurses, and 8 licensed practical nurses

### Other Medical Facilities

Comprehensive Care Center

Instant Care Center

Madison County Health Department (a public health facility)

### Ambulance Service

Name - Madison County Ambulance Service

Staff - 18 full-time and 15 part-time emergency medical technicians; 5 paramedics



## OTHER LOCAL FACILITIES

### Communications

Telephone -	South Central Bell
Telegraph -	Western Union
	Toll-Free number, 1-800-325-6000
Newspapers -	Richmond Register
Daily and circulation -	8,760
Radio -	WCBR-AM; WEKY-AM; WMCQ-FM; WEKU-FM (Eastern Kentucky University)
Television -	
Airwave reception from -	Danville and Lexington, Kentucky
Cable service -	Centel Cable Television Company of Kentucky
Educational Television -	The Kentucky Educational Television (K.E.T.) network is available statewide

### Library Services

Public library - Madison County Public Library
Size collection - 5,830 volumes
Circulation, April-October, 1988 - 13,506
John Grant Crabbe Library - Eastern Kentucky University
Size collection - 811,067 volumes
Circulation, 1987-88 - 245,538

### Religious Institutions

Denominations -	AME	Church of Jesus Christ
	Apostolic	of Latter Day Saints
	Assembly of God	Church of Nazarene
	Baptist	Episcopal
	Catholic	Lutheran
	Christian	Jehovah's Witnesses
	Christian - Disciples	Methodist
	of Christ	Presbyterian
	Church of Christ	Seventh-Day Adventist
	Church of God	United Methodist
Nearest Synagogues -	Lexington, 25 miles northwest of Richmond	
Congregations -	Adath Israel (reform)	
	Ohavey Zion (traditional)	



## Financial Institutions

<u>Banks</u>	<u>Assets</u>	<u>Deposits</u>	<u>Statement Date</u>
Citizens Fidelity Bank and Trust Company - Madison County (a subsidiary of PNC Financial Corporation	\$37,823,160,000.00	\$25,046,722,000.00	9/30/88
First Security Corporation of Kentucky, and its subsidiary State Bank and Trust Company	1,598,591,000.00	1,259,024,000.00	9/30/88
Peoples Bank and Trust Company of Madison County	\$56,375,390.00	\$50,838,518.00	6/30/88
Richmond Bank and Trust Company	67,417,000.00	60,438,000.00	6/30/88

<u>Savings and Loan Associations</u>	<u>Assets</u>	<u>Deposits</u>	<u>Statement Date</u>
First Federal Savings and Loan Association of Richmond	93,266,170.00	84,520,501.00	6/30/88

## Hotels and Motels

Total number - 14  
Total rooms - 895



## RECREATION

### Local

The Richmond Parks and Recreation Department maintains and administers six park sites and a community center. These facilities include historic Irvinton and the Irvine McDowell Park, Million Park, Camp Catalpa Environmental Park, Lake Reba Recreation Area, Dillingham Heights Neighborhood Playground, a Little League baseball complex, and the community recreation center. Located within these facilities are 10 ball fields, four tennis courts, two outdoor basketball courts, four-square courts, eight picnic shelters, five apparatus areas (with one specifically designed for the orthopedically handicapped), numerous outdoor picnic areas with tables and grills, playground areas, a nature trail, 12 lighted horseshoe pits, green spaces, parking, restrooms, and concessions. The recreation center features a gymnasium, a kitchen, meeting rooms, a game room, a crafts room, locker rooms with shower facilities, and a large multipurpose room. The department recently constructed a Little League baseball complex. The \$85,000 facility consists of three baseball fields and a concession stand with the development of two additional fields already under way.

The department organizes a well-balanced recreation program offering participation in sports leagues and athletics, games, wellness and physical fitness programs, outdoor recreational activities, cultural arts programs, and social activities. Special interest classes and programs for special population groups, such as senior citizens and the handicapped, involve residents and visitors of all ages and backgrounds.

Special annual events in Richmond include the Madison County Fair, the Founders Day Fourth of July Celebration, the Pops in the Park concert (held at White Hall State Shrine), the Haunted Forest and Big Boo Bash held during the Halloween season, the Holiday Happening Arts and Crafts Fair, the Easter Egg Extravaganza, the Holiday Parade held during the Christmas season, the "Heart of Kentucky" May Celebration, the Pattie A. Clay Charity Ball, the Richmond Junior Women's Club Junior Miss Pageant, and the Hardee's Richmond Road Race. A local children's theater group presents two performances annually.

Private recreational facilities include two country clubs offering golf and swimming, three indoor and one drive-in movie theater, two bowling facilities, the Madison Fish and Game Club, a fishing lake, and several campgrounds.

Eastern Kentucky University, located at Richmond, is the center for a variety of educational, cultural, and recreational activities, including lectures, theatrical productions, art exhibits, ballets, concerts, and sporting events. The EKU campus also serves as a conference center for eastern and central Kentucky, hosting numerous groups and organizations throughout the year. Recreational facilities on the University campus include indoor and outdoor Olympic-size swimming pools, indoor and outdoor tennis courts, a 27-acre intramural sports area, racquetball courts, gymnasiums, a 6,500-seat basketball arena, and a 20,000-seat football complex. The University has been host to the Girls' State High School Basketball Tournament and the boys' and girls' state high school swimming meets.



Historical buildings in Richmond include the Greek Revival-style Madison County Courthouse, built in 1849-1850; Bronston Place and Brighton, homes built during the 1820's and 1830's in the traditional Federal style; Nay Coy's Home and Elmwood, designed in the late 1880's by Cincinnati architect des Jardin; and Irvinton, built in the 1820's and listed on the National Register of Historic Homes.

White Hall State Shrine, 8 miles north of Richmond, one of the grand estate houses of post-Civil War Kentucky, is the Italianate mansion of Cassius Marcellus Clay, the early abolitionist and politician. An outdoor drama entitled, "The Lion of White hall" is performed during the spring and summer seasons. Kentucky handcrafts are sold in the White Hall gift shop, only a short walk from the mansion.

The spirit of Daniel Boone and his pioneers is reborn at Fort Boonesborough State Park in Boonesboro, 13 miles north of Richmond. In the re-created fort, pioneer crafts of the eighteenth century are demonstrated by using functioning antiques from the frontier era. Cabins are furnished as they would have been in the days of Boone and documentary films are presented which depict the struggle of the first Kentuckians to make the Kentucky wilderness a home. A gift shop within the fort offers for sale all the handcrafted items made at the fort. Other recreational facilities and activities of the park include the finest sand beach on the Kentucky River with a modern bathhouse and a modern 187-site camping area, a picnic area, a playground and miniature golf.

Bybee Pottery, located 13 miles northeast of Richmond, is known nation-wide for its unusual handmade Kentucky pottery. Generations of craftsmen-potters have been creating the Bybee line for over a century. Tours are available.

#### Area (Within 55 miles)

The Daniel Boone National Forest, approximately 22 miles east of Richmond, covers 640,000 acres of timberland in eastern Kentucky. It encompasses much of Kentucky's great beauty and provides a vacation paradise. There are scenic hiking trails, rivers and streams stocked with a variety of fish, hunting preserves, camping sites, and numerous other natural and historical attractions.

Lexington, 25 miles northwest of Richmond, offers a variety of cultural, sporting, and recreational activities. Thoroughbred and harness racing is presented at Keeneland Race Course and the Red Mile Harness Track during several meets each year. The University of Kentucky and Transylvania University offer a number of sporting events. The University of Kentucky basketball games are held at Rupp Arena, the second largest basketball arena in the world. Other attractions include Lexington Philharmonic concerts, Lexington Children's Theatre, and plays performed by Broadway touring companies, all held in the recently renovated Opera House. In addition, located in the heart of downtown Lexington, the historical Victorian Square and Festival Market Place offer a taste of nostalgia with their many quaint shops and restaurants.



**Waveland State Shrine**, 26 miles northwest of Richmond near Lexington, features an 1847 Greek Revival mansion depicting Kentucky lifestyles from the days of early settlers to the antebellum era of gentility and elegance as well as the Civil War and postwar periods. The shrine also includes the Kentucky Life Museum and a plantation village on ten acres with many shops and displays.

The **Kentucky Horse Park**, a park dedicated to horses and to man's love for horses, is located 33 miles northwest of Richmond at Lexington. The park, which contains more than 1,000 acres of Kentucky Bluegrass, features the International Museum of the Horse; the American Saddle Horse Museum; the Man O'War Memorial; the wide screen film "Thou Shalt Fly Without Wings"; an antique carriage display; horseback and pony rides; walking farm tours; horse-drawn tours; a restaurant; a gift shop; and a campground area, which offers swimming, tennis, and planned activities. Numerous special events are held year-round and include various horse shows, steeplechasing, dressage, polo games, and rodeos.

**Constitution Square State Shrine**, 36 miles west of Richmond in Danville, is a reproduction of Kentucky's first courthouse square, including the original 1792 post office which was the first in the west.

**William Whitley House State Shrine**, 40 miles southwest of Richmond near Stanford, is the first brick house west of the Allegheny Mountains, built 1787-94. Whitley laid out Kentucky's first race track here and started U.S. counterclockwise racing. The facility provides picnic and playground areas in a ten-acre park.

**Isaac Shelby State Shrine**, 41 miles southwest of Richmond near Danville, is the burial site of Kentucky's first governor and one of the Commonwealth's foremost statesmen.

**Herrington Lake**, 42 miles west of Richmond near Danville and Harrodsburg, was developed by the Kentucky Utilities Company in 1925. Dix River Dam near Pleasant Hill is located on the 3,600-acre lake. Fishing, boating, and swimming can all be enjoyed on the lake. Camping and fishing facilities are available near Danville and Harrodsburg.

**Old Fort Harrod State Park**, 45 miles west of Richmond, is a 28-acre park in Harrodsburg that features a full-scale reproduction of the original Fort Harrod. The park also contains the log cabin where Abraham Lincoln's parents were wed, the Mansion Museum which houses mementos associated with the great periods of Kentucky history, a pioneer cemetery, and a federal monument dedicated to pioneers. The "Legend of Daniel Boone" and "Lincoln", two excellent outdoor dramas, are performed at the Old Fort Amphitheater during the summer months.

**Perryville Battlefield State Shrine**, 49 miles west of Richmond near Perryville, is the site of the largest Civil War battle in Kentucky. A museum, a gift shop, a picnic area, and a playground are located on the grounds.

**Frankfort**, the capital of Kentucky, is 52 miles northwest of Richmond. Points of interest in Frankfort include the Capitol Building, a 34-foot floral clock, the Daniel Boone Monument, several museums, and historic homes with their original furnishings. Frankfort is also the home of Kentucky State University which offers many cultural activities and sporting events.



Pleasant Hill, a restored Shaker Village located 52 miles west of Richmond, is a National Historic Landmark. Thirty buildings and grounds have been restored to display unique Shaker skills in furniture making, crafts, and architecture. Dining rooms, lodging, craft shops, and seasonal festivals and plays are offered.

Natural Bridge State Resort Park near Slade, 54 miles east of Richmond, is located in the Daniel Boone National Forest where cliffs and stone arches fill the landscape. The rugged awesomeness of the great Natural Bridge is the main attraction. The park offers a 35-room resort lodge with a dining room, convention center, gift shop, ten rustic cottages, and 95 camping sites. Other facilities include a lake, a swimming pool, a nature center and state nature preserve, picnic shelters and playgrounds, hiking trails, and a riding stable.



## COMMUNITY IMPROVEMENTS

### Recent

Richmond received its sixth consecutive "Kentucky Certified City" award in 1987. The award is based on achievement in the following categories: economic development, transportation, public affairs, utilities, health, commercial development, housing, education and recreation. The Certified Cities Program is sponsored by the Kentucky Chamber of Commerce.

Kokoku Rubber, Inc., recently located in Richmond. The 40,000-square-foot facility produces rubber molding applications for the medical industry. Twenty million dollars were invested in the 20-employee operation, which is projected to eventually employ 80 persons.

Development of the Richmond Technology Park was recently completed. The 72-acre industrial park fronts on Interstate 75 and is provided with all utilities.

A new 360,000-square-foot indoor shopping mall opened in Spring 1988. This regional complex employs over 600 persons.

The Madison County School System recently completed construction of Madison Southern High School in Berea. Cost of the project was approximately \$3.7 million.

The Lake Reba Recreation Area, near Richmond, is being developed as a major recreation complex for Madison County. Current facilities include two softball fields, three Little League fields, twelve lighted horseshoe pits, picnic and playground areas, and nature trails.

The Richmond Parks and Recreation Department recently constructed a Little League baseball complex. The \$85,000 facility consists of three baseball fields and a concession stand with the development of two additional fields already under way.

### Under Way

Development of the Richmond Industrial Park is under way. The 173-acre site will be served by rail and utilities.

Diversified Tool and Development, Inc., is scheduled to begin operations soon. The 30,000-square-foot facility is a machine screw specialty shop and will employ 19 persons.

Expansions at the Okonite Company and Exide Company are under way. Employment will increase at the two plants by a combined total of 145 persons.

Richmond Utilities is in the process of replacing a portion of the sewerage system's trunk line. The \$16,000 project will be completed by spring of 1989.



A main street revitalization program is under way in Richmond. The project consists of replacing and upgrading streets, sidewalks, lighting, and general aesthetic improvement.

#### Planned

Richmond Utilities is planning to expand its existing water treatment plant to 9 million gallons-per-day. Construction will begin by 1992. Sewer service for areas west of Interstate 75 is being considered.

An extension of the Richmond Bypass is planned. The highway will start at Kentucky 52 east of the city and extend north and west to U.S. Highway 25 north of Richmond.

Construction of a 500,000-gallon water storage tank is planned for the Kingston-Terrill Water District.