

1988

Industrial Resources: Hardin County - Radcliff

Kentucky Library Research Collections
Western Kentucky University, spcol@wku.edu

Follow this and additional works at: https://digitalcommons.wku.edu/hardin_cty

 Part of the [Business Administration, Management, and Operations Commons](#), [Growth and Development Commons](#), and the [Infrastructure Commons](#)

Recommended Citation

Kentucky Library Research Collections, "Industrial Resources: Hardin County - Radcliff" (1988). *Hardin County*. Paper 24.
https://digitalcommons.wku.edu/hardin_cty/24

This Report is brought to you for free and open access by TopSCHOLAR®. It has been accepted for inclusion in Hardin County by an authorized administrator of TopSCHOLAR®. For more information, please contact topscholar@wku.edu.

RESOURCES FOR ECONOMIC DEVELOPMENT

Radcliff



RADCLIFF, KENTUCKY --- Site 188 --- 73 Acres

For more information contact the Cabinet for Economic Development, Department of Business Development, Industrial Development & Marketing Division, Capital Plaza Tower, Frankfort, Kentucky 40601 (502-564-7140)

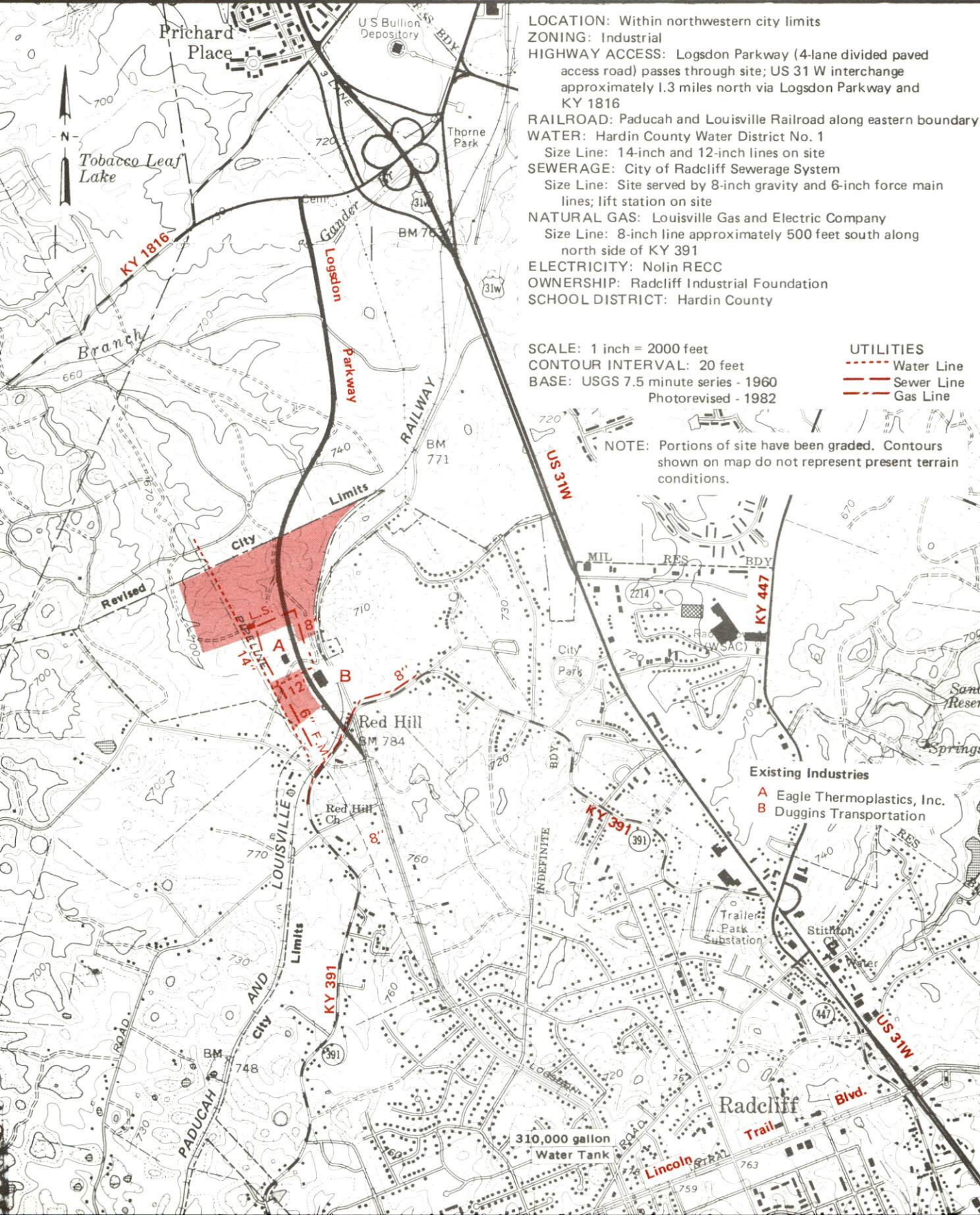

- LOCATION: Within northwestern city limits
- ZONING: Industrial
- HIGHWAY ACCESS: Logsdon Parkway (4-lane divided paved access road) passes through site; US 31 W interchange approximately 1.3 miles north via Logsdon Parkway and KY 1816
- RAILROAD: Paducah and Louisville Railroad along eastern boundary
- WATER: Hardin County Water District No. 1
Size Line: 14-inch and 12-inch lines on site
- SEWERAGE: City of Radcliff Sewerage System
Size Line: Site served by 8-inch gravity and 6-inch force main lines; lift station on site
- NATURAL GAS: Louisville Gas and Electric Company
Size Line: 8-inch line approximately 500 feet south along north side of KY 391
- ELECTRICITY: Nolin RECC
- OWNERSHIP: Radcliff Industrial Foundation
- SCHOOL DISTRICT: Hardin County

SCALE: 1 inch = 2000 feet
 CONTOUR INTERVAL: 20 feet
 BASE: USGS 7.5 minute series - 1960
 Photorevised - 1982

- UTILITIES**
- Water Line
 - Sewer Line
 - Gas Line

NOTE: Portions of site have been graded. Contours shown on map do not represent present terrain conditions.

- Existing Industries**
- A Eagle Thermoplastics, Inc.
 - B Duggins Transportation

310,000 gallon Water Tank

RESOURCES FOR ECONOMIC DEVELOPMENT
RADCLIFF, KENTUCKY

Prepared by
The Kentucky Department of Business Development
Division of Research and Planning
in cooperation with
The Radcliff-North Hardin Chamber of Commerce
and
The Radcliff Industrial Foundation

1988

Program manager - Andrew Dennis; research - Keith Roberts; clerical - Bobbi Graves; graphics - Tony Cecconi, Robert Owens, Pat Coleman; cartography - Site Evaluation Branch, Division of Industrial Development and Marketing. Cost of printing paid from state funds.

TABLE OF CONTENTS

<u>Chapter</u>	<u>Page</u>
INDUSTRIAL SITES	i
RADCLIFF, KENTUCKY - A RESOURCE PROFILE	1
THE LABOR MARKET STATISTICS	2
Labor Market Area Map	2
Population	3
Population Projections	3
Unemployment Rates, 1980-1987 - Line Chart	4
Labor Force Characteristics of Residents, 1987	5
Selected Components of Nonagricultural Employment, by Place of Work, 1987	5
Estimated Male Labor Supply	6
Estimated Female Labor Supply	6
Average Placement Wages	7
Per Capita Personal Income	7
Average Weekly Wages of Workers Covered by Unemployment Insurance F.Y. 1986-87 - Bar Chart	8
Average Weekly Wages by Industry, by Place of Work, 1987	9
EXISTING INDUSTRY	10
Radcliff Manufacturing Firms, Their Products and Employment	10
Labor Organizations in Manufacturing Firms	10
Selected Industrial Services	11
TRANSPORTATION	12
Rail	12
Highways	12
Truck Service	13
Air	14
Air Express Service	14
Water	14
POWER AND FUEL	15
Electricity	15
Natural Gas	16
WATER AND SEWERAGE	17
Public Water Supply	17
Sewerage	18

<u>Chapter</u>	<u>Page</u>
CLIMATE	19
LOCAL GOVERNMENT	20
Structure	20
Planning and Zoning	20
Local Fees and Licenses	20
State and Local Property Taxes	21
Combined State and Local Rates Per \$100 Valuation, 1987	21
Safety	22
Police	22
Fire	22
Rescue Service	22
Refuse Collection and Disposal	22
EDUCATION	23
Public Schools	23
Nonpublic Schools	23
Area Colleges and Universities	24
Vocational Training	25
HEALTH	27
Local Medical Personnel	27
Hospitals	27
Other Medical Facilities	27
Ambulance Service	27
OTHER LOCAL FACILITIES	28
Communications	28
Library Services	28
Religious Institutions	28
Financial Institutions	29
Hotels and Motels	29
Clubs and Organizations	30
RECREATION	31
COMMUNITY IMPROVEMENTS	34

GENERAL HIGHWAY MAP
HARDIN COUNTY
KENTUCKY

PREPARED BY THE
KENTUCKY TRANSPORTATION CABINET
DEPARTMENT OF HIGHWAYS
DIVISION OF PLANNING
IN COOPERATION WITH THE
U.S. DEPARTMENT OF TRANSPORTATION
FEDERAL HIGHWAY ADMINISTRATION

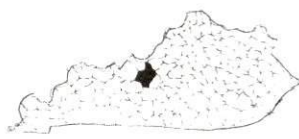
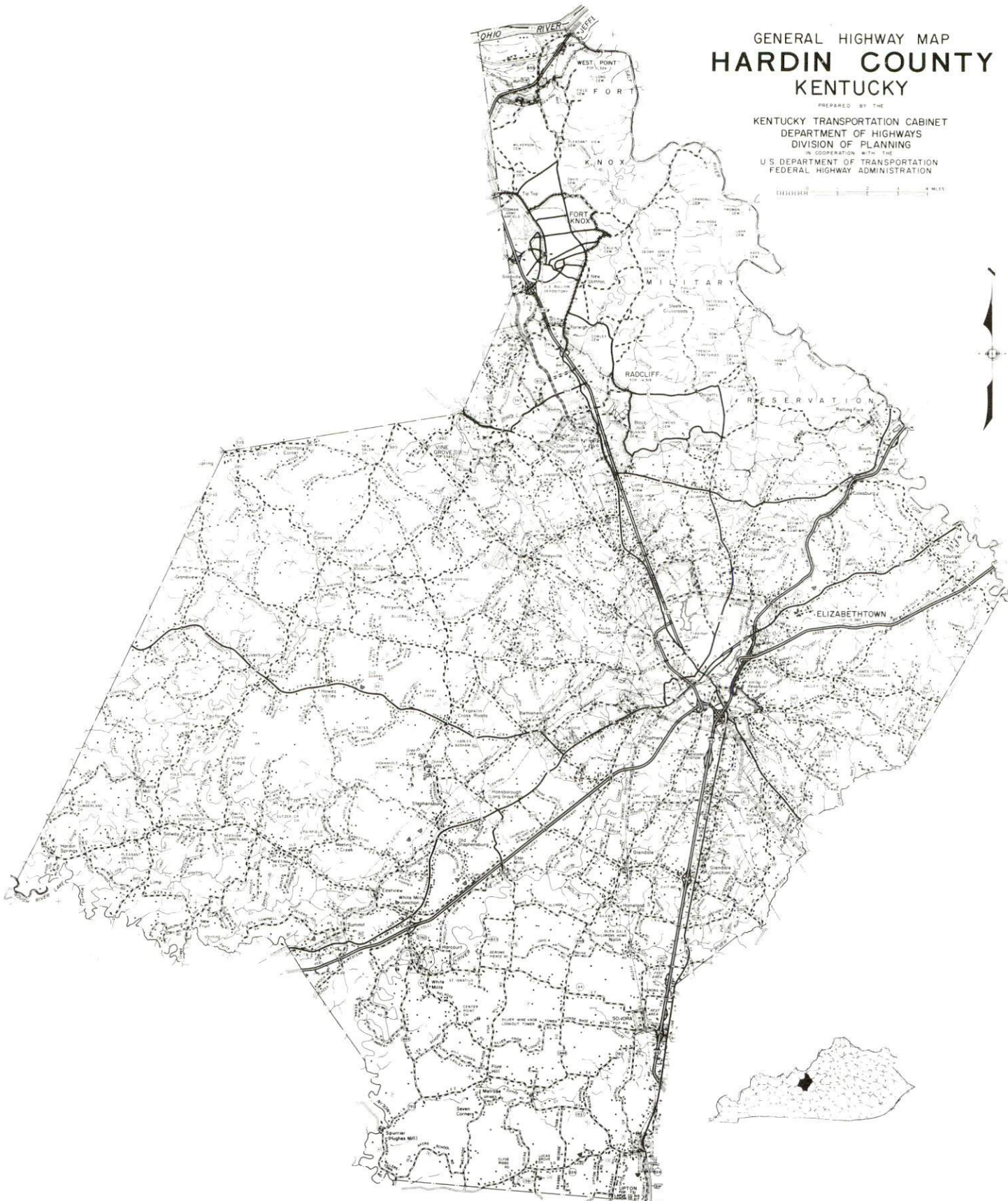

RADCLIFF, KENTUCKY - A RESOURCE PROFILE

Radcliff, situated in northern Hardin County, had a 1986 estimated population of 20,160 persons. Radcliff is adjacent to the Fort Knox Military Reservation. U.S. Highway 31W, a major traffic artery through Radcliff, provides direct, four-lane access to Louisville, Kentucky, only 34 miles northeast of the city. Radcliff is 135 miles southwest of Cincinnati, Ohio, and 143 miles northeast of Nashville, Tennessee.

Hardin County, located in north central Kentucky's Mississippian Plateaus Region, covers a land area of 629 square miles. The topography of the county ranges from a low, rolling plateau in the central section where Radcliff is located, to steeper hills and ridges along the eastern border of the county. Hardin County's 1986 estimated population was 93,811 persons.

The Economic Framework - The total number of Hardin County residents employed in 1987 averaged 31,400. Manufacturing firms in the county reported 4,200 employees; wholesale and retail trade provided 7,200 jobs; 3,320 people were employed in service occupations; state and local government accounted for 3,830 employees; and contract construction firms provided 1,300 jobs.

Labor Supply - There is a current estimated labor supply of 13,310 men and 19,670 women available for industrial jobs in the labor market area. In addition, from 1988 through 1992, 10,930 young men and 10,440 young women in the area will become 18 years of age and potentially available for industrial jobs.

Transportation - Paducah and Louisville Railway provides rail freight service to Radcliff. U.S. Highway 31W, a "AAA"-rated trucking highway, provides Radcliff with four-lane access to Interstate 65, the Blue Grass Parkway, and the Western Kentucky Parkway at Elizabethtown, 12 miles south of Radcliff. U.S. 31W also provides four-lane access to the Louisville area, 34 miles north of Radcliff, where Interstate 64, Interstate 65, Interstate 71 and several major U.S. and Kentucky highways intersect. There are 25 trucking companies which provide intrastate and/or interstate service to Radcliff. The nearest scheduled commercial airline service is available at Louisville's Standiford Field, 33 miles northeast of Radcliff. Addington Field, 15 miles south of Radcliff, has a paved 5,000-foot runway. Riverport facilities are available on the Ohio River at Louisville, 34 miles northeast of Radcliff.

Power and Fuel - Kentucky Utilities Company and Nolin Rural Electric Cooperative Corporation both serve portions of Radcliff and Hardin County with electric power. Louisville Gas and Electric Company provides natural gas service to Radcliff as well as providing electric power to a small portion of northern Hardin County.

Education - The Hardin County School System is accredited by the Southern Association of Colleges and Schools. The Elizabethtown Community College, a unit of the University of Kentucky Community College System, is located 12 miles south at Elizabethtown. Vocational training is provided by Elizabethtown State Vocational-Technical School at Elizabethtown, and at Meade County Area Vocational Education Center, 22 miles northwest of Radcliff at Brandenburg.

LABOR MARKET STATISTICS

The Radcliff Labor Market Area includes Hardin County and the adjoining Kentucky counties of Breckinridge, Bullitt, Grayson, Hart, Larue, Meade and Nelson.

POPULATION

Area	1986*	1980	1970	Percent Nonwhite
				1980
Radcliff	20,160	14,656	7,881	25.3
Labor Market Area	259,253	247,734	202,670	-
Hardin County	93,811	88,911	78,421	14.7
Breckinridge County	16,982	16,861	14,789	3.8
Bullitt County	46,387	43,346	26,090	0.8
Grayson County	21,601	20,854	16,445	0.6
Hart County	15,709	15,402	13,980	8.1
Larue County	12,223	11,922	10,672	4.7
Meade County	22,952	22,854	18,796	9.0
Nelson County	29,588	27,584	23,477	6.6

* Population estimates.

Sources: U.S. Department of Commerce, Bureau of the Census. University of Louisville, Urban Studies Center, Population Unit.

POPULATION PROJECTIONS

Area	1990	1995	2000	2010
Labor Market Area	273,983	287,826	300,640	321,971
Hardin County	100,320	105,210	109,905	118,450
Breckinridge County	17,454	17,748	17,919	18,022
Bullitt County	49,537	53,451	57,182	63,069
Grayson County	22,941	24,053	25,090	26,920
Hart County	16,011	16,677	17,266	18,195
Larue County	12,074	11,999	11,860	11,392
Meade County	24,395	25,284	26,046	27,018
Nelson County	31,251	33,404	35,372	38,905

Source: University of Louisville, Urban Studies Center, State Data Center, Newsletter Vol. 6, Nos. 3/4, March/June 1988.

UNEMPLOYMENT RATES

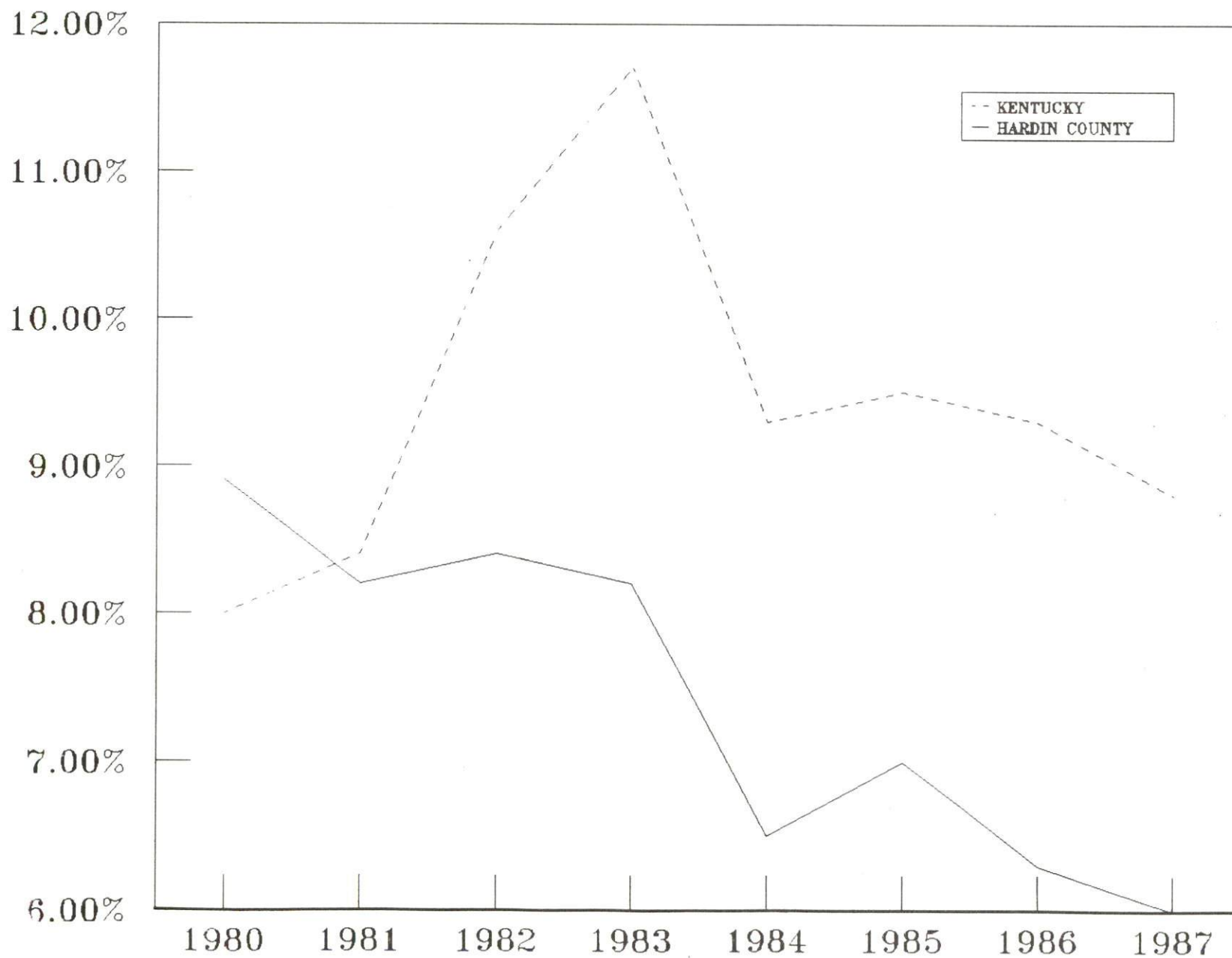

LABOR FORCE CHARACTERISTICS OF RESIDENTS, 1987

	<u>Hardin County</u>	<u>Labor Market Area</u>
Civilian Labor Force	33,413	104,781
Employment	31,402	96,039
Unemployment	2,011	8,742
Rate of Unemployment (%)	6.0	8.3

Source: Kentucky Cabinet for Human Resources, Kentucky Labor Force Estimates, Annual Averages, 1987.

**SELECTED COMPONENTS OF NONAGRICULTURAL EMPLOYMENT
BY PLACE OF WORK, 1987**

	<u>Hardin County</u>	<u>Labor Market Area</u>
All Industries (total)	21,802	49,513
Manufacturing	4,201	12,433
Wholesale & Retail Trade	7,195	13,998
Services	3,316	6,548
State/Local Government	3,832	9,117
Contract Construction	1,300	2,782

Note: Excludes domestic workers, railway workers, certain nonprofit corporations, majority of federal government workers, and self-employed workers.
Source: Kentucky Cabinet for Human Resources, Average Monthly Workers Covered by Kentucky Unemployment Insurance Law, 1987.

HARDIN COUNTY

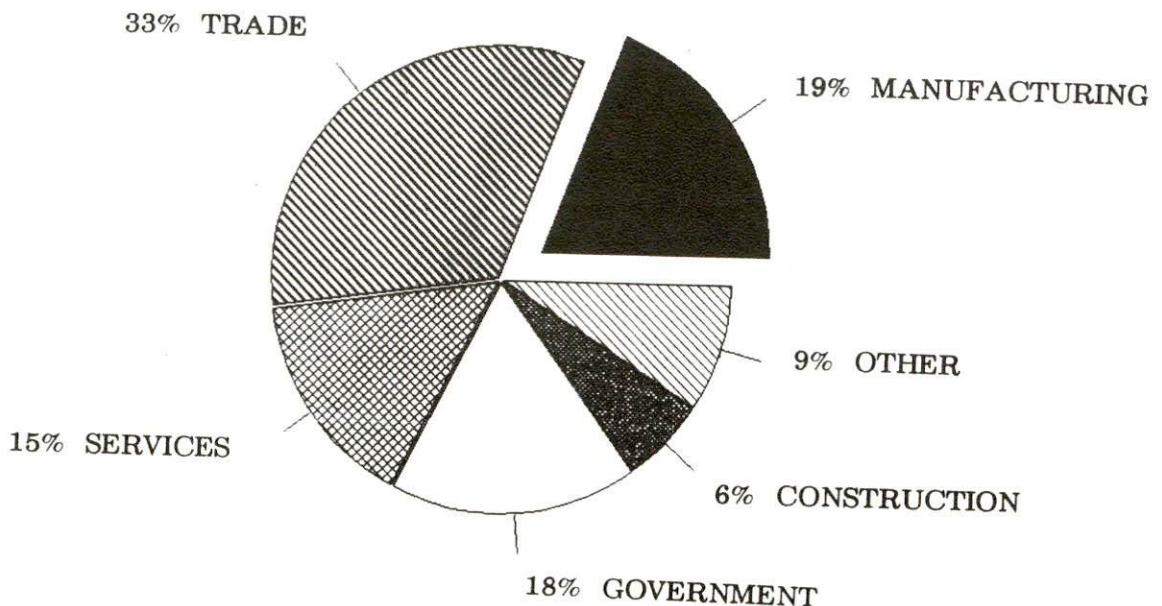

ESTIMATED MALE LABOR SUPPLY
RADCLIFF LABOR MARKET AREA

Area	Current				Future
	Total Male	Unemployed	Under-employed	Not in Labor Force	Becoming 18 years of age 1988 thru 1992
Labor Market Area*	13,308	4,945	7,009	1,354	10,931
Hardin	4,099	910	3,189	0	3,326
Breckinridge	932	425	507	0	721
Bullitt	1,770	861	909	0	2,501
Grayson	2,036	918	649	469	882
Hart	1,381	420	486	475	634
Larue	572	292	217	63	468
Meade	1,030	269	414	347	1,210
Nelson	1,488	850	638	0	1,189

ESTIMATED FEMALE LABOR SUPPLY
RADCLIFF LABOR MARKET AREA

Area	Current				Future
	Total Female	Unemployed	Under-employed	Not in Labor Force	Becoming 18 years of age 1988 thru 1992
Labor Market Area*	19,668	4,528	5,668	9,472	10,444
Hardin	4,707	1,222	2,001	1,484	3,161
Breckinridge	1,603	363	350	890	660
Bullitt	3,835	733	1,071	2,031	2,406
Grayson	2,148	437	550	1,161	846
Hart	2,131	471	337	1,323	603
Larue	922	170	181	571	429
Meade	2,619	385	539	1,695	1,139
Nelson	1,703	747	639	317	1,200

* Additional workers may be drawn from other nearby counties.

Note: Unemployed - persons unemployed and actively seeking work; Underemployed - persons employed but working only 14 to 26 weeks per year; Not in Labor Force - represents the number of persons who would enter the labor force if suitable employment were available (based on the assumption that persons in Kentucky would like to participate in the labor force in the same proportion that they do nationally).

Sources: Kentucky Cabinet for Human Resources, Kentucky Labor Supply Estimates by County, 1986. Kentucky Department of Economic Development, Future Labor Supply Becoming 18 Years of Age, 1988 thru 1992.

AVERAGE PLACEMENT WAGES

Hardin County is served by the Elizabethtown local office of the Kentucky Department for Employment Services. The focus of the following data is on job placements made by the Elizabethtown local office and may therefore be used as an indicator of the wages which employers in the area pay new employees. During the twelve months which ended on June 30, 1988, the local employment office filled 3,256 job openings in various occupational categories. The average hourly wage for selected occupational categories were:

<u>OCCUPATIONAL CATEGORY</u>	<u>NUMBER OF PLACEMENTS</u>	<u>AVERAGE WAGE(\$)</u>
All Occupations	3,256	4.47
Clerical	960	3.90
Sales	291	3.89
Services (excluding domestic)	841	4.22
Agricultural, Fishery, Forestry, etc.	57	3.90
Processing	18	4.61
Machine Trades	164	5.46
Bench Work	146	3.92
Structural	209	5.28
Motor Freight/ Transportation	99	4.92
Packaging and Materials Handling	233	4.66
Other	4	10.27

The Elizabethtown local office also serves Breckinridge, Grayson, Larue, and Meade Counties. The above occupational categories are taken from the Dictionary of Occupational Titles published by the U.S. Department of Labor.

Source: Kentucky Cabinet for Human Resources, Department for Employment Services.

PER CAPITA PERSONAL INCOME

<u>Area</u>	<u>1982</u>	<u>1986</u>	<u>Percent Change</u>
Hardin County	\$8,158	\$10,096	23.8
Labor Market Area Range	\$6,861 - 8,602	\$7,942 - 10,438	-
Kentucky	\$9,277	\$11,342	22.3
U.S.	\$11,480	\$14,636	27.5

Sources: Kentucky Economic Information System, April 1988.

AVERAGE WEEKLY WAGES OF WORKERS COVERED BY
UNEMPLOYMENT INSURANCE F.Y. 1986-87

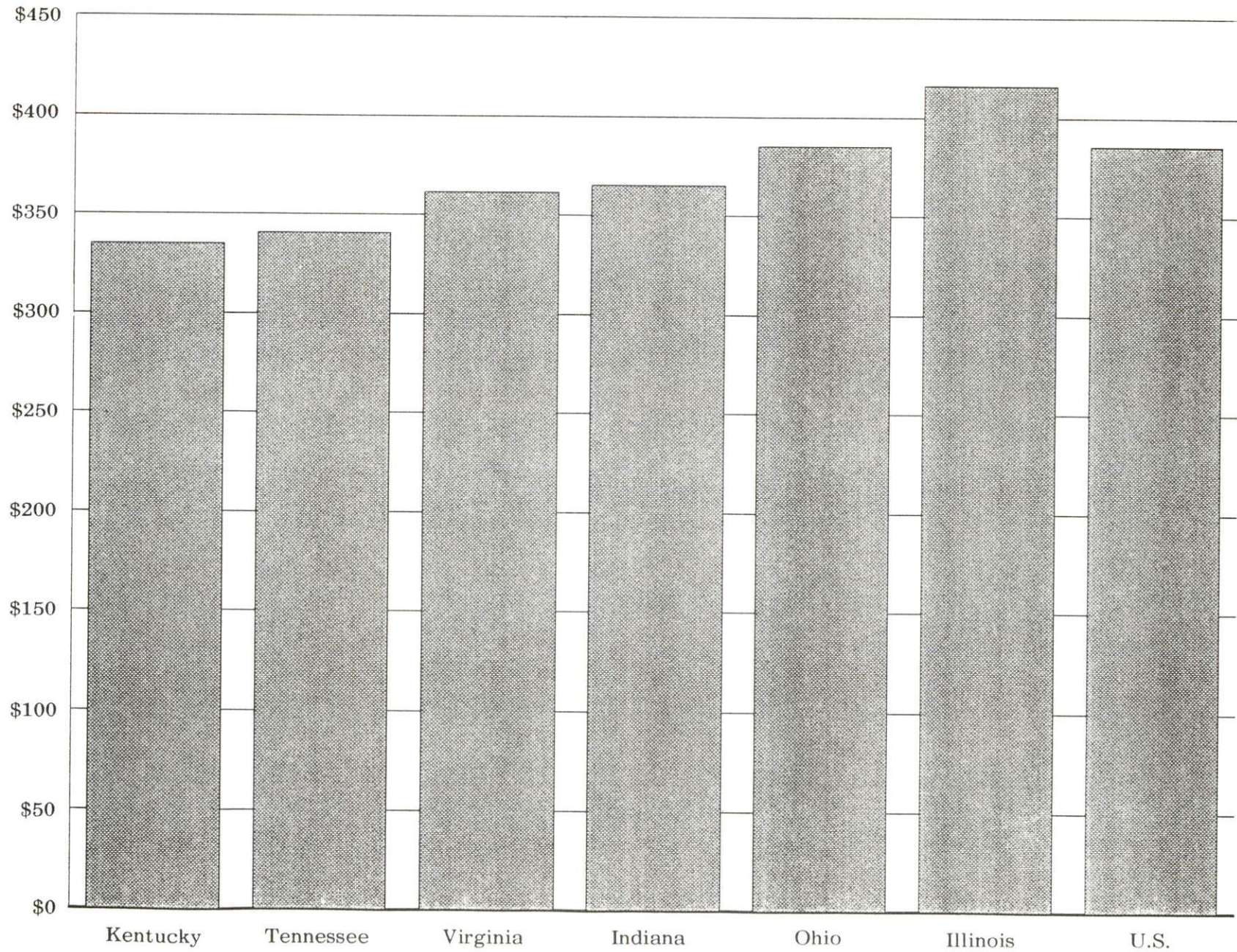

AVERAGE WEEKLY WAGES BY INDUSTRY
BY PLACE OF WORK, 1987

	Hardin County	Breckinridge County	Bullitt County	Grayson County
All Industries	\$292.15	\$250.30	\$293.83	\$246.61
Mining & Quarrying	*	281.44	*	460.39
Contract Construction	343.83	314.47	250.34	235.32
Manufacturing	412.16	256.08	419.40	261.57
Transportation, Communications & Public Utilities	352.57	390.78	364.00	331.15
Wholesale & Retail Trade	191.36	183.40	174.83	191.05
Finance, Insurance & Real Estate	300.52	301.67	262.40	272.48
Services	278.42	203.21	202.75	181.64
State/Local Government	328.05	298.28	313.79	285.30
Other	237.29	154.14	192.41	180.97
	Hart County	Larue County	Meade County	Nelson County
All Industries	\$243.93	\$235.74	\$325.11	\$293.45
Mining & Quarrying	*	0	250.89	301.61
Contract Construction	188.08	196.51	237.27	330.45
Manufacturing	285.85	234.08	603.25	386.01
Transportation, Communications & Public Utilities	229.86	455.71	477.93	434.16
Wholesale & Retail Trade	182.90	181.09	197.18	185.34
Finance, Insurance & Real Estate	271.49	272.89	259.86	266.66
Services	206.31	194.49	169.37	183.59
State/Local Government	273.19	292.13	317.65	313.19
Other	195.18	147.70	178.20	193.72

* Not disclosed.

Note: The average weekly wage for each category includes the salaries and wages of all persons working for that type business. For example, the manufacturing category includes both production workers and administrative personnel. Excludes domestic workers, railway workers, certain nonprofit corporations, majority of federal government workers, and self-employed workers.

Source: Kentucky Cabinet for Human Resources, Average Weekly Wages of Workers Covered by Kentucky Unemployment Insurance Law, 1987.

EXISTING INDUSTRY

RADCLIFF MANUFACTURING FIRMS,
THEIR PRODUCTS AND EMPLOYMENT

<u>Firm</u> <u>(Establishment date)</u>	<u>Product</u>	<u>1987</u> <u>Average Employment</u>	<u>Labor</u> <u>Unions</u>
Eagle Thermoplastics, Inc. (1985)	Plastic & aluminum containers	12	
Hardin County Ready Mix (1979)	Ready-mixed concrete	24	
Radcliff Concrete, Inc. (1957)	Ready-mixed concrete	39	Teamsters*
Royalty Printing Company and The Sentinel (1957)	Newspaper, job printing	5	
UARCO, Inc. (1972)	Business forms	181	

* See Labor Organizations below.

Sources: Kentucky Department of Economic Development, 1988 Kentucky Directory of Manufacturers; Division of Research and Planning.

LABOR ORGANIZATIONS IN MANUFACTURING FIRMS

<u>Union</u>	<u>Representing workers at:</u>
International Brotherhood of Teamsters, Chauffeurs, Warehousemen and Helpers of America	Radcliff Concrete, Inc.

SELECTED INDUSTRIAL SERVICES

<u>Types of Service</u>	<u>Location</u>	<u>Mileage from Radcliff</u>
Custom Data Processing	Elizabethtown	12
Custom Plastics Producers	Fairdale	26
	Louisville	34
Electric Motor Repair	Elizabethtown	12
	Louisville	34
Grinding, Precision & Tool	Louisville	34
Heat Treating Facilities	Louisville	34
Industrial Equipment & Supplies	Louisville	34
Industrial Gases	Elizabethtown	12
	Louisville	34
Industrial Waste Removal	Elizabethtown	12
	Louisville	34
Machine Shops, Tool & Die	Elizabethtown	12
	Louisville	34
Metal Castings	Louisville	34
Metal Finishers	Elizabethtown	12
	Louisville	34
Metal Service Centers	Louisville	34
Millwrights	Radcliff	-
Public Warehouse Facilities	Elizabethtown	12
	Louisville	34

Sources: Kentucky Department of Economic Development, Kentucky Directory of Selected Industrial Services, 1987; Division of Research and Planning.

TRANSPORTATION

Rail

The Paducah and Louisville Railway provides main line rail service to Radcliff. The nearest piggyback facilities are located in Louisville, 34 miles north of Radcliff.

For details on routing, schedules, rates, and services contact:

Vice President - Marketing and Sales
Paducah and Louisville Railway
1500 Kentucky Avenue
Paducah, Kentucky 42001
(502) 444-4341

Highways

Radcliff is directly served by U.S. Highway 31W, a "AAA"-rated (80,000-pound gross load limit) trucking highway. U.S. 31W provides Radcliff with four-lane access to two major highway networks. Interstate 65, the Western Kentucky Parkway, and the Blue Grass Parkway are all accessible at Elizabethtown, 12 miles south of Radcliff. Interstate 65 is a major north-south traffic artery extending from Chicago, Illinois, to the Gulf of Mexico. The Blue Grass Parkway and the Western Kentucky Parkway are both multilane highways, and together they extend from Interstate 24 in western Kentucky to Lexington in central Kentucky.

U.S. 31W also provides access to a highway network at Louisville, 34 miles north of Radcliff, which includes Interstate 64, Interstate 65, Interstate 71, and many other U.S. and Kentucky highways. The Gene Snyder Freeway is 21 miles north of Radcliff via U.S. 31W and provides easy multilane access to and from Interstate 65, just south of the Louisville metropolitan area.

Logsdon Parkway is presently being extended to Interstate 65. This four-lane highway serves the Radcliff Industrial Park. This highway project is scheduled to be completed in 1989.

Truck Service

ABF Freight System, Inc.*	Leitchfield Transfer Company**
ANR Freight System, Inc.*	Majors Transit, Inc.**
Advance Transportation Company**	Manning Motor Express, Inc.**
American Freight System, Inc.*	NW Transport Service, Inc.**
Averitt Express, Inc.**	Overnite Transportation Company**
Bowman Transportation, Inc.*	Owenton Express, Inc.**
Carolina Freight Carriers Corporation**	P-I-E Nationwide, Inc.**
Churchill Truck Lines, Inc.**	Preston Trucking Company, Inc.**
Claxon Truck Line, Inc.**	RW Service System, Inc.**
Consolidated Freightways Corporation of Delaware**	Roadway Express, Inc.**
Hohenwald Truck Lines, Inc.**	Spartan Express, Inc.*
Jones Truck Lines, Inc.**	TNT Holland Motor Express, Inc.**
	Yellow Freight System, Inc.**

* Interstate service only.

** Interstate and intrastate service.

Source: American Motor Carrier Directory, Fall 1988.

HIGHWAY MILES AND TRUCK TRANSIT TIME IN DAYS FROM RADCLIFF, KENTUCKY, TO SELECTED MARKET CENTERS

City	Highway Miles	Delivery		City	Highway Miles	Delivery	
		Time TL				Time TL	
Atlanta, GA	385	2		Los Angeles, CA	2,142	5	
Baltimore MD	632	3		Louisville, KY	34	1	
Birmingham, AL	339	3		Nashville, TN	143	1	
Chicago, IL	326	2		New Orleans, LA	660	3	
Cincinnati, OH	135	1		New York, NY	782	-	
Cleveland, OH	379	1		Pittsburgh, PA	422	1	
Detroit, MI	394	2		St. Louis, MO	297	1	
Knoxville, TN	267	2					

Note: Mileage computations are via the best interstate or primary highways, not necessarily the most direct route of travel.

Sources: Rand McNally Deluxe Motor Carriers' Road Atlas, 1987. Official Kentucky Mileage Map, 1980. Delivery time - Overnite Transportation Company, P. O. Box 99308, Louisville, Kentucky 40299.

Air

Local

Location: Addington Field
4 miles west of Elizabethtown;
15 miles south of Radcliff

Runways: 1 paved

Length: 5,000 feet

Traffic

Control: Unicom, wind sock

Lighting: Runway, taxiway and beacon, VASI, REIL

Services: 100 octane, jet-A fuel, charter, major A & P repairs,
hangar and tie-down, flight instruction, lease
car, FBO

Air Freight
Service: Chartered air freight service must be arranged

Nearest Scheduled Commercial Airline Service

Location: Standiford Field
4 miles southeast of center of Louisville, Kentucky;
33 miles northeast of Radcliff

Runways: 2 paved

Length: 10,000 feet; 7,250 feet

Traffic

Control: Control Tower

Lighting: Runways, obstructions, beacon and approach; touch-
down lights and center line on one runway

Services: American Airlines, Delta, Eastern, Piedmont,
Northwest, TWA, United, USAir, Jetstream,
Allegheny Commuter, Comair, Braniff; fuel - 100
and jet-A; major A & P repairs, major Avionics
repairs, APU, charter, oxygen, U.S. Customs; taxi,
car rentals, limousine, courtesy car, public
transit; Weather Bureau, restaurant, snack bar,
gift shop, USO, bank

Air Freight
Service: Air freight terminal

Air Express Service

Several major companies offer air express services in Kentucky. These companies provide a quick means of shipping small to medium-sized packages expeditiously.

Water

The nearest navigable waterway is the Ohio River, 15 miles north of Radcliff, where a 9-foot navigation channel is maintained. Radcliff is 34 miles south of the Ohio River at Louisville where port facilities are available. The Louisville and Jefferson County Riverport Authority has been designated as a Foreign Trade Zone and offers complete U.S. Customs services for imports and exports.

POWER AND FUEL

Electricity

Company serving portions of Radcliff and Hardin County - Kentucky
Utilities Company
Source of power - Kentucky Utilities Company
For industrial rates contact:

Industrial Development Department
Kentucky Utilities Company
One Quality Street
Lexington, Kentucky 40507
(606) 255-1461

Company serving portions of Radcliff and Hardin County - Nolin Rural
Electric Cooperation
Source of power - East Kentucky Power Cooperative
For industrial rates contact:

Industrial Development Division
East Kentucky Power Cooperative
P. O. Box 707
Winchester, Kentucky 40391
(606) 744-4812

and/or

Nolin RECC
612 East Dixie
Elizabethtown, Kentucky 42701
(502) 765-6153

Company serving northern portion of Hardin County - Louisville Gas and
Electric Company
Source of power - Louisville Gas and Electric Company
For industrial rates contact:

Louisville Gas and Electric Company
P. O. Box 32010
Louisville, Kentucky 40232
(502) 566-4246 or (502) 566-4253

Natural Gas

Company serving Radcliff - Louisville Gas and Electric Company

Source of supply - Texas Gas Transmission Corporation

Size of transmission mains - 26-inch (supplier); 16-inch (distributor)

Distribution mains - 2 through 8 inches

Distribution pressure - 35 psi

Btu content - 1,025 per cubic foot

Specific gravity - .583

For rates and supplies contact:

Manager, Economic Development and

Market Research

Louisville Gas and Electric Company

P. O. Box 32010

Louisville, Kentucky 40232

(502) 566-4488

WATER AND SEWERAGE

Public Water Supply

Company serving Radcliff - Hardin County Water District No. 1*
409 West Lincoln Trail Boulevard
Radcliff, Kentucky 40160
(502) 351-3222

Source - Purtel Spring, wells, Muldraugh
Treatment plant capacity - 4,600,000 gallons per day (total for 2 plants)
Average daily consumption - 4,500,000 gallons**
Peak daily consumption - 4,800,000 gallons
Treatment processes - Chlorination, coagulation, filtration, fluoridation,
floculation, sedimentation, rapid mix
Storage capacity - 2,493,000 gallons, including clear well
Size lines - 2 to 14 inches
Water pressure - 40 psi to 225 psi

MONTHLY WATER RATES

First	2,000 gallons	\$5.50 (Minimum)
Next	13,000 gallons	1.47 per M gallons
All over	15,000 gallons	1.00 per M gallons

Tap-on charge:

5/8 x 3/4-inch meter -	\$325
3/4-inch meter -	355
1-inch meter -	475
1 1/2-inch meter -	1,225
2-inch meter -	1,750
3-inch meter -	2,825
4-inch meter -	3,650
6-inch meter -	5,600

Additional meter installations in existing services:

Utilizing the existing meter vault - \$105
Installing another meter vault - \$135

* The Hardin County Water District #1 recently completed construction of a 1.2-million-gallon storage tank. Plans were recently approved for two additional tanks, a 250,000-gallon elevated tank and a 1.2-million-gallon tank. Cost of these storage facilities will be approximately \$1.3 million.

** Approximately two million gallons of water per day is presently being sold to Hardin County Water District #2. When Water District #2 completes its new treatment plant, this amount will be considerably lower.

Sewerage

Company serving Radcliff - City of Radcliff Sewerage System*
P. O. Box 606
Radcliff, Kentucky 40160
(502) 351-6270 (plant); (502) 351-6466 (office)

Design capacity - 2,810,000 gallons per day (total of two plants)

Average daily flow - 2,300,000 gallons

Type of treatment - Secondary

Treatment processes - Screening, grit removal, secondary sedimentation,
chlorination, aerobic digester, sludge drying beds, post aeration,
flow equalization, oxidation ditch

Treated effluent discharged into - Mill Creek

Size of sanitary mains - 10 to 14 inches

Monthly rates - Based on water consumption:

First	2,000 gallons	\$4.71 (Minimum)
Next	8,000 gallons	1.27 per M gallons
Next	30,000 gallons	1.01 per M gallons
Over	40,000 gallons	.94 per M gallons

Tap-on charge:

Within city limits - \$150

Outside city limits - \$450

* A new 2.8 mgd wastewater treatment plant was recently completed in Radcliff. Cost of the new plant was \$5.4 million. A sewer line expansion project was also recently completed. Cost of this project was \$500,000.

CLIMATE

Hardin County

Temperature

Normal (30-year record)	54.90 degrees
Average annual 1986	54.40 degrees
Record highest, August 1983 (42-year record)	103.00 degrees
Record lowest, January 1963 (42-year record)	-21.00 degrees
Normal heating degree days (30-year record) (Heating degree day totals are the sums of negative departures of average daily temperatures from 65 degrees F.)	4,814

Precipitation

Normal (30-year record)	45.68 inches
Mean annual snowfall (30-year record)	16.40 inches
Total precipitation 1986	34.86 inches
Mean number days precipitation (.01 inch or more) (42-year record)	130.30
Mean number days thunderstorms (42-year record)	45.60

Prevailing winds (through 1963)

South

Relative Humidity

1 a.m.	77 percent (22-year record)
7 a.m.	82 percent (23-year record)
1 p.m.	60 percent (23-year record)
7 p.m.	64 percent (23-year record)

Source: U.S. Department of Commerce, Environmental Science Services Administration, Climatological Data, 1986. Station of record: Lexington, Kentucky.

LOCAL GOVERNMENT

Structure

The city of Radcliff is served by a mayor and six council members. Hardin County is served by a county judge/executive and eight magistrates.

Planning and Zoning

City agency - Radcliff Planning Commission
Zoning enforced - Within Radcliff city limits
Subdivision regulations enforced - Within Radcliff city limits
Local codes enforced - Building and housing
Mandatory state codes enforced - Kentucky Plumbing code, National Electric Code, Kentucky Boiler Regulations and Standards, Kentucky Building Code (modeled after BOCA code)

County agency - Hardin County Planning and Development Commission
Zoning enforced - All areas of unincorporated Hardin County
Subdivision regulations enforced - All areas of unincorporated Hardin County
Local codes enforced - Building
Mandatory state codes enforced - Kentucky Plumbing code, National Electric Code, Kentucky Boiler Regulations and Standards, Kentucky Building Code (modeled after BOCA code)

Local Fees and Licenses

Radcliff levies business license fees based upon annual gross receipts. Assessment rates on the businesses' gross receipts vary according to the type of business, and range from .00625 to .007. The minimum annual fees for businesses also vary, and most range from \$25 to \$150. The assessment rate for manufacturers is .00275, with a minimum annual fee of \$50.

Radcliff also levies a one percent occupational tax on wages, salaries, and commissions of individuals.

A 3 percent tax is levied on utilities receipts for schools in Hardin County. Tax is paid by all consumers of utilities as an add-on to the utilities bills. Exempted are receipts from utilities services that are resold and the receipts from the sale of energy or energy producing fuels that exceed 3 percent of the cost of production in manufacturing, processing, mining or refining.

State and Local Property Taxes

All property in Kentucky, except items exempted by the state constitution, is taxed by the state. Property which also may be taxed by local jurisdictions includes land and buildings, finished goods inventories, automobiles, trucks, office furniture and office equipment. Local taxing jurisdictions in Kentucky include counties, cities, and school districts.

All property in Kentucky is assessed at 100 percent of fair cash value.

COMBINED STATE AND LOCAL RATES PER \$100 VALUATION, 1987

	Radcliff	Unincorporated Hardin County
Land and Buildings	\$0.6886	\$0.5006
Manufacturing		
Machinery	0.150	0.150
Pollution Control		
Equipment	0.150	0.150
Inventories		
Raw materials	0.001	0.001
Goods in Process	0.001	0.001
Finished Goods	0.4866	0.2986
Automobiles & Trucks	0.9366	0.7376
Other Tangible		
Personal Property	0.9356	0.7476
Intangibles (Accounts receivable*, money in hand, stock, notes, bonds)	0.250	0.250
Goods Stored in Public Warehouses in Transit Status	0.001	0.001
Private Leaseholds in Industrial Revenue Bond Financed Facilities	0.015	0.015

* Accounts receivable are taxed at 85 percent of face value, for an effective rate of \$0.2125 per \$100 valuation.

Safety

Police	Radcliff	Hardin County
Total staff	37	13
Radio-patrol cars	10	9
Fire*		
Insurance Services Office, Public Protection Classification		
	5	**
Full-time staff	2	-
Volunteers	20	262
Rescue Service		

Hardin County Disaster and Emergency Service provides rescue service to all areas of Hardin County.

Refuse Collection and Disposal

Private companies provide sanitation service to Radcliff. The unincorporated areas of Hardin County are served by a private sanitation company through a franchise agreement with the Hardin County government.

* Includes copyrighted material of ISO Commercial Risk Services, Inc., with its permission.

** Ten fire protection districts serve Hardin County. Property located within five road miles of a responding fire station ranges from class 7 to class 9. Property located in unincorporated Hardin County, more than five road miles from a fire station, has a class 10 rating.

EDUCATION

Public Schools

	Hardin County*
Total Enrollment (May 1988)	11,837
Kindergarten	922
Elementary	4,716
Middle School	2,674
High School	3,409
Special Education	116
Accreditation	Southern Association of Colleges and Schools
Pupil-Teacher Ratio (1986-87)	21-1
Percent High School Graduates to College (1986-87)	64.2
Expenditures Per Pupil (1986-87)	\$2,122.00

Nonpublic Schools

<u>School</u>	<u>Enrollment</u>	<u>Grades</u>
Fort Knox Community Schools (military personnel)	3,814	K-12
St. Christopher Elementary	117	K-6
Hardin Christian Academy	69	K-12

* The Hardin County School System is presently converting Hardin Central Middle School to a new high school. A new middle school is also under construction. Both facilities are scheduled to be completed in the fall of 1990 at a cost of \$9.1 million.

Area Colleges and Universities

<u>Name</u>	<u>Location (Miles distant)</u>	<u>Enrollment (Fall, 1987)</u>	<u>Highest Degree Conferred</u>
Elizabethtown Community College	Elizabethtown (12)	2,346	Associate
Bellarmino College	Louisville (34)	3,624	Masters
Jefferson Community College	Louisville (34)	7,750	Associate
Spalding University	Louisville (34)	1,177	Doctorate
University of Louisville	Louisville (34)	21,087	Doctorate, M.D., D.M.D., J.D.
Campbellsville College	Campbellsville (54)	660	Baccalaureate
Saint Catharine College	Springfield (55)	265	Associate

Elizabethtown Community College

Elizabethtown Community College, located 12 miles south of Radcliff in Elizabethtown, is a member of the University of Kentucky's Community College System and is accredited by the Southern Association of Colleges and Schools. The College offers an Associate in Applied Science degree in the following fields: Nursing, Office Administration, Data Processing Technology, and Business Technology with options in Management, Banking Management, and Real Estate Management. In addition, the college offers the first two years of study toward baccalaureate degrees in most programs offered by four-year colleges and universities. An Associate in Arts or an Associate in Science degree may be awarded in the pre-baccalaureate program.

Fort Knox Extension Campuses

Ten institutions of higher education operate extension campuses at Fort Knox Military Reservation, located adjacent to the city of Radcliff. These extension campuses confer various graduate and undergraduate degrees, including doctorate degrees in policy analysis and education. The extension campuses' programs are open to the public. The extension campuses include: Central Texas College, Eastern Kentucky University, Embry Riddle Aeronautical University, Sullivan Junior College of Business, University of Kentucky, University of Louisville, University of Southern California, Western Kentucky University, McKendree College, and Elizabethtown Community College.

Vocational Training

The Bluegrass State Skills Corporation, an independent public corporation created and funded by the Kentucky General Assembly, provides programs of skills training to meet the needs of business and industry from entry level to advanced training, and from upgrading present employees to retraining experienced workers.

The Bluegrass State Skills Corporation is the primary source for skills training assistance for a new or existing company. The Corporation works in partnership with other employment and job training resources and programs, as well as Kentucky's economic development activities, to package a program customized to meet the specific needs of a company.

Vocational training is available at both the state vocational-technical schools and the area vocational education centers. The state vocational-technical schools are post-secondary institutions. The area vocational education centers are designed to supplement the curriculum of high school students. Both the state vocational-technical schools and the area vocational education centers offer evening courses to enable working adults to upgrade current job skills.

Arrangements can be made to provide training in the specific production skills required by an industrial plant. Instruction may be conducted either in the vocational school or in the industrial plant, depending upon the desired arrangement and the availability of special equipment.

Nearest State School

Elizabethtown State Vocational-Technical School
Elizabethtown, 12 miles south of Radcliff

Agriculture	Electricity
Agricultural Mechanics	Electronics
Business & Office	Industrial Machine Maintenance
Accounting/Management	Machine Shop
Clerical	Plumbing
Secretarial	Radio & TV Repair
Word Processing	Welding
Consumer & Home Economics	Public Service Occupations
Commercial Foods	Business/Industry Security
Consumer & Family Life	Training
Skills	CPR Training
Industrial Education	Electrical Safety Training
Air Conditioning	Emergency Medical Care
Appliance Repair	Fire Service Training
Auto Mechanics	First Aid & Safety
Carpentry	Rescue & Emergency Services
Diesel Mechanics	Training
Drafting (with CAD/CAM)	

Nearest Area Education Center

Meade County Area Vocational Education Center
Brandenburg, Kentucky, 22 miles from Radcliff

Home Economics
Child Care Services
Health & Personal Services
Occupations
Health Services
Industrial Education
Air Conditioning

Auto Mechanics
Carpentry
Electricity
Electronics
Welding
Learning Resource Center
Retailing

HEALTH

Local Medical Personnel

Physicians - 16

Dentists - 12

Hospitals

<u>General Hospital</u>	<u>Location</u>	<u>Beds</u>
Hardin Memorial Hospital	Elizabethtown	300

Medical staff - 107 physicians, 318 registered nurses, 22 licensed practical nurses

Other Medical Facilities

Carefirst

Communicare, Inc.

Lincoln Trail District Health Department/Hardin County Health Center

Lincoln Trail Psychiatric Hospital

Radcliff Medical Clinic

North Hardin Medical Center

Ambulance Service

Name - Hardin County Ambulance Service

Staff - 19 full-time and 6 part-time emergency medical technicians

OTHER LOCAL FACILITIES

Communications

Telephone -	Brandenburg Telephone Company; General Telephone Company
Telegraph -	Western Union Toll-Free number, 1-800-325-6000
Newspapers - Daily and circulation -	News-Enterprise (Elizabethtown) - 16,326
Weekly and circulation -	The Sentinel - 3,950; Radcliff Leader - 3,200
Radio -	WASE-AM & FM
Television - Airwave reception from -	Louisville, Kentucky Telecable of Radcliff
Cable service - Educational Television -	The Kentucky Educational Television (K.E.T.) network is available statewide

Library Services

Public library - Hardin County Public Library (branch located in Radcliff)
Size collection - 73,968 volumes
Circulation, 1986-87 - 163,680

Religious Institutions

Denominations -	Assembly of God Baptist Catholic Christian Church of Christ Church of God Church of the Nazarene Disciples of Christ First Korean Baptist	Full Gospel Korean Church Jehovah's Witnesses Korean United Methodist Methodist Non-denominational Pentecostal Presbyterian
Nearest Synagogues - Congregations -	Louisville, 44 miles north Adath Isreal Brith Sholom (reform) Adath Jeshurum (conservative) Anshei Sfard (orthodox) Keneseth Isreal (orthodox) Sholom (reform)	

Financial Institutions

<u>Banks</u>	<u>Assets</u>	<u>Deposits</u>	<u>Statement Date</u>
Hardin County			
The Cecilian Bank	\$ 58,224,066.99	\$ 48,598,506.31	12/31/87
Citizens Fidelity Bank of Hardin County	231,559,000.00	168,167,000.00	6/30/88
Farmers Bank	16,872,458.85	14,762,949.56	6/30/88
First Citizens Bank	92,983,469.00	82,184,336.00	6/30/88
Fort Knox National Bank	66,052,000.00	58,968,000.00	12/31/87
Hardin County Bank	43,603,814.00	38,809,196.00	12/31/87
Liberty National Bank of Hardin County	28,568,091.00	23,504,611.00	12/31/87

<u>Savings and Loan Associations</u>	<u>Assets</u>	<u>Deposits</u>	<u>Statement Date</u>
First Federal Savings Bank	\$178,416,081.00	\$147,310,508.00	3/31/88
Republic Savings Bank	348,705,373.41	175,897,907.39	12/31/87

Hotels and Motels

Total number - 6
Total rooms - 330

Clubs and Organizations

Adult Activities Club
American Federation of
Government Employees (AFGE)
American Legion
American Legion Auxiliary
Ancestral Trails
Armor Center Civic League
Association of United States
Army (AUSA)
Boy Scouts
Brownies
CB Club
Chamber of Commerce
Daughters of the American
Revolution
Disabled American Veterans
Eastern Star
Emergency Disaster Unit
Foreign Language Club
Fort Knox NCO Wives Club
Fort Knox Officer's Wives Club
Fraternal Order of Police
Future Business Leaders of
America (FBLA)
Future Farmers of America
(FFA)
Future Homemakers of America
(FHA)
Future Teachers of America
(FTA)

Girl Scouts
International F & AM Masons
International Wives Club
Jaycees
Knights of Columbus Council
Ladies Auxiliary (Fire Department)
Lions Club
Masonic Lodge
Mothers Against Drunk Drivers
(MADD)
Mothers of Twins Club
Non-Commissioned Officers
Association
Optimist International
Parents Without Partners
Pep Club
Radcliff Arts Guild
Radcliff Homemakers
Radcliff Industrial Foundation
Radcliff Ministerial Association
Radcliff Sunrise Optimist
Radcliff Woman's Club
Retired Officers Association
Rotary Club
Teens Who Care
TOPS
Veterans of Foreign Wars (VFW)
Veterans of Foreign Wars Ladies
Auxiliary
Weight Watchers

RECREATION

Local

Radcliff and Northern Hardin County residents enjoy a year-round recreation program with excellent facilities. The recreation department is staffed by a Recreation Director, Assistant Director, and Recreation Leader who work full-time. A host of volunteers support the many programs for all age groups, tots and seniors.

The David S. Colvin Community Center has a junior Olympic-size swimming pool, a wading pool, shuffleboard courts, tennis courts, a walking course, and a game room. Two meeting rooms (one fully-equipped with kitchen facilities) are available for community and private gatherings.

The Radcliff City Park has picnic areas, playground equipment, tennis courts, pavilions, walkways, shade trees, and ample parking space. The Hardin County Playhouse, a theatre with seating for 200 persons, is located at the park, and features five productions each year.

Duvall Park provides four baseball/softball fields, a concession stand and playground equipment.

Dawley Park has two adult softball fields, two soccer fields, one football field, playground equipment, a fitness course, two pavilions, picnic tables, grills, a concession stand, and convenient parking space.

Radcliff Junior High School maintains an excellent softball field and a paved outdoor basketball court, which are used frequently for recreation activities. The North Hardin High School's football practice field and four outdoor tennis courts, with lights, and the Parkway Elementary School's soccer fields are available for recreational use.

Activities supervised by the Radcliff Recreational Department include kids and youth soccer, kids and youth baseball/softball leagues, little league football, cheerleading, adult softball leagues, water polo, swimming lessons, tennis lessons, tennis leagues, tennis tournaments, youth and adult volleyball leagues, teen dances, ballet, tap and jazz lessons, square dance lessons, karate lessons, women's fitness programs, kids crafts, special game room hours, children/adult basketball leagues, turkey trots, turkey shoot, Mom's Day Out, flag football, stuffed animal pet show, trivia contests, Family Feud tournament, Pictionary tourney, children's theatre, youth theatre, and storybook/craft time.

League play in all youth sports extends to Fort Knox and three surrounding communities.

Bingo, card games, and shuffleboard are among the list of senior citizen activities.

The Golden Armor Festival is held in Radcliff in September of each year and pays tribute to nearby Fort Knox and the military personnel stationed there. The events are open to the public. The week-long celebration features a parade, entertainment, music, food, crafts, funfest, sport tournaments, receptions, and a beauty pageant.

Area (Within 60 miles)

The Patton Museum of Cavalry and Armor at Fort Knox, adjacent to Radcliff, features exhibits depicting the history and development of cavalry and armored weapons. A military history and reference library is also available. The Patton Gallery displays many of General George S. Patton, Jr.'s, personal items. Historic pieces of armor, including some captured from Germany by General Patton's army in World War II, are displayed on the museum grounds.

Abraham Lincoln Birthplace National Historic Site, located 27 miles southeast of Radcliff near Hodgenville, features the log cabin which was the birthplace of Abraham Lincoln, enclosed within a granite memorial shrine. The grounds include 116 acres of the original Thomas Lincoln farm and a visitors' center with audiovisual programs and exhibits on the Lincoln family.

Bernheim Forest Arboretum and Nature Center, located 34 miles east of Radcliff, is a privately endowed 10,000-acre forest and wildlife refuge. The area contains over 1,200 labeled varieties of plants, trees and shrubs; ornamental gardens; a nature center; nature trails and waterfowl ponds.

Louisville, 34 miles northeast of Radcliff, provides a wide variety of recreational opportunities. The most noted recreational event in Louisville is the Kentucky Derby at Churchill Downs. The "Run for the Roses" is the oldest continuously held horse race in the United States. Other attractions include: Kentucky Center for the Arts, Macauley Theatre, Actors Theatre of Louisville, Louisville Children's Theatre, the Louisville Bach Society, the Louisville Orchestra, the Louisville Ballet, the Kentucky Opera Association, several museums, the Louisville Zoological Gardens, University of Louisville sporting events, rock concerts, and the "Belle of Louisville" sternwheeler.

My Old Kentucky Home State Park, 38 miles east of Radcliff in Bardstown, portrays an image of the South's gentle and leisurely home life before the Civil War. The restored Georgian Colonial mansion is where composer Stephen Foster visited and where he was inspired to write "My Old Kentucky Home." A world-renowned outdoor drama, "The Stephen Foster Story", is presented in the park's amphitheatre during the summer months. The park also offers a 40-site campground, a gift shop, a 9-hole golf course and pro shop, a picnic area, and planned recreation.

E. P. "Tom" Sawyer State Park, 45 miles northeast of Radcliff, is located near Louisville. Recreational facilities include an outdoor Olympic-size pool, a bathhouse, 12 lighted tennis courts, bicycle moto-cross track (BMX), softball fields, a one-mile fitness trail, a picnic area, an archery range, and soccer fields. Planned recreation and playground are offered year-round. Indoor facilities are available for basketball, volleyball, exercise classes, dance classes and various other events.

Noteworthy for its spaciousness, **Rough River Dam State Resort Park** at Falls of Rough is 54 miles southwest of Radcliff. The 637-acre park on Rough River Lake features a 40-room lodge with a dining room, a coffee shop, a gift shop, a meeting room, and a 2,500-foot lighted airstrip. Cottages and camping sites are also available. Recreational facilities include a launching ramp, a dock with open and covered slips, fishing and pleasure boat rentals, a 9-hole, 3-par golf course, a swimming pool, a sand beach with a bathhouse complex, tennis courts, an archery range, hiking and fitness trails, picnic and playground areas, and planned recreation. Cruise boat excursions on Rough River Lake are available on the "Lady of the Lake" in season.

Mammoth Cave National Park is located 56 miles southwest of Radcliff near Cave City. Beneath 52,000 park acres, Mammoth Cave is among the major tourist attractions of all times. It is the largest cave network ever discovered, with over 300 miles of caverns. Some famous sights are Snowball Dining Room (267 feet below surface), Frozen Niagara, Crystal Lake, and Bottomless Pit. The park also features scenic boat trips on the Green River and nature and hiking trails. Park accommodations include a hotel with distinctive gift shops featuring native Kentucky and Southern Highland handicrafts, a motor lodge, hotel cottages, and woodland cottages. Other park facilities include the hotel dining room and coffee shop, a service center, group meeting facilities, a campground, boat rides, a picnic area, and tennis and shuffleboard courts. The park is open for tours every day of the year (except Christmas Day).

Nolin River Lake is just north of Mammoth Cave National Park. The lake has a surface area of 5,800 acres and offers facilities for camping, boating, and fishing.

Green River Lake State Park near Campbellsville, 57 miles southeast of Radcliff, is made up of 1,300 acres surrounding an 8,200-acre lake. The park is open all year-round and offers 156 campsites, a service building, playground, planned recreation, beaches, boat docks, fishing, and a picnic area.

Taylorsville Lake State Park, 57 miles east of Radcliff near Taylorsville, was developed by the U.S. Army Corps of Engineers. The 3,050-acre lake and 10,700-acre recreation area features full-service marina facilities, fishing, boating, swimming, and wildlife recreation.

Lincoln Homestead State Park, 60 miles east of Radcliff near Springfield, is a 153-acre park on land settled by Abraham Lincoln's family. The actual building in which Nancy Hanks, mother of President Lincoln, lived during her courtship with Thomas Lincoln is preserved here as well as a replica of the 1782 cabin where Thomas Lincoln lived as a boy. The park also maintains a museum, a gift shop, a picnic area, and an 18-hole golf course.

COMMUNITY IMPROVEMENTS

Recent

Radcliff was chosen as a "Kentucky Certified City" in 1985-1988. The award is based on achievement in the following categories: economic development, transportation, public affairs, utilities, health, commercial development, housing, education and recreation. The Certified Cities Program is sponsored by the Kentucky Chamber of Commerce.

The Radcliff Tourism, Convention, and Recreation Commission was established in July 1988. The commission consists of a seven-member board and is funded by a motel tax.

The city of Radcliff recently completed construction of the new Hall of Justice. The new \$1 million facility houses the city police department and court system.

A new 2.8 mgd wastewater treatment plant was recently completed in Radcliff. Cost of the new plant was \$5.4 million. A sewer line expansion project was also recently completed. Cost of this project was \$500,000.

The Hardin County Water District #1 recently completed construction of a 1.2-million-gallon storage tank. Plans were recently approved for two additional tanks, a 250,000-gallon elevated tank and a 1.2-million-gallon tank. Cost of these storage facilities will be approximately \$1.3 million.

Under Way

Logsdon Parkway is presently being extended to Interstate 65. This four-lane highway serves the Radcliff Industrial Park. This highway project is scheduled to be completed in 1989.

The Hardin County School System is presently converting Hardin Central Middle School to a new high school. A new middle school is also under construction. Both facilities are scheduled to be completed in the fall of 1990 at a cost of \$9.1 million.

Planned

The Hardin County School System plans to construct a new high school. Estimated cost of the new facility is approximately \$5.7 million and it is scheduled for completion in the fall 1992. A \$2.5 million renovation project is also planned for Lincoln Trail Elementary.



Cabinet for Economic Development
Department of Business Development
Capital Plaza Tower
Frankfort, Kentucky 40601
(502) 564-7140