

1-28-2005

UA1B1/7 Complex for Engineering & Biological Sciences Dedication

Western Kentucky University

Follow this and additional works at: http://digitalcommons.wku.edu/dlsc_ua_records

 Part of the [Biology Commons](#), [Engineering Commons](#), [Higher Education Administration Commons](#), [Public Relations and Advertising Commons](#), [Social History Commons](#), [Sociology Commons](#), and the [Urban, Community and Regional Planning Commons](#)

Recommended Citation

Western Kentucky University, "UA1B1/7 Complex for Engineering & Biological Sciences Dedication" (2005). *WKU Archives Records*. Paper 4745.
http://digitalcommons.wku.edu/dlsc_ua_records/4745

This Other is brought to you for free and open access by TopSCHOLAR®. It has been accepted for inclusion in WKU Archives Records by an authorized administrator of TopSCHOLAR®. For more information, please contact topscholar@wku.edu.



*T*HE COMPLEX FOR ENGINEERING AND BIOLOGICAL SCIENCES
DEDICATION CEREMONY

FRIDAY, JANUARY 28, 2005

11:00 A.M. (CST)

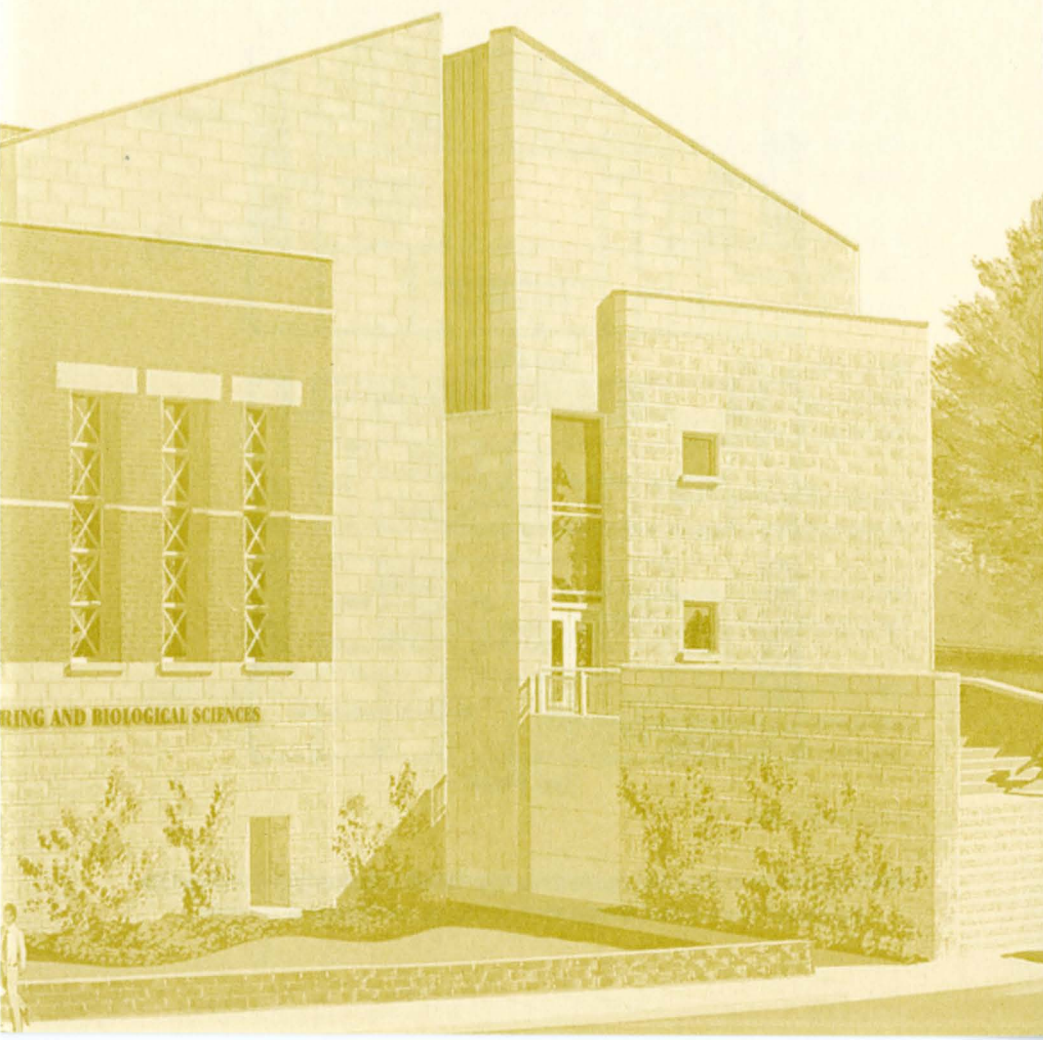



WESTERN
KENTUCKY
UNIVERSITY

*T*HE COMPLEX FOR ENGINEERING AND BIOLOGICAL SCIENCES
DEDICATION CEREMONY

FRIDAY, JANUARY 28, 2005
11:00 A.M. (CST)

WELCOME AND INTRODUCTIONS DR. BLAINE FERRELL
DEAN, OGDEN COLLEGE OF SCIENCE
AND ENGINEERING

REMARKS MS. KATE L. HERTWECK
SENIOR, BIOLOGY
EVANSVILLE, INDIANA

MR. BUD LAYNE
CEO, SPANTECH
GLASGOW, KENTUCKY

DR. GARY A. RANDELL
PRESIDENT, WESTERN KENTUCKY UNIVERSITY

THE HONORABLE ERNIE FLETCHER
GOVERNOR, COMMONWEALTH OF KENTUCKY

PRESENTATION MARK ROGERS
SENIOR, MECHANICAL ENGINEERING
SOMERSET, KENTUCKY

MS. HERTWECK

CLOSING DR. FERRELL

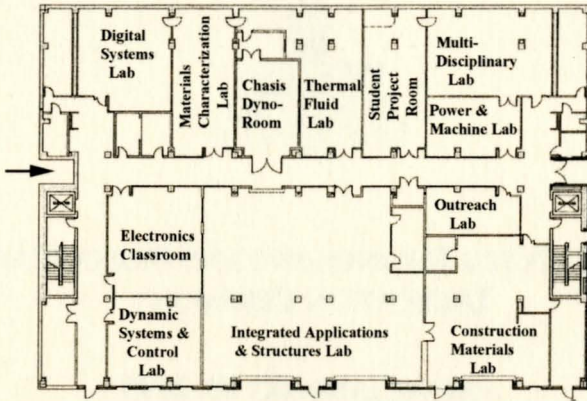

1st Floor

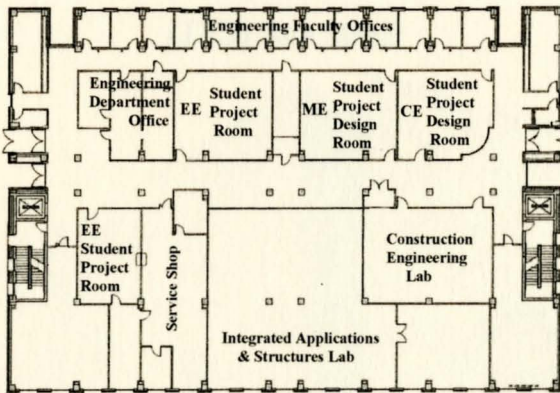

2nd Floor

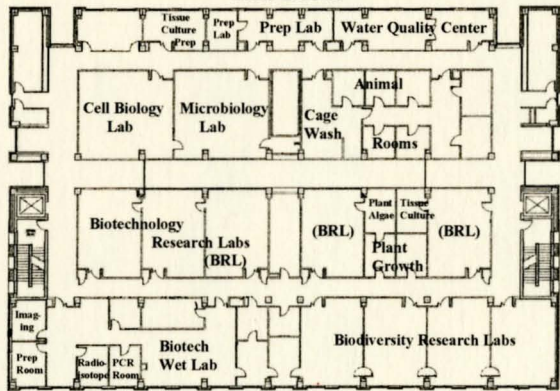

3rd Floor

Students from the biology and engineering departments will be available to assist in self-guided tours of the Complex for Engineering and Biological Sciences.

D4691

